

THIS MAP WAS PREPARED FOR ASSESSMENT PURPOSE ONLY

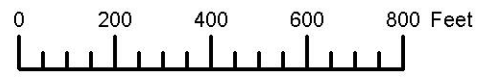

SECTION 15 T.1N. R.39E. W.M.

UNION COUNTY

1" = 400'

01N39E15 & INDEX, ELGIN

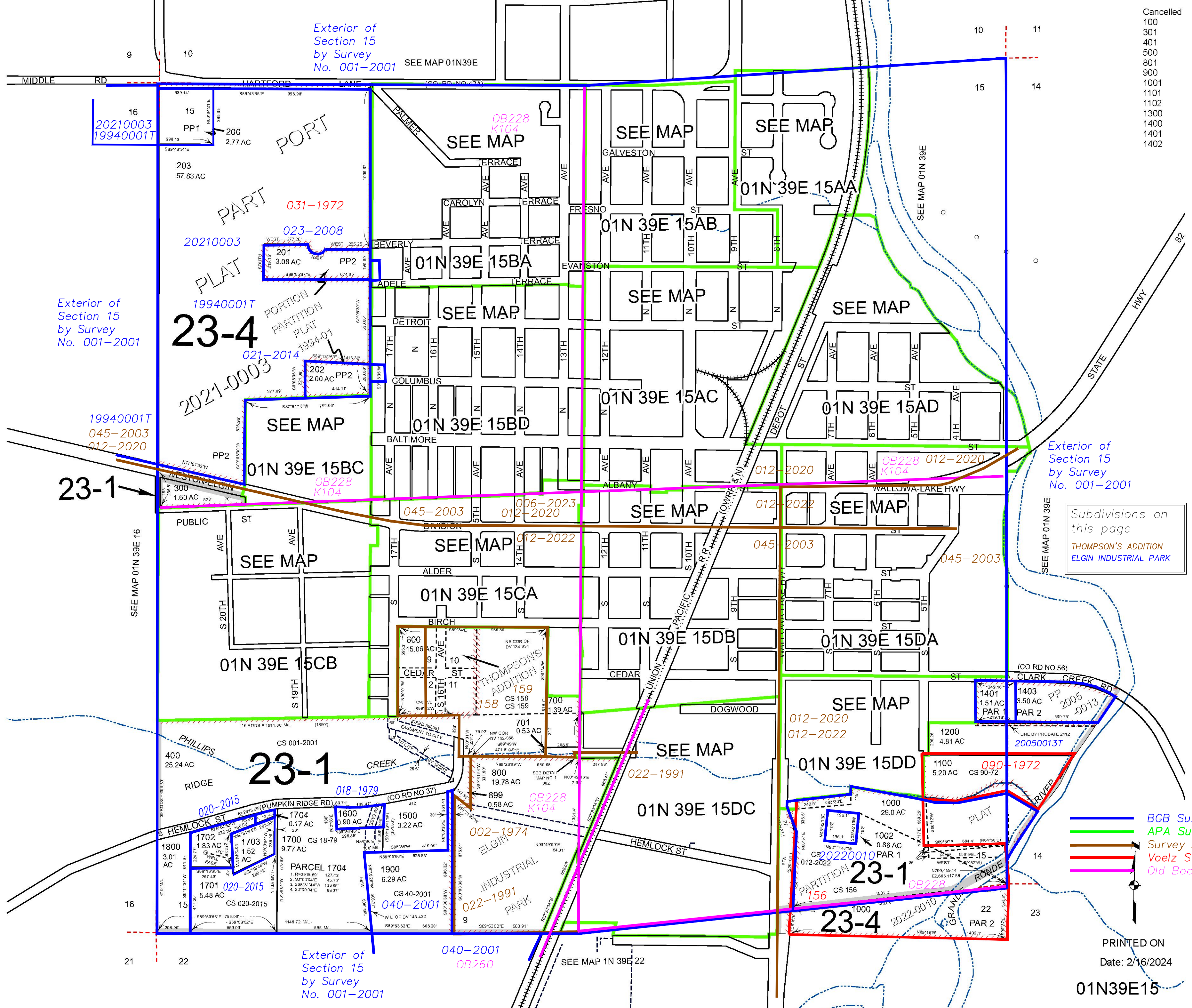

- Cancelled
- 100
- 301
- 401
- 500
- 801
- 900
- 1001
- 1101
- 1102
- 1300
- 1400
- 1401
- 1402

Exterior of Section 15 by Survey No. 001-2001

Exterior of Section 15 by Survey No. 001-2001

19940001T
045-2003
012-2020

Subdivisions on this page
THOMPSON'S ADDITION
ELGIN INDUSTRIAL PARK

- BGB Survey
- APA Survey
- Survey by Others
- Voelz Survey
- Old Book Survey

PRINTED ON
Date: 2/16/2024

01N39E15