

64

79

64

SPRING AVENUE

SURVEY OF

DIVISION OF LOTS 7-8-9-10, BLOCK 5, FOLEY'S ADDITION TO LA GRANDE, OREGON.

FOR FORREST RUSSELL

By A. H. McLain  
4-3-65

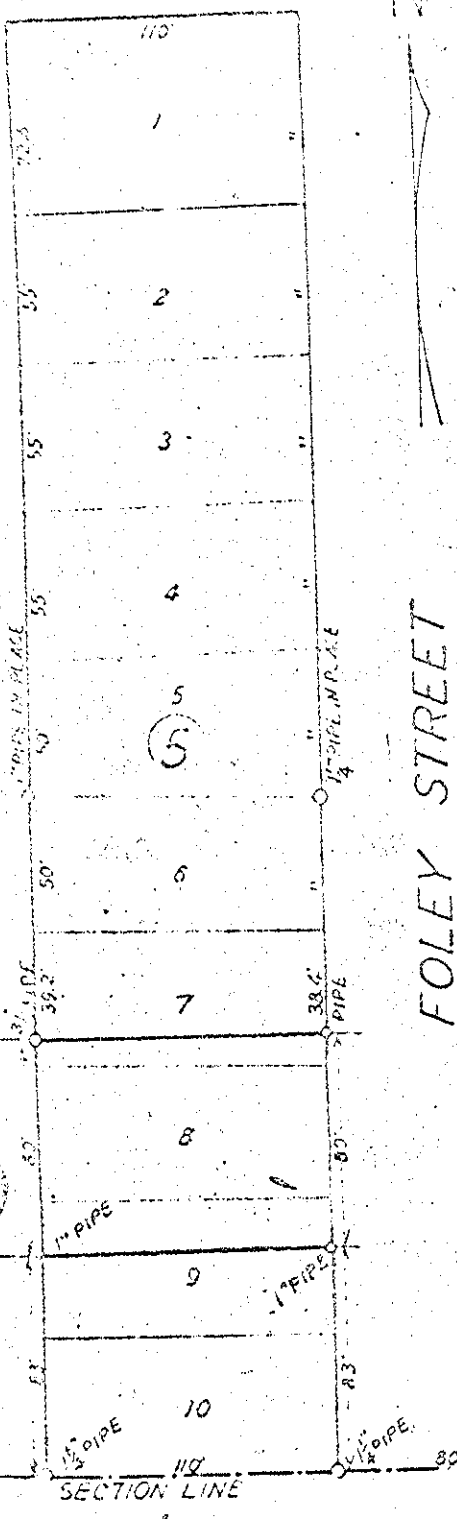

SPRING AVENUE

FOLEY STREET

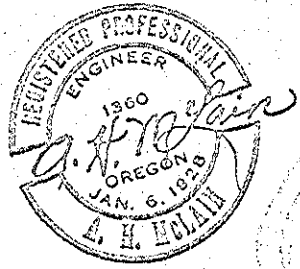

SCALE 1"=80'

1/2 SECTION CORNER BT SEC'S 6 & 7  
T. 3 S. R. 35 E. W. M.

PENNSYLVANIA AVENUE