

Scale 1" = 100'

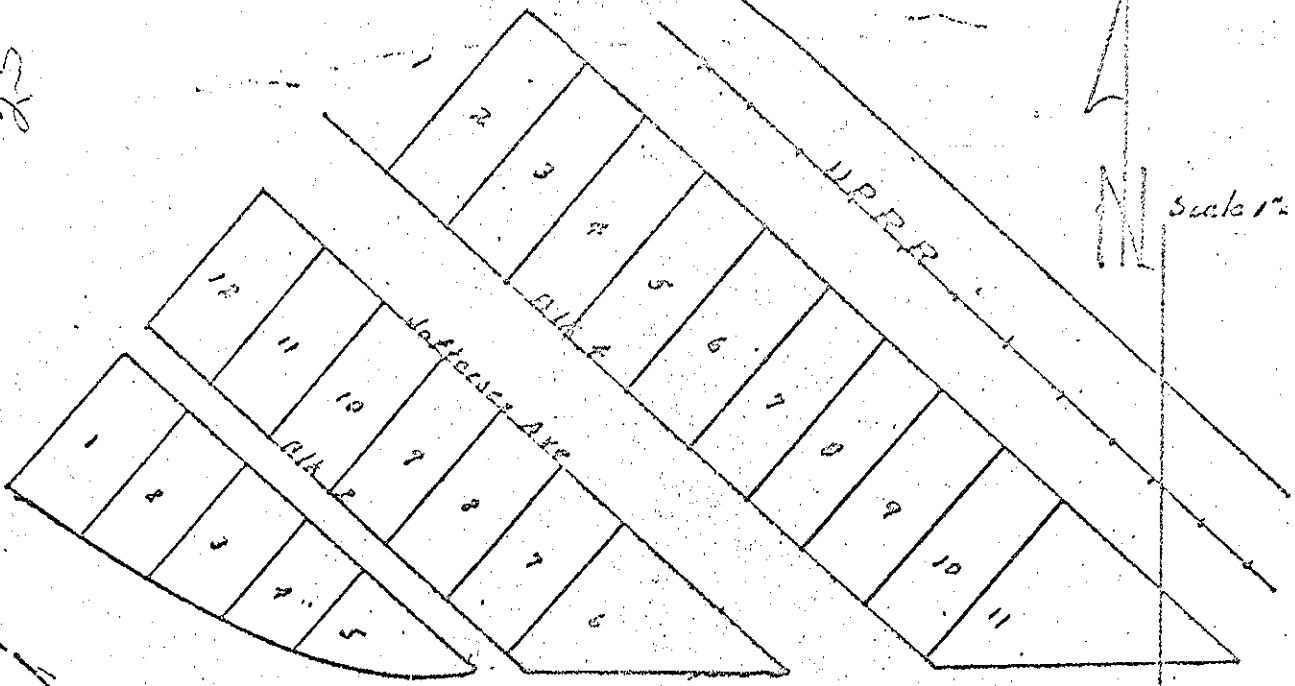
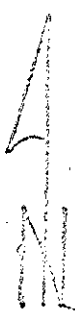

U. S. Highway 30

2/A cor. between

sec. 8 & 9 T-3-S R-35-E

Point of beginning

10' 11'

Highway Acres Extended

Adams Ave. Extended

75.29

30' Pipe

This survey completed in May 1958. Description as follows:  
 Commencing at a point on the south line of Old Oregon Trail Highway (U. S. Highway 30) as widened by deed to State of Oregon by and through its State Highway Commission, dated Oct. 16, 1951 (deed book 126 Pg. 415), which point of beginning is approx. 96.67 feet west (measured at right angles) the east line of said section 8; said point of beginning being the intersection of the south line of said highway as widened, with the east line of land conveyed to Helen Greathouse by deed dated April 19, 1950 (deed book 123 Pg. 497).

From said point of beginning so found and determined, the boundary of the property being here described runs south along the east line of the Greathouse tract referred to above and approx 96.67 feet west of and parallel with the east line of said section 8, to the intersection of said line with the northeasterly line of Adams Avenue, extended; thence southeasterly along the northeasterly line of said Adams Avenue to the intersection with the east line of said section 8, thence east 30 feet, thence north parallel with and 30 feet distance from the west line of said section 8; to the intersection with the southerly line of said highway as widened; thence westerly along the south line of said highway, as widened, to the point of beginning.