

RECORD OF SURVEY

Township 15 Range 38 EWM Union County, Oregon.

CHAINS. LKS.

Survey made May 28 1913, for Shaw, Mercham,
Needham, et al. to establish the center of section
12 T. 15 S. R. 38 E. M. 1/4

I established the 1/4 corner on the south side
of sec. 12 by measuring the south side of said
section and dividing the distance equally.
The remaining quarter corners are in place.

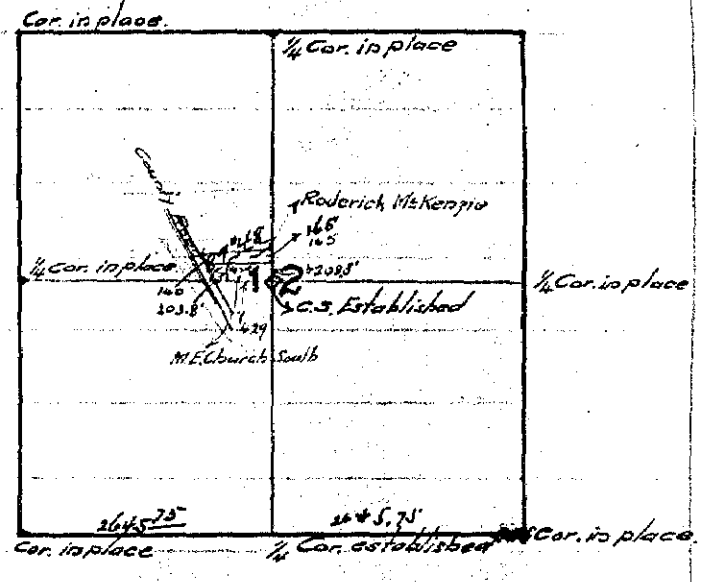

I established the center of this section by
intersecting straight lines joining the ^{quarter corners on} opposite sides of the section.
at this point I drove a 2' length chased stake ten feet below the
ground surface over which I placed a stone over 1000 cu. in. in vol. marked
C.S. The accompanying sketch accurately describes the survey.

At the 1/4 cor. on the south side, I drove a stake ^{over which I}
placed a stone over 1000 cu. in. in vol. marked 1/4.

O'Darley Co. Surveyor
Survey recorded June 18, 1913, by O'D.