

188
203-

Township 3 South

Range 38 East W. M.

Union County, Oregon.

CHAINS
LKS.

Henry Van Hook March 10-1899

I commenced at the South West
Cor. of Section 4 and run East
Var 20°

60 18 Set Temp. 1/8 Sec. Cor. to Kimbrel
field Notes on page 233

80 24 Set. Temporary Sec. Cor.

39 90 The 1/4 Section Cor between 3-10
this being a equal division
according to field notes I set
the section corner a marked

rock 18-10-12 inches Then North

20 Set Temp 1/8 Sec. Cor.

40 " " 1/4 " "

60 " " 1/8 " "

80 04 The North East Corner of Section 4 making a excess of 40 lks
according to Field Notes Then South

39 74 Set a stake for 1/8 Section Cor.

49 84 " " Stone 24-12-8 inches, for 1/4 Sec. Corner

69 94 " " " 10-14-16 " " 1/8 " " Then I set the 1/8
Section Corner on the South East 1/4 of Section 4 on the South side
and run North

20 Set Temp. 1/2 Cor

40 " " " "

60 " " " "

80 04 The 1/8 Section Corner on the North side of the N.E. 1/4 Sec 4
making a excess 40 lks to field notes, Then South

29 74 Set a marked stone for 1/2 Section Cor, 18-12-6 inches

49 84 " " " " " " 12-8-8 "

69 94 " " " " " " 14-10-8 "

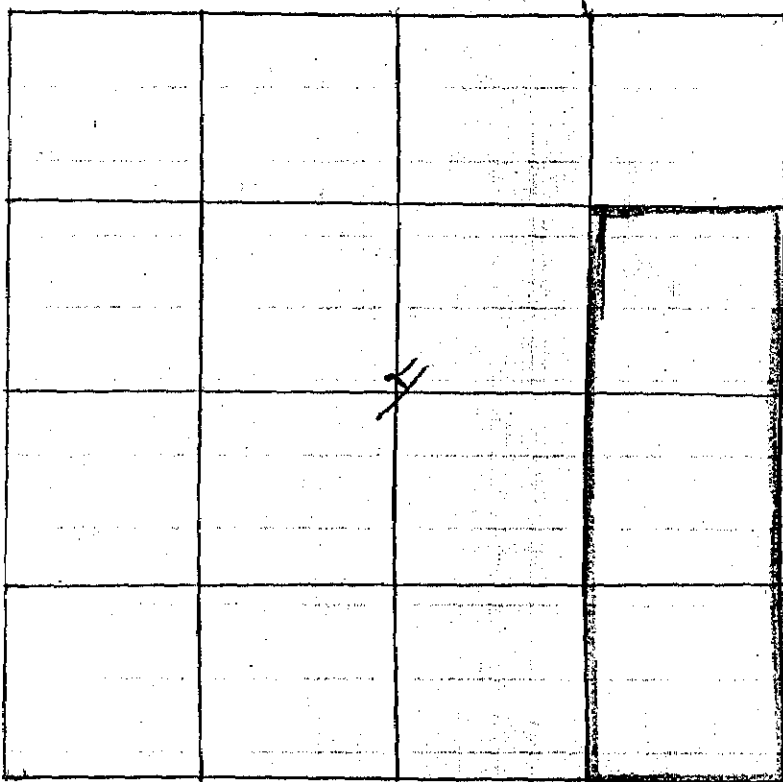

Arthur Curtis