

Township 1 North Range 39 East Union County, Oregon.

J. D. Guile et al Done Sept 20 & 21<sup>st</sup> 1892

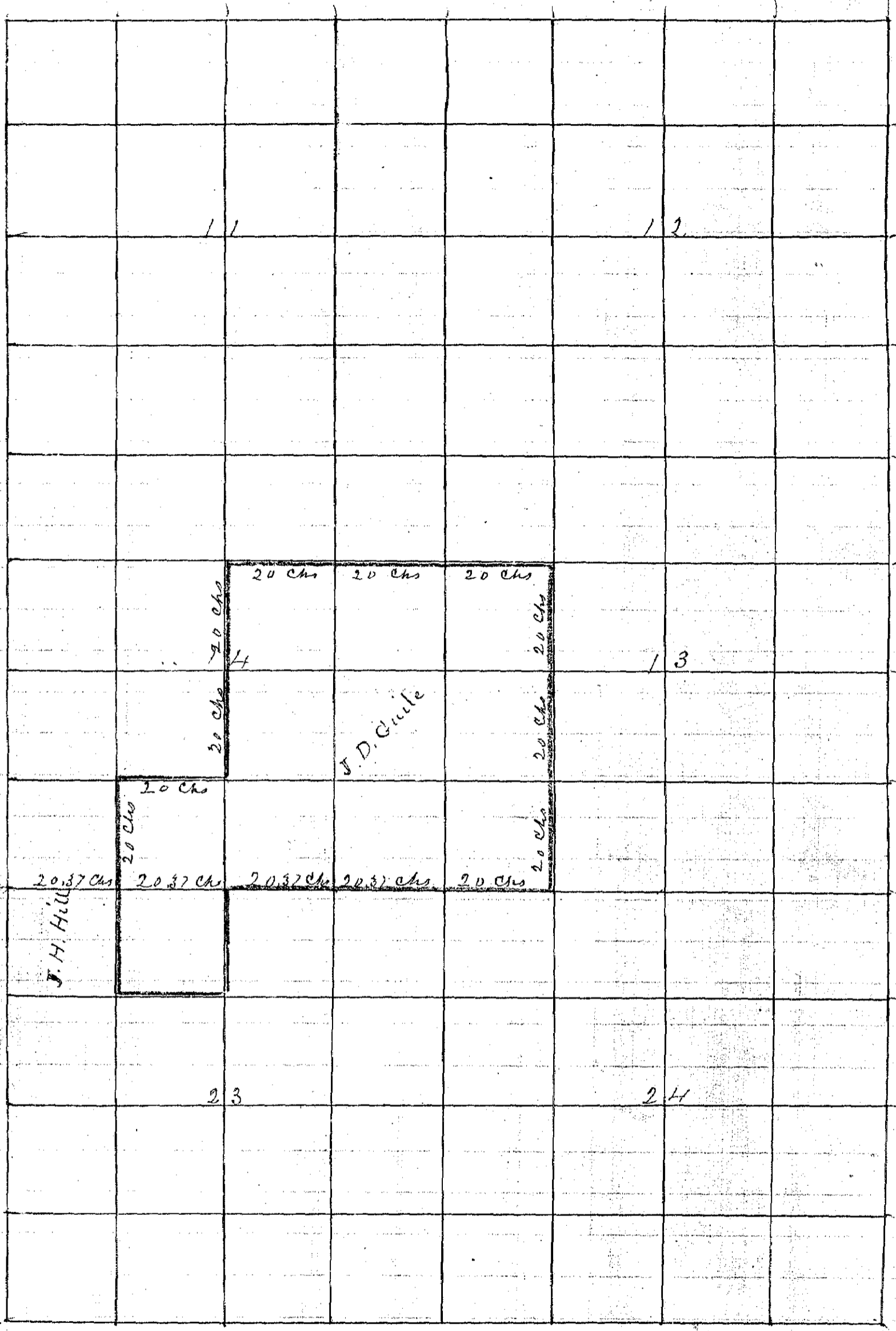

From Meas  
Line 20°36' to 20°45' East

From the Sec corner between Secs 13 x 14 & 23 & 24 W Van 20°30' E

- 20 00 Set Temporary 1/8 corner
- 40 00 " " 1/4 " no Government corner being found
- 60 00 " " 1/8 "
- 85 49 " " Sec corner for Secs 14 x 15 x 22 & 23

Note: I first measured from the 1/4 sec corner between Secs 15 & 22 E Van 20°45' E 3159 Chs to the West bank of the River and set a Flag and in morning West I intersected

RECORD OF SURVEY

Township

Range

Union County, Oregon.

CHAINS.

LKS.

The Flag 32 Lks North: I then measured across the River to the Flag and found the Distance 10.00 Chs making an excess of 149 Lks I then ran East on true line N 89°30' E

20 37 Set 1/8 corner a Rock 6x10x12 Thence East

40 74 Set 1/4 Sec corner a Rock 10x16x48 "

61 11 " 1/8 corner a Rock in mound of Rock Thence East-

81 48 intersect the corner between Sec 13x44x23&24 " "

20 00 Set Rock in mound of Rock for corner to SE corner of SW<sup>4</sup> of SW<sup>4</sup> of Sec 13

From the SW corner of the NW<sup>4</sup> of SW<sup>4</sup> Sec 14 N Var 20°30'

20 00 Set Rock in mound of Rock Thence East

20 00 " " " " " " for 1/16 corner Thence N

20 00 " " " " " " " " " "

20 00 " " " " a solid Rock 1/8 " " East

40 00 Set Temporary corner

From the corner between 11x12x13&14 South

20 00 intersected the line running East and Set corner Thence East

20 00 Set Rock 8x10x14 for NE corner of NW<sup>4</sup> of T-W<sup>4</sup> Sec 13 Thence South

60 00 intersect corner to SE corner of SW<sup>4</sup> of SW<sup>4</sup> Sec 13