

RECORD OF SURVEY

N^o 135

Township 2 South Range 39 East Union County, Oregon.

G W Gray and Wm Randall

This survey was made on July 13th 1891 and was made as follows To wit, I commenced at the S E corner of Sec 1 and ran W on a Var of 21° East intersected high Bluff of Rocks and offset to the N from thence W

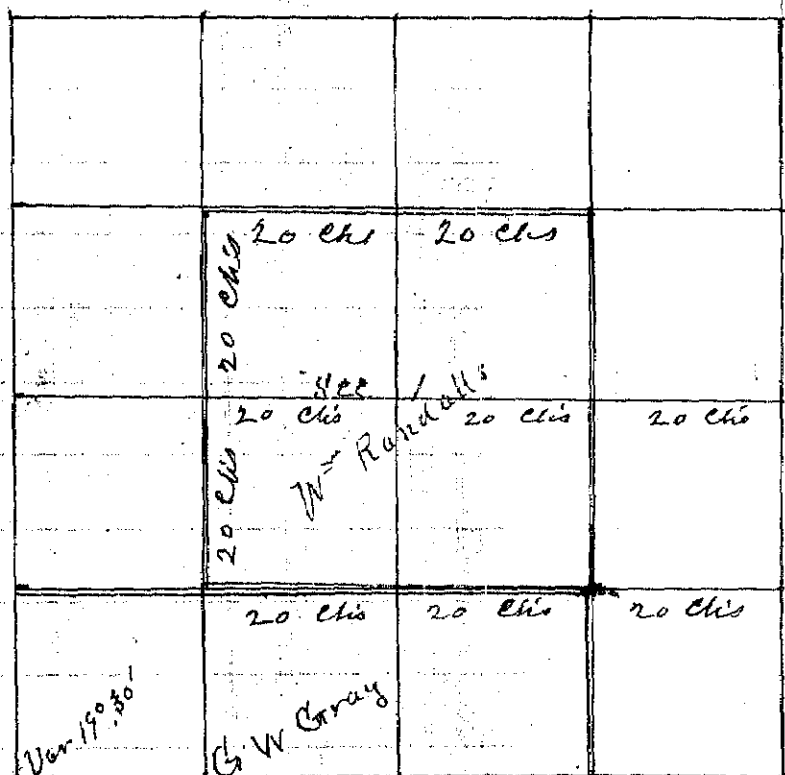
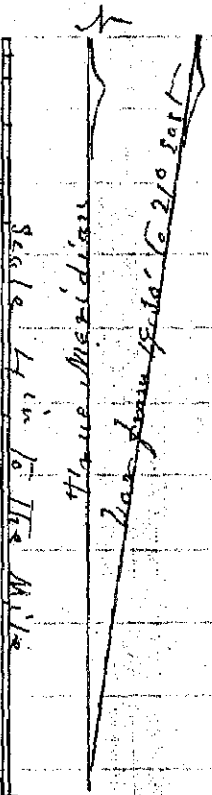

488
20
35-12
20
20
20
20
40
34
6
40

and established line for the centre of the East half of Sec 1 from thence I ran N Var 21° E and set temporary stake for centre of E² of Sec 1 From the 1/4 sec corner between Secs 1 and 6 I ran W Var 21° E intersected line running N and established corner for S E corner of the S W⁴ of N E⁴ Sec 1 Thence S Var 21° E set temporary stake for corner From the S E corner of the N E⁴ of S E⁴ Sec 1 W Var 21° E set corner for the centre of the S E⁴ Sec 1 A tree marked on four sides and marked 1/16 From the centre of E² of Sec 1 N Var 21° E set Post in mound of Rock A Pine Tree 12 in in diam bearing N 87° W 22 links distant From thence W Var 21° E set Post for centre of N W⁴ Sec 1 From centre of S E⁴ Sec 1 W Var 21° E came to Bluff Offset 6 chs N and ran W intersected the N and S centre line in the W half of Sec 1 Thence N Var 19° 30' intersect the centre corner of the N W⁴ of Sec 1

J L Curtis
Surveyor