

RECORD OF SURVEY

No. 107

Township 3 South

Range 38 East

Union County, Oregon.

N. Blum

April the 18th 1890

CHAINS.

LKS.

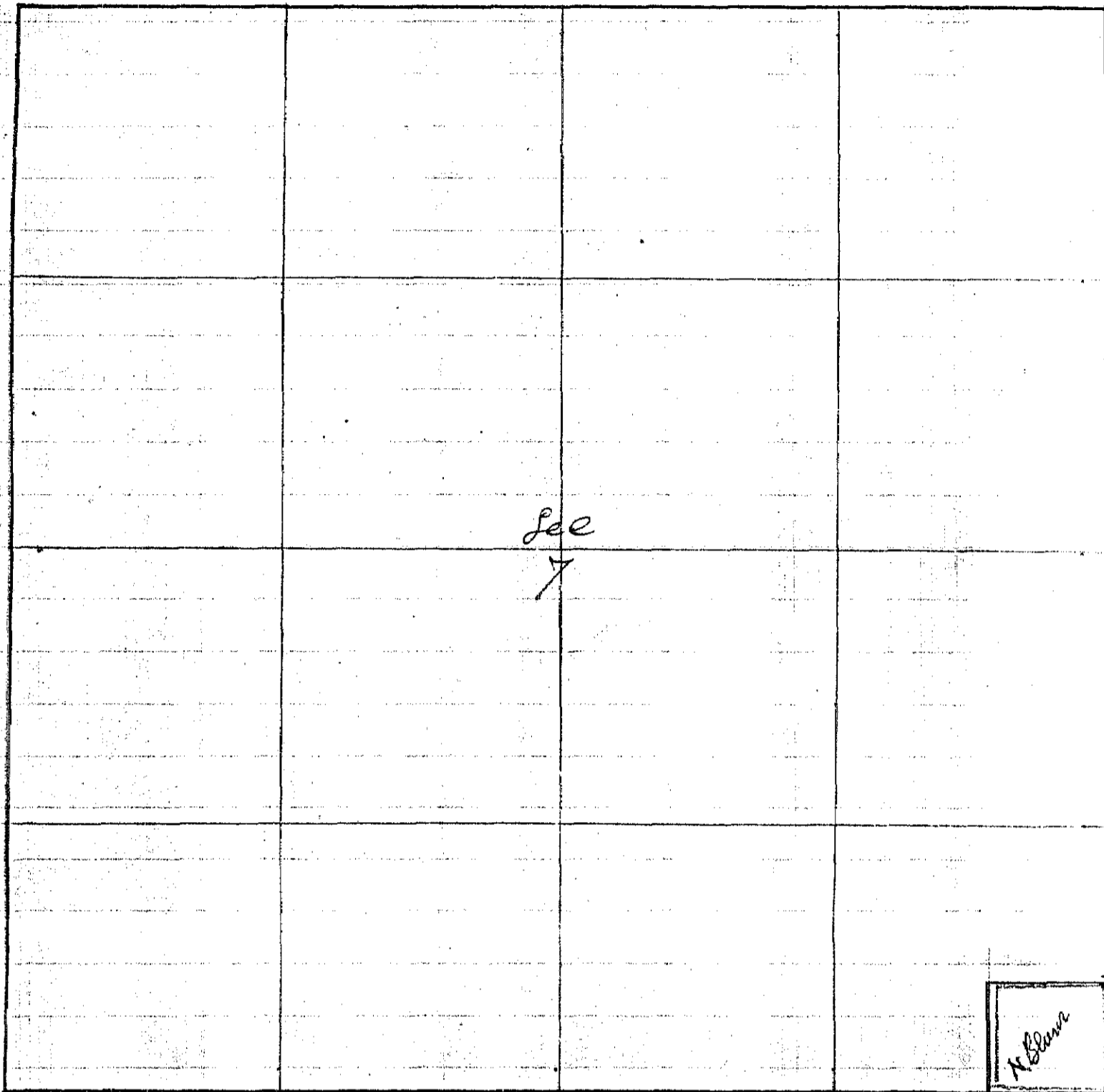

I Commenced at the corner to Sec 7-8-17-18
 Thence North on Sec. line to Sec 7 1/2
 on 20° E

- 4 10 Lake 181 Acs across
- 7 26 Set Post for corner No 2
Thence west
- 8 08 Set Post for corner No 3
Thence South
- 7 26 Set Post for corner No 4
Thence East-
- 8 08 to Piece of Beginning corner No 1

J.W. Kimbrell County Surveyor