

Township 9 South

Range 45 East W M

Union County, Oregon.

Jogan Saunders & Joseph Beck

March the 24th 1890

I commenced at the $\frac{1}{4}$ Sec corner
bet Sec 11 & 14

thence South through Sec 14
Var 21° E

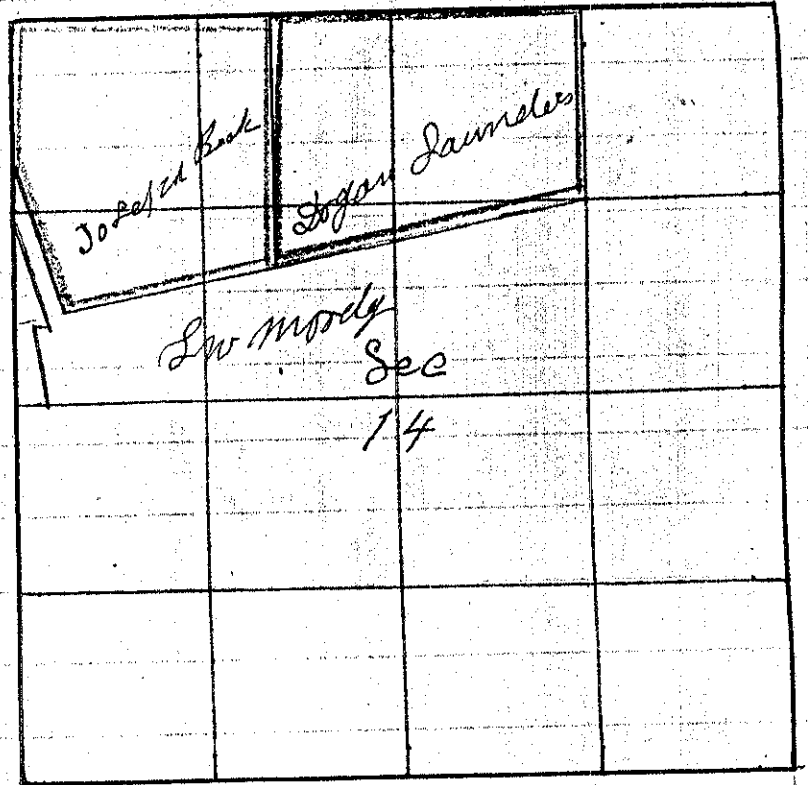

20 00 Set Temporary $\frac{1}{16}$ corner

24 27 wire fence SW & NE
County Road

25 71 wire fence SW & NE

40 00 Set Temporary center Sec 14

40 28 wire fence E & W

41 05 Rail fence NW

60 00 Set Temporary $\frac{1}{16}$ corner

70 06 Rail fence NW & SE

80 63 Intersect 27 lks west of the $\frac{1}{4}$ Sec corner bet Sec 14 & 23
thence N $11\frac{1}{2}^{\circ}$ W on true line through Sec 14

The $\frac{1}{4}$ Sec corner bet Sec 13 & 14

thence West through Sec 14
Var 20° E

20 00 Set Temporary $\frac{1}{16}$ corner

39 93 Intersect true N & S line 34 lks North of 1st Stake at Center

80 26 Intersect 68 lks North of the $\frac{1}{4}$ Sec corner bet Sec 14 & 15
thence N $89^{\circ} 31'$ E on true line through Sec 14

40 29 Set Post for center Sec 14

60 27 $\frac{1}{2}$ Set Post for $\frac{1}{16}$ corner in center E $\frac{1}{4}$ Sec 14

80 26 The $\frac{1}{4}$ Sec corner bet Sec 13 & 14

The center Sec 14

thence North through N $\frac{1}{2}$ Sec 14

40 24 The $\frac{1}{4}$ Sec corner bet Sec 11 & 14

thence East bet Sec. 11 & 14

20 00 Set Temporary $\frac{1}{8}$ corner

40 21 Intersect 29 lks South of corner to Sec 11 = 12 = 13 & 14
thence S $89^{\circ} 35'$ W on true line bet Sec 11 & 14

20 10 $\frac{1}{2}$ Set Post for $\frac{1}{8}$ corner

thence South through N $\frac{3}{4}$ Sec 14

40 31 The $\frac{1}{16}$ corner in center E $\frac{1}{4}$ Sec 14

thence North through center N $\frac{3}{4}$ Sec 14

20 15 $\frac{1}{2}$ Set Stone 6 + 8 + 20 for center N $\frac{3}{4}$ Sec 14