

No. 99

Township 3 South

Range 38 East W. M.

Union County, Oregon

Charles McConnell

Nov. 20<sup>th</sup> 1889

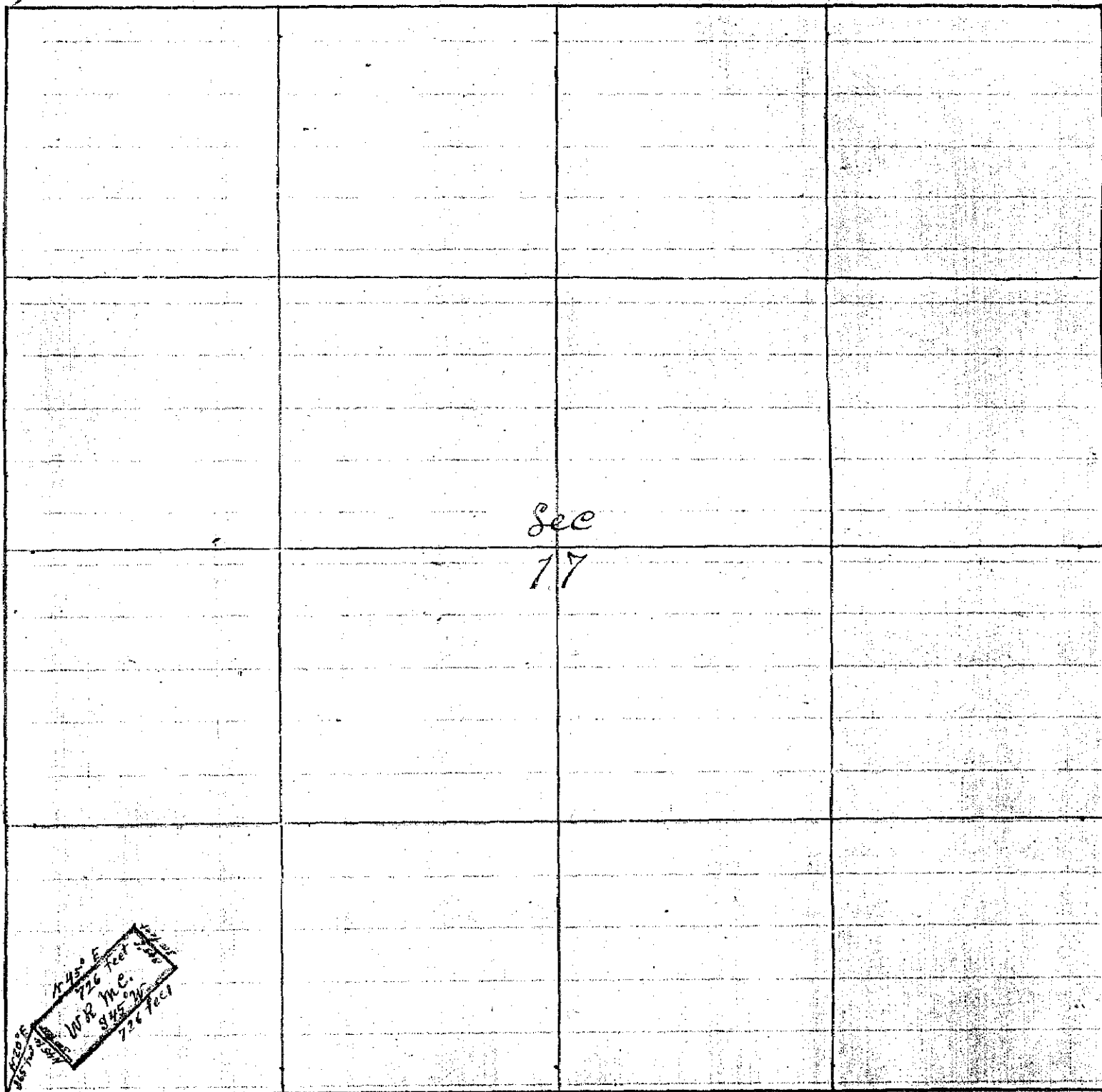

Beginning at a Point in the SW 1/4 SW 1/4 Sec 17  
 a Pine Tree 48 inches diameter Marked W. R. M. C. No. 1  
 from which

The corner to Sec 17=18=19 & 20 by S 20° 45' W 365 feet distant.

Thence S 45° E 300 feet corner No. 2

" N 45° E 726 " " No. 3

" N 45° W 300 " " " 4

" S 45° W 726 " " " 1 To Place of Beginning

J. W. Keim Full County Surveyor