

RECORD OF SURVEY

No. 96

Township 7 South

Range 45 East W.M.

Union County, Oregon.

CHAINS.

LKS.

R. H. Boyles and John Curry Nov. 8 1889

I Commenced at the 1/4 Sec
Corner bet Sec 1 & 36 on
T₁₀ line bet T₇ & 8
Thence west bet Sec 1 & 36
Var 27° E

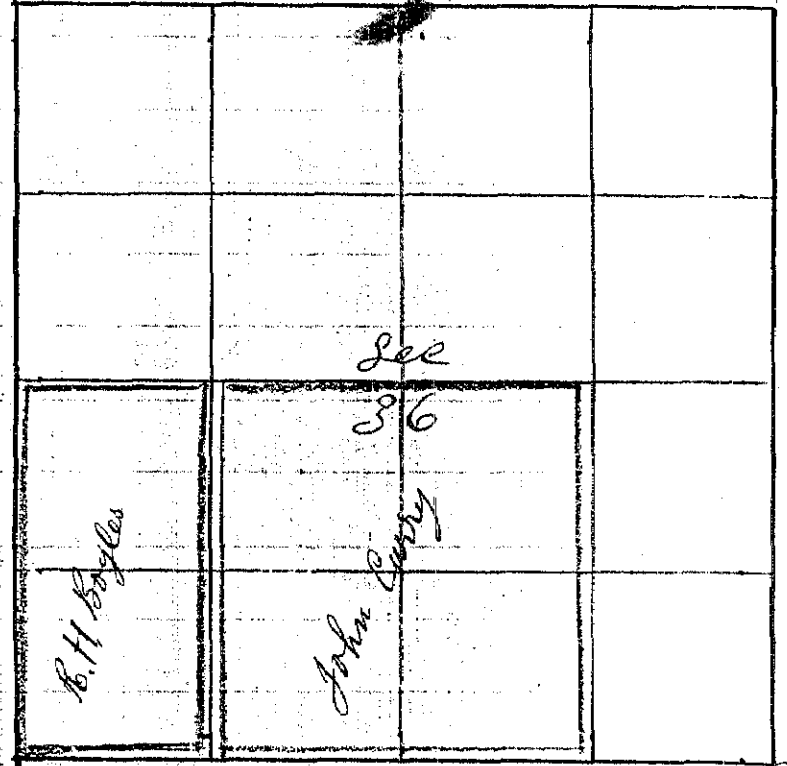

20 00 Set Temporary 1/8 corner

40 07 Intersect 20 lks south of the
corner to Sec 1-2-35-36
Thence S 89° 43' E

on true line bet Sec 1 & 36

20 03 1/2 Set Stone 10 + 10 + 18 for 1/8 corners

40 07 the 1/4 Sec corner bet Sec 1 & 36

on cottonwood from which
a Balm 6 inches dia. bet S 68 1/2° E 28 lks dist

The 1/4 Sec corner bet Sec 35 & 36

Thence East through W 1/2 Sec 36

Var 21° E

1 94 Mining Gulch 192 lks across course S E

20 00 Set Temporary 1/16 corner

41 11 Intersect at center Sec 36

Thence west

20 55 1/2 Set Post marked 1/16 for center W 1/2 Sec 36

from which

a cottonwood 14 inches dia. bet S 78 1/2° W 108 lks dist

41 11 the 1/4 Sec corner bet Sec 35 & 36

J. W. Kimball County Surveyor