

CHAS. LKS. P. E. Wade Sam Brooks and J. S. Clark Oct the 22 1889

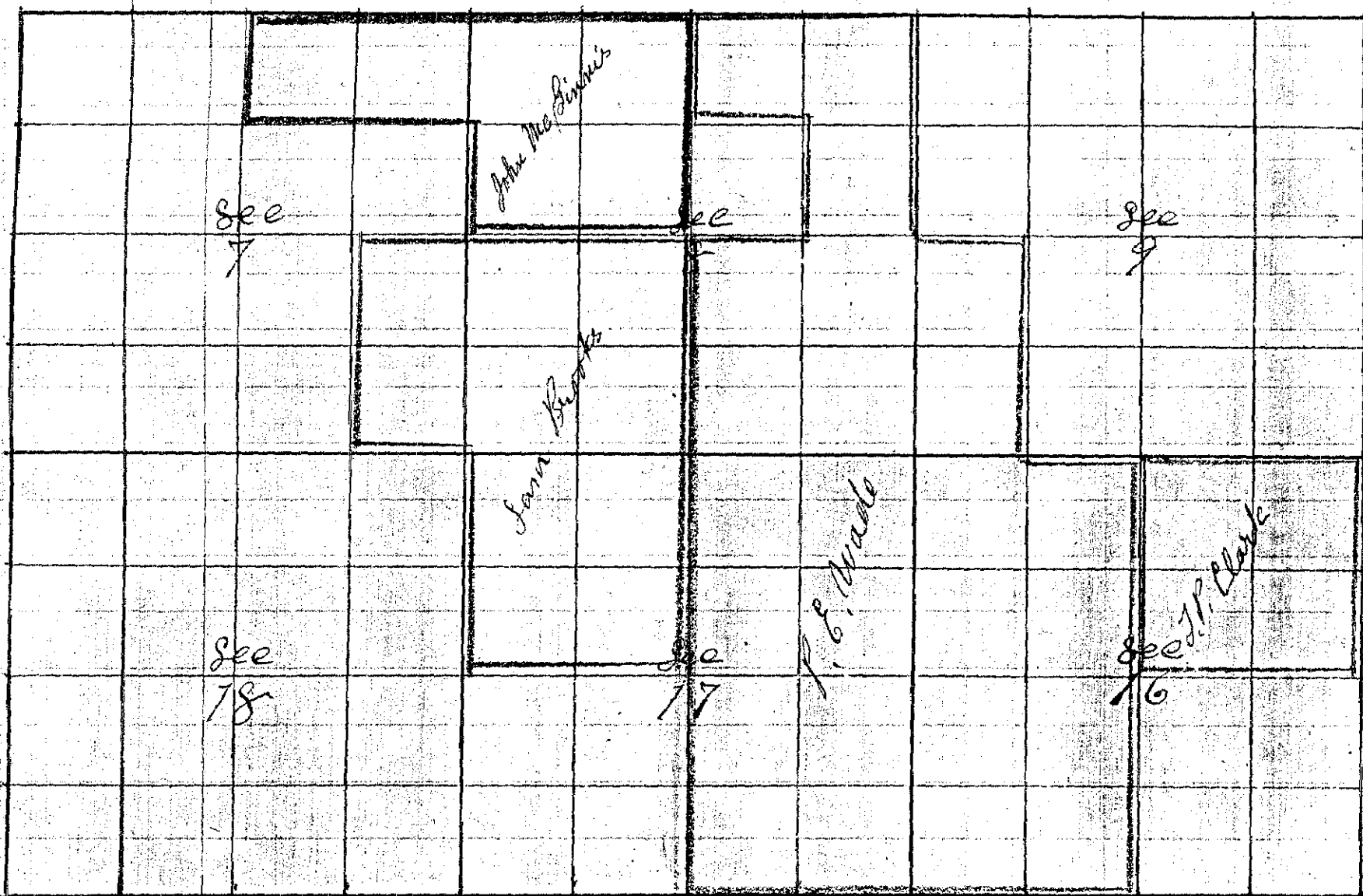

I Commenced at the corner to Sec. 6=7=12 & 12  
on Range Line bet Ranges 38 & 39  
Thence South bet Sec 7 & 12  
Var. 20° E.

40 00 Set Temporary 1/4 Sec corner

80 10 The corner to Sec 7=18=12 & 18

Post decayed Set Stone 5 x 16 x 30 for corner to Sec 7=18=12 & 18

Thence North bet Sec 7 & 12

40 05 Set post in middle of County Road for 1/4 sec corner to Sec 7 & 12

80 10 The corner to Sec 1=6=7 & 12

The corner to Sec 7=18=12 & 18

Thence East bet Sec 7 & 18

Var 20° E

38 52 Set Temporary 1/4 Sec cor

51 38 Willow creek 75 lks across Course N. E.

58 52 Set Temporary 1/8 corner

78 52 Set Temporary corner to Sec 7=8=17 & 18

Thence East bet Sec 8 & 17

Var 20° E

40 00 Set Temporary 1/4 Sec cor

80 00 Set Temporary cor to Sec 8=9=16 & 17

Township 1 South

Range 39 East

Union County, Oregon.

CHANCE	L.S.	DESCRIPTION
		Thence East bet Sec 9 & 16
19	50	Set Temporary 1/8 corner var 20° E
39	50	Set Temporary 1/4 Sec corner
71	10	The corner to Sec 9 = 10 = 15 & 16
		Making an excess of 190 lbs as per U.S. Field Notes
		I therefore run West bet Sec 9 & 16
39	91	Set Stone 8 x 12 x 27 for 1/4 Sec corner bet Sec 9 & 16
59	86	Set Stone 6 x 12 x 22 for 1/8 corner
79	82	Set Stone 6 x 15 x 22 for corner to Sec 8 = 9 = 16 & 17
		Thence West bet Sec 8 & 17
40	82	Set Stone 6 x 10 x 15 for 1/4 Sec corner bet Sec 8 & 17
80	64	Set Stone 5 x 14 x 23 for corner to Sec 7 = 8 = 17 & 18
		Thence West bet Sec 7 & 18
20	16	Set Stone 3 x 10 x 16 for 1/8 corner
40	32	Set Post for 1/4 Sec corner bet Sec 7 & 18
79	16	The corner to Sec 7 = 18 = 12 & 13
		The corner to Sec 4 = 5 = 8 & 9
		Thence South bet Sec 8 & 9
		var 21° 30' E
40	50	Set Temporary 1/4 Sec corner
80	39	The corner to Sec 8 = 9 = 16 & 17
		Thence South bet Sec 16 & 17
		var 20° E
40	00	Set Temporary 1/4 Sec cor
80	39	The corner to Sec 16 = 17 = 20 & 21
		Thence North 12' W. on zero line bet Sec 16 & 17
		var 20° E
40	19 1/2	Set Stone 6 x 12 x 19 for 1/4 Sec corner bet Sec 16 & 17
80	39	The corner to Sec 8 = 9 = 16 & 17 a Stone 6 x 15 x 22
		Thence North bet Sec 8 & 9
		var 20° E
40	19 1/2	Set Stone 6 x 15 x 25 for 1/4 Sec corner bet Sec 8 & 9
80	39	The corner to Sec 4 = 5 = 8 & 9
		The 1/4 Sec corner bet Sec 6 & 7
		Thence South through Sec 7
		var 20° E
20	00	Set Temporary 1/6 corner
40	00	Set Temporary center Sec 7
80	10	Intersect 26 lbs East of 1/4 Sec cor bet Sec 8 & 9

CHAINS.	LKS.	
		Hence North $11^{\circ} E$ Through Center Sec 7 Var $20^{\circ} E$
40	05	Set Post for center Sec 7
60	07 1/2	Set Stone $6 \times 7 \times 32$ for $1/4$ corner in center N 1/2 Sec 7
80	10	The $1/4$ Sec corner bet Sec 6 & 7
		The $1/4$ Sec corner bet Sec 17 & 18 Hence North bet Sec 17 & 18 Var $20^{\circ} E$
40	07	The corner to Sec 7 = 8 = 17 & 18 Hence North bet Sec 7 & 8 Var $20^{\circ} E$
40	00	Set Temporary $1/4$ Sec corner
80	12	The corner to Sec 5 = 6 = 7 & 8 Hence South
14	97	Center of Willow creek course East Set Stone $10 \times 10 \times 25$ on North or Left Bank of Willow Creek 25 lks North of True $1/4$ corner which is in the center of Willow creek
40	06	Set Stone $5 \times 14 \times 23$ for $1/4$ Sec corner
80	12	The corner to Sec 7 = 8 = 17 & 18 The $1/4$ Sec corner bet Sec 8 & 9 Hence West Through Sec 8 Var $20^{\circ} E$
40	00	Set Temporary Center Sec 8
80	42	Intersect 17 lks North of $1/4$ Sec cor bet Sec 7 & 8 Hence $N 89^{\circ} 58' W$ on True line Through Sec 8
40	46	Set Stone $5 \times 8 \times 15$ for center Sec 8
80	92	The $1/4$ Sec cor bet Sec 8 & 9 The $1/4$ Sec corner bet Sec 8 & 17 Hence North Through Sec 8 Var $20^{\circ} 30' E$
40	13	Intersect E & W line
69	12	Bluff on South Side of Willow Creek
80	23	The $1/4$ Sec cor bet Sec 5 & 8 The corner to Sec 16 = 17 = 20 & 21 Hence East bet Sec 16 & 21 Var $20^{\circ} E$

37 57  
46 57  
60 00  
79 14  
11 40  
40 26  
40 08  
39 65  
79 70

Hence East set Sec 16 & 21. var 20 1/4° E  
found no 1/4 Sec cor Set Temporary 1/4 Sec cor  
left Bank of Grand Round river course N 85° E  
Offset 150 lks North  
Hence East on offset  
Set back 150 lks South on line  
found no Sec cor Set Temporary corner to Sec 15 = 16 = 21 & 22  
Hence East  
Grand Round River 168 lks across Course N 10° W  
The 1/4 Sec corner set Sec 15 & 22  
Hence West set Sec 15 & 22  
Set Stake for corner to Sec 15 = 16 = 21 & 22  
Hence west set Sec 16 & 21  
Set Stone 5 x 12 x 22 for 1/4 Sec cor set Sec 16 & 22  
The corner to Sec 16 = 17 = 20 & 21

The corner to Sec 9 = 10 = 15 & 16

Hence South on Offset of 10 Chains

West of corner

40 00  
80 00  
9 08  
40 00  
80 50  
40 00  
80 92

Set back East 10 chains to line  
Set Temporary 1/4 Sec corner  
Set Temporary corner to Sec 15 = 16 = 21 & 22  
Hence South set Sec 21 & 22  
Grand Round River 238 lks across course East  
found no 1/4 Sec corner  
found no Sec cor  
Hence South set Sec 27 & 28  
found no 1/4 Sec cor  
The corner to Sec 27 = 28 = 33 & 34

Making an excess of 92 lks over US Field Notes

Hence North allowing 62 lks as an excess set  
Sec 27 & 28 and 21 & 22 and set Post  
for corner to Sec 15 = 16 = 21 & 22

Hence North set Sec 15 & 16

20 07 1/2  
40 15  
80 30

Set Stone 5 x 12 x 23 for 1/4 corner  
Set Stone 5 x 16 x 22 for 1/4 Sec corner set Sec 15 & 16  
The corner to Sec 9 = 10 = 15 & 16

The 1/4 Sec corner set Sec 15 & 16

Hence West through Sec 16

var 20° E

Township 1 South

Range 39 East

Union County, Oregon.

CHAINS.

LKS.

40 00 Set Temporary Center Sec 16.

79 70 Intersect 7 Ecs. North of the 1/4 Sec corner bet Sec 16 & 17  
Thence N 89° 57' E on same line

39 85 Set Temporary center Sec 16.

79 70 The 1/4 Sec corner bet Sec 15 & 16

The 1/4 Sec corner bet Sec 9 & 16

Thence South through Sec 16

(or 20° E)

40 17 Intersect E & W line at center

80 37 Intersect - South Boundary at the 1/4 Sec Cor bet Sec 16 & 21

Thence North through center Sec 16

40 17 Set Stone 10 x 12 x 23 for Center Sec 16

J. W. Kimbrell County Surveyor