

RECORD OF SURVEY

No. 91

191  
1889

Township 15. N 1 North

Range 39 East W. M.

Union County, Oregon.

J. K. P. Harris & Co. A. C. Eaton and John Bennett Oct. 14 1889

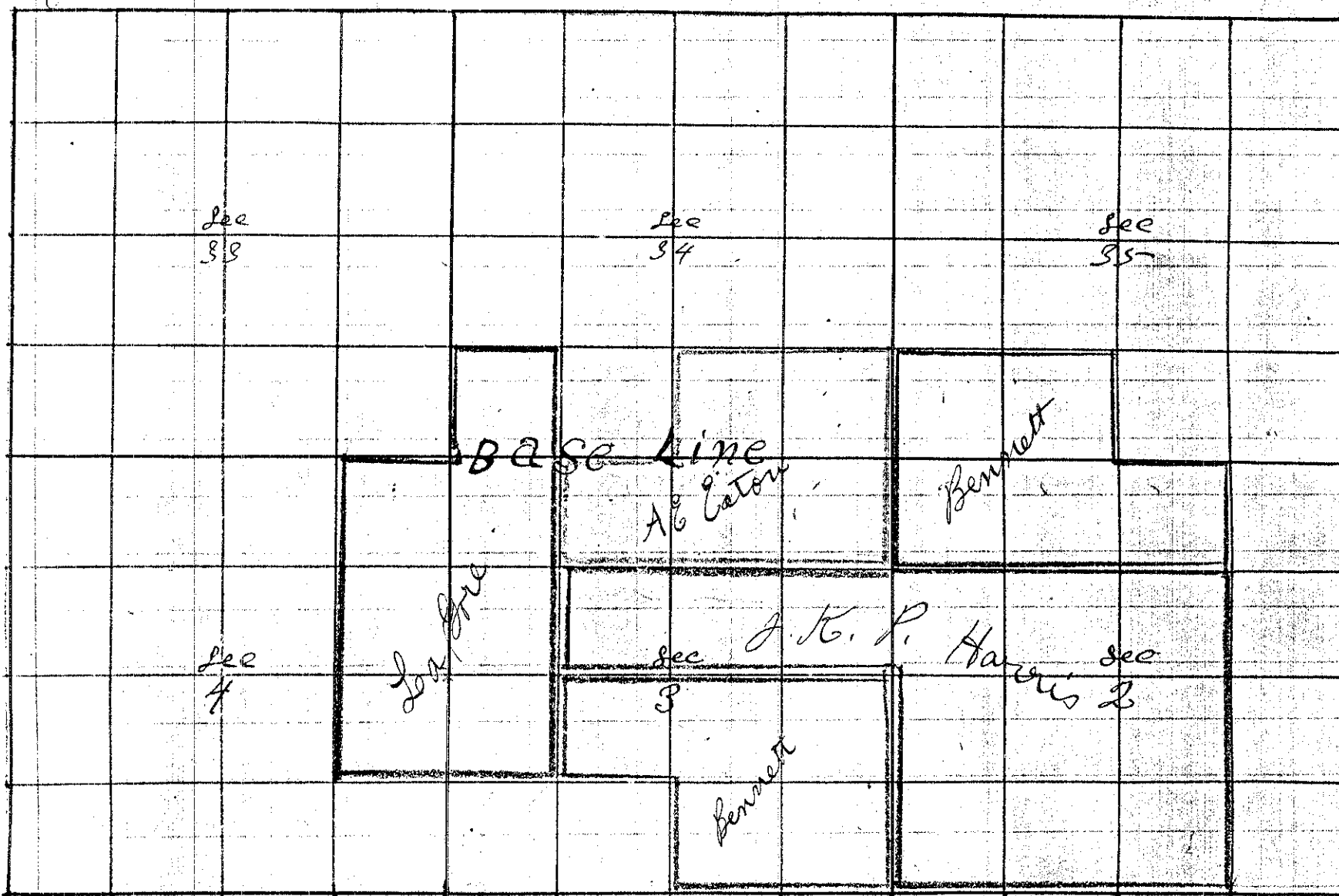

I Commenced at the corner of Sec 3 = 4 = 33 & 34 on the Base line

Thence South bet Sec 3 & 4

Var 24° 30' E

19 34 Set Temporary 1/4 corner

37 34 Set Temporary 1/4 Sec cor

59 34 Set Temporary 1/8 corner

79 34 found no Sec cor. Set Temporary corner to Sec 3 = 4 = 9 & 10

Thence South bet Sec 9 & 10

Var 20° E

11 89 Grande Round River 200 lbs across Course East

40 53 found no 1/4 Sec cor

43 76 Grande Round River 460 lbs across Course N 20° W

81 08 Intersect 77 lbs west of corner to Sec 9 = 10 = 15 & 16

Thence N 16° W

80 54 Set 4 x 13 x 24 for corner to Sec 3 = 4 = 9 & 10

Thence North bet Sec 3 & 4

20 13 1/4 Set Stone 4 x 7 x 34 for 1/8 cor

40 27 Set Stone 8 x 14 x 32 in mound of Stone for 1/4 Sec cor bet Sec 3 & 4

60 41 Set Stone 6 x 22 x 26 " for 1/8 cor

79 88 The corner of Sec 3 = 4 = 33 & 34

## RECORD OF SURVEY

Township 1 South &amp; 1 North

Range 39 East

Union County, Oregon.

CHAINS.

LKS.

The corner of Sec 4 = 5 = 8 &amp; 9

Thence East bet Sec 4 &amp; 9

for 21° E

5	00	Spring Branch Course South
9	00	foot of Hill as said
39	72	Set temporary $\frac{1}{4}$ Sec corner
59	58	Set temporary $\frac{1}{8}$ corner
79	65	The corner of Sec 3 = 4 = 9 & 10
		Thence East bet Sec 3 & 10
19	87	Set temporary $\frac{1}{8}$ corner for 20° E
26	04	Grande Round River 215 lks across course North
39	90	The $\frac{1}{4}$ Sec corner bet Sec 3 & 10
		Thence West bet Sec 3 & 10
19	95	Set stake for $\frac{1}{8}$ corner
39	90	The corner to Sec 3 = 4 = 9 & 10
		Thence West
19	90	Set Stone 6 x 12 x 30 for $\frac{1}{8}$ corner
39	80	The $\frac{1}{4}$ Sec corner
79	65	The corner to Sec 4 = 5 = 8 & 9
		The corner of Sec 3 = 4 = 33 & 34
		Thence West bet Sec 4 & 33
20	50	Set temporary $\frac{1}{8}$ corner
40	23	Intersect $\frac{1}{4}$ Sec corner bet Sec 4 & 33
		Thence East
20	11 $\frac{1}{2}$	Set Stone 4 x 12 x 36 for $\frac{1}{8}$ corner
		Thence South through $\frac{1}{16}$ Sec 4
60	00	Set temporary $\frac{1}{16}$ corner for 21° 30' E
80	09	Intersect 42 lks East of $\frac{1}{8}$ corner on boundary of $\frac{1}{4}$ Sec 4
		Thence North through $\frac{1}{16}$ Sec 4
20	03	Set Stone 8 x 12 x 24 for $\frac{1}{16}$ corner in center of $\frac{1}{4}$ Sec 4
		The $\frac{1}{4}$ Sec corner bet Sec 3 & 4
		Thence East through Sec 3
20	00	Set temporary $\frac{1}{16}$ corner
31	30	Grande Round River 587 lks across course N 80° E

H.M.C. L.S.

The corner to Sec 3-4-33 & 34

Hence East on Baseline bet Sec 3 & 34  
Var 24° 30' E

9 50 Road Course N & S

15 40 Grande Round River 225 lks across Course North

20 00 Set Temporary 1/8 cor

30 78 The corner to Sec 2-3-34 & 35-

Hence West bet Sec 3 & 34

67 58 Set Stone 6 x 17 x 27 for 1/8 cor

The corner to Sec 2-3-34 & 35- on Baseline

Hence South bet Sec 2 & 3

Var 19° E

19 20 Set Temporary 1/8 corner

39 20 Set Temporary 1/4 Sec corner

79 20 The corner to Sec 2-3-10 & 11

Hence North

40 00 Set Stone 6 x 6 x 20 for 1/4 Sec corner bet Sec 2 & 3

60 00 Set Stone 6 x 8 x 37 for 1/8 cor

Hence West through N 1/2 Sec 3

Var 21° E

42 50 Point of Rock Cliff Telescope measurement 690 lks to  
Second Cliff

56 35 Grande Round River 327 lks across Course N 25° W

60 50 Set Temporary 1/16 corner

83 80 The 1/8 cor on West Bdy NW 1/4 Sec 3

The 1/8 corner on North Boundary NW 1/4 Sec 3

Hence South through W 1/2 Sec 3

Var 22° 30' E

14 53 Grande Round River 455 lks across Course N 10° W

19 25 Intersect E & W line 14 lks west of first Stake for center NW 1/4

54 33 Set Temporary 1/16 cor

59 38 Set Temporary 1/16 cor

72 04 Intersect South Bdy Sec 3 155 lks East of 1/8 corner

Hence North

20 10 Set Willow Post 4 feet long and 4 inches dia. for 1/16  
Corner in center S W 1/4 Sec 3

40 27 Stone 7 x 12 x 24 for 1/16 cor in center W 1/2 Sec 3

60 27 Set Stone 4 x 18 x 32 for 1/16 cor in center NW 1/4 Sec 3

79 64 The 1/8 cor on North Boundary NW 1/4 Sec 3

Township 7 North & 1 South Range 39 East Union County, Oregon.

CHAINS.	LKS.	
		The Corner to Sec 3=4=33 & 34 Thence North bet Sec 33 & 34
40	96	The 1/4 Sec corner bet Sec 33 & 34 Thence South
20	48	Set 1/8 corner
40	96	The line to Sec 3=4=33 & 34
		The corner to Sec 2=3=34 & 35 - on Base Line Thence North bet Sec 34 & 35 -
40	62	The 1/4 Sec corner bet Sec 34 & 35 - Thence South
20	31	Set Stone 6 x 16 x 44 in mound of Stone for 1/8 corner Thence West through S 1/2 Sec 34 Cor 20° E
29	88	Top of Rocky Bluff East of Grand Round River
31	92	Right Bank of Grand Round River
34	46	Left Bank of Grand Round River
40	00	Set Temporary center S 1/2 Sec 34
60	00	Set Temporary 1/16 corner
80	96	The 1/8 corner on west boundary S W 1/4 Sec 34 Thence East through center South 1/2 Sec 34
20	23	Set Post in mound of Stone for 1/16 corner in center S W 1/4
40	46	Set Stone in mound of Stone for center S 1/2 Sec 34
		The corner to Sec 1=2=35 & 36 on Base Line Thence West bet Sec 2 & 35 - Cor 21° E
20	00	Set Temporary 1/8 corner
40	00	Set Temporary 1/4 Sec corner
80	36	The corner to Sec 2=3=34 & 35 - Thence East bet Sec 2 & 35 -
40	18	Set Stone 8 x 16 x 19 for 1/4 Sec Cor bet Sec 2 & 35 -
60	27	Set Post in mound of Stone for 1/8 corner
80	36	The corner to Sec 1=2=35 & 36 Post decayed Set Stone 6 x 9 x 25 for corner to Sec 1=2=35 & 36 Thence South bet Sec 1 & 2 Cor 19° 45' E
20	00	Set Temporary 1/8 corner
80	75	The corner to Sec 1=2=11 & 12

Township 1 North 41 South

Range 39 East

Union County, Oregon.

Thence North bet Sec 1 & 2

60 45 1/2 Set Stone 7 x 10 x 22 for 1/8 corner

50 75 The corner to Sec 1 = 2 = 3 & 36

The 1/8 corner on West Boundary NW 1/4 Sec 2

Thence East through center NE 1/4 Sec 2  
var 21° E

00 50 Set Temporary 1/16 corner

80 18 The 1/8 corner on East Boundary NE 1/4 Sec 2

Thence West through NE 1/4

20 04 1/2 Set Stone 12 x 18 x 26 for 1/16 corner in center NE 1/4 Sec 2

The corner to Sec 1 = 2 = 11 & 12

Thence West bet Sec 2 & 11

var 19° E

20 50 Set Temporary 1/8 corner

40 26 Intersect 26 1/2 Sec South of 1/4 Sec corner bet Sec 2 & 11

Thence S 89° 38' E on true line

20 18 Set Stone 9 x 9 x 31 for 1/8 corner

Thence North through SE 1/4 Sec 2

var 21° E

60 40 The 1/16 corner in center NE 1/4 Sec 2

J. H. Campbell County Surveyor