

J. F. Smith Wm. R. Boothe and A. E. Eaton Aug 27 1889

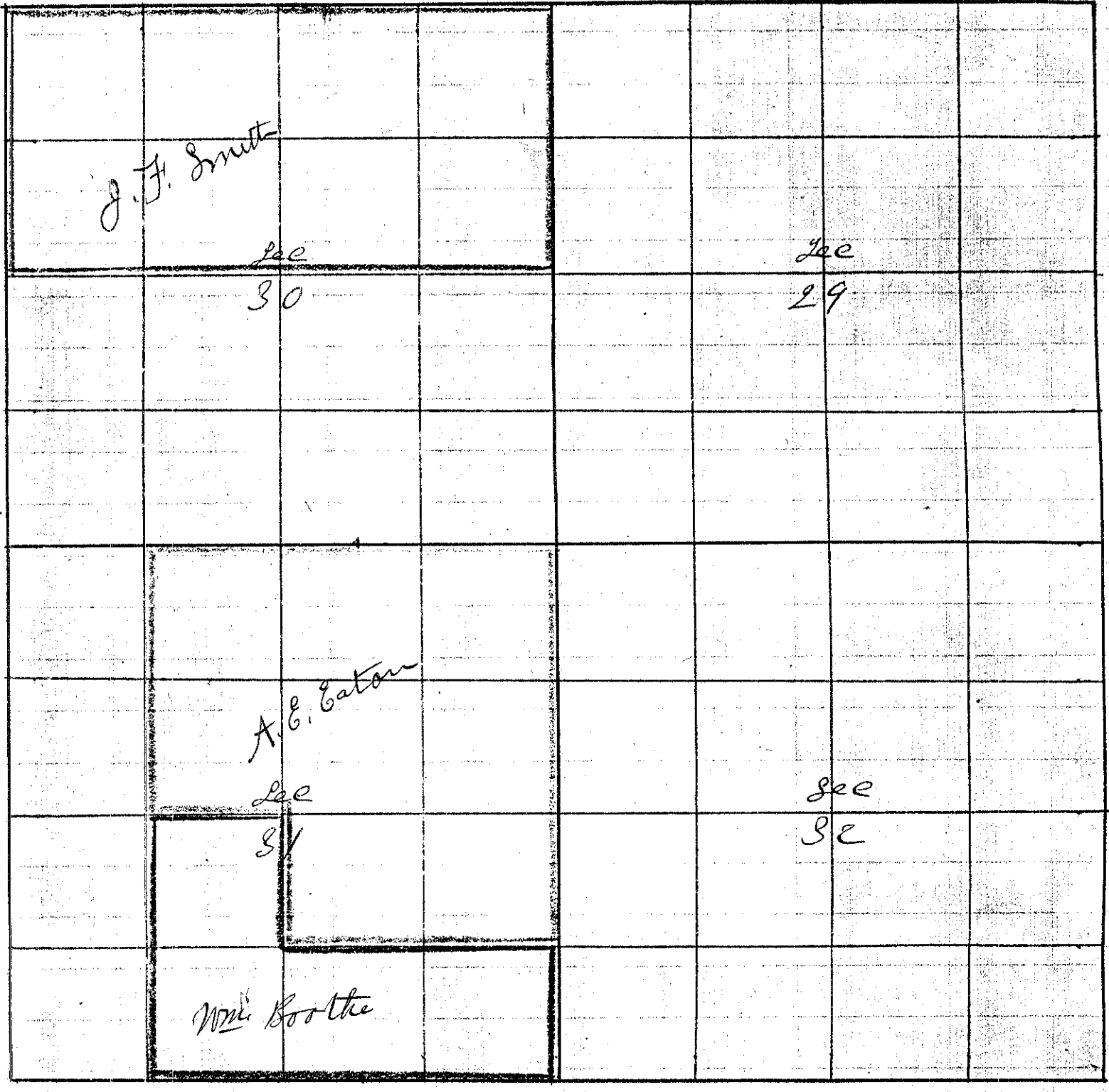

I Commenced at the corner of Sec 20=21=28 & 29  
 Thence South set Sec 28 & 29  
 bearing  $19^{\circ} 45' E$

40 00 found no  $1/4$  Sec corner Set Temporary  $1/4$  Sec corner  
 80 50 found no Sec corner. Set Temporary corner to Sec 28=29=32 & 33  
 Thence South set Sec 32 & 33  
 bearing  $19^{\circ} 45' E$

20 00 Set Temporary  $1/8$  corner  
 40 00 found no  $1/4$  Sec corner Set Temporary  $1/4$  Sec corner  
 60 00 Set Temporary  $1/8$  corner  
 80 84 intersect South Boundary at the cor. to Sec 4=5=32 & 33  
 Thence North

20 10 1/4 Set Stone 6+8+16 for  $1/8$  corner  
 40 21 Set Stone 9+11+20 for  $1/4$  Sec cor. set Sec 32 & 33  
 60 33 1/2 Set Stone 8+9+16 for  $1/8$  cor.  
 80 42 Set Stone 6+8+16 for corner of Sec 28=29=32 & 33  
 Thence North set Sec 28 & 29  
 40 21 Set Stone 11+12+22 for  $1/4$  Sec corner set Sec 28 & 29  
 80 42 The corner to Sec 20=21=28 & 29

| CHAINS. | LKS.   |   |
|---------|--------|---|
|         |        | The corner to Sec 27 = 28 = 33 & 34<br>Thence west set Sec 28 & 33<br>Var 21° 45' E   |
| 80      | 00     | Set temporary corner to Sec 28 = 29 = 32 & 33<br>Thence west set Sec 29 & 32  |
| 40      | 00     | found no 1/4 Sec corner<br>Offset 400 lks North   |
| 58      | 50     | Set back south 200 lks to Grande Round River<br>200 lks across to left bank of River<br>to line thence west on line                         |
| 59      | 70     | Set temporary 1/8 corner  |
| 79      | 60     | found no Sec corner Set temporary corner to Sec 29 = 30 = 31 & 32<br>Thence west - set Sec 30 & 31  |
| 81      | 35     | Intersect west boundary at the corner to Sec 30 = 31 = 25 & 36<br>Making an excess of 135 lks in the 3 miles<br>Thence East set Sec 30 & 31 |
| 80      | 45     | Set stake for corner to Sec 29 = 30 = 31 & 32<br>Thence East  |
| 20      | 02 1/2 | Set Stone 6 x 8 x 20 for 1/8 corner   |
| 80      | 10     | The corner to Sec 28 = 29 = 32 & 33 a stone 6 x 8 x 16 in the   |
|         |        | The corner to Sec 5 = 6 = 31 & 32<br>Thence North set Sec 31 & 32   |
| 40      | 20     | The 1/4 Sec corner set Sec 31 & 32  |
| 80      | 41     | The corner to Sec 29 = 30 = 31 & 32<br>Thence North set Sec 29 & 30   |
| 36      | 34     | Grande Round River 297 lks across course S, W,  |
| 40      | 20     | Set temporary 1/4 Sec corner  |
| 80      | 46     | Went set the corner to Sec 19 = 20 = 29 & 30<br>Thence South  |
| 40      | 22 1/2 | Set Stone 7 x 6 x 21 for 1/4 Sec corner set Sec 29 & 30<br>The 1/4 Sec corner set Sec 31 & 32 Thence East                                   |
| 20      | 03     | Set Stone 6 x 8 x 12 for 1/16 corner in center W 1/2 Sec 32   |
| 28      | 07     | Grande Round River 147 lks across course North  |
| 40      | 10     | Set Post for center   |
| 80      | 22     | Intersect East boundary at 1/4 Sec corner set Sec 32 & 33<br>Thence West  |
| 40      | 11     | Set Stone - 8 x 8 x 21 for center Sec 32<br>Thence South through S 1/2 Sec 32   |
| 40      | 22     | The 1/4 Sec corner set Sec 5 & 32<br>Thence North   |
| 20      | 11     | Set Stone 7 x 8 x 12 for 1/16 corner in center S 1/2 Sec 32<br>McKinnon County, Oregon  |