

Township 4 South

Range 40 East W M

Union County, Oregon.

April the 5th 1889

CHAINS. LKS.

Biddleman and Ostrander
I commenced at the corner
to Sec 19=30=24 & 25 on Guide
Meridian bet Ranges 39 & 4

Thence South bet Sec 30 & 25
Var 20° E

20 00 Set Temporary 1/8 corner

40 00 found no 1/4 Sec corner

Set Temporary 1/4 Sec corner
bet Sec 25 & 30

80 00 found no 1/4 Sec corner

Set Temporary corner
to Sec 30=31=25 & 36

Thence South bet Sec 31 & 36
Var 20° E

81 15 take set 40 lks west of corner to Sec 1=6=31 & 36

Which is also corner to T4 & 5 S 16 39 & 40 E

Thence N 9° W on True line

Var 20° E

80 57 1/2 Set Stone 10 x 10 x 30 in mound of Stone

for corner to Sec 30=31=25 & 36

Thence North bet Sec 25 & 30

40 28 3/4 set Post for 1/4 Sec corner bet Sec 25 & 30

60 44 set Post for 1/8 corner

80 57 1/2 The corner to Sec 19=30=24 & 25

The corner to Sec 30=31=25 & 36

Thence East bet Sec 30 & 31

Var 20° E

40 00 found no 1/4 Sec corner

80 26 intersect 97 lks South of corner to Sec 29=30=31 & 3-

Thence S 89° 18' W on True line

40 11 1/2 set Stone 8 x 10 x 20 for 1/4 Sec corner bet Sec 30 & 31

Thence North through Sec 30

Var 20° E

40 00 Set Temporary center Sec 30

60 00 Set Temporary 1/6 corner

80 61 intersect 92 lks West of 1/4 Sec corner bet Sec 19 & 3

Thence S 40° W on True line

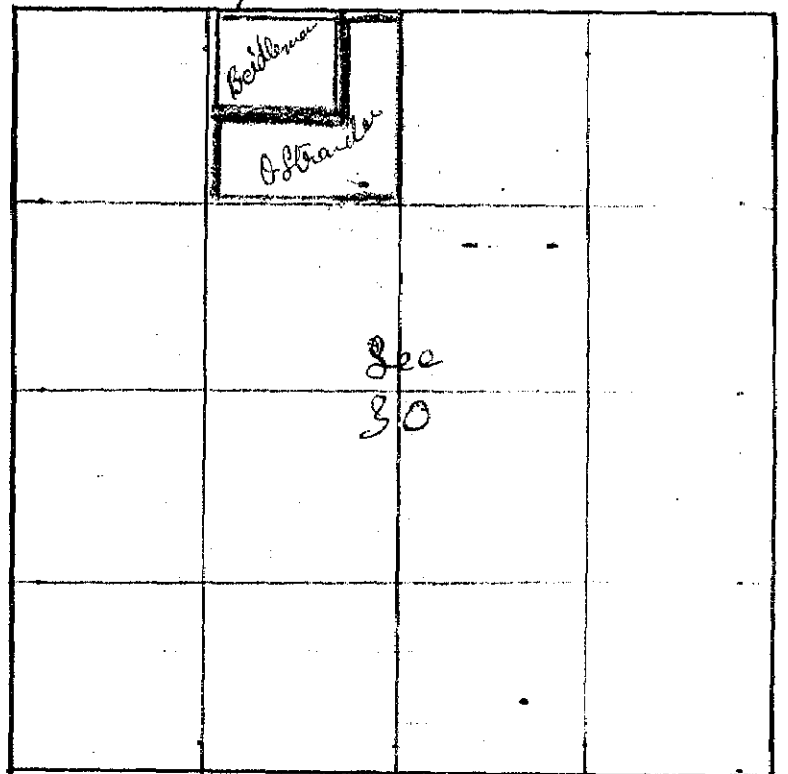

Township 4 South

Range 40 East

Union County, Oregon.

- 40 23 The $\frac{1}{4}$ Sec corner bet Sec 29 & 30
 Hence west through Sec 30
 Var $20^{\circ} 8'$
 Intersect Line N & S line 15 lks North of Cante Stake
- 80 24 The $\frac{1}{4}$ Sec corner bet Sec 25 & 30
- The $\frac{1}{4}$ Sec corner bet Sec 19 & 30
 Hence South on True line
 Var $19^{\circ} 20' E.$
- 20 00 Set Stone 8 x 6 x 27 for $\frac{1}{16}$ corner in Center N $\frac{1}{2}$ Sec 30
 Hence West
- 20 09 Set Stone 7 x 8 x 18 for $\frac{1}{16}$ corner in Center N $\frac{1}{4}$ Sec 30
 Lot No 1
 The $\frac{1}{8}$ corner on North Boundary N $\frac{1}{4}$ Sec 30
 Hence South
- 18 06 $\frac{1}{4}$ Set Stone 3 x 9 x 18 for Corner No 1
 Hence East
- 14 75 Set Stone 3 x 8 x 18 for Corner No 2
 Hence North
- 18 06 $\frac{1}{4}$ Set Stone 3 x 12 x 18 for corner No. 2
 Hence West
- 14 75 To Place of Beginning corner No 4
 Lot. No. 2
 Described as follows to wit
 Commencing at the $\frac{1}{4}$ Sec corner bet Sec 19 & 30
 Hence South
- 20 00 a Stone 8 x 6 x 27
 Hence West
- 20 09 a Stone 7 x 8 x 18
 Hence North 25 $\frac{3}{4}$ Rods a Stone 8 x 9 x 18
 Hence East 59 Rods " 3 x 8 x 18
 Hence North 54 $\frac{1}{4}$ Rods " 3 x 12 x 18
 Hence East 21 Rods to Place of Beginning the
 $\frac{1}{4}$ Sec corner bet Sec 19 & 30 a Post in Mound of Stone

J. W. Kimball County Surveyor