

Township 3 South

Range 36 East W. M.

Union County, Oregon.

Dec 11 1888

Mrs. E. C. Endrope & Steve Ferguson

I Commenced at the 1/4 Sec corner
bet Sec 12 & 13

41 08 Thence West var 20° E
Intersect N & S line 80 lks North
of the corner to Sec 11 = 12 = 13 & 14
from which

a Pine 18 in dia. to N 61° E 45 lks dist.

Limrock 18 " " N 70° W 59 " "

a Pine 15 " " S 59° W 18 " "

" 20 " " S 25° E 79 " "

Thence N 88° 51' E on true line

20 54 Set Post in Mound of Stone for 1/8 corner

The corner to Sec 11 = 12 = 13 & 14

Thence South bet Sec 13 & 14

var 20° E

41 10 The 1/4 Sec corner bet Sec 13 & 14

Thence North

20 55 Set Post in Mound of Stone
for 1/8 corner

The
The 1/4 Sec corner bet Sec 13 & 14

Thence South var 20° E

41 07 The corner to Sec 13 = 14 = 23 & 24

Thence North

20 53 Set Post in Mound of Stone for 1/8 corner

41 07 The 1/4 Sec corner bet Sec 13 & 14

Thence East through Sec 13
var 20° E

20 50 Set Temporary 1/16 corner

40 50 Set Temporary Centre Sec 13

60 50 Set Temporary 1/16 corner

80 41 I intersect East boundary 346 lks South of the
1/4 Sec corner bet Sec 13 & 18

Thence S 87° 31' W on true line through Sec 13

The 1/4 Sec corner bet Sec 13 & 18

Thence South bet Sec 13 & 18

42 20 The corner to Sec 13 = 24 = 18 & 19

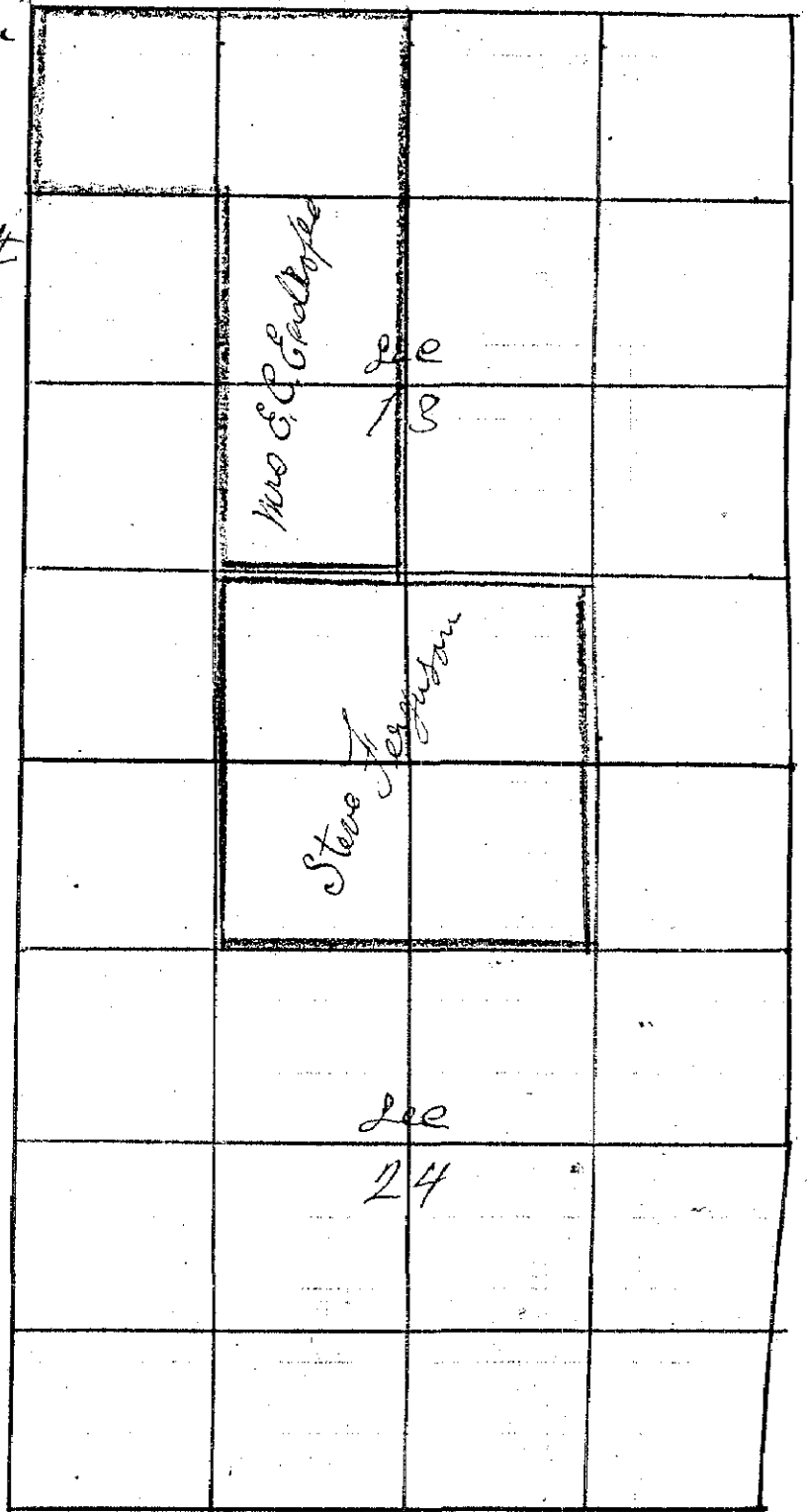

CHAINS. LKS.

The 1/4 Sec corner bet Sec 13 & 14
Thence North through Sec 13
for 20° E

82 88 Intersect E of W line 190 lks west of the 1/4 Sec cor bet Sec 13 & 14
Thence South 1° W on true line

20 57 Set Post for 1/16 corner in Center 1/4 Sec 13

41 15 Set Post for Center Sec 13

from which

a Pine 25 inches dia, bearing S 29° E 212 lks dist.

" 23 " " " S 31° W 261 " "

62 01 Set Post for 1/16 corner in Center 1/4 Sec 13

from which

a Pine 14 inches dia, bearing S 44° E 67 lks dist.

" 14 " " " S 67° W 184 " "

" 24 in " " N 23° W 330 " "

82 88 The 1/4 Sec corner bet Sec 13 & 14

The center Sec 13

Thence West

20 41 Set Post for 1/16 corner in Center 1/4 Sec 13

from which

a Pine 12 inch dia bearing S 79° E 154 lks dist.

" 12 " " " N 62° W 83 " "

Thence North through NW 1/4 Sec 13

41 00 The 1/8 corner on North Boundary N W 1/4 Sec 13

Thence South

20 50 Set Post for 1/16 corner in Center N W 1/4 Sec 13

41 00 The 1/16 corner in Center W 1/2 Sec 13

Thence South

41 31 The 1/8 corner on South Boundary S W 1/4 Sec 13

Thence North

20 65 Set Post for 1/16 corner in Center S W 1/4 Sec 13

from which

a Pine 18 inches dia, bearing S 47° E 334 lks dist.

41 31 The 1/16 corner in Center W 1/2 Sec 13

The center Sec 13

Thence East

20 04 Set Post for 1/16 corner in Center E 1/2 Sec 13

Thence South through

The S E 1/4 Sec 13

Township 3 South

Range 36 East

Union County, Oregon.

20 50 Set Temporary 1/16 corner
 41 92 Intersect- at the 1/8 corner on South Boundary
 S E 1/4 Sec 13
 Thence North through
 The S E 1/4 Sec 13
 on 20° E

20 76 Set Post for 1/16 corner in Center S E 1/4 Sec 13
 from which
 a Pine 24 inches dia by S 76° W 112 feet dist.
 " 14 " " " N 20° E 123 " "

J. W. Smithell