

J. L. A. Pritchison and J. S. Cameron

Sept. the 23rd 1888

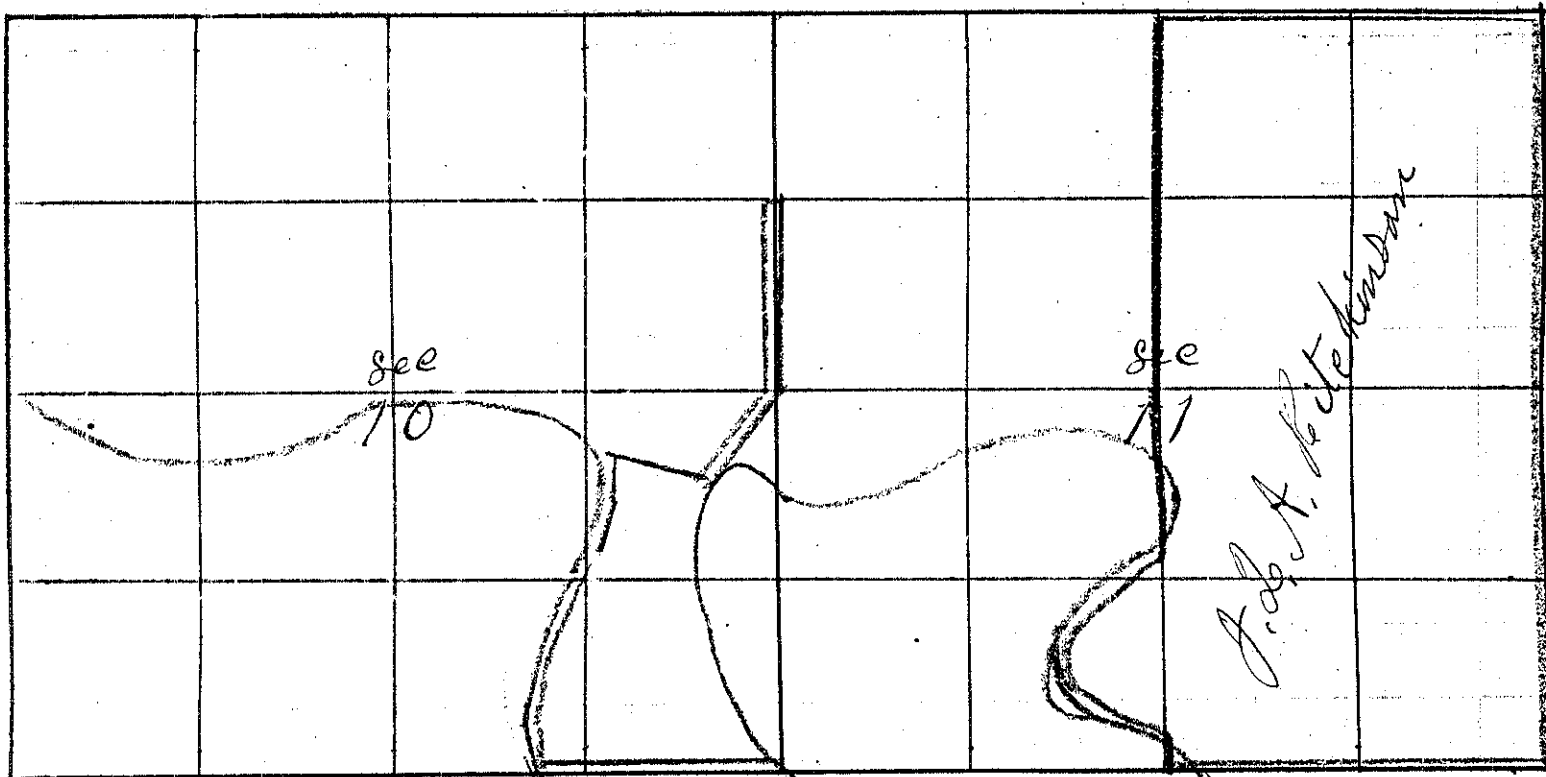

I commenced at the corner to Sec 2-3-10 & 11

Thence East bet Sec 2 & 11 var 20° E

40 50 found no 1/4 sec corner Set temporary 1/4 sec cor.

89 60 the corner to Sec. 1-2-11 & 12 Post secured and

Set Stone 5-7-80 inches for corner to Sec 1-2-11 & 12

Thence West

40 80 Set Stone 8 x 9 + 22 inches for 1/4 sec corner bet Sec 2 & 11

Thence South through Sec 11

Var 20° E

49 50 Set temporary center Sec 11

46 00 Offset 300 lks East on account of thick willows on Grande Round river

Thence South on offset

54 09 Set back west 300 lks to line Set stake on right bank of river

Thence South on line

70 40 Grande Round river 225 links across runs N 50° W

80 60 Intersect South boundary Sec 11 and found no 1/4 sec corner

and Set temporary 1/4 sec corner and proceeded to

The corner to Sec 11-12-13 & 14

Thence West bet Sec 11 & 14

Var 20° E

34 68 Grande Round river 152 lks across Course N 20° W

40 05 found no 1/4 sec corner Set temporary 1/4 sec corner

78 09 Grande Round river 270 lks across Course S 80° E

80 70 Set temporary corner on right bank of river

Thence West on same variation

25 42 Grande Round river 195 lks across Course N 10° W

40 13 found no 1/4 sec corner

00 - 9 found no sec corner

Thence West Var 20° E

CHAINS. LKS.

79 40 found no Sec. corner but at 60 Mts farther on I found
 Corner to Sec 8=9=16 & 15 making an Excess
 of 60 Mts in the 3 miles over US Field Notes
 and a falling of 20 Mts to each mile west
 I therefore ran east, allowing
 20 Mts to the mile and set temporary corner to
 Sec 10=11=14 & 15 on right bank of Grande River

I then proceeded to the corner to Sec 2=3=10 & 11
 thence South bet Sec 10 & 11
 for 25⁰⁰

40 50 found no 1/4 Sec Corner set temporary corner
 50 62 Grande River 622 Mts across course N 40° W
 78 00 Grande River 245 Mts across course S 80° E
 80 45 set temporary corner to Sec 10=11=14 & 15
 on right bank of river
 thence South

25 05 Grande River 200 Mts across course West
 41 10 the 1/4 Sec corner bet Sec 14 & 15
 making an excess of 110 Mts over US field notes
 I therefore ran North on this

40 36 set Stone on South side or right bank for
 corner to Sec 10=11=14 & 15
 thence North

40 37 set Stone 6 x 10 + 16 for 1/4 Sec corner bet Sec 10 & 11
 the corner to Sec 10=11=14 & 15
 thence East

40 70 set Stone 8 x 9 + 18 inches for 1/4 Sec corner bet Sec 11 & 14

the 1/4 Sec corner bet Sec 11 & 12
 thence West through Sec 11
 for 25⁰⁰

40 07 intersect true N & S line at center Sec 11

80 20 intersect West Boundary Sec 11 at 1/4 Sec corner bet Sec 10 & 11

I then proceeded to survey a fractional tract of
 land as follows to wit Lot No. 1 in Sec 10
 commencing at the 1/4 Sec corner bet Sec 10 & 11
 thence North 80 rods thence West 2 rods
 thence South 80 rods thence East S 36° 15' E 50 rods

Township

Range

Union County, Oregon.

and 11 lks Thence $N 66^{\circ} 15' W$ 28 Rods and 6 lks To The Center of Grande Round River Thence $S 20^{\circ} W$ 22 Rods
 Thence $S 35^{\circ} W$ 34 Rods Thence South $20^{\circ} W$ 14 Rods
 Thence $S 10^{\circ} W$ 59 Rods To Sec line bet Sec 10 & 15 - in Center of Grand Round river Thence East on Sec line 104 Rods to The Sec corner to Sec 10 = 11 = 14 & 15

I then proceeded to Establish Witness Corners to a Fractional Tract of Land in SW 1/4 Sec 11 as follows To wit Lot No. 2

Commencing at a Point 52 Rods and 20 lks South of the Center Sec 11 on right Bank of Grande Round River Set Stone 6 x 8 x 14 marked M. 1 from which

a willow 3 inches dia bears $N 28^{\circ} 35' E$ 21 lks dist.

The True Corner being 4 Rods North of Stone in Center of river

Thence $S 55^{\circ} W$ 12 Rods a Stone marked M. 2 The True Corner being 2 Rods North of Stone in Center of river

Thence $S 67^{\circ} W$ 37 Rods a Stone marked M. 3, The True Corner being 2 Rods NW of Stone in Center of river

Thence $S 2^{\circ} E$ 10 Rods a Stone marked M. 4, The True Corner being 2 Rods SW of Stone in Center of river

Thence $S 50^{\circ} 30' E$ 56 Rods a Stone marked M. 5, The True Corner being 4 Rods South of Stone in Center of river

Thence from witness Corner North $var 20^{\circ} E$ 64 Rods to Corner No 1 of Lot No. 2.

J. W. Fairbairn County Surveyor