

C. C. Coffinberg and Robert Eakin July the 9th 1888

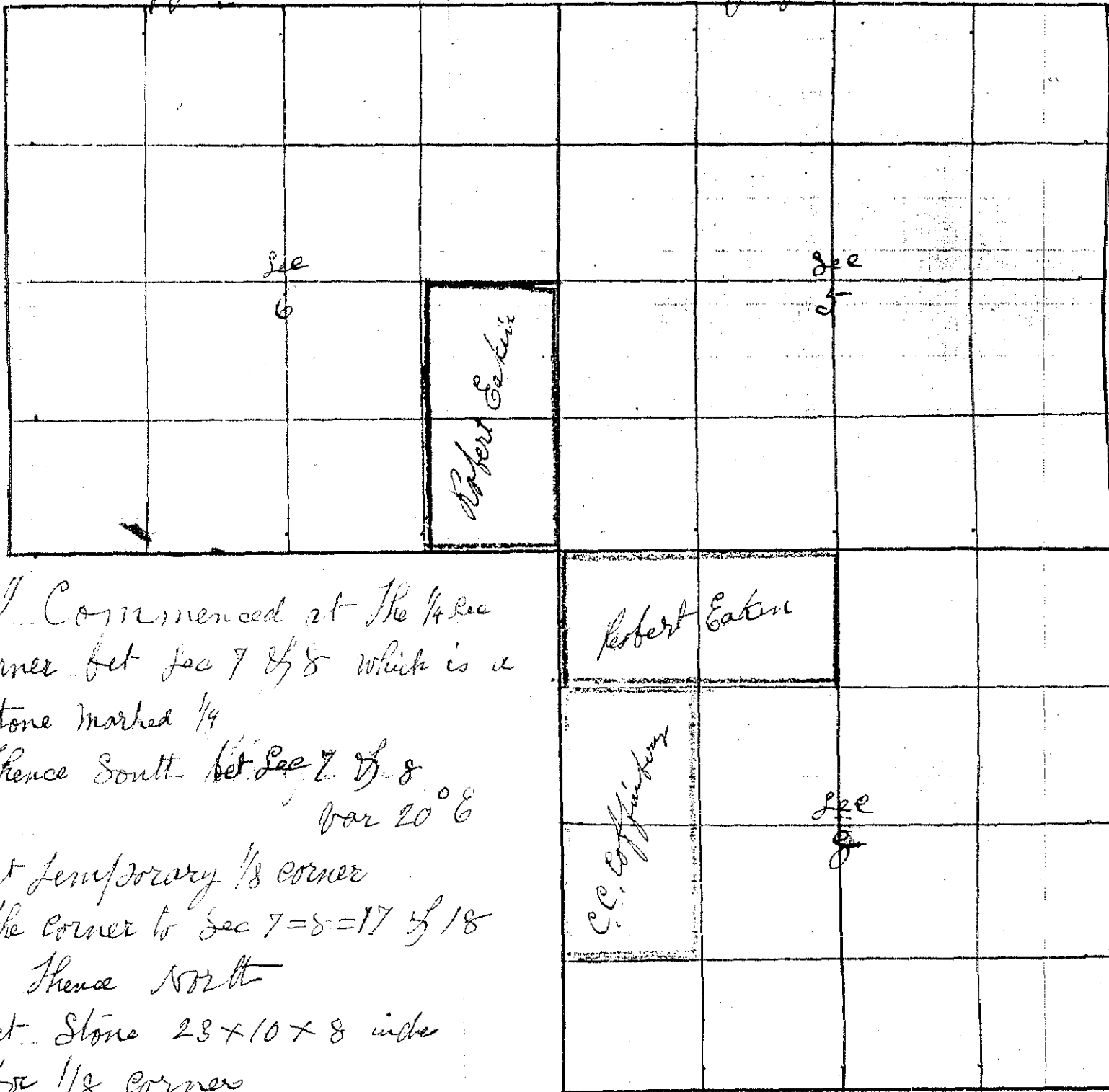

I Commenced at the 1/4 sec corner bet sec 7 & 8 which is a Stone marked 1/4

Thence South bet Sec 7 & 8
var 20° E

20 00 Set temporary 1/8 corner
40 18 the corner to sec 7-8-17 & 18
Thence North

20 09 Set Stone 28 x 10 x 8 inches
for 1/8 corner

40 18 the 1/4 sec corner bet sec 7 & 8
Thence North bet Sec 7 & 8 var 20° E

20 00 Set temporary 1/8 corner
40 18 the corner to sec 5-6-7 & 8 a stone 28 x 8 x 8 inches
Thence South

20 04 Set Stone 4 x 6 x 12 for 1/8 corner

40 18 the 1/4 sec cor bet Sec 7 & 8
Thence East through Sec 8
var 20° E

20 00 Set temporary 1/16 corner

40 00 Set temporary center Sec 8

80 12 Intersect East Boundary at 1/4 sec corner bet Sec 8 & 9

The corner to Sec 4-5-8 & 9 a Post in (Mid. of Stone)
Thence West bet Sec 5 & 8
var 20° E

40 00 found no 1/4 sec corner Set temporary 1/4 Sec.

80 36 the corner to Sec 6-6-7 & 8
Thence East on line

Township 4 South Range 40 East Union County, Oregon.

CHAINS	LINKS	
40	18	Set Stone 7+8+14 inches for 1/4 Sec corner bet Sec 5 & 8 The corner to Sec 5=8=17 & 18 Thence East Var 20° E
39	94	found no 1/4 Sec corner
80	36	Intersect 25 lks North of corner to Sec 8=9=16 & 17 a Point in Sec 8 Thence N 89° 49' W on True line
40	18	Set Post for 1/4 Sec corner bet Sec 8 & 17 at a Point from which a Stone marked 1/4 said to be set by Moses Austin County Surveyor in doing some work for John Hobbs but left no record bears N 2° W 32 links distant Thence North through Sec 8 Var 20° 15' E
40	47	Intersect True East & West line at center Sec 8
60	00	Set Temporary 1/6 corner
80	75	The 1/4 Sec corner bet Sec 5 & 8 Thence South on line
20	14	Set Stone 6+12+22 in mound of Stone for 1/6 corner in center N 1/2 Sec 8
40	00	The 1/2 corner Point on North Boundary N 1/4 Sec 8 Thence South
20	12	Set Stone 6+8+14 for 1/6 corner in center NW 1/4 Sec 8
40	25	Set Post for center W 1/2 Sec 8
60	31	Set Stone 8+9+20 inch for 1/6 corner in center SW 1/4 Sec 8 The corner to Sec 5=6=7 & 8 Thence North between Sec 5 & 6 Var 20° E
40	00	found no 1/4 Sec cor. Set Temporary 1/4 Sec Post
80	90	Intersect North Boundary 67 lks East of corner to Sec 5=6=31 & 32 Thence South 29° E on True line
40	60	Set 18+7+8 for 1/4 Sec corner bet Sec 5 & 6
80	90	The corner to Sec 5=6=7 & 8 Thence West Var 20° E
20	00	Set Temporary 1/8 corner
40	24	The 1/4 Sec corner bet Sec 6 & 7 a Stone Thence East
20	12	Set Stone 6+9+14 for 1/8 corner W. Kinbell County Surveyor