

Township 6 South

Range 41 East W.M.

Union County, Oregon.

CHAINS. Lks.

P. H. Miles and William Wilson April 14 1888

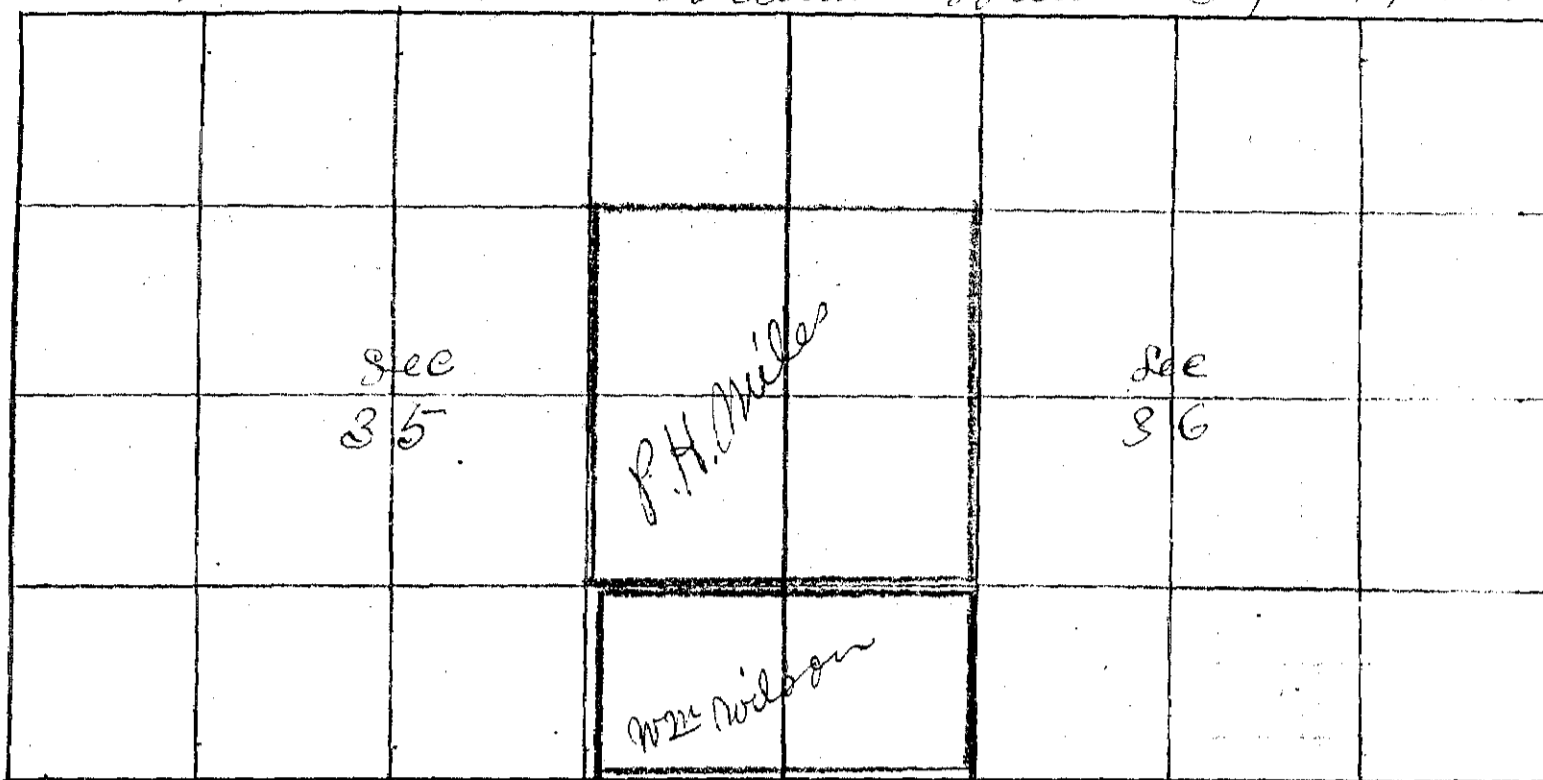

I commenced at the 1/4 Sec corner bet Sec 35 & 36
 thence South bet Sec 35 & 36
 Var 20° 5' E

20 00 Set temporary 1/8 corner

40 03 Intersect south boundary 10 lks west
 of corner to Sec 1-2-35 & 36 on Township
 line bet T 6 & 7 S 16 & 41 E
 thence N 9° west on true line
 Var 20° 5' E

20 01 1/2 Set Post for 1/8 corner

40 03 The 1/4 Sec corner bet Sec 35 & 36

W. Kimbrell Deputy County Surveyor

Township No 9 South R 45 East W.M.

No. 29 1/2

G W Moody

April the 15 1888

I commenced at the 1/4 Sec corner
 bet Sec 14 & 15

thence North bet Sec 14 & 15
 Var 20° E

68 Rods and 12 lks

thence S 27° E 38 Rods

thence S 82° W 8 1/2 lks

thence S 8° E 33 " 9 "

" N 89° 45' W 10 " 14 " to place
 of beginning

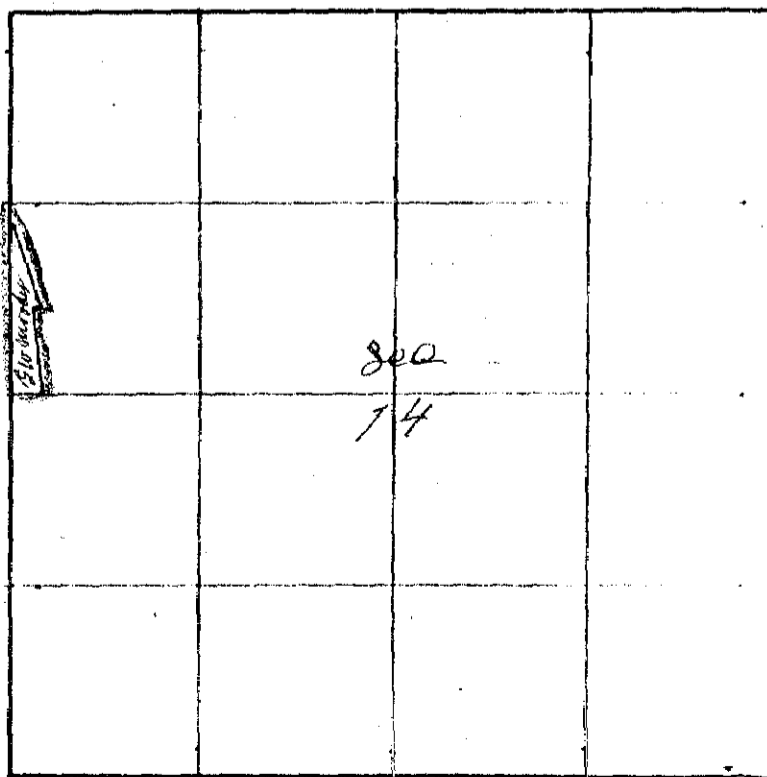

W. Kimbrell Deputy County Surveyor