

J. H. Corbin and J. M. Worley March the 16 1888

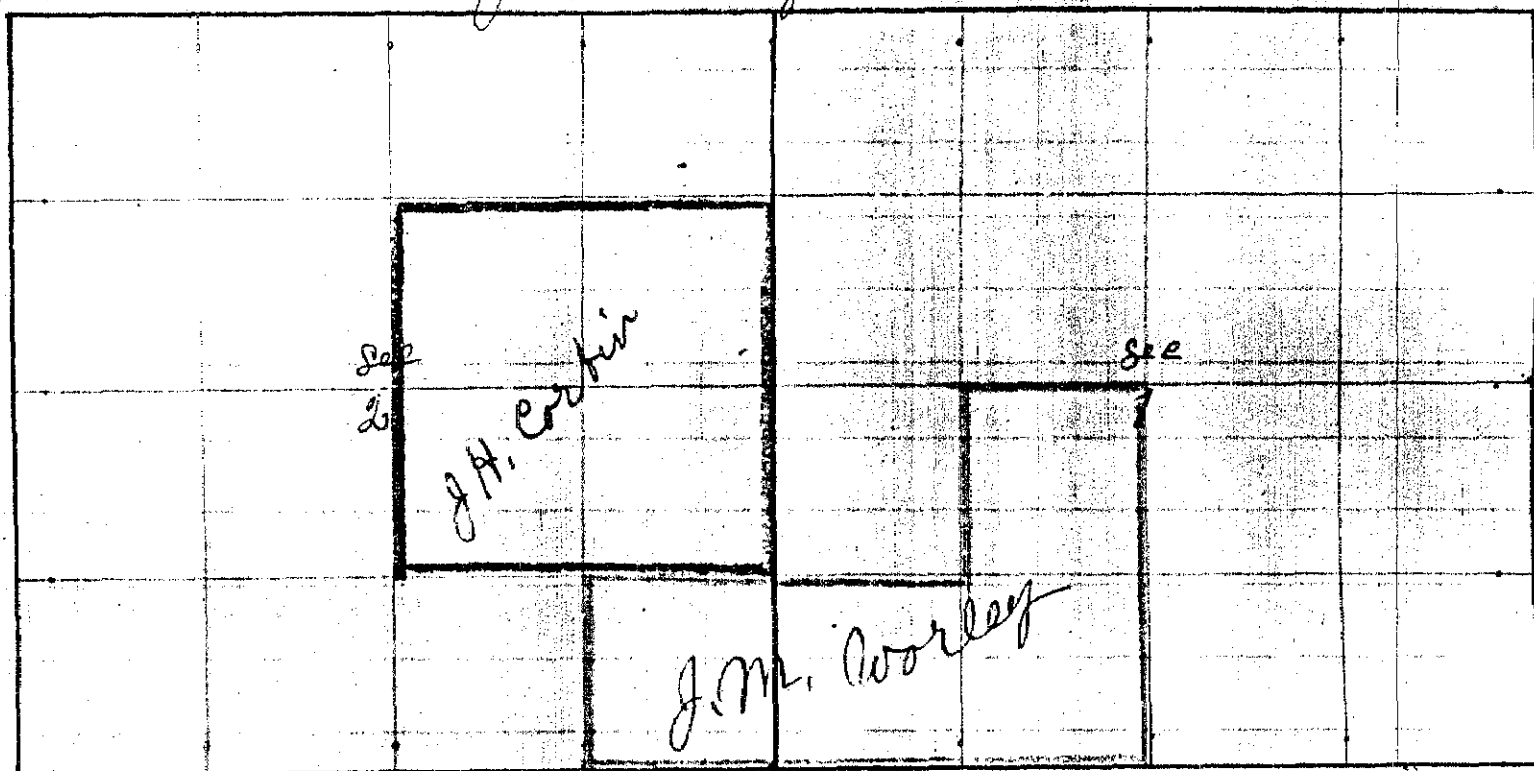

- I Commenced at the 1/4 Sec corner bet Sec 2 & 11 Post in Mid of East
Thence East var 20° 15' E
- 40 10 The corner to Sec 1 = 2 = 11 1/2 Post in Mid of East
Thence west on line
- 20 05 Set Stone for 1/8 corner
- 40 10 The 1/4 Sec corner bet Sec 2 = 11
The corner to Sec 1 = 2 = 11 1/2
Thence East bet Sec 1 & 12 var 20° E
- 20 00 Set Temporary 1/8 cor
- 39 94 found no 1/4 Sec cor Set Temporary 1/4 Sec
- 80 25 Intersect East Boundary 24 lbs South of corner to Sec 1 = 12 = 687
S 89° 50' W on line
- 40 12 1/2 Set Post dug 100 N & S Built Mound for 1/4 Sec cor bet Sec 1 & 12
- 60 19 Set Post dug 100 built Mound of Earth for 1/8 cor
- 80 25 The corner to Sec 1 = 2 = 11 1/2
The 1/4 Sec corner bet Sec 1 & 12
Thence North through Sec 1
- 20 00 Set Temporary 1/16 corner
- 40 50 Set Temporary center Sec 1
- 80 14 The 1/4 Sec corner bet Sec 1 & 36 a stone in Mid of Stone
Thence west on line
- 40 50 found no corner Set Temporary corner to Sec 1 = 2 = 35 & 36
- 60 00 Set Temporary 1/8 cor
- 80 30 The 1/4 Sec corner bet Sec 2 & 35 Stone
Thence East
- 20 07 1/2 Set Post for 1/8 corner
- 40 15 Set Post in Grainfield for corner to Sec 1 = 2 = 35 & 36
Thence South bet Sec 1 & 2
- 19 75 Set Temporary 1/8 corner