

Surveyed for J.L. Rose Thos. William Neville & William Press. Oct 7 1889

By J.W. Kinnell County Surveyor Plat No. 91

For the re-establishment of Original U.S. Survey Section and 1/4 section corners and the subdivision of sections 5=6=7 & 8 in Township 2 South of Range 39 East of Willamette Meridian

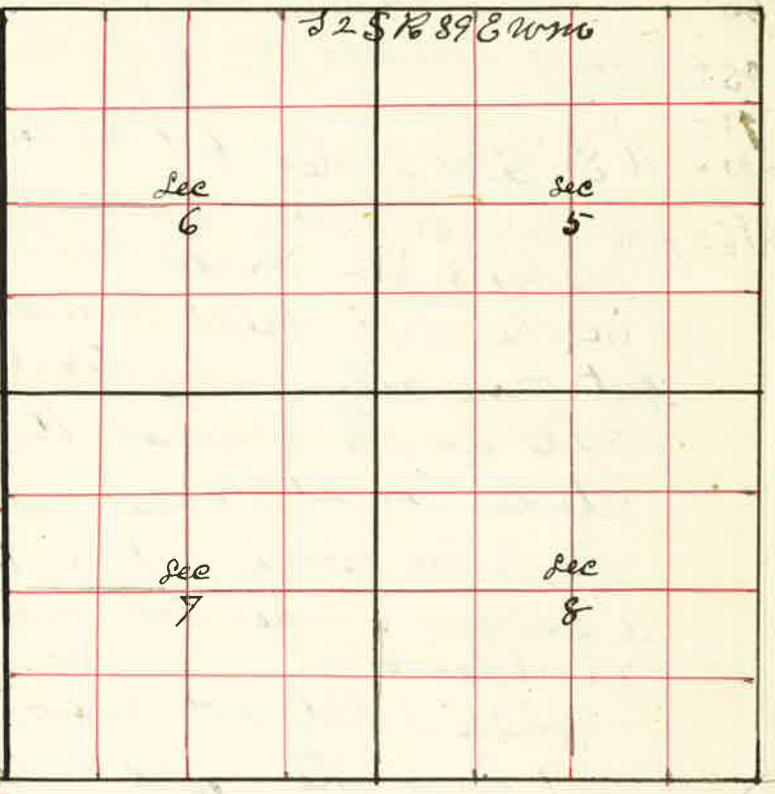

I Commenced at the corner to sections 5=6=31 & 32 on the Township line S. 1/2 1/2 S. Thence South var 19 1/2 E

- 1955 Set Temporary 1/8 corner
- 3955 " " 1/4 Sec corner
- 5955 " " 1/8 corner
- 7958 I intersect E & W line 17 lks West of corner to Sec 5=6=7 & 8 a Stone supposed to be set in place of old U.S. Post corner from which I run North var 20° E
- 2007 Set Stone 6x8x18 for 1/8 corner
- 4002 Set Stone 5x18x25 inches for 1/4 Sec corner bet Sec 5 & 6
- 6003 Set Stone 5x14x28 " for 1/8 corner
- 7958 The corner to Sec 5=6=31 & 32 on Twp line Thence West var 20° 30' East
- 4000 Set Temporary 1/4 Sec Stake
- 7882 Intersect West Boundary at corner to Sec 6=7=1 & 12 from which I run East var 20° 30' E
- 3881 Set Post for 1/4 Sec corner at Sec 6 & 7
- 7882 The corner to Sec 5=6=7 & 8 Thence East set Sec 5 & 8 var 20° 45' E
- 19976 Set Post for Temporary 1/8 corner

- 3995 Set Temporary 1/4 Sec Post
- 5992 Set " " 1/8 corner = Excess 69 lks on W. line
- 8059 I intersect N & S line 61 lks North of corner to Sec 4=5=8 & 9 from which I run N 89° 30' W. on true line bet Sec 5 & 8 var 20° E
- 2015 Set Stake for 1/8 corner
- 4029 " " " 1/4 Sec corner
- 6044 Set Stone 5x8x22 for 1/8 corner
- 8059 The corner to Sec 5=6=7 & 8. Thence North var 20° 30' E
- 2000 Set Post for Temporary 1/8 corner
- 4000 Set " " " 1/4 Sec corner, bet Sec 4 & 5
- 6000 " " " " 1/8 corner
- 7967 I intersect North Boundary 100 lks West of corner to Sec 4=5=32 & 33 from which I run S 45° W on true line
- 1954 Set 1/8 corner Post
- 3958 " 1/4 Sec corner Post
- 5968 " 1/8 corner Post
- 7967 The corner to Sec 4=5=8 & 9 Thence West var 20° E
- 2008 wire fence N & S
- 4000 Set Temporary 1/4 Sec Stake
- 8018 The corner to Sec 5=6=31 & 32 from which I run East
- 4009 Set Stone 8x12x32 inches for 1/4 Sec corner bet Sec 5 & 8
- 8018 The corner to Sec 4=5=32 & 33 Thence West var 20° E
- 2000 Set Temporary 1/6 corner in center of 1/2 Sec 5
- 4000 " " 1/6 corner in center Sec 5
- 6000 " " 1/6 corner in center W 1/2 Sec 5
- 8048 The 1/4 Sec corner bet Sec 5 & 6 from which I run East var 20° E

Surveyed for J. P. Lee the William Neville pres of Oliver Bros. Oct 7 1889

- 2010 Set Stake for $\frac{1}{16}$ corner in center W. $\frac{1}{2}$
- 4022 The center Sec 5 -
- 6032 The $\frac{1}{16}$ corner in center E $\frac{1}{2}$
- 8048 The $\frac{1}{4}$ Sec corner bet Sec 4 & 5 -
The $\frac{1}{4}$ Sec corner on North Boundary Sec 5 -
Thence South var $20^{\circ}15' E$
- 1960 Set Temporary $\frac{1}{16}$ corner in center N. $\frac{1}{2}$ Sec 5 -
- 3960 " " " " " " center Sec 5 -
- 5960 " " " " " " " S $\frac{1}{2}$ Sec 5 -
- 7968 The $\frac{1}{4}$ Sec corner bet Sec 5 & 8 15 lks East of line
from which I run North on true line
- 2002 Set Stake for $\frac{1}{16}$ corner in center S $\frac{1}{2}$ Sec 5 -
- 4004 " Stake for $\frac{1}{16}$ corner in center Sec 5 -
- 6006 " Stone 9 x 10 x 24 for $\frac{1}{16}$ corner in center N. $\frac{1}{2}$ Sec 5 -
- 7968 The $\frac{1}{4}$ Sec corner bet Sec 5 & 8 on T/P line
The $\frac{1}{8}$ corner on west Boundary N. $\frac{1}{4}$ Sec 5 -
Thence East var $20^{\circ} E$
- 2000 Thence N & S.
- 4014 The $\frac{1}{16}$ corner in center N. $\frac{1}{2}$ Sec 5 -
- 8029 The $\frac{1}{8}$ corner on East Boundary N. E. $\frac{1}{4}$ Sec 5 -
The $\frac{1}{8}$ corner on west Boundary S. W. $\frac{1}{4}$ Sec 5 -
Thence East through center S $\frac{1}{2}$ Sec 5 - var $20^{\circ} E$
- 2000 Set Temporary $\frac{1}{16}$ corner in center S. W. $\frac{1}{4}$ Sec 5 -
- 4025 The center S $\frac{1}{2}$ Sec 5 - from which I run west
- 2011 Set Stone 8 x 14 x 20 inches for center S. W. $\frac{1}{4}$
- 4029 The $\frac{1}{8}$ corner on west Side, S. W. $\frac{1}{4}$
The center S $\frac{1}{2}$ Sec 5
Thence East var $20^{\circ} E$
- 2000 Set Stake for Temporary $\frac{1}{16}$ corner
- 4026 The $\frac{1}{8}$ corner on East Boundary S. E. $\frac{1}{4}$ Sec 5 -
from which I run west
- 2013 Set Stone 9 x 11 x 24 inches for $\frac{1}{16}$ corner in center S. E. $\frac{1}{4}$ Sec 5 -
The $\frac{1}{8}$ corner on South Boundary S. E. $\frac{1}{4}$ Sec 5 - Thence North
- 2004 The center S. E. $\frac{1}{4}$ Sec 5 -
- 2003 The $\frac{1}{8}$ corner on South Boundary S. W. $\frac{1}{4}$ Sec 5 - Thence North

- I Commenced at the $\frac{1}{4}$ Sec corner bet Sec 6 & 7 on the Range line bet Ranges 38 & 39 and ran South var $20^{\circ} E$
- 4000 Set Temporary $\frac{1}{4}$ Sec bet to Sec 6 = 7 = 18 & 2
Thence South on same var. $20^{\circ} E$
- 4000 Set Temporary $\frac{1}{4}$ Sec corner
- 8086 The corner to Sec 7 = 18 = 12 & 18 making an Excess of 36 lks in $1\frac{1}{2}$ miles or 12 lks to each $\frac{1}{2}$ mile over the original U.S. Field notes
I therefore run North var $20^{\circ} E$
- 4012 Set Stake for $\frac{1}{4}$ Sec Point bet Sec 6 & 7 = 78 & 12
- 8024 Set Stake " corner to Sec 6 = 7 = 18 & 12
Thence North var $20^{\circ} E$
- 4012 The $\frac{1}{4}$ Sec corner bet Sec 1 & 6
The $\frac{1}{4}$ Sec corner bet Sec 5 & 6
Thence West var $20^{\circ}15' E$
- 4000 Set Stake for Temporary center Sec 6
- 7981 Intersect West Boundary 29 lks North of $\frac{1}{4}$ Sec corner bet Sec 6 & 7
The $\frac{1}{4}$ Sec corner bet Sec 6 & 7
Thence North var $20^{\circ} E$
- 4008 The center Sec 6
- 6000 Set Stake for Temporary center N. $\frac{1}{2}$ Sec 6
- 7978 Intersect North Boundary 12 lks West of $\frac{1}{4}$ Sec corner bet Sec 6 & 7 which was decayed and I set Stone 4 x 19 x 24 for $\frac{1}{4}$ Sec corner from which I run South on true line
- 1970 Set Stone 4 x 18 x 24 for $\frac{1}{16}$ corner in center N. $\frac{1}{2}$ Sec 6
- 3970 The center Sec 6
Thence East var $20^{\circ} E$
- 3997 The corner to Sec 5 = 6 = 78 & 8
Thence South var $20^{\circ}15' E$ bet Sec 7 & 8
- 4000 Set Stake for Temporary $\frac{1}{4}$ Sec corner
- 8070 " " " " " " corner to Sec 7 = 8 = 17 & 18
Thence South var $20^{\circ}50' E$
- 4044 The $\frac{1}{4}$ Sec corner making an Excess of 44 lks over U.S. Survey I therefore run North and at
- 4014 Set Stake for corner to Sec 7 = 8 = 17 & 18
Thence North var $20^{\circ} E$
- 4015 Set Stone 8 x 12 x 24 inches for $\frac{1}{4}$ Sec corner bet Sec 7 & 8
- 8015 The corner to Sec 5 = 6 = 78 & 8
The corner to Sec 4 = 5 = 8 & 9
Thence South

J. L. Rose Thos Gilliam Neville

- The corner to Sec 4 = 5 = 8 & 9
Thence South var 20° E
- 2000 Set Stake for temporary 1/8 corner
- 4000 Set " " " 1/4 Sec corner
- 6000 " " " " 1/8 corner
- 8028 Intersect East and West line 27 lks west of Corner to Sec 8 = 9 = 16 & 17
from which I run North on true line
- 2007 Set Stone 4 1/2 x 12 x 24 inches for 1/8 corner
- 4014 Set Stone 6 x 9 x 20 inches for 1/4 Sec corner bet Sec 8 & 9
- 6021 Set Stone 8 x 8 x 19 for 1/8 corner
- 8033 The corner to Sec 4 = 5 = 8 & 9 in Ollivers field meadow
The 1/4 Sec corner bet Sec 7 & 8 Thence East var 20° E
- 2000 Set Stake for temporary 1/16 corner for Center W 1/2 Sec 8
- 4000 Set Temporary Stake for Center Sec 8
- 5200 Set " " " Fractional lot bet Rose & Olliver
- 6000 Set " " " 1/16 corner in center E 1/2 Sec 8
- 8020 Intersect East Boundary 8 lks North of 1/4 Sec corner
from which I run west on true line var 20° E
- 2008 Set Stone 7 x 9 x 20 inches for 1/16 corner in center E 1/2 Sec 8
- 2411 Set Stone 6 x 10 x 21 inches for fractional lot bet Rose & Olliver
- 4016 Set Stone 6 x 12 x 18 " for center Sec 8
- 6024 Set Stone 8 x 7 x 27 " for center west 1/2 Sec 8
- 8033 The 1/4 Sec corner bet Sec 7 & 8
The 1/4 Sec corner bet Sec 8 & 17
Thence North var 20° 15' E
- 2000 Set Temporary Stake for center E 1/2 Sec 8
- 4017 Intersect E & W line 12 lks East of 1st Stake for Center
- 6017 Set Stake for temporary 1/16 corner to Center N 1/2 Sec 8
- 8031 Intersect North Boundary 6 lks west of 1/4 Sec corner bet Sec 5 & 8
from which I run South on true line
- 2007 Set Stake for center N 1/2 Sec 8
- 4014 Set Stone 6 x 12 x 18 for center Sec 8
- 6022 Set Stake for center E 1/2 Sec 8
- 8031 The 1/4 Sec corner
The 1/8 corner on south Boundary S.W. 1/4 Sec 8 a Stone 8 x 10 x 20
Thence East - 144 lks bet temporary Sec 8 var 20° E
- 1991 1/2 Set Temporary Stake for
- 392 1/2 Set " Stake for 1/8 corner
- 899 The corner to Sec 8 = 9 = 16 & 17

J. L. Rose Thos Gilliam Neville Rose & Olliver Bros

- from which I run West
- 2000 Set Stone 4 x 9 x 22 inches for 1/8 corner
- 4000 Set Stone 6 x 6 x 22 inches for 1/4 Sec corner bet Sec 8 & 17
The 1/8 corner on west Boundary N.W. 1/4 Sec 8
Thence East var 20° E
- 2000 Set Stake for temporary center N.W. 1/4 Sec 8
- 4020 Intersect N & S line 5 lks South of center N 1/2
- 5220 Set Stake for temporary Fractional corner bet Rose & Olliver
- 6020 Set Stake for temporary 1/16 corner in center N.E. 1/4 Sec 8
- 8046 Intersect East Boundary 25 lks South of 1/8 corner
from which I run West on true line
- 2013 Set Stone 8 x 12 x 28 inches for 1/16 corner in center N.E. 1/4 Sec 8
- 2409 Set Stone 7 x 7 x 25 for fractional corner bet Rose & Olliver
- 4026 The center N 1/2 a Stone 8 x 10 x 15 for center N 1/2 Sec 8
- 6039 Set Stone 6 x 12 x 20 inches for center N.W. 1/4 Sec 8
- 8046 The 1/8 corner on west Boundary N.W. 1/4 Sec 8
The 1/8 corner on North Boundary N.E. 1/4 Sec 8
Thence South
- 2006 The center N.E. 1/4
- 4012 The center E 1/2 Sec 8 a Stone 7 x 7 x 20
Thence South var 20° E
- 2000 Set Stake for temporary 1/16 corner in center S.E. 1/4 Sec 8
- 4015 The 1/8 corner on south Boundary S.E. 1/4
from which I run North
- 2007 1/2 Set Stone 5 x 6 x 22 inches for 1/16 corner in center S.E. 1/4 Sec 8
- 4015 The 1/16 corner in center E 1/2 Sec 8
The 1/8 corner on south Boundary S.W. 1/4 Sec 8
Thence North var 20° E
- 2000 Set Temporary 1/16 corner
- 4015 The center W 1/2 Sec 8 a Stone 8 x 7 x 27 in
from which I run South
- 2007 1/2 Set Stone 4 x 6 x 18 for 1/16 corner in center S.W. 1/4 Sec 8
The 1/16 corner in center W 1/2 Sec 8
Thence North
- 2010 Intersect E & W line
- 4017 The 1/8 corner on North Boundary N.W. 1/4 Sec 8
from which I run South on true line
- 2008 1/2 Set Stone 6 x 12 x 20 inches for 1/16 corner in center N.W. 1/4 Sec 8
- 4017 The center W 1/2 Sec 8

J. W. Frombell County Surveyor