

The 1/4 Sec Corner on West Side Sec 20 thence East 74 10 1/2
8020 chains the 1/4 Sec cor on East Side Sec 20 from
which I run West 2005 chains set Stone for 1/2 cor.
4011 chains set Stone marked C.S. for center Sec 20 6017
chains set Stone for 1/2 corner for center West Side 20
the 1/4 Sec corner on North Side Sec 20 thence South
4022 chains the center 8045 chains the 1/4 Sec cor
on South Side Sec 2 W. Kimbrell County Surveyor

Surveyed for J. Olliver Dec 23rd 1888

By W. Kimbrell County Surveyor Plat No. 63

I commenced at the N.W. corner
of Sec 18 thence East - var 20° 8' 48" 57
chains Willow-creek 7852 chains
set stake for temporary Sec cor
thence East 40 chains set stake
for temporary 1/4 Sec cor 8000
thence East 7914 chains no
corner but at 8044 chains found
the Old Original Cor to Sec
9=10=15 & 16 stake decayed
I placed a Stone 6x10x18 in
12 inches in the ground.

I therefore have an excess of
270 links in the 3 miles over the U.S. Field Notes
I run West allowing 90 links excess to each mile
and I located a Point for 1/4 Sec cor on N Side Sec 17
and run South for the Establishment of the center Sec
17 at 4015 center 8037 1/4 Sec cor on South Side Sec 17
the S.E. corner Sec 17 thence North 4011 chains 1/4 Sec cor
thence West 4032 chains the center 8065 chains West
boundary the S West cor Sec 17 thence North 4026
chains the 1/4 Sec cor on West Side Sec 17 set Stone for
1/4 Sec cor from which I run East 4033 chains set
Stone mark C.S. for center Sec 17

W. Kimbrell County Surveyor

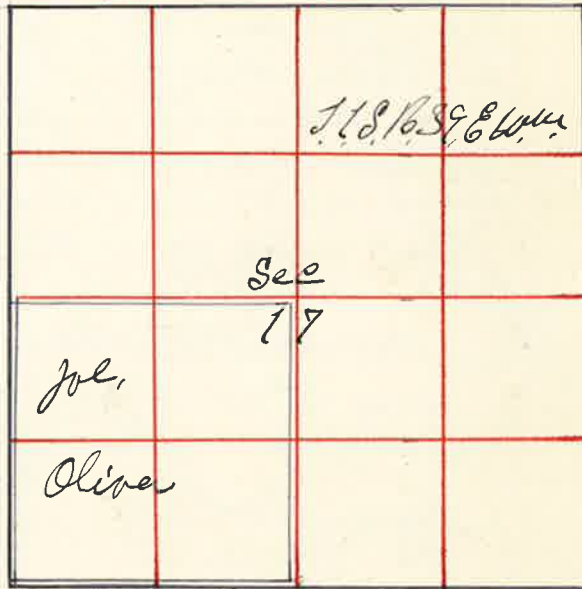

Surveyed for H. H. Elmer Dec 24 1888

By W. Kimbrell County Surveyor Plat No. 64

I commenced at the 1/4 Sec cor
on the South Side Sec 19 thence
East 4045 chains the S.E. cor
Sec 19 from which I run
West 2022 1/2 chains set Stone
marked for 1/2 cor 4045 chains
the 1/4 Sec cor thence
West 7998 chains the S.W.
corner Sec 19 from which
I run East 1959 chains set
Stone marked for 1/2 corner on
South Side Sec 19

The S.W. corner Sec 19 thence
North 40 chains set stake for temporary 1/4 Sec cor 80
chains set stake for Sec cor thence North
4042 chains the 1/4 Sec cor on West Side Sec 18
making an excess of 48 links in 1 1/2 miles or 2 1/4
links to each 1/2 mile. I therefore run South 4014
chains set Stone marked for Sec cor to Sec 18=19=138 1/4
thence South 4014 chains set stake for 1/4 Sec cor.
thence East 1920 chains set stake for 1/2 cor
3920 set stake for temporary center 5920 chains set
stake for temporary 1/2 cor 8020 chains 1/4 Sec cor East
Side Sec 19 from which I run West 2025 chains set Stone
for 1/2 corner in center of East 1/2 Sec 19 4050 chains
set Stone for center Sec 19 6075 chains set Stone marked
for 1/2 cor in center West Side Sec 19 the N.W. corner
Sec 19 thence East 3920 chains set stake for temporary 1/4
Sec cor 4074 chains to N.E. cor Sec 19 from which
I run West 4077 chains for natural 1/4 Sec thence South
through center of 022 1/2 center 8045 the 1/4 Sec cor
on South Side Sec 19

W. Kimbrell County Surveyor

