

58 Surveyed for George Geckler Nov, 15<sup>th</sup> 1888

By J.W. Kimbrell County Surveyor Plat No. 54

I Commenced at the  $\frac{1}{4}$  Sec corner on East Side Sec 24 thence South 4000 chains the corner to Sec 24-25-19830 thence South 2000 chains set post for temporary  $\frac{1}{8}$  corner 4030 chains the  $\frac{1}{4}$  Sec corner on East Side Sec 25 from which I run North 2015 chains and set post marked  $\frac{1}{8}$  c for  $\frac{1}{8}$  corner on East Side N E  $\frac{1}{4}$  Sec 25 - I then started at  $\frac{1}{4}$  Sec corner on East Side of Sec 25 thence West through center Sec 25 - 4000 chains set post for temporary center 8180 chains West boundary Sec 25 - from which I turn East and at 4090 chains marked a Fir Tree 11 inches diameter C.S. for center Sec 25 - thence North 2000 chains set post for temporary  $\frac{1}{4}$  corner 3850 chains the  $\frac{1}{4}$  Sec corner on North Side Sec 25 - from which I run South 1925 chains set post in mound of stone marked  $\frac{1}{16}$  for center  $\frac{1}{4}$  Sec 25 - I then started at  $\frac{1}{4}$  Sec corner on South Side Sec 24 thence East 20 chains set post for temporary  $\frac{1}{8}$  corner 3940 chains corner to Sec 24-25-19830 from which I run West and at 1970 chains set post in mound of stone for  $\frac{1}{8}$  corner I then started at  $\frac{1}{4}$  Sec corner on East Side Sec 24 thence West through center Sec 24 20 chains set stake for temporary  $\frac{1}{16}$  corner 8030 chains the  $\frac{1}{4}$  Sec corner on West Side Sec 24 from which I run East 6022 chains set post marked  $\frac{1}{16}$  for center  $\frac{1}{4}$  Sec 24 from which a Fir 6 inches Bears N 33° W 56 links distant a Fir 20 inches diameter Bears S 32° E 148 links distant

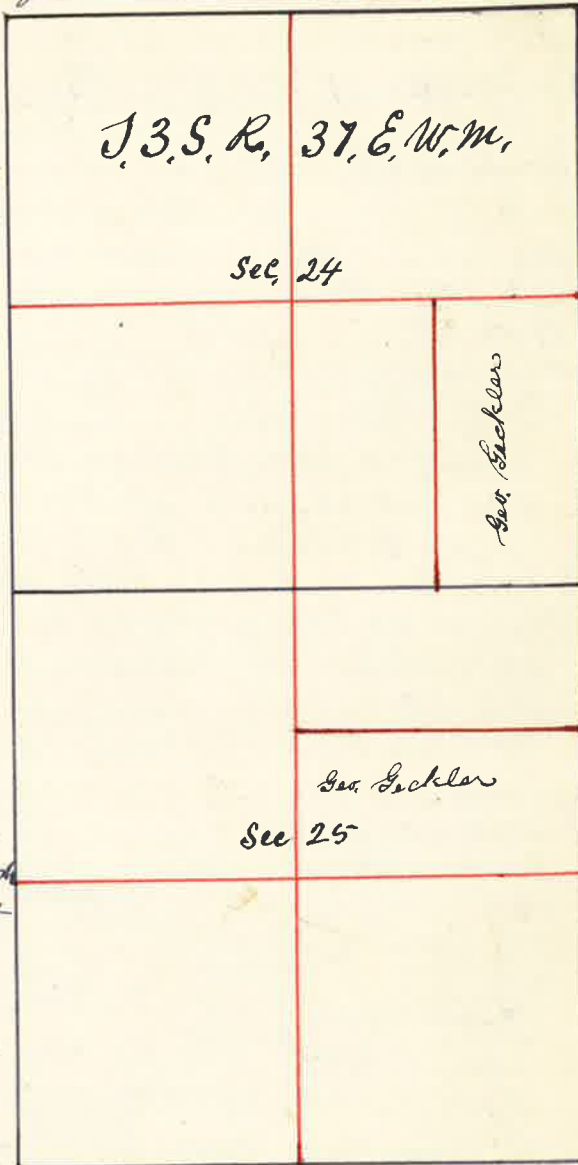

J.W. Kimbrell County Surveyor

59 Surveyed for Union County Oct. 21 1888

By J.W. Kimbrell County Surveyor Plat No. 53

I Commenced at the corner to Sec 3=4=9810 thence West between Sec 4 and 9 80 chains set temporary stake for corner to Sec 4=5=889 thence West 3964 chains the corner to Sec 5=6=788 making a deficiency of 16 links in 2 miles I therefore run East 7983 chains and set stake for temporary Sec corner. I started at  $\frac{1}{4}$  Sec corner between Sec 988 16 and run West 3990 chains and set stake for temporary corner to Sec 8=9=16817 thence West 80 chains the corner to Sec 7=8=17818. I then started on township line at the  $\frac{1}{4}$  Sec corner between Sec 5832 in town Booths Hay Coral thence East 40 chains set post for temporary Sec corner 80 " set post for temporary Sec corner at 4030 chains the  $\frac{1}{4}$  Sec corner between Sec 3 and 34 making an excess of 20 links over U.S. Field Notes I therefore run West per 20 8, at 4005 chains set stone 10 x 10 x 20 inches marked for corner to Sec 3=4=33834 thence West 8010 chains set stone 8 x 10 x 15 inches marked for corner to Sec 4=5=32833 show this corner I run South 7980 chains set stake for temporary corner thence South 80 chains set temporary stake for Sec corner thence South 8130 chains the corner to Sec 16=17=21820 making an excess of 130 links over U.S. Field Notes in the 3 miles retraced I therefore run North 4023 chains and set a stone 10 x 12 x 18 for  $\frac{1}{4}$  Sec corner between Sec 16817 8043 chains set a stone 14 x 14 x 32 inches for corner to Sec 8=9=16817 thence North 8044 chains set a stone 6 x 6 x 18 inches for corner to Sec 4=5=8 and 9

J.W. Kimbrell County Surveyor

