

Surveyed for John Johnson & Ed Remillard June 14, 1885

By J.W. Kimbrell Dept. Co. Surveyor Plat No 36

For the Re-establishment of the corner to Sec 1 & 12 and 6 & 7 on the Guide Meridian or Auxiliary meridian between T4S Ranges 39 & 40 E 10th and the 1/4 Sec corners on West side of Sec 6 & 7 in T4S R. 40 E. 10th and the establishing of the 1/4 corner on West side of Sec. 7.

I started at the NW corner Sec. 6 thence South over 20° E at 40 chains set post for temporary 1/4 sec. cor. on west side Sec. 6. at 80 chains set stake for support corner to Sec 1-12-6 & 7 and at thence South at 40 chains set stake for temporary 1/4 sec. cor. at 60 chains set stake for temporary 1/2 corner and at 80 & 4 chains the corner to Sec 7-12-13 making an excess of 54 links in the 2 miles I therefore run

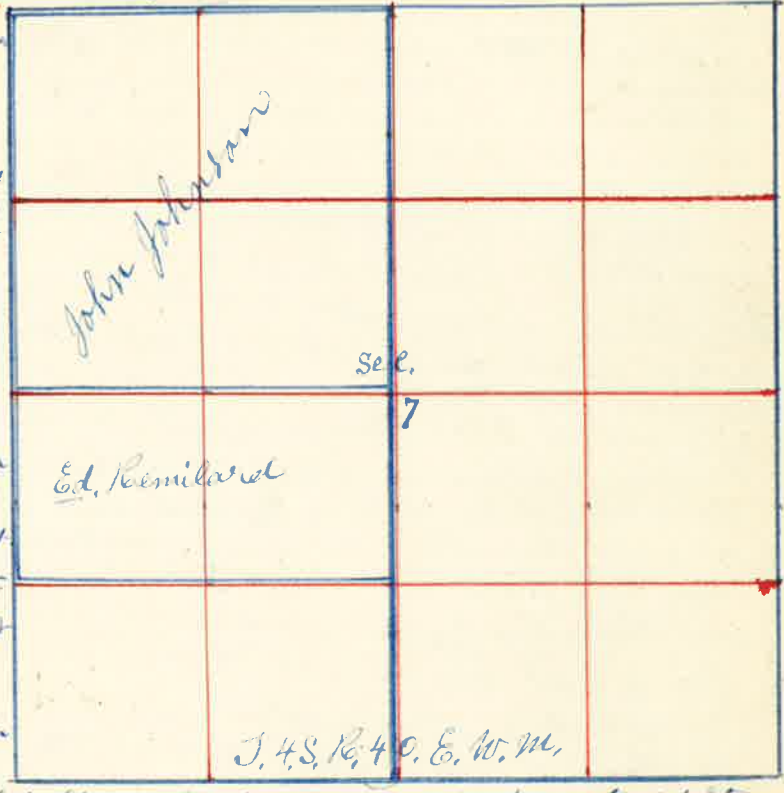

North and at 2007 chains set stone for 1/4 cor. end at 4014 set stone marked 1/4 on west face for 1/4 sec cor. between Sec 7 & 12, and at 8028 chains set stone for cor. to Sec 1-12-6 & 7 thence North at 4014 chains set stone for 1/4 sec cor. between Sec 1 & 6 and at 8028 chains the cor. to Sec 1-6-31 & 36 the corner to Sec 12-13-7-12 thence East at 3980 chains set stake for temporary 1/4 sec cor. at 7980 chains set support cor. to Sec 7-8-12 & 13 thence East at 3993 chains set stake for temporary 1/4 sec cor. and at 7989 chains the corner to Sec 8-9-16 & 17 the from which I run West and at 3993 chains a stone marked 1/4 at 7987 the cor. to Sec. 7-8-12-13 and thence West at 4001 chains set stake for 1/4 sec cor. between Sec 7 & 12. thence North at 40 chains set stake for 1/4 sec cor. the corner to Sec 5-6-7 & 8. thence North at 80 chains set stake for temporary corner to Sec 5-6-7 & 8. thence North at 8094 chains the N.E. corner Sec. 6 making an excess of 60 links in 2 miles from which I run South and at 8060 chains set stone for cor. to Sec 5-6-7 & 8 and at 4030 chains further on set stone for 1/4 sec cor. between Sec 7 & 8. 8030 sec cor. I then started at cor. to Sec 4-5-8 & 9 thence West at 8097 chains a stone at thence West at 40 chains set post at 8075 the N.W. cor. Sec. 7 from which I run East at 4004 chains set stone for 1/4 sec cor. between Sec 6 & 7 thence South at 4011 chains the center Sec 7 at 8022 chains 1/4 sec cor. on West side Sec 7 thence North 2006 chains set stake for 1/4 cor. the 1/4 sec cor. on West side Sec 7 thence East at 3989 chains the center Sec. 7.

J.W. Kimbrell Dept. Co Surveyor

Surveyed for Parcel Titus Haynes & Lee May 1st 1885

By J.W. Kimbrell Dept. Co. Surveyor Plat No. 33

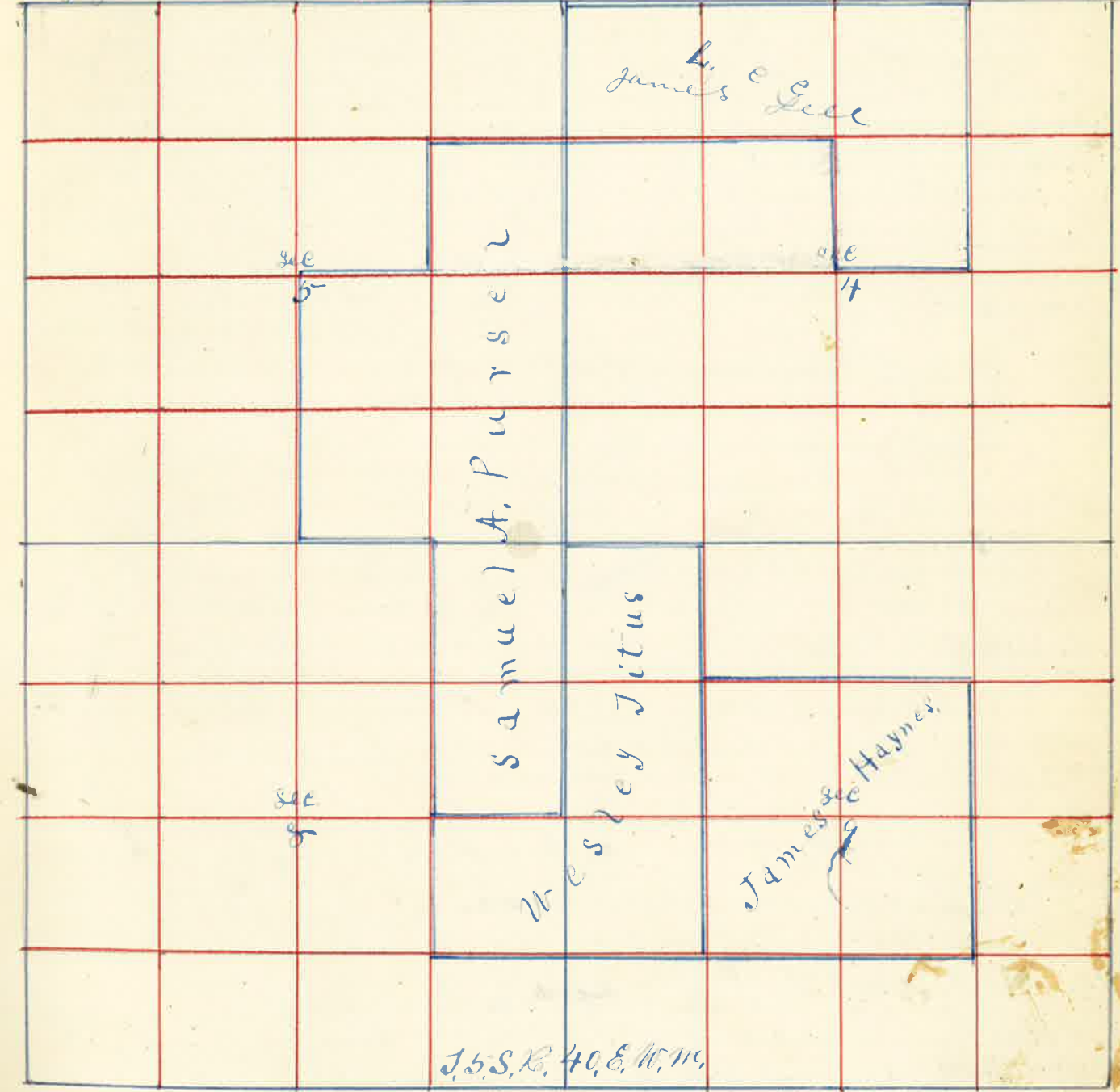

I started at the corner to Sec 4-5-8 & 9 thence I run East 20 chains set post for temporary 1/4 cor. 3986 chains 1/4 sec cor. from top of Sec 4 thence West 1993 chains set post in mound of stone the 1/4 sec cor. on North side Sec 9 thence East at 20 chains set stake at 4010 chains the N.E. cor. Sec 9 from which I run West at 2005 chains set post for 1/4 cor. the N.E. corner Sec 9 thence South 20 chains set post 4015 chains 1/4 sec cor. on East side Sec 9 from which I run North 2007 chains set post for 1/4 cor. the 1/4 sec. cor. on East side Sec 9 thence South 20 chains set post 4014 chains S.E. corner Sec 9 from which I run North 2007 chains set post for 1/4 cor. the S.E. corner thence West 20 chains set post 4012 chains 1/4 sec cor. on South side Sec 9 from which I run East 2006 chains set post for 1/4 cor.

in T.5S R.40 E. 11th. Surveyed for Hayes Lee Parcel of Titus May 2 1885

The 1/4 Sec corner on South Side Sec 9 thence west 20 chains set Post 4012 chains S.W. Corner Sec 9 from which I run East at 2006 chains set Post for 1/4 corner. The S.W. Corner Sec 9 thence North 20 chains set Post for 1/4 corner at 40 chains set Post for temporary 1/4 Sec corner 60 chains set Post for temporary 1/4 corner at 8027 chains the N.W. Corner Sec 9 from which I run South 2007 chains set Post for 1/4 corner 4014 chains Planted Stone marked 1/4 S or west face for 1/4 Sec. corners between Sec 8 & 9 at 6020 chains set Stake for 1/4 corner. thence I run west 20 chains and drove Stake for center S.E. 1/4 Sec 8.

I commenced at 1/4 Sec. Corner on west side Sec 9 thence I run East 20 chains set Stake at 40 chains set Post for center Sec 9 60 chains set Stake for 1/4 corner 8020 chains 1/4 Sec corner on East side Sec 9 from which I run West 2005 chains 1/4 corner 4010 chains center 6015 chains 1/4 corner.

I started at 1/4 Sec corner on North side Sec 9 thence I run South 20 chains set Post 3960 chains the center Sec 9. thence I run South 20 chains set Stake for 1/4 corner 3980 chains 1/4 Sec. corner on South side Sec 9 from which I run North 1990 chains set Post for 1/4 corner thence East 2006 chains set Post for center S.E. 1/4 Sec 9. The center S.W. 1/4 Sec 9 thence West 2007 chains set Post for center S.W. 1/4 Sec 9. The 1/4 corner on west side N.W. 1/4 Sec 9 thence East 20 chains set Post in mound of Stone for center N.W. 1/4 Sec 9.

thence East at 1993 chains the center N.W. 1/4 Sec 9 at 4005 chains set Post for center N.E. 1/4 Sec 9, May 2, 1885. I commenced at N.E. corner Sec 8 thence West 20 chains set Post at 4017 chains the 1/4 Sec corner from which I run East and at 2008 chains set Stake for 1/4 corner.

The 1/4 Sec corner on North side Sec 8 thence I run South 20 chains set Post 40 chains set Post at 8035 chains the 1/4 Sec corner on South side Sec 8 thence East - at 20 chains set Post at 4040 chains the S.E. corner Sec 8.

I started at 1/4 Sec corner on East side Sec 8 thence West 20 chains set Post 4000 chains set Post in mound of Stone for center Sec 8 from which I run East 2010 chains set Post for center S.E. 1/4 Sec 8.

The 1/4 Sec corner on South side Sec 5 at 40 chains set Post for temporary center at 8083 chains 1/4 Sec corner on North side Sec 5. from which I run East at 40 chains set Stake for temporary corner to Sec 4-5-32833. at 7940 1/4 Sec corner from which I run West on township line and at 3970 chains set Stone for corner to Sec. 4-5-32833.

The N.E. corner Sec 4 thence South at 40 chains set Post at 8075 chains the S.E. corner Sec 4 from which I run North and at 4015 chains established 1/4 Sec corner thence West at 20 chains set Stake for 1/4 corner at 40 chains set Stake for center Sec 4

7997 chains 1/4 Sec corner on West side Sec 4. I started at corner to Sec 4-5-32833 thence North 40 chains set Post for temporary 1/4 corner at 8027 chains corner to Sec 4-5-32833 from which I run South making a deficiency of 8 links at the U.S. field notes. Therefore I run South and at 2033 chains set Stone for 1/4 corner and at 3996 chains established 1/4 Sec corner on West face thence West 3990 chains center Sec 5.

J.W. Kimbrell Capt. Co. Surveyors

Surveyed for Bayland Leep. Prof. Hainey & Morrison June 21 1885

By J.W. Kimbrell Capt. Co. Surveyors Plat. No. 37

1890	1890	2004	2004	2005	2004		
3994		2005	2004	2005	2004		
1824	1976	2015	2015	2010	2005		
3994		4012		2007	2009		
1727	2011	4022		1998	1967		
1618		2003			1967		
	1877	2002		4023	2006		
		2002			2005		
		2003			2006		
4014		2002			2006		
1851	1851				2007		

I commenced this survey by Re-establishing the corner to Sec 6-7-12 and the 1/4 Sec corner between Sec 12 & 7 & 12 on Range line between townships 45 & 46 S. & S. The bearing due to the Sec corner U.S. Survey, a cottonwood 5 or 6 diameter bears N 50° E 275 links distant being cut down the of which is still in place. I therefore reestablished by planting a Post in mound of earth 8 1/2 inch dia. from which as a 3 inch dia. bears N 48° 45' E 102 links distant an as a 5 inch dia. bears S 24° W 77 links distant from this corner I run South 20° E at 40 chains set temporary stake for 1/4 Sec corner at 8036 chains the corner to Sec 7-12-12313 from which I run North 4018 chains set Stone marked for 1/4 Sec corner between Sec 7 & 12 8036 chains Sec. corner. thence North 21° E 40 chains set Post 7983 chains the N.W. corner Sec 6 from which