

**BASIS OF BEARING**  
 The South line of the Southeast quarter of Section 29 being North 89°28'12" East, as per Survey Number 013-2005

**SCALE: 1" = 500'**

- LEGEND**
- ⊙ Found 2 1/2" iron pipe with 3" brass cap, marked as per Union County Monumentation records
  - ⊙ Found 2 1/2" aluminum pipe with 2 1/2" aluminum cap, marked as per Union County Monumentation Records
  - ⊙ Set 2 1/2" x 30" aluminum pipe with 2 1/2" aluminum cap, marked as per Union County Monumentation Records
  - Set 5/8" x 30" iron pin with 2 1/2" aluminum cap, marked as per Union County Monumentation Records
  - Fenceline
  - ~ Road
  - ( ) Record measurement as per field notes of GLO contract number 388, executed by W.B. Barr
  - Set steel fencepost on line

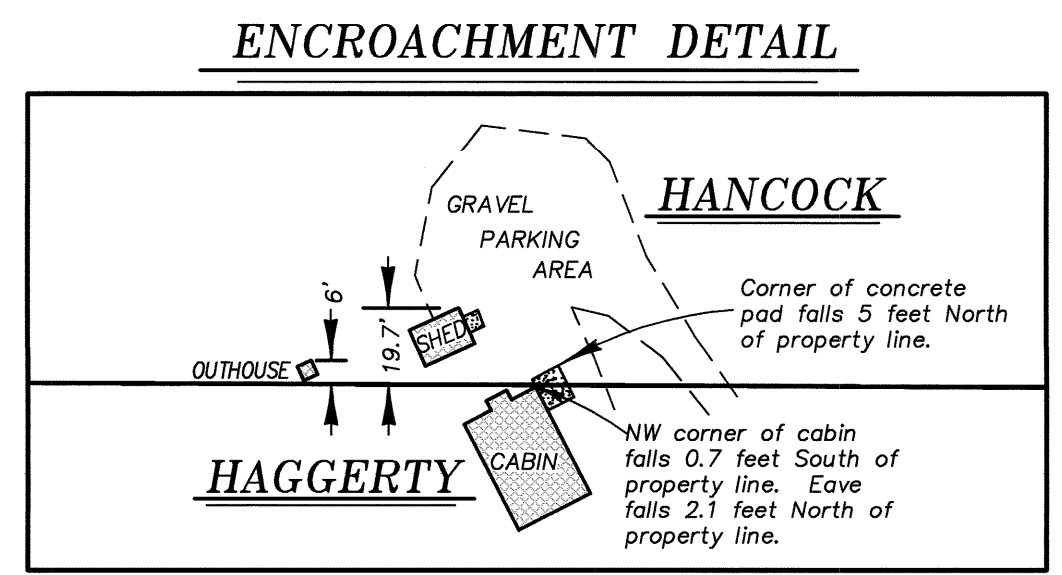

UNION COUNTY SURVEYOR

Date Received 6/27/16

Date Filed 6/27/16

By *Jeffrey S. HSU*

File No. 018-2016

**REFERENCE MATERIAL**

Union County Monumentation Records  
 Partition Plat 2008-0015T  
 Partition Plat 2007-0041T  
 Survey Number 013-1991  
 Survey Number 020-2003  
 Survey Number 013-2005

Field Notes of GLO Contract Number 388, dated May 7, 1881, executed by W.B. Barr

**DEED REFERENCES**  
 Book 147, Page 205  
 Microfilm Document Number 135714  
 Microfilm Document Number 20085572  
 Microfilm Document Number 20104345  
 Microfilm Document Number 20134272

**NARRATIVE**

This survey was done at the request of Patrick Marolla on behalf of Hancock Forest Management, land manager for the land within. Mr. Marolla wanted select lines monumented and posted with steel fenceposts prior to a timber harvest. I find and accept monuments as shown hereon. At the Northwest corner of Section 29, I find the original Northwest bearing tree and set the monument at record bearing and distance from the tree. I find no remains of the original GLO corner at the quarter corner between Sections 28 and 33, however, there is a 1 1/4" iron pipe from which an ancient fenceline extends Northerly. The fenceline is likely over 60 years old as evidenced by ring count on high stumped trees where the barbed wire was attached. I find the position harmonious with record GLO bearing and distance. There appears to be a history of unrecorded pipes in this area, as the Southwest corner of Section 28 was a long accepted pipe with a history of acceptance. I therefore accept this pipe as a perpetuation of the original GLO corner.

At the East quarter corner of Section 29, I find a similar pipe with an ancient fence of similar vintage at the one mentioned above, extending to the West. The position, however, is much more suspect as it would put a 1'30" skew heading to the South and over a 3' skew heading Northerly. I therefore reject this pipe as being representative of the original GLO corner position. Finding no remaining original GLO evidence, I place the corner at proportionate position. Boise Cascade corner record, date unknown, depicts the North quarter corner of Section 29 to be on the East side of an old logging road. Having no means of accurately placing this position or any available physical evidence on the ground, despite recognizing that the proportion position places the corner on the West side of this road, I have no choice but to resort to a proportioned position. I find no remaining evidence at the West quarter corner position and place this corner at proportionate position.

Subdivision of the Section is as per BLM Manual of Instructions.

Fenceline along the posted lines are quite erratic in nature and are off of title lines as shown. There is a notable encroachment along the South line of Section 28 along the line common with Haggerty where two outbuildings and a graveled parking/turnaround area fall North of the line as shown hereon.

I find no other unusual conditions with this survey.

REGISTERED PROFESSIONAL LAND SURVEYOR

*Jeffrey S. HSU*

OREGON JUNE 2, 2010

JEFFREY S. HSU 83571

Renewal Date: June 30, 2017

**BAGETT, GRIFFITH & BLACKMAN**  
 2006 Adams Avenue, LaGrande, Oregon  
 Map of Survey

Situate in Sections 28 and 29, Township 4 South, Range 38 East of the Willamette Meridian

UNION COUNTY, OREGON

SURVEYED FOR	Hancock Forest Management
SURVEYED BY	J. S. H.
Scale: 1" = 500'	Drawn by: J. S. H. June 2016