

BASIS OF BEARING

Forward bearing as published by the U.S.C. and G.S. from Δ COLLEGE to Δ VALLEY Dated 1946.

SCALE: 1" = 100'

LEGEND

- Found 5/8" iron pin with plastic cap marked BGB SURVEY MARKER set by Partition Plat Number 1996-08
- ▲ Found 5/8" iron pin set by Survey Number 33-80
- ◆ Found 5/8" iron pin set by Survey Number 26-81
- Found 1/2" unrecorded iron pipe, as per Survey Number 26-81
- ◇ Found 2 1/2" brass cap set as initial point of Evans Subdivision
- ⊕ Found 2 1/2" brass cap, set by Survey Number 13-88
- ⬢ Found 3/4" iron pipe, set by Survey Number 021-1991
- ⊙ Found 3/4" iron pipe set by survey Number 18-89 (1922 monumentation)
- ⊕ Found 2 1/2" brass plaque, as per Partition Plat Number 1996-08
- ⊙ Set 2" brass cap in concrete marked BGB SURVEY MARKER
- Set cotton spindle as reference
- [] Record measurement as per Survey Number 26-81
- { } Record measurement as per Survey Number 30-79
- () Record measurement as per Survey Number 18-89 (1922 monumentation of La Grande)
- / / Record measurement as per Survey Number 001-1993
- - Record measurement as per Partition Plat Number 1996-08

REFERENCE MATERIAL

Survey Number 143
 Survey Number 1-69
 Survey Number 109-77
 Survey Number 30-79
 Survey Number 33-80
 Survey Number 26-81
 Survey Number 13-88
 Survey Number 021-1991
 Survey Number 030-1991
 Survey Number 024-1992
 Survey Number 001-1993
 Partition Plat Number 1996-08
 Partition Plat Number 20060019T
 Plat of Evans Subdivision
 Supplemental Plat of Grandy's Addition

NARRATIVE

This survey was done at the request of Norm Paullus, public works director for the City of La Grande. Mr. Paullus wanted the centerline monument of Alder and Grandy replaced following a paving project. I find no remains of the original McIn pipes in Jefferson Street. The monuments set by Partition Plat 1996-008, Survey 33-80 and Evans subdivision are harmonious with record dimensions as per Survey Number 001-1993. I find relative harmony with the measurements Northward to monuments on Palmer as per Survey 26-81 as well. I place the centerline intersection as per Survey Number 001-1993 from the centerline monument in Adams and Walnut. I find no other unusual conditions with this survey.

DETAIL SCALE 1" = 50'

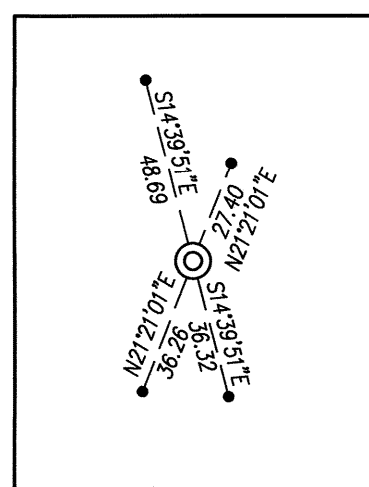

REGISTERED
 PROFESSIONAL
 LAND SURVEYOR

Jeffrey S. Hsu
 OREGON
 JUNE 2, 2010
 JEFFREY S. HSU
 83571

Renewal Date: June 30, 2017

UNION COUNTY
 SURVEYOR
 Date Received 5/27/15
 Date Filed 5/27/15
 By Jeffrey S. Hsu
 File No. 033-2015

BAGETT, GRIFFITH & BLACKMAN
 2006 Adams Avenue, LaGrande, Oregon
 Map of Survey

Monumentation of intersection of Grandy Avenue and Alder Street, City of La Grande

UNION COUNTY, OREGON		
SURVEYED FOR	City of La Grande	
SURVEYED BY	J. S. H.	
Scale: 1" = 100'	Drawn by: J. S. H.	Feb.-May 2015

SURVEY NUMBER 033-2015