

9 10
16 15

(N. 89° 14' W., 40.40 CHAINS - W.B. BARR)

APPROXIMATE SECTION CORNER
BASED UPON GLO NOTES

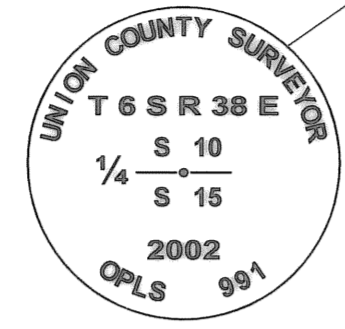

NORTH 1/4 CORNER OF SECTION 15.
ORIGINAL STONE FOUND BY BILL WELLS.
MONUMENTED BY GREG BLACKMAN,
UNION COUNTY SURVEYOR, ON MAY 22, 2002.

10 11
15 14

APPROXIMATE SECTION CORNER
UPON GLO NOTES. ALSO FOUND 1 1/2" I.D. PIPE
SET IN SMALL MOUND OF STONES, SET
BY UNION COUNTY SURVEY NO. 61-72,
145'± NORTH & 60'± WEST.

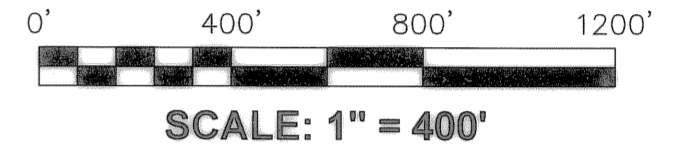

LEGEND

- Set 2 1/2" brass cap on a 1" x 30" galvanized steel pipe.
- ⊙ Found brass cap monument as noted.
- ⊕ Found aluminum cap monument as noted.
- () Original G.L.O. Bearing & Distance.
- [] Record Data Per Union County Survey No. 033-90.
- x — x — x — Fence Line.

(NORTH, 40 CHAINS - W.B. BARR)

FOUND 2 1/2" BRASS CAP MONUMENT
SET BY UNION COUNTY SURVEY NO.
59-90R.

S. 88° 17' 20" E., 5372.20'

15

2712.0'

2660.2'

N. 0° 08' 24" E., 5339.1'

SET 12" SPIKE AT FENCE INTERSECTION.
FENCES RUN NORTH, SOUTH & EAST
FROM INTERSECTION. FENCE REMAINS
TRACED OUT, WEST TO THE APPROX.
CENTER 1/4 CORNER OF SECTION 15.

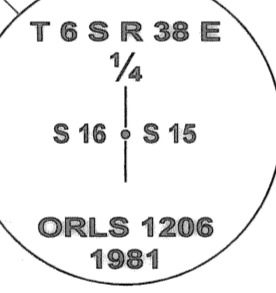

BASIS OF BEARING

[N. 0° 16' 41" W., 2650.74']
[N. 0° 16' 41" W., 2649.53']
(NORTH, 40 CHAINS - W.B. BARR)

UNION COUNTY SURVEYOR	
Date Received	5/25/06
Date Filed	5/25/06
By	Greg T. Blackman
File No.	018-2006

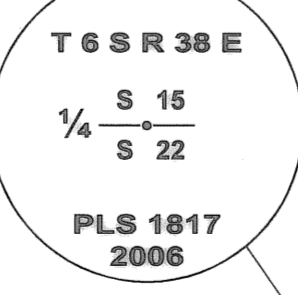

REMAINS OF OLD FENCE CORNER. ORIGINAL
GLO STONE SET BY W.B. BARR WAS EXTENSIVELY
SEARCHED FOR BUT NOT FOUND. CORNER
DECLARED OBLITERATED. CORNER MONUMENTED
BY HANLEY ENGINEERING, INC. ON MAY 22, 2006.
NOTE: ALL BEARINGS AND DISTANCES SHOWN
HEREON ARE TO THE FENCE CORNER, AS THE
MONUMENT HAS YET TO BE TIED TO BY SURVEY.

(NORTH, 40 CHAINS - THOMPSON & CHAPLIN)

SKETCH OF SURVEY
LOCATED IN SECTION 15,
T. 6 S., R. 38 E., W.M., UNION COUNTY, OREGON
Surveyed November 4, 2005 thru May 3, 2006
for Chris Heffernan
Scale: 1" = 400'

HANLEY ENGINEERING, INC.
P.O. BOX 701, 204J MAIN STREET, BAKER CITY, OREGON 97814 (541) 523-3803

FENCE INTERSECTION ACCEPTED AS
THE SOUTHWEST CORNER OF SECTION 15
BY UNION COUNTY SURVEY NO. 45-78.
SET DRILLED NAIL AT INTERSECTION.
FENCES RUN WEST & SOUTH FROM
FENCE INTERSECTION.

FENCE INTERSECTION WAS ACCEPTED AS THE
SOUTHEAST CORNER OF SECTION 15 BY
UNION COUNTY SURVEY NO. 008-1994.
FENCES RUN EAST, WEST & NORTH.
SET NAIL APPROX. 3" NORTH OF R.R.
TIE AT FENCE INTERSECTION.

REGISTERED
PROFESSIONAL
LAND SURVEYOR

THOMAS J. HANLEY
OREGON
JULY 13, 1979
THOMAS J. HANLEY
1817

16 15
21 22

(N. 89° 19' W., 40.30 CHAINS - W.B. BARR)
S. 86° 35' 04" E., 2696.0' - TO FENCE CORNER

(N. 89° 19' W., 40.30 CHAINS - W.B. BARR)
S. 89° 48' 05" E., 2536.2' - TO FENCE CORNER

15 14
22 23

Renews June 30, 2007