

# SKIDDER/EAGLE CAP WILDERNESS SURVEY

## WALLOWA-WHITMAN NATIONAL FOREST

### COVER SHEET

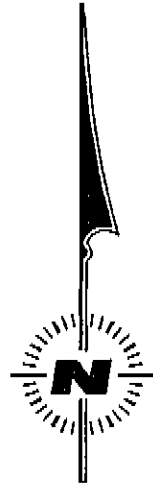

### NOTES

BASIS OF BEARING WAS SOLAR OBSERVATION TAKEN ON 05/30/1992 AT A GPS CONTROL STATION MORIAH 104 FEET SOUTH AND 51 FEET WEST OF THE SE CORNER OF SECTION 8. THE MAGNETIC DECLINATION FOR THIS SURVEY IS 18 1/2' EAST AS DETERMINED FROM A U.S.G.S. TOPO MAP FOR THIS PROJECT AREA.

THIS SURVEY REPRESENTS A RECORD OF THE PARTIAL RETRACEMENT OF THE EAGLE CAP WILDERNESS AND A PORTION OF T 1 S, R 41 E, W.M., UNION COUNTY, OREGON.

THIS SURVEY WAS PERFORMED AT THE REQUEST OF THE FOREST SUPERVISOR, WALLOWA-WHITMAN NATIONAL FOREST, BAKER CITY, OREGON.

THE PURPOSE OF THIS SURVEY WAS TO DETERMINE THE EAGLE CAP WILDERNESS BOUNDARY ADMINISTERED BY THE U.S. FOREST SERVICE THRU A PORTION OF T 1 S, R 41 E, W.M. AND TO POST TO STANDARD THOSE BOUNDARIES.

THE PROCEDURES USED IN THIS SURVEY WERE IN ACCORDANCE WITH THE CONTRACT SPECIFICATIONS, THE 1973 B-L-M MANUAL AND STATE LAW, RESULTING IN AN ERROR OF CLOSURE OF 1 AND 5000 OR BETTER.

THE EQUIPMENT USED ON THIS SURVEY IS KEPT ADJUSTED AND STANDARDIZED. WE USED A SOKKIA SET 2, 3 OR 4 TOTAL STATION AND LEAP FROGGED A COMPLETE SET UP AT EACH TRAVERSE STATION OR CONTROLLING CORNER. TRIMBLE 4000SE STATIC GPS RECEIVERS WERE USED ALONG WITH REV. E TRIMVEC SOFTWARE TO CLOSE THE CONTROL TRAVERSE OF THIS SURVEY.

LOST OR OBLITERATED CORNERS WERE REESTABLISHED IN ACCORDANCE WITH THE B-L-M MANUAL, A COMPLETE DESCRIPTION OF THE CORNERS FOUND, SET OR REESTABLISHED CAN BE FOUND ON PAGES 6 & 7 OF THIS RECORD OF SURVEY. THE FIELD NOTES FOR THIS SURVEY ARE CONTAINED IN BOOK 1, PAGES 1 - 84, TITLED: SKIDDER CADASTRAL SURVEY, 1992 - 1994.

### LEGEND

- FOUND ORIGINAL EVIDENCE, SET A 3" DIAM. U.S.F.S. ALUMINUM CAPPED PIPE, 30" LONG, WITH MAGNET, MARKED PER B-L-M MANUAL, SEE TYPICAL CAP FOR STANDARD MARKINGS
- FOUND A 3" DIAM. ALUMINUM CAPPED PIPE MONUMENT, SEE CORNER NOTES
- FOUND A U.S.G.S. BRASS TABLET CONTROL STATION
- ▲ FOUND A 3" DIAM. ALUMINUM TABLET MONUMENT GPS CONTROL STATION
- ⊙ SET A 3" DIAM. U.S.F.S. ALUMINUM CAPPED PIPE, 30" LONG, WITH MAGNET, MARKED PER B-L-M MANUAL, SEE TYPICAL CAP FOR STANDARD MARKINGS
- [ ] RECORD BEARING AND/OR DISTANCE, G-L-O, 1898
- (ECW) = NATIONAL FOREST SYSTEM LANDS DESIGNATED AS EAGLE CAP WILDERNESS AREA ARE POSTED TO STANDARD
- NFSL NATIONAL FOREST SYSTEM LANDS

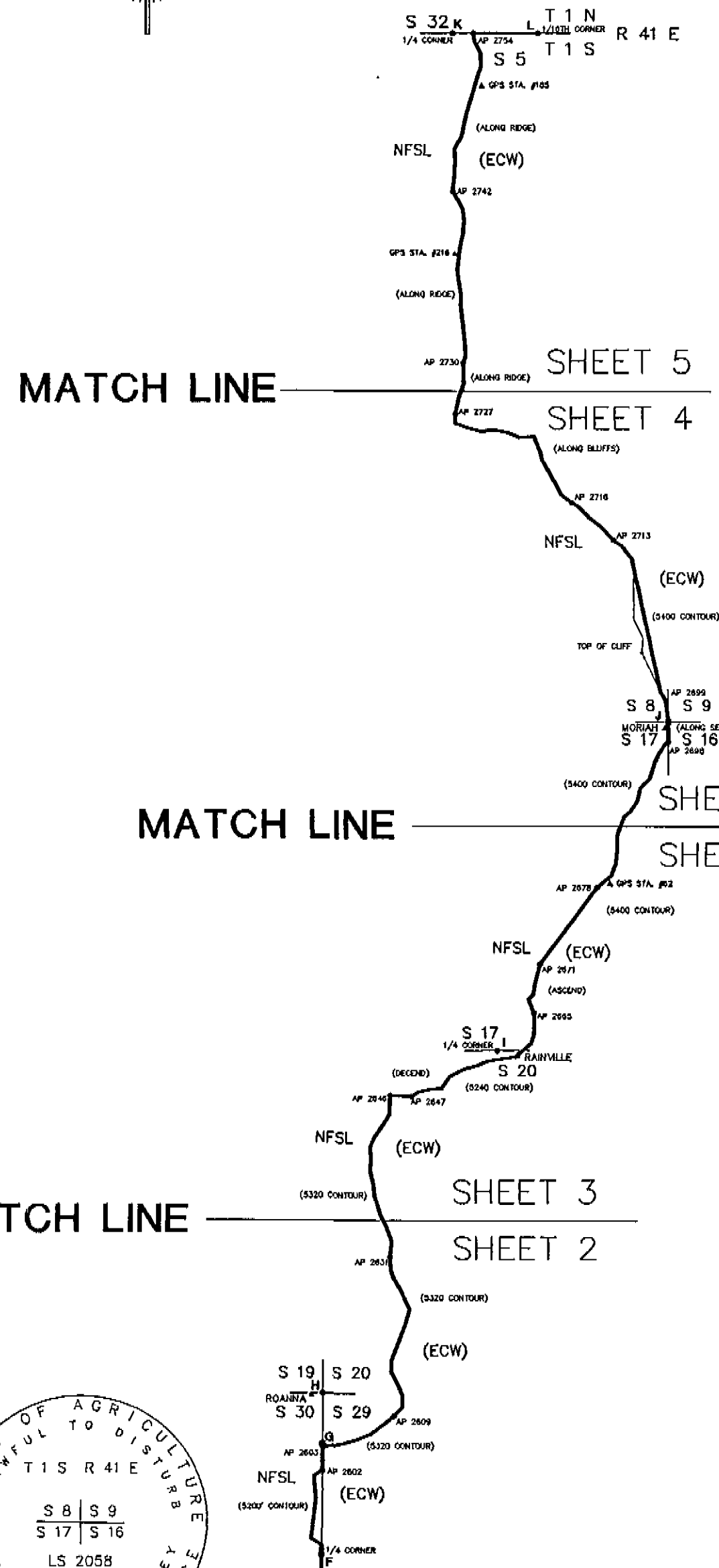
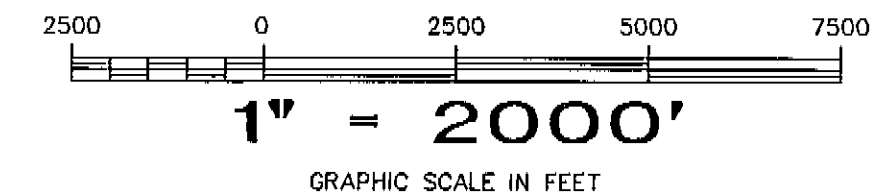

### HISTORY OF SURVEYS

TOWNSHIP 1 SOUTH, RANGE 41 EAST:  
 1898: A. GENSNER SURVEYED THE SUBDIVISIONAL LINES OF THE TOWNSHIP.  
 1988: B.A. SUTTON SURVEYED SECTIONS 18,19 & 30 AND THE WEST LINE OF SECTION 31.  
 EAGLE CAP WILDERNESS LEGAL DESCRIPTION  
 1987; JAMES F. TORRENCE, USFS, REGIONAL FORESTER, DESCRIPTION OF WILDERNESS BOUNDARY  
 EAGLE CAP WILDERNESS GPS SURVEY  
 1992; ROGER GREEN, LS, USFS, PERFORMED A GEODETIC CONTROL SURVEY

### SURVEYORS CERTIFICATE

THIS PLAT CORRECTLY REPRESENTS A SURVEY MADE BY ME OR UNDER MY DIRECTION IN CONFORMANCE WITH THE STATUTES OF OREGON AND AT THE REQUEST OF THE U.S.D.A. FOREST SERVICE, WALLOWA-WHITMAN NATIONAL FOREST, DURING THE MONTHS OF MAY 1992 THRU SEPTEMBER 1994  
 RONALD E. STOLL, L.S. 2058.

<b>UNION COUNTY SURVEYOR</b>
Date Received <u>12/18/98</u>
Date Filed <u>12/18/98</u>
By <u>R. Robinson, Deputy</u>
File No. <u>051-1998</u>

REGISTERED PROFESSIONAL LAND SURVEYOR
<i>Ronald E. Stoll</i> 10/98
OREGON JULY 15, 1983 RONALD E. STOLL 2058

RONALD E. STOLL, LS 2058

EXAMINED AND ACCEPTED FOR THE U.S. FOREST SERVICE THIS <u>8th</u> DAY OF <u>DECEMBER</u> , 1998.
<i>Roger Green</i> COR
I CERTIFY THAT THIS SURVEY WAS PERFORMED AT THE REQUEST OF THE WALLOWA-WHITMAN NATIONAL FOREST SUPERVISOR.
<i>Kenneth A. Wood</i> SIGNATURE <u>12.16.98</u> DATE

A PORTION OF
T 1 S R 41 E W.M.
UNION COUNTY, OREGON
RECORD OF SURVEY
RES LAND SURVEYS, INC.      8335 N. PLACITA DADIVOSO TUCSON, ARIZONA 85704

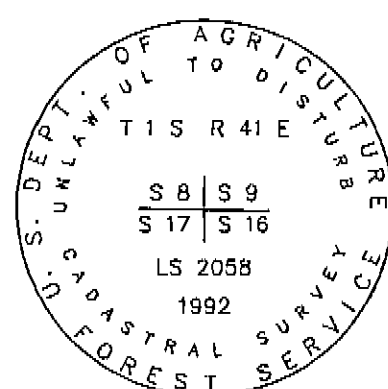

TYPICAL FOREST SERVICE CAP MARKED PER B-L-M MANUAL

JOB NO. 1227  
 CONTRACT NO. 53-04M3-1-0163  
 SHEET 1 OF 7

# SKIDDER/EAGLE CAP WILDERNESS SURVEY

## WALLOWA-WHITMAN NATIONAL FOREST

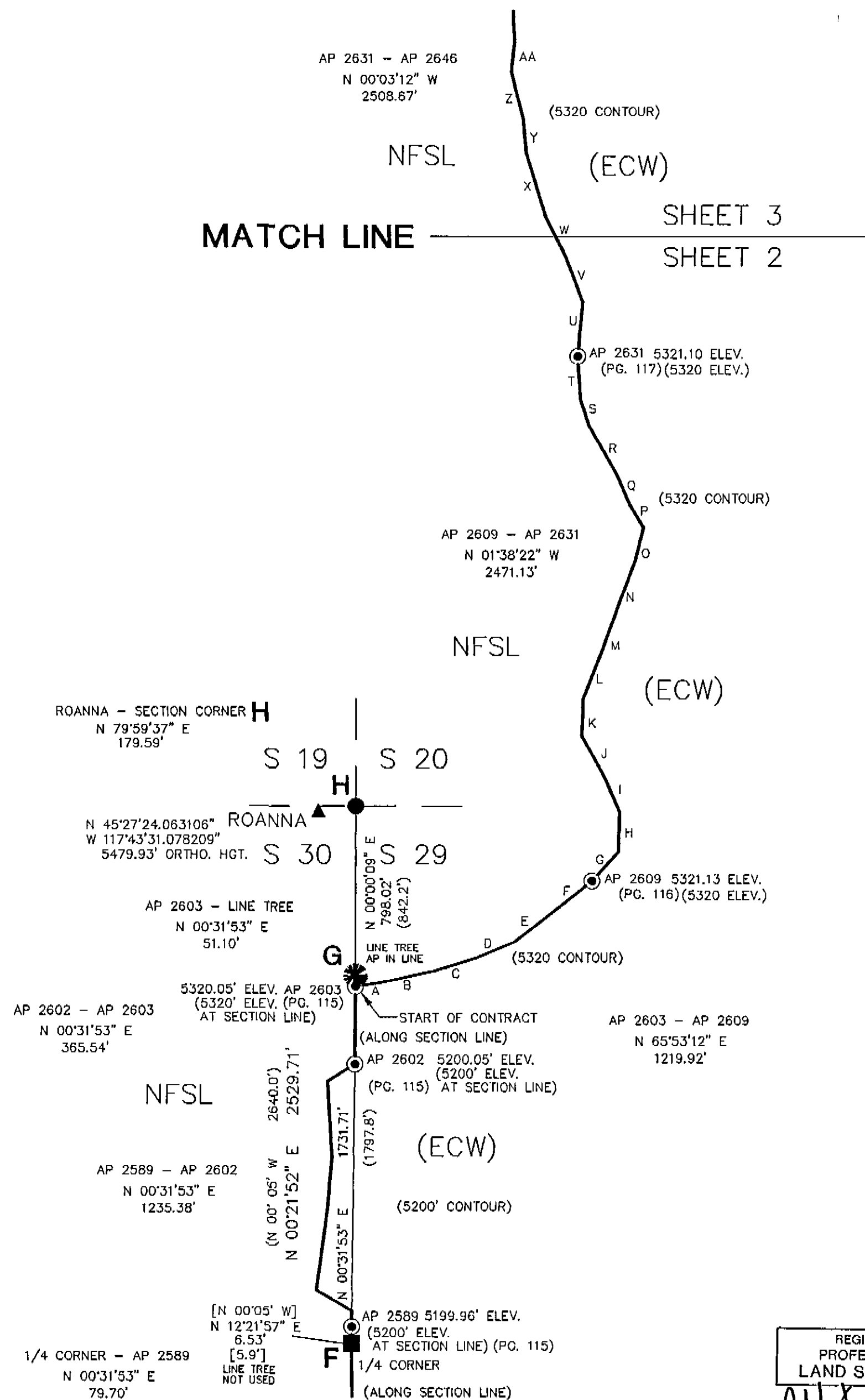

**LINE TABLE**

LINE	DIRECTION	DISTANCE
A	N 80°27' E	165.4'
B	N 77°33' E	216.9'
C	N 72°34' E	197.4'
D	N 67°23' E	202.4'
E	N 51°46' E	313.2'
F	N 51°29' E	150.0'
G	N 42°17' E	184.4'
H	N 01°40' E	187.5'
I	N 23°36' W	204.5'
J	N 29°38' W	196.1'
K	N 02°00' E	174.5'
L	N 21°07' E	233.6'
M	N 19°51' E	233.3'
N	N 20°25' E	227.5'
O	N 14°28' E	162.1'
P	N 31°00' W	123.2'
Q	N 23°55' W	163.7'
R	N 29°17' W	266.3'
S	N 17°39' W	122.7'
T	N 03°47' W	202.6'
U	N 05°06' E	259.7'
V	N 20°36' W	227.3'
W	N 26°46' W	214.1'
X	N 17°04' W	311.6'
Y	N 04°37' W	150.6'
Z	N 14°00' W	238.9'
AA	N 06°12' E	139.5'

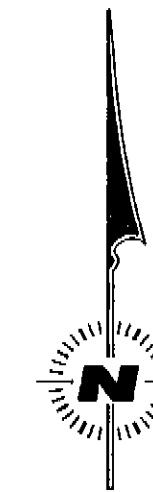

**LEGEND**

- FOUND ORIGINAL EVIDENCE, SET A 3" DIAM. U.S.F.S. ALUMINUM CAPPED PIPE, 30" LONG, WITH MAGNET, MARKED PER B-L-M MANUAL, SEE TYPICAL CAP FOR STANDARD MARKINGS
- FOUND A 3" DIAM. ALUMINUM CAPPED PIPE MONUMENT, SEE CORNER NOTES
- ▣ FOUND A U.S.G.S. BRASS TABLET CONTROL STATION
- ▲ FOUND A 3" DIAM. ALUMINUM TABLET MONUMENT GPS CONTROL STATION
- ⊙ SET A 3" DIAM. U.S.F.S. ALUMINUM CAPPED PIPE, 30" LONG, WITH MAGNET, MARKED PER B-L-M MANUAL, SEE TYPICAL CAP FOR STANDARD MARKINGS
- [ ] RECORD BEARING AND/OR DISTANCE, G-L-O, 1898
- (ECW) = NATIONAL FOREST SYSTEM LANDS DESIGNATED AS EAGLE CAP WILDERNESS AREA ARE POSTED TO STANDARD
- NFSL NATIONAL FOREST SYSTEM LANDS

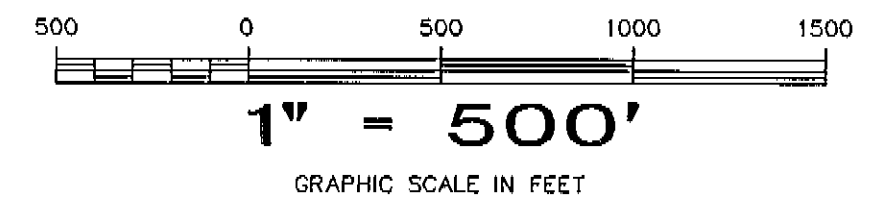

REGISTERED  
PROFESSIONAL  
LAND SURVEYOR

*Ronald E. Stoll* 10/198

OREGON  
JULY 15, 1983  
RONALD E. STOLL  
2058

RONALD E. STOLL, LS 2058

JOB NO. 1227  
CONTRACT NO. 53-04M3-1-0163  
SHEET 2 OF 7

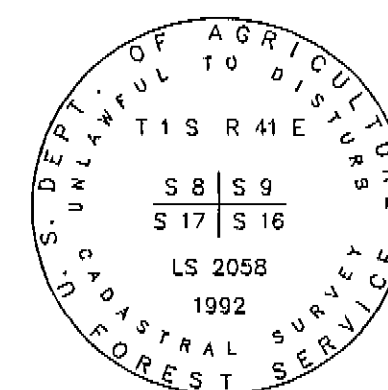

TYPICAL FOREST SERVICE CAP  
MARKED PER B-L-M MANUAL

A PORTION OF

# T 1 S R 41 E W.M.

UNION COUNTY, OREGON

---

## RECORD OF SURVEY

---

RES LAND SURVEYS, INC. 8335 N. PLACITA DADIVOSO  
TUCSON, ARIZONA 85704

SKIDDER/EAGLE CAP  
WALLOWA--WHITMAN

WILDERNESS SURVEY  
NATIONAL FOREST

LINE TABLE

LINE	DIRECTION	DISTANCE
S	N 17°39' W	122.7'
T	N 03°47' W	202.6'
U	N 05°06' E	259.7'
V	N 20°36' W	227.3'
W	N 26°46' W	214.1'
X	N 17°04' W	311.6'
Y	N 04°37' W	150.6'
Z	N 14°00' W	238.9'
AA	N 06°12' E	139.5'
AB	N 02°42' W	218.2'
AC	N 23°29' E	178.4'
AD	N 33°45' E	248.4'
AE	N 31°59' E	169.6'
AF	N 01°31' E	170.3'
AG	N 01°54' E	125.4'
AH	S 86°36' E	186.6'
AI	S 86°55' E	138.9'
AJ	N 58°12' E	130.4'
AK	N 76°50' E	206.0'
AL	N 87°01' E	160.9'
AM	N 34°30' E	233.3'
AN	N 62°34' E	265.8'
AO	N 76°01' E	183.0'
AP	N 67°29' E	200.2'
AQ	N 81°31' E	424.1'
AR	N 48°51' E	318.3'
AS	N 17°18' E	148.2'
AT	N 03°17' E	196.4'
AU	N 04°23' W	135.5'
AV	N 21°19' W	234.9'
AX	N 43°34' E	110.5'
AY	N 07°49' E	138.4'
AZ	N 13°58' E	340.0'
BA	N 37°04' E	470.3'
BB	N 36°40' E	1014.4'
BC	N 50°11' E	261.1'
BD	N 21°43' E	215.1'
BE	N 04°31' E	202.2'
BF	N 00°09' W	239.3'
BG	N 20°00' E	311.4'
BH	N 48°30' E	141.6'
BI	N 32°31' E	187.0'
BJ	N 13°10' E	194.7'
BK	N 43°21' E	215.4'
BL	N 18°01' E	153.1'
BM	N 16°52' E	114.8'
BN	N 26°10' E	149.4'

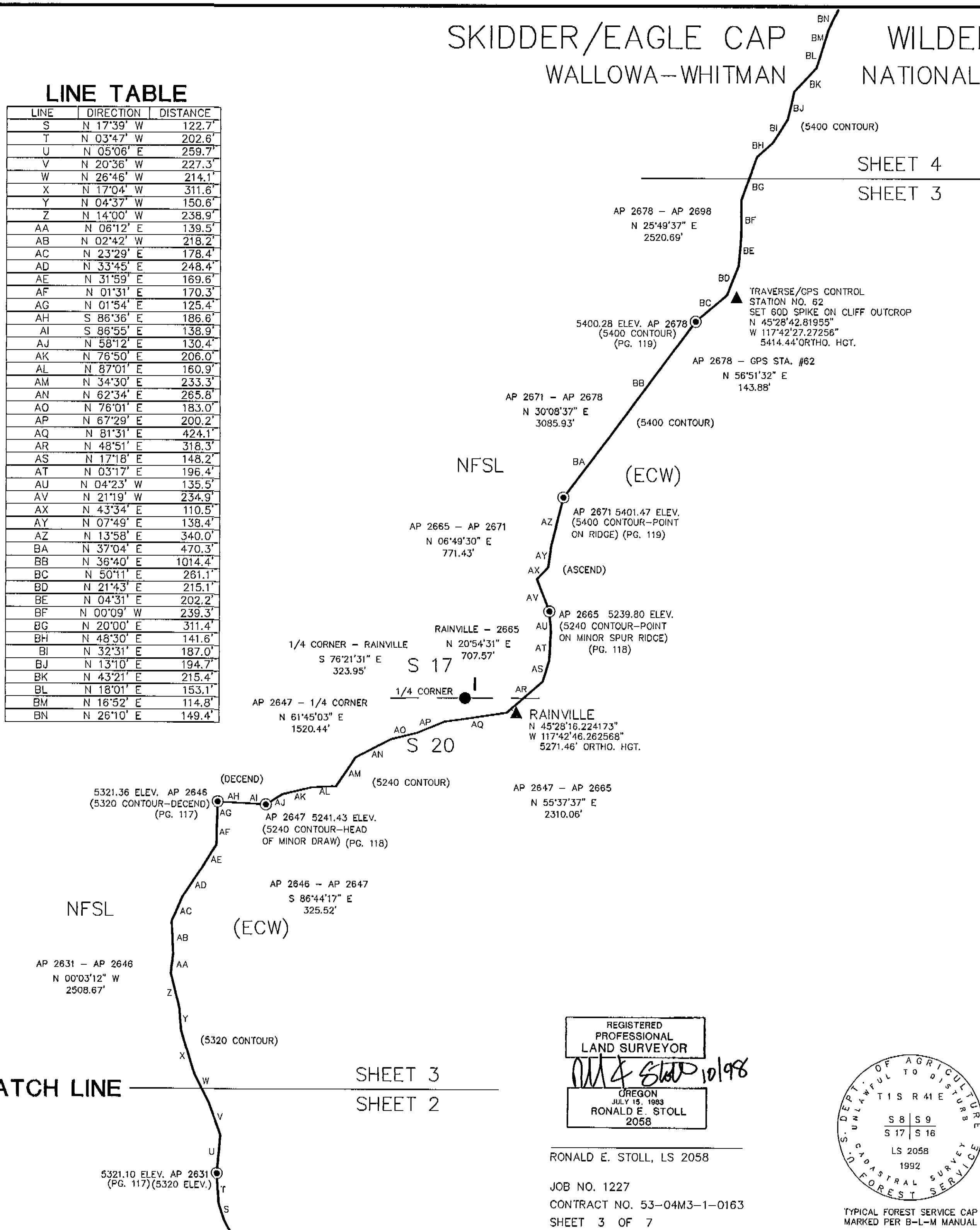

SHEET 4  
SHEET 3  
MATCH LINE

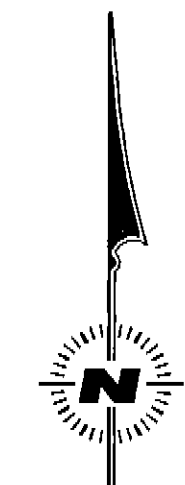

LEGEND

- FOUND ORIGINAL EVIDENCE, SET A 3" DIAM. U.S.F.S. ALUMINUM CAPPED PIPE, 30" LONG, WITH MAGNET, MARKED PER B-L-M MANUAL, SEE TYPICAL CAP FOR STANDARD MARKINGS
- FOUND A 3" DIAM. ALUMINUM CAPPED PIPE MONUMENT, SEE CORNER NOTES
- FOUND A U.S.G.S. BRASS TABLET CONTROL STATION
- ▲ FOUND A 3" DIAM. ALUMINUM TABLET MONUMENT GPS CONTROL STATION
- ⊙ SET A 3" DIAM. U.S.F.S. ALUMINUM CAPPED PIPE, 30" LONG, WITH MAGNET, MARKED PER B-L-M MANUAL, SEE TYPICAL CAP FOR STANDARD MARKINGS
- [ ] RECORD BEARING AND/OR DISTANCE, G-L-O, 1898
- (ECW) = NATIONAL FOREST SYSTEM LANDS DESIGNATED AS EAGLE CAP WILDERNESS AREA ARE POSTED TO STANDARD
- NFSL NATIONAL FOREST SYSTEM LANDS

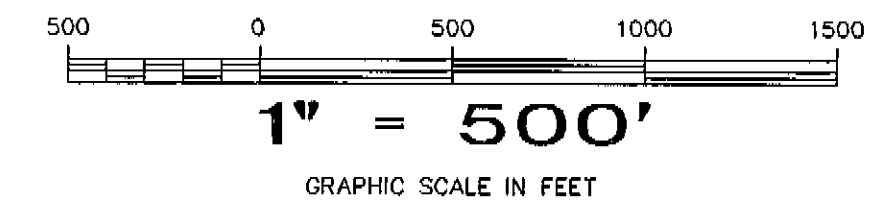

REGISTERED  
PROFESSIONAL  
LAND SURVEYOR  
*Ronald E. Stoll* 10/98  
OREGON  
JULY 15, 1983  
RONALD E. STOLL  
2058

RONALD E. STOLL, LS 2058

JOB NO. 1227  
CONTRACT NO. 53-04M3-1-0163  
SHEET 3 OF 7

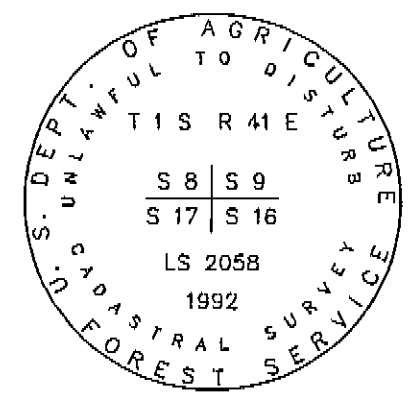

TYPICAL FOREST SERVICE CAP  
MARKED PER B-L-M MANUAL

A PORTION OF  
T 1 S R 41 E W.M.  
UNION COUNTY, OREGON

RECORD OF SURVEY

RES LAND SURVEYS, INC. 8335 N. PLACITA DADIVOSO  
TUCSON, ARIZONA 85704

MATCH LINE  
SHEET 3  
SHEET 2

# SKIDDER/EAGLE CAP WILDERNESS SURVEY WALLOWA-WHITMAN NATIONAL FOREST

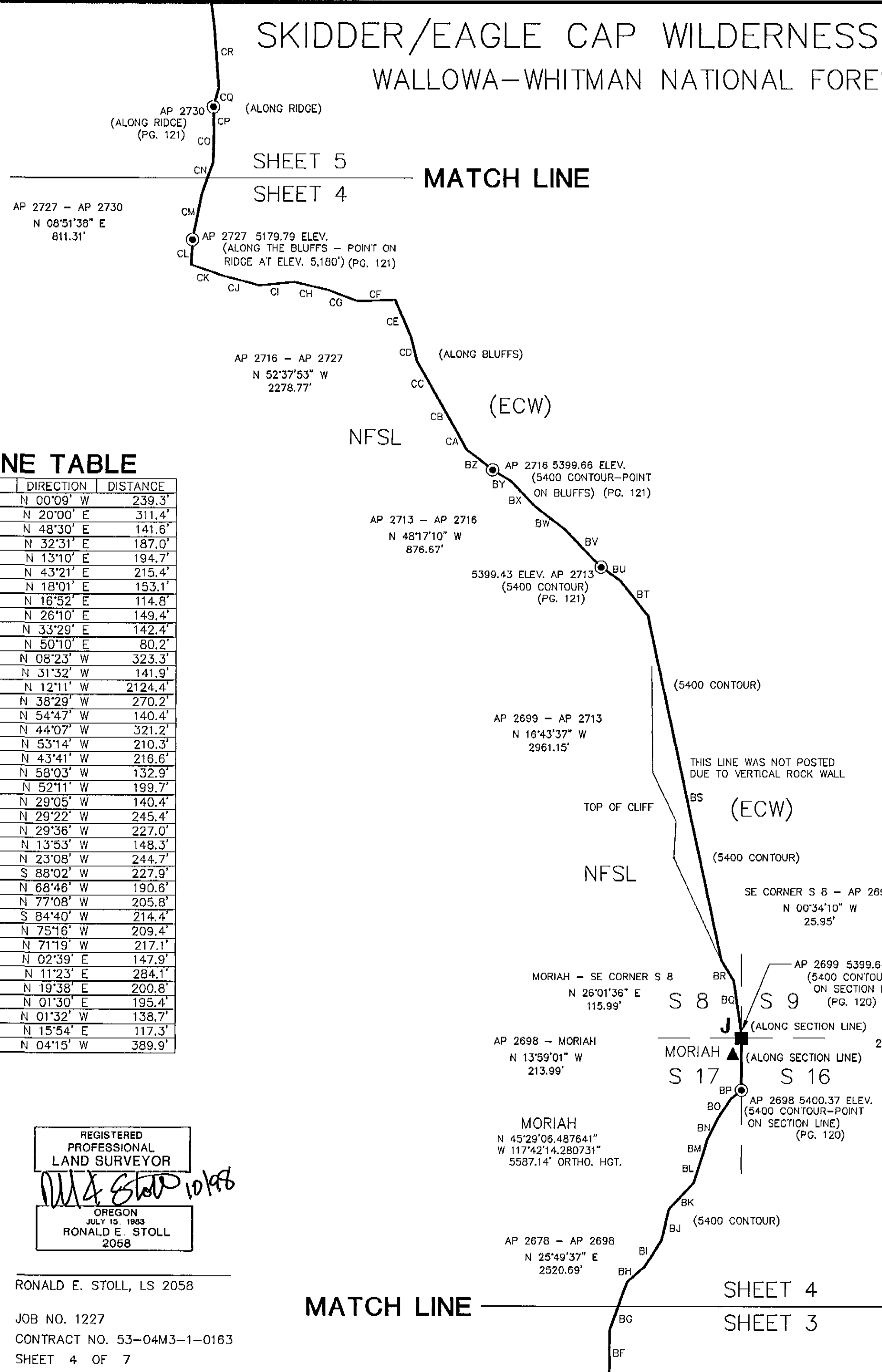

**LINE TABLE**

LINE	DIRECTION	DISTANCE
BF	N 00°09' W	239.3'
BG	N 20°00' E	311.4'
BH	N 48°30' E	141.6'
BI	N 32°31' E	187.0'
BJ	N 13°10' E	194.7'
BK	N 43°21' E	215.4'
BL	N 18°01' E	153.1'
BM	N 16°52' E	114.8'
BN	N 26°10' E	149.4'
BO	N 33°29' E	142.4'
BP	N 50°10' E	80.2'
BQ	N 08°23' W	323.3'
BR	N 31°32' W	141.9'
BS	N 12°11' W	212.4'
BT	N 38°29' W	270.2'
BU	N 54°47' W	140.4'
BV	N 44°07' W	321.2'
BW	N 53°14' W	210.3'
BX	N 43°41' W	216.6'
BY	N 58°03' W	132.9'
BZ	N 52°11' W	199.7'
CA	N 29°05' W	140.4'
CB	N 29°22' W	245.4'
CC	N 29°36' W	227.0'
CD	N 13°53' W	148.3'
CE	N 23°08' W	244.7'
CF	S 88°02' W	227.9'
CG	N 68°46' W	190.6'
CH	N 77°08' W	205.8'
CI	S 84°40' W	214.4'
CJ	N 75°16' W	209.4'
CK	N 71°19' W	217.1'
CL	N 02°39' E	147.9'
CM	N 11°23' E	284.1'
CN	N 19°38' E	200.8'
CO	N 01°30' E	195.4'
CP	N 01°32' W	138.7'
CQ	N 15°54' E	117.3'
CR	N 04°15' W	389.9'

**LEGEND**

- FOUND ORIGINAL EVIDENCE, SET A 3" DIAM. U.S.F.S. ALUMINUM CAPPED PIPE, 30" LONG, WITH MAGNET, MARKED PER B-L-M MANUAL, SEE TYPICAL CAP FOR STANDARD MARKINGS
- FOUND A 3" DIAM. ALUMINUM CAPPED PIPE MONUMENT, SEE CORNER NOTES
- FOUND A U.S.G.S. BRASS TABLET CONTROL STATION
- ▲ FOUND A 3" DIAM. ALUMINUM TABLET MONUMENT GPS CONTROL STATION
- ⊙ SET A 3" DIAM. U.S.F.S. ALUMINUM CAPPED PIPE, 30" LONG, WITH MAGNET, MARKED PER B-L-M MANUAL, SEE TYPICAL CAP FOR STANDARD MARKINGS
- [ ] RECORD BEARING AND/OR DISTANCE, G-L-O, 1898
- (ECW) = NATIONAL FOREST SYSTEM LANDS DESIGNATED AS EAGLE CAP WILDERNESS AREA ARE POSTED TO STANDARD
- NFSL NATIONAL FOREST SYSTEM LANDS

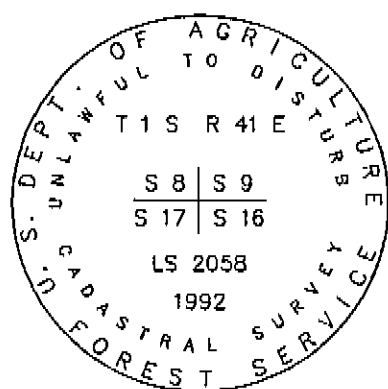
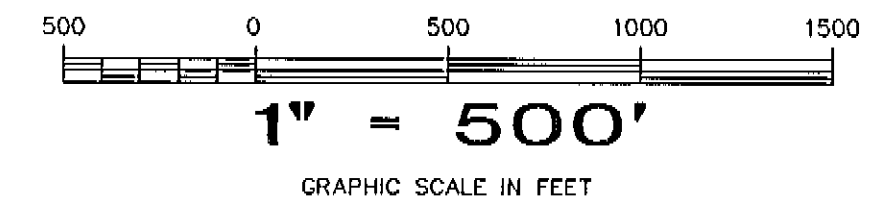

REGISTERED  
PROFESSIONAL  
LAND SURVEYOR  
*Ronald E. Stoll*  
OREGON  
JULY 15, 1983  
RONALD E. STOLL  
2058

RONALD E. STOLL, LS 2058

JOB NO. 1227

CONTRACT NO. 53-04M3-1-0163

SHEET 4 OF 7

TYPICAL FOREST SERVICE CAP  
MARKED PER B-L-M MANUAL

MATCH LINE

SHEET 4  
SHEET 3

A PORTION OF  
**T 1 S R 41 E W.M.**  
UNION COUNTY, OREGON

---

**RECORD OF SURVEY**

---

RES LAND SURVEYS, INC. 8335 N. PLACITA DADIVOSO  
TUCSON, ARIZONA 85704

# SKIDDER/EAGLE CAP WILDERNESS SURVEY

## WALLOWA-WHITMAN NATIONAL FOREST

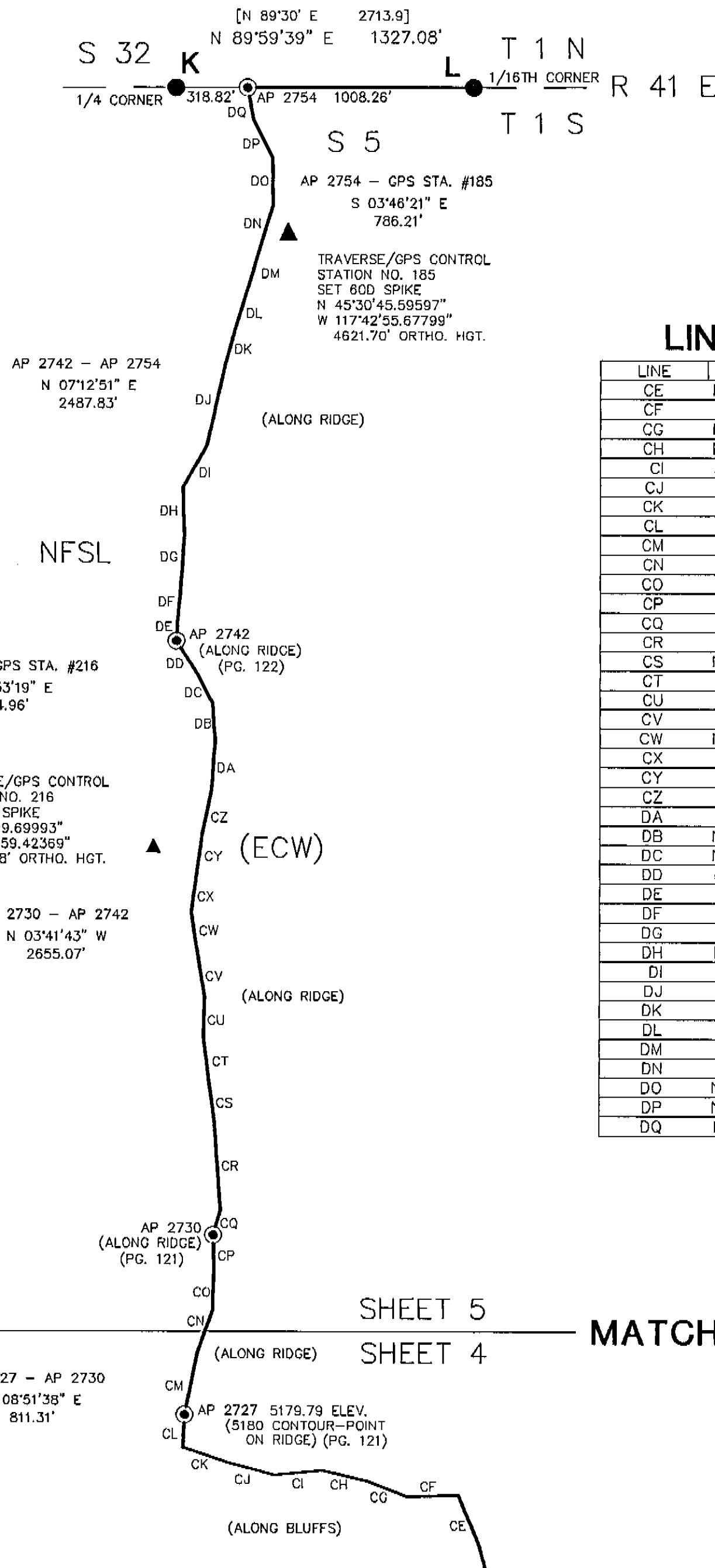

### LINE TABLE

LINE	DIRECTION	DISTANCE
CE	N 23°08' W	244.7'
CF	S 88°02' W	227.9'
CG	N 68°46' W	190.6'
CH	N 77°08' W	205.8'
CI	S 84°40' W	214.4'
CJ	N 75°16' W	209.4'
CK	N 71°19' W	217.1'
CL	N 02°39' E	147.9'
CM	N 11°23' E	284.1'
CN	N 19°38' E	200.8'
CO	N 01°30' E	195.4'
CP	N 01°32' W	138.7'
CQ	N 15°54' E	117.3'
CR	N 04°15' W	389.9'
CS	N 07°42' W	185.1'
CT	N 07°14' W	197.2'
CU	N 01°20' E	183.0'
CV	N 09°18' W	207.5'
CW	N 08°56' W	170.7'
CX	N 07°40' E	178.2'
CY	N 07°49' E	178.9'
CZ	N 12°00' E	193.3'
DA	N 04°06' E	222.9'
DB	N 04°08' W	168.4'
DC	N 27°37' W	149.3'
DD	N 31°58' W	173.4'
DE	N 03°02' E	84.7'
DF	N 05°04' E	192.8'
DG	N 03°56' E	191.5'
DH	N 01°43' W	219.2'
DI	N 29°44' E	215.6'
DJ	N 12°43' E	375.4'
DK	N 15°27' E	173.5'
DL	N 17°24' E	188.7'
DM	N 16°09' E	180.9'
DN	N 17°16' E	193.3'
DO	N 00°55' W	207.7'
DP	N 26°27' W	189.9'
DQ	N 10°53' W	147.2'

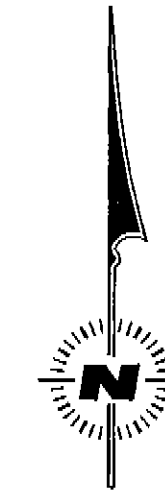

### LEGEND

- FOUND ORIGINAL EVIDENCE, SET A 3" DIAM. U.S.F.S. ALUMINUM CAPPED PIPE, 30" LONG, WITH MAGNET, MARKED PER B-L-M MANUAL, SEE TYPICAL CAP FOR STANDARD MARKINGS
- FOUND A 3" DIAM. ALUMINUM CAPPED PIPE MONUMENT, SEE CORNER NOTES
- FOUND A U.S.G.S. BRASS TABLET CONTROL STATION
- ▲ FOUND A 3" DIAM. ALUMINUM TABLET MONUMENT GPS CONTROL STATION
- ⊙ SET A 3" DIAM. U.S.F.S. ALUMINUM CAPPED PIPE, 30" LONG, WITH MAGNET, MARKED PER B-L-M MANUAL, SEE TYPICAL CAP FOR STANDARD MARKINGS
- [ ] RECORD BEARING AND/OR DISTANCE, G-L-O, 1898
- (ECW) = NATIONAL FOREST SYSTEM LANDS DESIGNATED AS EAGLE CAP WILDERNESS AREA ARE POSTED TO STANDARD
- NFSL NATIONAL FOREST SYSTEM LANDS

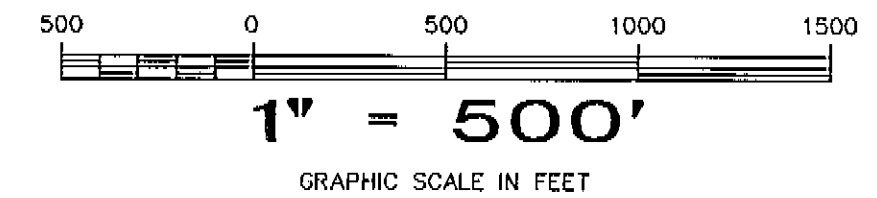

REGISTERED  
PROFESSIONAL  
LAND SURVEYOR

*Ronald E. Stoll 10/98*

OREGON  
JULY 16, 1983  
RONALD E. STOLL  
2058

RONALD E. STOLL, LS 2058

JOB NO. 1227

CONTRACT NO. 53-04M3-1-0163

SHEET 5 OF 7

SHEET 5

SHEET 4

MATCH LINE

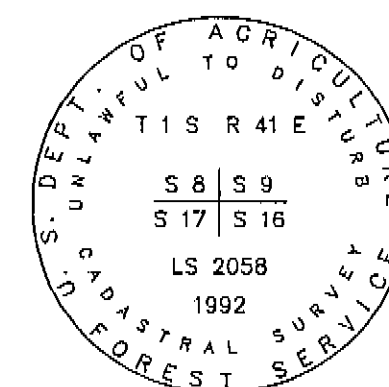

TYPICAL FOREST SERVICE CAP  
MARKED PER B-L-M MANUAL

A PORTION OF

T 1 S R 41 E W.M.

UNION COUNTY, OREGON

RECORD OF SURVEY

RES LAND SURVEYS, INC.

8335 N. PLACITA DADIVOSO  
TUCSON, ARIZONA 85704

# SKIDDER/EAGLE CAP WILDERNESS SURVEY WALLOWA-WHITMAN NATIONAL FOREST

F: 1/4 CORNER TO SECTIONS 29 & 30

NO EVIDENCE OF THE ORIGINAL MONUMENT FOUND, POSITION OF CORNER REESTABLISHED FROM A FOUND ORIGINAL BEARING TREE, SET MONUMENT 20" IN GROUND WITH MOUND OF STONE TO CAP, CAP MARKED:

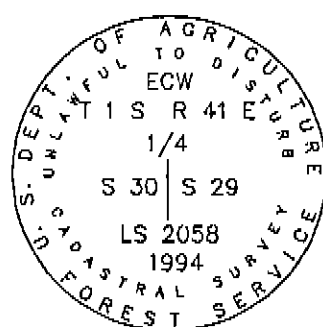

FROM WHICH: G-L-O ACCESSORIES

A FIR, 17" [8"] IN DIAM. BEARS S 41°01' W, [S37° W], 9.76' [9.2'], WITH CLOSED BLAZE

FROM WHICH: LS 2058 ACCESSORIES

A FIR, 25" IN DIAM. BEARS S 88°10' W, 19.90', SCRIBED 1/4X BT  
A FIR, 11" IN DIAM. BEARS N 11°11' W, 43.62', SCRIBED 1/4S30 BT  
A FIR, 7" IN DIAM. BEARS N 87°25' E, 45.82', SCRIBED 1/4S29 BT

AP 2602

SET MONUMENT ON SECTION LINE 10" IN GROUND WITH MOUND OF STONE TO CAP, CAP MARKED:

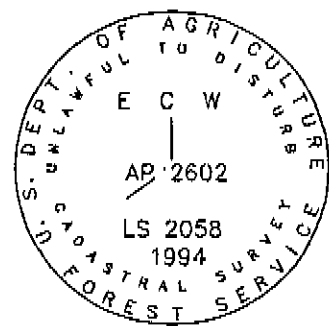

FROM WHICH: LS 2058 ACCESSORIES

A FIR, 15" IN DIAM. BEARS S 38°02' W, 32.15', SCRIBED ECWAP2602 BT  
A FIR, 10" IN DIAM. BEARS S 20°26' E, 28.86', SCRIBED ECWAP2602 BT

AP 2603

SET MONUMENT ON SECTION LINE 10" IN GROUND WITH MOUND OF STONE TO CAP, CAP MARKED:

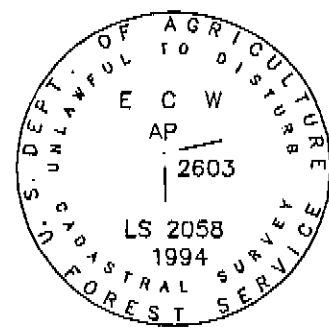

FROM WHICH: LS 2058 ACCESSORIES

A FIR, 8" IN DIAM. BEARS N 83°10' E, 8.74', SCRIBED ECWAP2603 BT  
A FIR, 9" IN DIAM. BEARS S 31°50' E, 19.05', SCRIBED ECWAP2603 BT

G: LINE TREE TO SECTIONS 29 & 30

FOUND A 28" [30"] FIR SNAG WITH 2 NOTCHES VISIBLE ON NORTH & SOUTH SIDES OF TREE

FROM WHICH: LS 2058 ACCESSORIES

SET A 1 1/2" ALUMINUM CAP ON A 1/2" DIAM. REBAR, BEARS N 37°24' E, 49.63'

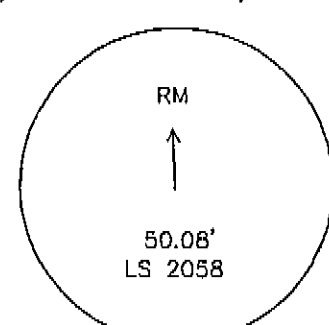

H: CORNER TO SECTIONS 19, 20, 29 & 30

FOUND A 14"x15"x8" [15"x14"x7"] MARKED STONE, SET A MONUMENT 30" IN THE GROUND WITH MOUND OF STONE TO CAP, CAP MARKED:

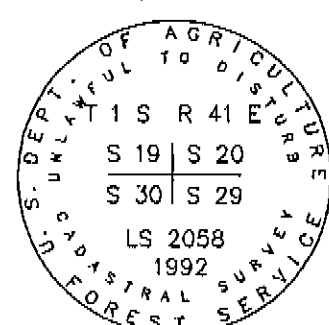

FROM WHICH: G-L-O ACCESSORIES

A FIR, 38" [24"] IN DIAM. BEARS N 11°24' E, [N14° E], 59.82' [60.7'], CLOSED BLAZE

A PINE, 10" [6"] IN DIAM. BEARS N 06°55' W, [N05° W], 39.15' [38.9'], PARTIAL OPEN BLAZE

A FIR, 28" [14"] IN DIAM. BEARS S 51°27' W, [S52° W], 7.34' [7.3'], CLOSED BLAZE

A FIR, 27" [24"] IN DIAM. BEARS S 52°12' E, [S52° E], 14.67' [14.5'], CLOSED BLAZE

AP 2609

SET MONUMENT 26" IN GROUND WITH MOUND OF STONE TO CAP, CAP MARKED:

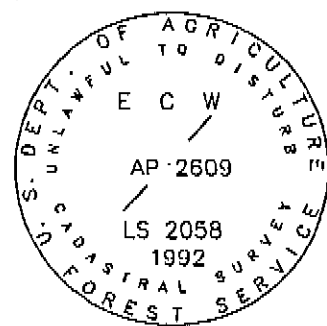

FROM WHICH: LS 2058 ACCESSORIES

A PINE, 17" IN DIAM. BEARS S 10°29' W, 46.04', SCRIBED ECWAP2609 BT  
A FIR, 20" IN DIAM. BEARS N 54°29' W, 32.68', SCRIBED ECWAP2609 BT

AP 2631

SET MONUMENT 26" IN GROUND WITH MOUND OF STONE TO CAP, CAP MARKED:

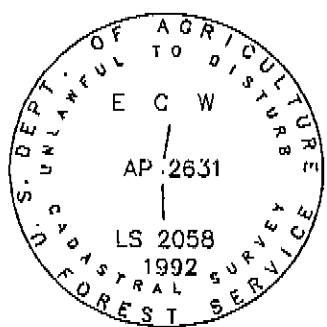

FROM WHICH: LS 2058 ACCESSORIES

SET A COTTON PICKER SPINDLE IN THE SE FACE OF A CLIFF FACE, 2' ABOVE THE GROUND, BEARS S 22° 44' W, 17.19'  
SET A COTTON PICKER SPINDLE ON THE SE TOP OF A 8'x10' LEDGE ROCK, BEARS S 14° 13' E, 43.01'

AP 2646

SET MONUMENT 25" IN GROUND WITH MOUND OF STONE TO CAP, CAP MARKED:

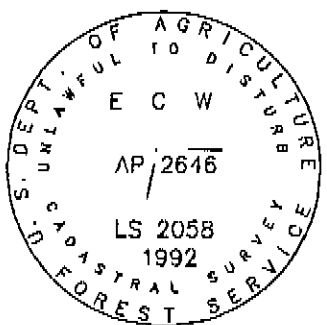

FROM WHICH: LS 2058 ACCESSORIES

A FIR, 6" IN DIAM. BEARS N 17°49' W, 4.37', SCRIBED ECWAP2646 BT  
A FIR, 7" IN DIAM. BEARS S 84°19' W, 23.69', SCRIBED ECWAP2646 BT

AP 2647

SET MONUMENT 25" IN GROUND WITH MOUND OF STONE TO CAP, CAP MARKED:

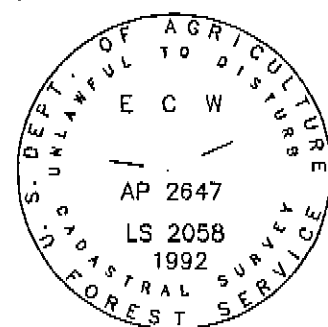

FROM WHICH: LS 2058 ACCESSORIES

A PINE, 13" IN DIAM. BEARS N 70°55' W, 31.58', SCRIBED ECWAP2647 BT  
A LARCH, 12" IN DIAM. BEARS S 38°29' E, 33.02', SCRIBED ECWAP2647 BT

I: 1/4 CORNER TO SECTIONS 17 & 20

FOUND A 3" DIAM. ALUMINUM CAPPED PIPE IN SMALL MOUND OF STONE, CAP MARKED:

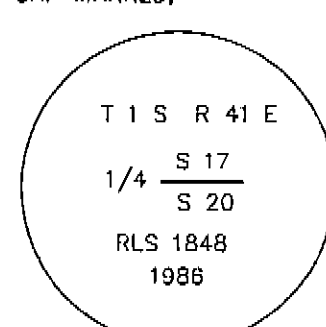

REFERENCE LAND CORNER RECORD 275-86-R

FROM WHICH: G-L-O ACCESSORIES:

A FIR (DEAD), 12" [8"] IN DIAM. BEARS S 54° W, [S 50° W], 14.8' [14.5'], PARTIALLY HEALED BLAZE

A STUMP, 48" [30"] IN DIAM. BEARS N 72°40' E, [N 75° E], 16.7' [17.8'], BADLY DECAYED

FROM WHICH: RLS 1848 ACCESSORIES:

A FIR, 10" (8") IN DIAM. BEARS S 56°20' E, (S 56° E), 8.7' (8.8'), CLOSED BLAZE

A FIR, 9" (8") IN DIAM. BEARS N 31°40' E, (N 31° E), 15.3' (15.5'), CLOSED BLAZE

FROM WHICH: LS 2058 ACCESSORIES

A FIR, 7" IN DIAM. BEARS S 39° W, 28.3', SCRIBED 1/4S20 BT

A FIR, 8" IN DIAM. BEARS N 75° W, 15.5', SCRIBED 1/4S17 BT

AP 2665

SET MONUMENT 28" IN GROUND WITH MOUND OF STONE TO CAP, CAP MARKED:

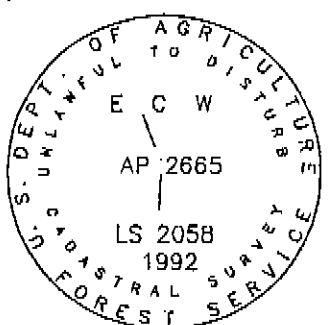

FROM WHICH: LS 2058 ACCESSORIES

A FIR, 7" IN DIAM. BEARS N 15°20' W, 5.40', SCRIBED ECWAP2665 BT

A FIR, 12" IN DIAM. BEARS S 81°26' W, 18.82', SCRIBED ECWAP2665 BT

AP 2671

SET MONUMENT 25" IN GROUND WITH MOUND OF STONE TO CAP, CAP MARKED:

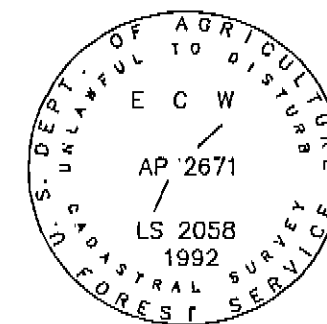

FROM WHICH: LS 2058 ACCESSORIES

A PINE, 20" IN DIAM. BEARS S 79°51' W, 39.76', SCRIBED ECWAP2671 BT

A FIR, 17" IN DIAM. BEARS N 43°30' W, 56.10', SCRIBED ECWAP2671 BT

AP 2678

SET MONUMENT 28" IN GROUND WITH MOUND OF STONE TO CAP, CAP MARKED:

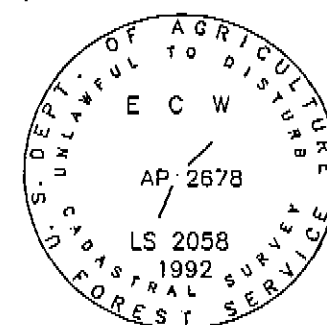

FROM WHICH: LS 2058 ACCESSORIES

SET A 3/4" DIAM. DRILL HOLE 6" ABOVE THE GROUND IN A 30"x30" BOULDER, BEARS S 33° 18' W, 22.92'

SET A 3/4" DIAM. DRILL HOLE 25" ABOVE THE GROUND IN A 54"x54" BOULDER, BEARS N 71° 44' W, 38.98'

AP 2698

SET MONUMENT 28" IN GROUND WITH MOUND OF STONE TO CAP, CAP MARKED:

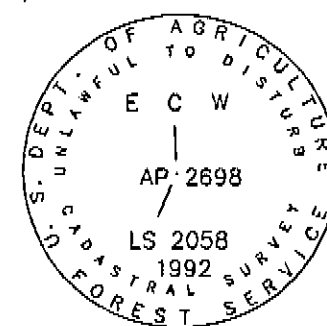

FROM WHICH: LS 2058 ACCESSORIES

SET A 3/4" DIAM. DRILL HOLE 33" ABOVE THE GROUND IN THE A SW FACE OF A ROCK CLIFF, BEARS N 65° 42' W, 19.66'

SET A 3/4" DIAM. DRILL HOLE 16" ABOVE THE GROUND IN THE SW FACE OF A ROCK CLIFF, BEARS N 11° 29' E, 35.85'

### LEGEND

- [ ] RECORD BEARING AND/OR DISTANCE, G-L-O, 1898
- ( ) RECORD BEARING AND/OR DISTANCE, LS 1848, 1986
- MONUMENT A U.S.F.S. 3" DIAM. ALUMINUM CAPPED PIPE, 30" LONG

REGISTERED PROFESSIONAL LAND SURVEYOR

*Ronald E. Stoll 10/98*  
OREGON  
JULY 15, 1983  
RONALD E. STOLL  
2058

RONALD E. STOLL, LS 2058

JOB NO. 1227  
CONTRACT NO. 53-04M3-1-0163  
SHEET 6 OF 7

A PORTION OF

# T 1 S R 41 E W.M.

UNION COUNTY, OREGON

---

## RECORD OF SURVEY

---

RES LAND SURVEYS, INC. 8335 N. PLACITA DADIVOSO  
TUCSON, ARIZONA 85704

# SKIDDER/EAGLE CAP WILDERNESS SURVEY WALLOWA-WHITMAN NATIONAL FOREST

J: CORNER TO SECTIONS 8, 9, 16 & 17

NO EVIDENCE OF THE ORIGINAL MONUMENT FOUND, POSITION OF CORNER REESTABLISHED FROM A FOUND ORIGINAL BEARING TREES, SET MONUMENT 29" IN GROUND WITH MOUND OF STONE TO CAP, CAP MARKED:

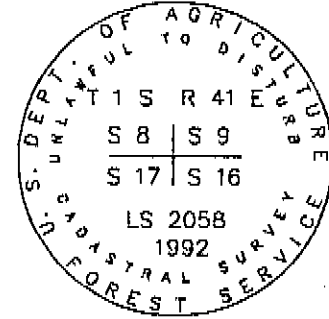

FROM WHICH: G-L-O ACCESSORIES  
A FIR, 24"[17"] IN DIAM. BEARS N 87°00' E, [N 87° E], 171.14' [190.1'], WITH CLOSED BLAZE  
A FIR, 36"[24"] IN DIAM. BEARS S 83°00' E, [S 83° E], 180.83' [205.3'], WITH CLOSED BLAZE

FROM WHICH: LS 2058 ACCESSORIES  
SET A COTTON PICKER SPINDLE IN THE FACE OF A ROCK CLIFF, 5' ABOVE THE GROUND, BEARS N 28° 24' W, 24.07'  
SET A 3/4" DIAM. DRILL HOLE 41" ABOVE THE GROUND IN THE FACE OF A ROCK CLIFF, BEARS S 28° 47' W, 23.11'

AP 2699

SET A 6' STEEL T POST IN ROCK SLIDE AREA FOR CORNER POSITION

AP 2713

SET MONUMENT 28" IN GROUND WITH MOUND OF STONE TO CAP, CAP MARKED:

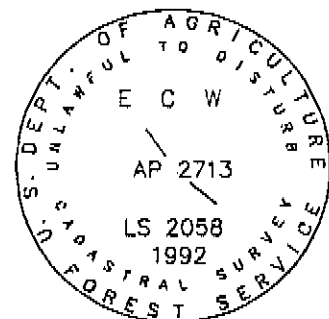

FROM WHICH: LS 2058 ACCESSORIES  
A FIR, 6" IN DIAM. BEARS N 43°10' E, 2.70', SCRIBED ECWAP2713 BT  
A FIR, 6" IN DIAM. BEARS N 27°48' E, 6.45', SCRIBED ECWAP2713 BT

AP 2716

SET MONUMENT 26" IN GROUND WITH MOUND OF STONE TO CAP, CAP MARKED:

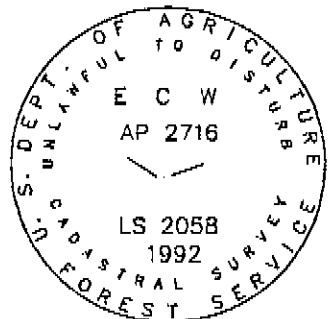

FROM WHICH: LS 2058 ACCESSORIES  
A FIR, 10" IN DIAM. BEARS S 9°17' W, 4.16', SCRIBED ECWAP2716 BT  
A FIR, 17" IN DIAM. BEARS N 64°30' W, 23.67', SCRIBED ECWAP2716 BT

AP 2727

SET MONUMENT 30" IN GROUND WITH MOUND OF STONE TO CAP, CAP MARKED:

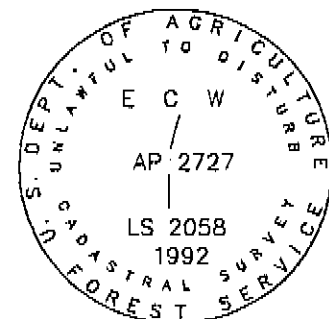

FROM WHICH: LS 2058 ACCESSORIES  
A FIR, 8" IN DIAM. BEARS N 75°26' W, 23.49', SCRIBED ECWAP2727 BT  
A PINE, 9" IN DIAM. BEARS N 15°24' W, 13.32', SCRIBED ECWAP2727 BT

AP 2730

SET MONUMENT 21" IN GROUND WITH MOUND OF STONE TO CAP, CAP MARKED:

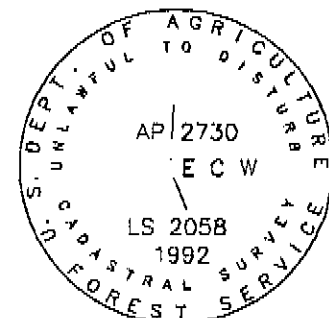

FROM WHICH: LS 2058 ACCESSORIES  
A FIR, 11" IN DIAM. BEARS S 28°21' E, 15.77', SCRIBED ECWAP2730 BT  
A FIR, 13" IN DIAM. BEARS N 69°54' E, 18.23', SCRIBED ECWAP2730 BT

AP 2742

SET MONUMENT 21" IN GROUND WITH MOUND OF STONE TO CAP, CAP MARKED:

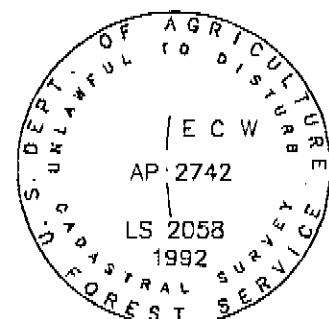

FROM WHICH: LS 2058 ACCESSORIES  
A FIR, 10" IN DIAM. BEARS S 79°41' W, 7.18', SCRIBED ECWAP2742 BT  
A FIR, 18" IN DIAM. BEARS S 14°56' W, 24.27', SCRIBED ECWAP2742 BT

AP 2754

SET MONUMENT 30" IN GROUND WITH MOUND OF STONE TO CAP, CAP MARKED:

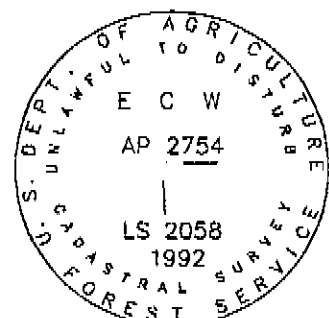

FROM WHICH: LS 2058 ACCESSORIES  
A FIR, 10" IN DIAM. BEARS S 06°28' W, 35.70', SCRIBED ECWAP2754 BT  
A FIR, 9" IN DIAM. BEARS N 69°59' E, 26.08', SCRIBED ECWAP2754 BT

K: 1/4 CORNER TO SECTION 32

FOUND A 3" DIAM. ALUMINUM CAPPED PIPE IN SMALL MOUND OF STONE, CAP MARKED:

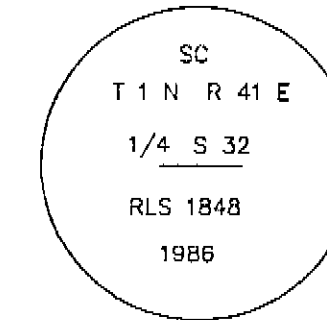

REFERENCE LAND CORNER RECORD 58-88-R

FROM WHICH: RLS 1848 ACCESSORIES

A FIR, 4"(4") IN DIAM. BEARS N 82°06' E(N 82°45' E), 19.06'(19.1'), SCRIBED 1/4S32SC BT  
A FIR, 7"(9") IN DIAM. BEARS N 30°29' E(N 34°15' E), 15.96'(16.1'), PARTIAL VISIBLE SCRIBING

L: E 1/16 CORNER TO SECTION 32

FOUND A 3" DIAM. ALUMINUM CAPPED PIPE IN SMALL MOUND OF STONE, CAP MARKED:

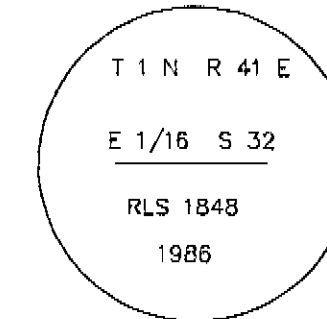

REFERENCE LAND CORNER RECORD 59-88-R

FROM WHICH: RLS 1848 ACCESSORIES

A PINE, 12"(12") IN DIAM. BEARS N 32°27' E(N 34°45' E), 65.22'(65.3'), SCRIBED 1/16S32 BT  
A FIR, 12"(11.5") IN DIAM. BEARS N 52°58' W(N 52°15' W), 28.72'(28.9"), SCRIBED E1/16S32 BT

### LEGEND

[ ] RECORD BEARING AND/OR DISTANCE, G-L-O, 1898

( ) RECORD BEARING AND/OR DISTANCE, LS 1848, 1986

MONUMENT A U.S.F.S. 3" DIAM. ALUMINUM CAPPED PIPE, 30" LONG

REGISTERED PROFESSIONAL LAND SURVEYOR

*Ronald E. Stoll 10/98*  
OREGON JULY 15, 1983 RONALD E. STOLL 2058

RONALD E. STOLL, LS 2058

JOB NO. 1227  
CONTRACT NO. 53-04M3-1-0163  
SHEET 7 OF 7

A PORTION OF

# T 1 S R 41 E W.M.

UNION COUNTY, OREGON

---

## RECORD OF SURVEY

---

RES LAND SURVEYS, INC. 8335 N. PLACITA DADIVOSO  
TUCSON, ARIZONA 85704