

PLANS-Recreation  
Blue Springs Summer Home Area  
La Grande District  
Wallowa-Whitman National Forest  
Region 6

SURVEY NOTES  
FOR  
ESTABLISHMENT OF LOTS

By  
R. Williams and E. O'Keeffe  
September 14 and 15, 1954

DATE RECEIVED	1/6/94
DATE	1/13/94
BY	Gregory T. Blanton Natchez
FILE NO.	1/20 Draw

RP No. 1 is a blazed 14-inch lodgepole pine in the Blue Spring Road Y, and is 43.56 ch. W. and 13.57 ch. N. of Sec. Cor. between S. 20, 21, 28, and 29, T. 5 S., R. 35 E., W.M.

RP No. 2 is a lodgepole pine on W. side of Garrity's gate, and bears S. 44° 30' W. and 3.18 chs. from RP No. 1.

From RP No. 2, N. 56° W., 42 lks. to N. E. corner of Lot No. 1.

From N. E. corner of Lot No. 1, N. 80° W., 2 chs. to N. W. corner of Lot No. 1.

From N. E. corner of Lot No. 1, S. 9° E., 2 chs. to S. E. corner of Lot No. 1.

From S. E. corner of Lot No. 1, N. 80° 30' W., 2 chs. to S. W. corner of Lot No. 1.

From S. E. corner of Lot No. 1, S. 6° E., 2 chs. to S. E. corner of Lot No. 2.

From S. E. corner of Lot No. 2, N. 82° 30' W., 2 chs. to S. W. corner of Lot No. 2.

From S. E. corner of Lot No. 2, S. 16° W., 2 chs. to S. E. corner of Lot No. 3.

From S. E. corner of Lots No. 3, N. 63° W., 2 chs. to S. W. corner of Lot No. 3.

From S. E. corner of Lot No. 3, S. 34° W., 1.4 chs. across vacant areas to S. E. corner of Lot No. 4.

From S. E. corner of Lot No. 4, S. 71° W., 2 chs. to S. W. corner of Lot No. 4.

From S. W. corner of Lot No. 4, N. 6° 30' W., 2 chs. to N. W. corner of Lot No. 4.

From N. E. corner of Lot No. 1, S. 34° E., 1.25 chs. to S. W. corner of Lot No. 5.

From S. W. corner of Lot No. 5, S. 79° E., 2 chs. to S. E. corner of Lot No. 5.

From S. W. corner of Lot No. 5, N. 54° 30' E., to N. corner of Lot No. 5.

Narrative File Draw  
1/20

From S. W. corner of Lot No. 5, S.  $4^{\circ}$  W., 1.5 chs. to S. W. corner of Lot No. 6.

From S. W. corner of Lot No. 6, S.  $79^{\circ}$  E., 2 chs. to S. E. corner of Lot No. 6.

From S. W. corner of Lot No. 6, S.  $4^{\circ}$  W., 1.5 chs. to S. W. corner of Lot No. 7.

From S. W. corner of Lot No. 7, S.  $79^{\circ}$  E., 2 chs. to S. E. corner of Lot No. 7.

---

From S. E. corner of Lot No. 5, S.  $81^{\circ}$  E., 0.75 chs. across proposed roadway to N. W. corner of Lot No. 8.

From N. W. corner of Lot No. 8, S.  $76^{\circ}$  E., 2 chs. to N. E. corner of Lot No. 8.

From N. W. corner of Lot No. 8, S.  $13^{\circ}$  W., 1.5 chs. to S. W. corner of Lot No. 8.

From S. W. corner of Lot No. 8, S.  $76^{\circ}$  E., 2 chs. to N. E. corner of Lot No. 9.

From S. W. corner of Lot No. 8, S.  $3^{\circ}$  W., 1.5 chs. to S. W. corner of Lot No. 9.

From S. W. corner of Lot No. 9, S.  $69^{\circ}$  E., 2 chs. to N. E. corner of Lot No. 10.

From S. W. corner of Lot No. 9, S.  $7^{\circ}$  W., 2 chs. to S. W. corner of Lot No. 10.

From S. W. corner of Lot No. 10, S.  $67^{\circ}$  E., 2 chs. to S. E. corner of Lot No. 10.

---

From N. W. corner of Lot No. 8, N.  $65^{\circ}$  E., 2 chs. across vacant area to N. W. corner of Lot No. 11.

From N. W. corner of Lot No. 11, S.  $6^{\circ} 30'$  E., 2 chs. to S. W. corner of Lot No. 11.

From N. W. corner of Lot No. 11, N.  $68^{\circ} 30'$  E., 2 chs. to N. E. corner of Lot No. 11.

From N. E. corner of Lot No. 11, S.  $22^{\circ}$  E., 2 chs. to S. E. corner of Lot No. 11.

---

From N. W. corner of Lot No. 1, N.  $85^{\circ}$  W., 4.75 chs. across meadow to S. W. corner of Lot No. 12.

From S. W. corner of Lot No. 12, S.  $4^{\circ}$  W., 2 chs. to S. W. corner of Lot No. 13.

From S. W. corner of Lot No. 13, S.  $85^{\circ}$  E., 2 chs. to S. E. corner of Lot No. 13.

From S. W. corner of Lot No. 12, S.  $85^{\circ}$  E., 2 chs. to N. E. corner of Lot No. 13.

From S. W. corner of Lot No. 12, N.  $14^{\circ}$  E., 2 chs. to N. W. corner of Lot No. 12.

From N. W. corner of Lot No. 12, S.  $54^{\circ}$  E., 1.75 chs. to N. E. corner of Lot No. 12.

---

From N. W. corner of Lot No. 12, N.  $67^{\circ}$  W., 0.50 chs. across proposed roadway to N. E. corner of Lot No. 14.

From N. E. corner of Lot No. 14, S.  $15^{\circ}$  W., 2 chs. to S. E. corner of Lot No. 14.

From N. E. corner of Lot No. 14, N.  $65^{\circ}$  W., 2 chs. to N. W. corner of Lot No. 14.

From S. E. corner of Lot No. 14, N.  $70^{\circ}$  W., 2 chs. to S. W. corner of Lot No. 14.

From S. E. corner of Lot No. 14, S.  $6^{\circ} 30'$  W., 2 chs. to S. E. corner of Lot No. 15.

From S. E. corner of Lot No. 15, N.  $71^{\circ}$  W., 2 chs. to S. W. corner of Lot No. 15.

From S. E. corner of Lot No. 15, S.  $7^{\circ}$  W., 2 chs. to S. E. corner of Lot No. 16.

From S. E. corner of Lot No. 16, N.  $71^{\circ}$  W., 2 chs. to S. W. corner of Lot No. 16.

---

From S. E. corner of Lot No. 15, S.  $7^{\circ}$  W., 0.5 chs. to N. W. corner of Lot No. 17.

From N. W. corner of Lot No. 17, S.  $7^{\circ}$  W., 2 chs. to S. W. corner of Lot No. 17.

From N. W. corner of Lot No. 17, S.  $72^{\circ}$  E., 2 chs. to N. E. corner of Lot No. 17.

From N. E. corner of Lot No. 17, S.  $13^{\circ}$  E., 2 chs. to S. E. corner of Lot No. 17.

From S. E. corner of Lot No. 17, S.  $22^{\circ} 30'$  E., 2 chs. to S. E. corner of Lot No. 18.

From S. E. corner of Lot No. 18, Due W., 2 chs. to S. W. corner of Lot No. 18.

From S. E. corner of Lot No. 17, along S. line of No. 17, 2 chs. to N. W. corner of Lot No. 18.

---

From S. W. corner of Lot No. 7, S.  $8^{\circ}$  W., 1.8 chs. to N. E. corner of Lot No. 19.

From N. E. corner of Lot No. 19, S.  $30^{\circ}$  E., 2 chs. to S. E. corner of Lot No. 19.

From N. E. corner of Lot No. 19, S.  $39^{\circ}$  W., 2 chs. to N. W. corner of Lot No. 19.

From N. W. corner of Lot No. 19, S.  $20^{\circ}$  E., 2 chs. to S. W. corner of Lot No. 19.

From N. W. corner of Lot No. 19, S.  $62^{\circ} 30'$  W., 2 chs. to N. W. corner of Lot No. 20.

From N. W. corner of Lot No. 20, S.  $1^{\circ}$  E., 2 chs. to S. W. corner of Lot No. 20.

UNION COUNTY	
SURVEYOR	
Date Received	1/6/94
Date Filed	1/13/94
By	<i>Gregory T. Blakely</i> Narrator
File No.	1/20 File Draw

LEGAL DESCRIPTION OF SPRINGS

Blue Spring	SW $\frac{1}{4}$ , NE $\frac{1}{4}$ , SE $\frac{1}{4}$ , SW $\frac{1}{4}$ , Sec. 20, T. 5 S., R. 35 E., W.M.
Garrity Spring	NW $\frac{1}{4}$ , SE $\frac{1}{4}$ , SW $\frac{1}{4}$ , Sec. 20, T. 5 S., R. 35 E., W.M.
Mud Spring	NW $\frac{1}{4}$ , NW $\frac{1}{4}$ , SE $\frac{1}{4}$ , SW $\frac{1}{4}$ , Sec. 20, T. 5 S., R. 35 E., W.M.

UNION COUNTY SUNNYVALE	
Date Received	<u>1/6/94</u>
Date Filed	<u>1/13/94</u>
By	<u>Mrs. T. Blask</u>
File No.	<u>1/20 Draw</u>

U- RECREATION - LANDS  
BLUE SPR. Summer Home  
FIELD MAP SHEET

T. 55 R. 35E Sec. 20 Subdiv. WALLAWA-WALTMAN N.F.

Mapped by \_\_\_\_\_ Reviewed by \_\_\_\_\_ Scale 10 inches = 1 Mile

AUGUST, 1954

Date Received 1/6/1954  
Date Filed 1/13/54  
By Guy Black  
NATFCH  
File No. 1/20 Drawn

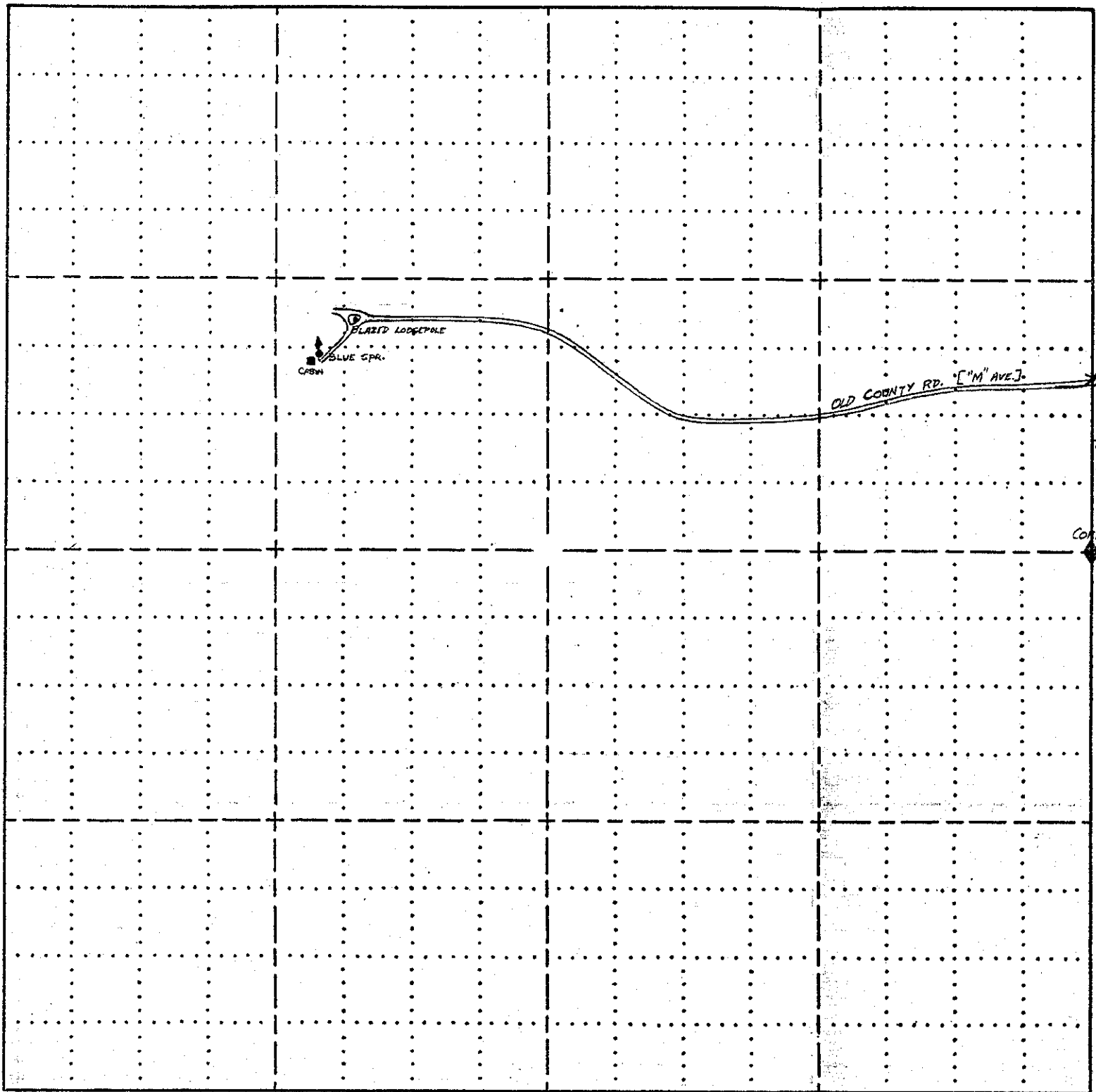

BLAZED 14" LODGEPOLE IS  
43.56 ch W & 13.67 ch N  
OF SEC. COR.

(OAKLAND-5-23-40-5,000)

Narrative File Drawer  
1/20