

Fnd. 5/8" pin by survey 87-73

29 28

Tamarack

S 88° 24' 46" E

Springs

Road

Reference to center of section by James Vaelz on Tamarack Springs Road Plan & Profile (unrecorded)

28 27

Corner reference by brass cap r.p.s

NOTE:
I FIND NO RECORD OF ROAD DEDICATION OR ROAD EASEMENT ACROSS THE NORTH PORTION OF BOTZAU PROPERTY

BASIS OF BEARING

SURVEY NO. 38-77

LEGEND

- △ SET 1 1/2" x 24" PIPE
- SET 5/8" x 30" IRON PIN WITH PLASTIC CAP MARKED B-G-A SURVEY MARKER
- FOUND MONUMENT OF RECORD
- FOUND UNRECORDED MONUMENT
- () RECORD DISTANCE
- EXISTING FENCELINE
- ROADWAY

REFERENCE MATERIAL

- SURVEY NO. 87-73
- SURVEY NO. 38-77
- SURVEY NO. 32-72
- UNRECORDED PLAT OF TAMARACK SPRINGS ROAD

NARRATIVE

THIS SURVEY WAS ORDERED BY BILL LANMAN OF SUN REALTY FOR KEN BOTZAU, THE NEW BUYER FOR SAID PROPERTY. THE OBJECT OF THIS SURVEY WAS TO LOCATE THE TITLE LINES. I SEARCHED FOR THE NORTHWEST CORNER OF SECTION 28, BUT DID NOT FIND IT. I THEREFORE USED THE WORK DONE BY THE COUNTY SURVEYOR AS SHOWN ON AN UNRECORDED MAP OF SURVEY OF "TAMARACK SPRINGS COUNTY ROAD". IT IS MY OPINION THIS WORK IS HARMONIOUS AND THE BEST AVAILABLE EVIDENCE IN THE AREA OF THE LOCATION OF THE PROPERTY LINES. MR. JOE JARVIS POINTED OUT THE LOCATION OF A WITNESS TREE (NOW GONE) WITH REFERENCE TO THE SOUTHWEST CORNER OF SECTION 28. ANDERSON PERRY AND ASSOCIATES ARE TAKING SIGNED STATEMENTS FOR RECORDING AS TO THE TRUE LOCATION OF SAID CORNER. I USED A P.K. NAIL IN THE CENTER OF A RAILROAD TIE SET BY ANDERSON, PERRY AND ASSOCIATES AT THE CORNER. THERE WERE TWO NEW BEARING TREES SET, ONE IN SECTION 33, AND ONE IN SECTION 32, WHICH I PRESUME WILL BE FILED INTO THE RECORD. IT IS IMPOSSIBLE TO SET A BRASS CAP AT THE TRUE CORNER, AS THE POST OCCUPIES THE CORNER. MR. JARVIS HAS A PRIVATE ROAD ALONG THE WEST LINE OF THE BOTZAU PROPERTY THAT ENCRACHES APPROXIMATELY 15-30 FEET. I ADVISED MR. BOTZAU'S REPRESENTATIVE, BILL LANMAN, THAT IT IS POSSIBLE FOR MR. JARVIS TO CLAIM THIS BY ADVERSE POSSESSION.

REGISTERED PROFESSIONAL LAND SURVEYOR

OREGON JULY 13, 1973 GREGORY T. BLACKMAN 991

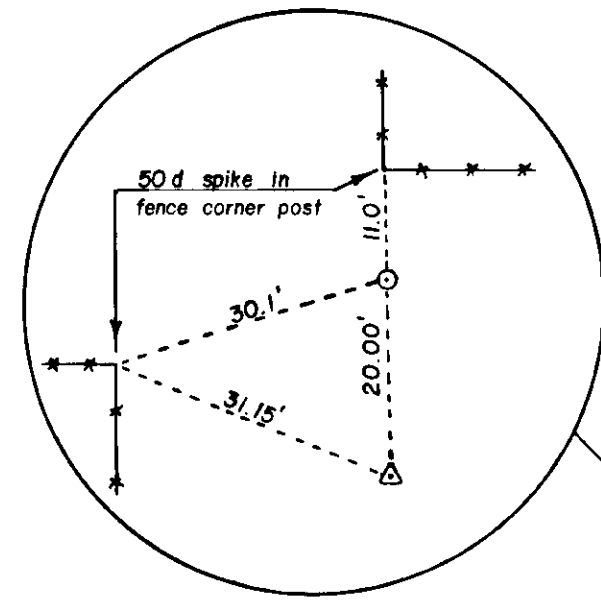

JARVIS PRIVATE ROAD

N 0° 04' 25" W

2663.47

fc. 8.7 ft. west of line

fc. 3.37 west of line

2683.48

private road encroachment

2650.27

N 0° 15' 21" E

2670.27

N 0° 15' 21" E

2686.55

Set 1/4 corner

28 27

N 0° 23' 59" W

2696.77 (2695.95)

29 28

1343.28

N 0° 04' 25" W 20.00

fc. cor. 12 ft. S. @ 30 ft. E.

1343.39

S 88° 57' 31" E

1343.27

ROADWAY

nail in top of fence post by Anderson & Perry Two new bearing trees.

BAGETT, GRIFFITH & ASSOCIATES

La Grande, Oregon

Map of Survey

THE EAST 1/2 OF THE SW 1/4 OF SECTION 28, T 1 N, R 38 E, W.M. EXCEPT THE SOUTH 20' USED FOR ROAD PURPOSES UNION COUNTY, OREGON

SURVEYED FOR	KEN BOTZAU	
SURVEYED BY	GTB	6/80
Scale: 1" = 200'	Drawn by: GTB	6/80

39-80