

MAP OF FIELD SURVEY  
 LOCATED IN BLOCK 44 OF HINDMAN'S ADDITION TO  
 CITY OF ELGIN UNION COUNTY, OREGON  
 DATE: AUGUST 1977 SCALE: 1" = 60'  
 BEARINGS: TRUE, FROM  $\zeta$  OF BALTIMORE ST.

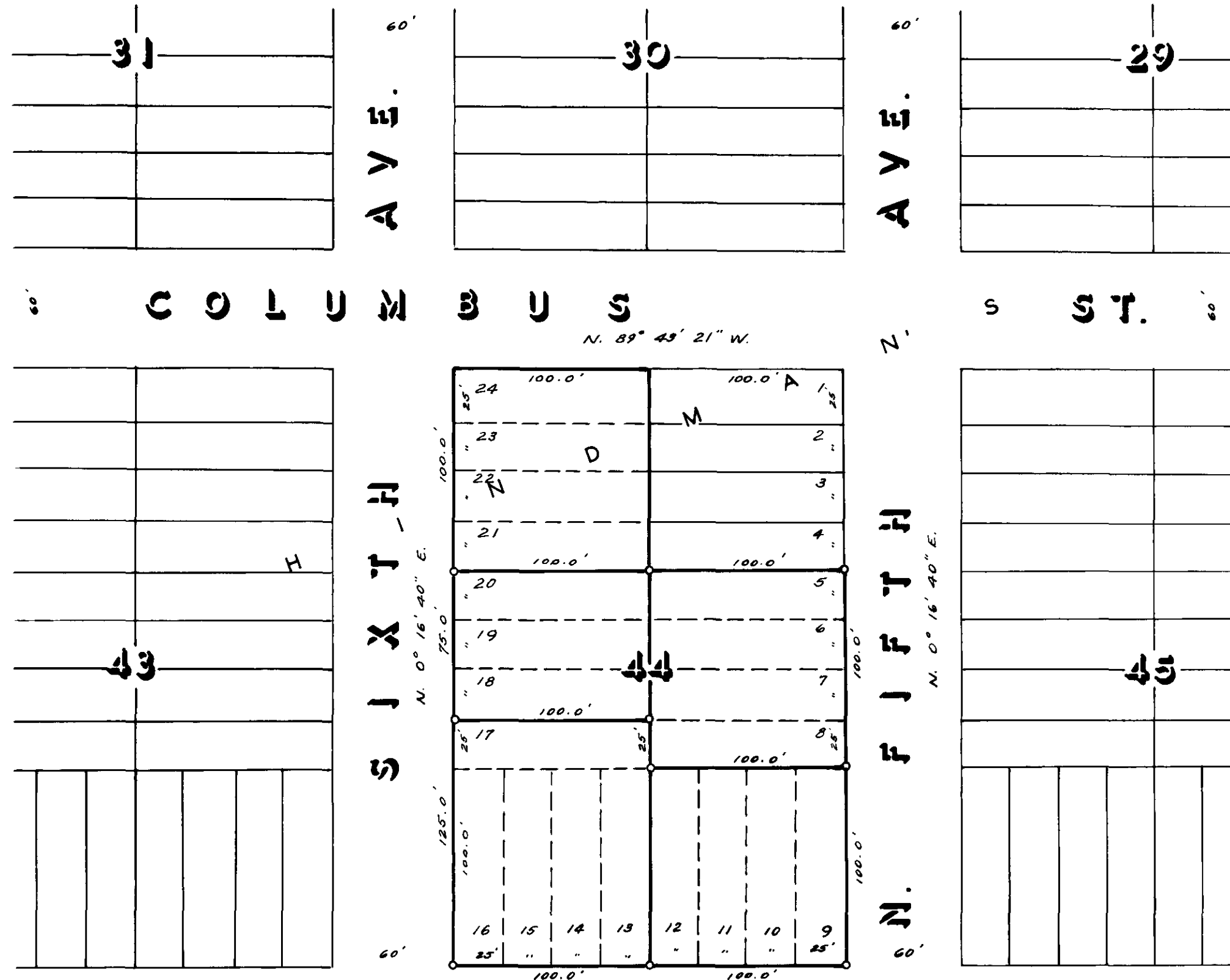

REGISTERED  
**OREGON**  
 LAND SURVEYOR  
*Ronald J. Brazeau*  
 MAY 4, 1956  
 RONALD J. BRAZEAU  
 374

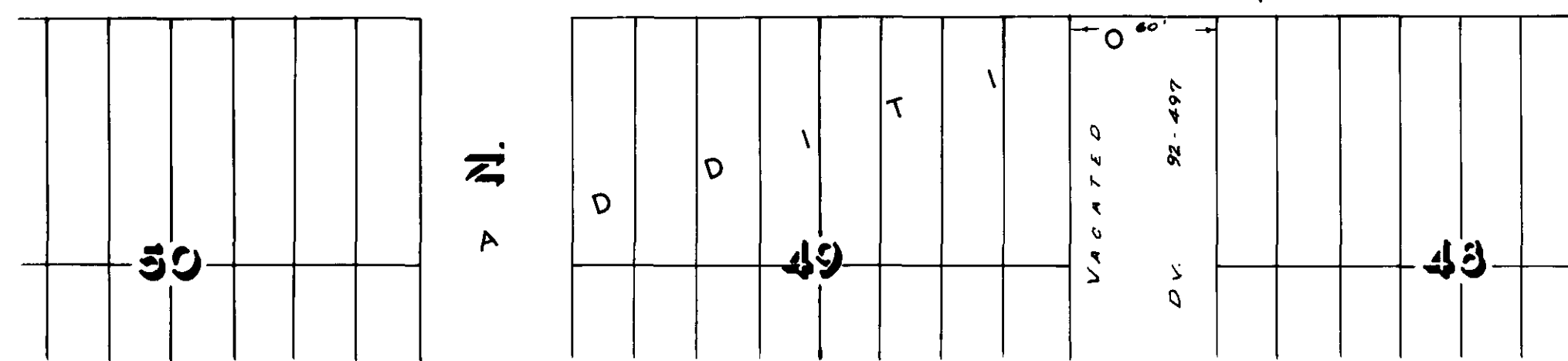
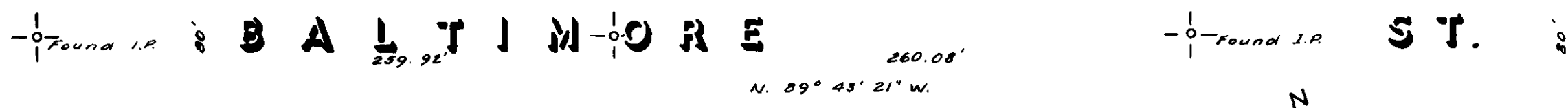

76.77