

Found 1" iron pin and Northeast Bearing Tree

8 9
17 16

(North)
N 1° 16' 46" W
5344.09
(80 Ch.)

Found 6" Fir blazed four sides, with blaze lines running North, South & East

17 16
20 21

(S 89° 30' E) (39.9 Ch.)
N 89° 43' 06" E 2603.03

Found 4" Fir blazed 4 sides with old fence lines running North - South and East. Blaze lines running East - South. Ring count on fence trees indicate the fence is approximately 50 years old. No evidence of bearing trees found.

Survey No. 38-76

(S 89° 30' E) (N 88° 53' 57" E) (39.9 Ch.)
N 88° 53' 57" E 2620.93

Found a bridge spike and Southeast Bearing tree at record Bearing and Distance

16 15
21 22

LEGEND

- Found Monument of Record
- Set 5/8" x 30" iron pin with plastic cap marked "BGA Survey Marker"
- X Found evidence as shown
- () Record Bearing and Distance
- Existing fence line

BASIS OF BEARING
SOLAR OBSERVATIONS
ON THE EAST 1/4 CORNER
OF SECTION 21

REFERENCE MATERIAL

- Survey No. 38-76
- Survey No. 45-76
- Survey in old survey book at County Surveyor's office on page 350 by Arthur Curtis dated Dec. 1902
- GLO Survey Notes:
Book 69 by David P. Thompson dated 1863
- Book 290 by Frank W. Campbell dated 1883

SURVEYOR'S CERTIFICATE

I, Duane I. Griffith, do hereby certify that I made the survey hereon shown. I set the pins as shown on what I feel is the best available evidence of the position of this Section. Due to a severe lack of original corners, especially to the South and East, I do not feel that a proportion would be in the best interest of the properties in this Section. Although I have found no direct connection to Arthur Curtis' survey of 1902, I feel the fences and blaze lines are, at least in part, based on his survey.

Duane I. Griffith
OPLS 644

Found North-South blaze line only

(80 Ch.)
5339.76

(North)
N 0° 28' 20" W

S 89° 14' 40" W
2622.88

5329.82

N 0° 54' 04" W

5203.93

Found East-West blaze line approximately 20 years old, on line.

(North)
N 0° 02' 37" W 2664.33
(40 Ch.)

Found BT stumps. Blazes evident. Set PK nails in top center of stumps as follows:
A 22" pine stump bears S 25° W, 35.98 ft.
A 20" pine stump bears S 18° E, 4.4.94 ft.

Survey No. 45-76

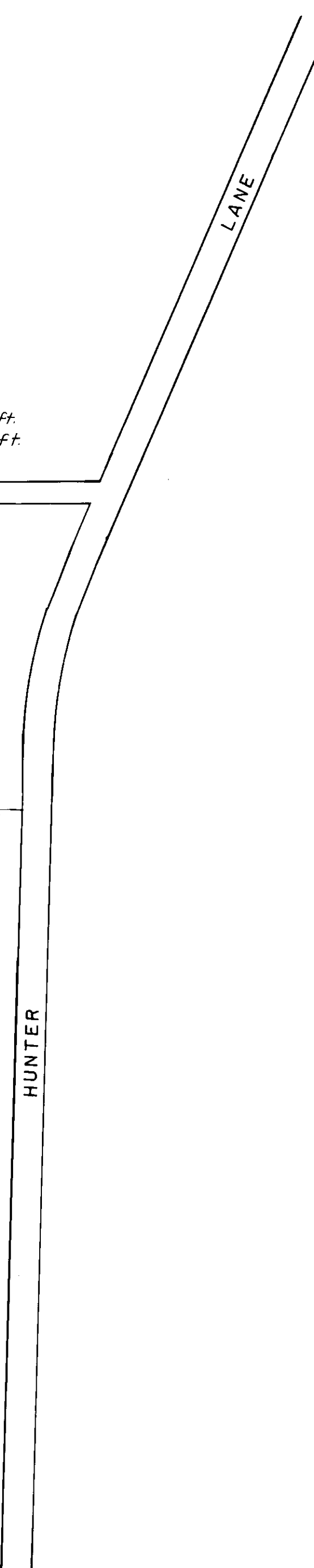

1/4 Corner searched for Not found

(80.70 Ch.)
5335.32
S 89° 08' 36" E
(S 89° 43' W)

N 89° 29' 48" E 2642.92
(40 Ch.)

Found mound of stone at fence corner. Fence running East & South with K-tag dated 1950.

N 88° 35' 38" E
(S 89° 30' W)

2539.57
(40 Ch.)

Found wooden stake pointed out as the Section Corner by Mr. Dobbin. Set spike & put PK nails in an 8" Fir 1.35 ft. and a 7" Fir 1.53 ft.



BAGETT, GRIFFITH & ASSOCIATES La Grande, Oregon		
Map of Survey		
Parcel in the NE 1/4, of the SE 1/4		
Section 21, T1S, R38E, W.M.		
UNION COUNTY, OREGON		
SURVEYED FOR	ELTON CLEMENS	
SURVEYED BY	D.I.G. & D.A.D.	Dec. 1976
Scale: 1" = 300'	Drawn by: tdg	Dec. 1976