

Lee Ellen Coe  
 265 - 14 th. street  
 Elgin, Oregon

July 8, 1972  
 scale 1" = 100'

set 5/8" x 30" steel rod.  
 ( ) data of record.

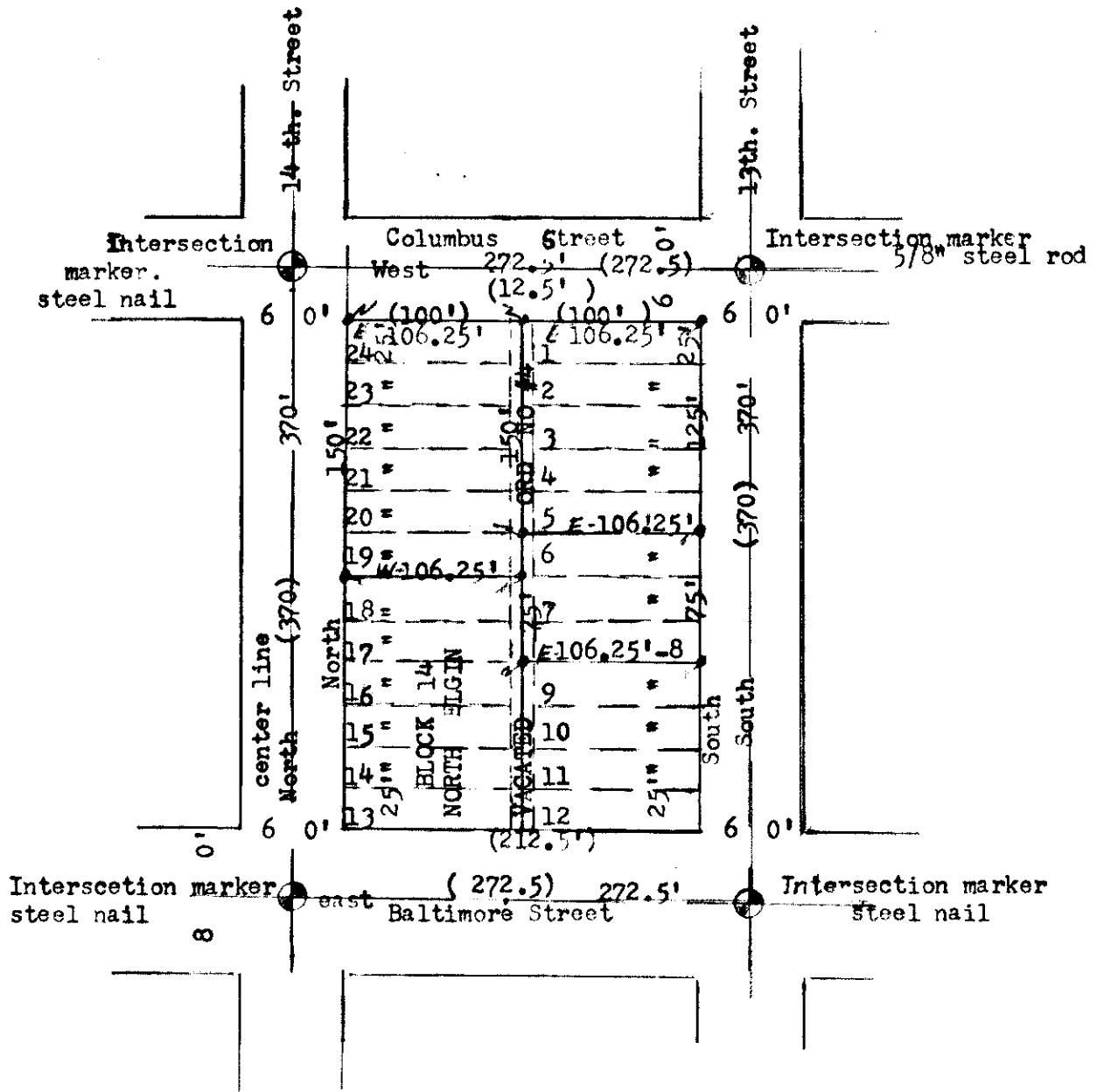

REGISTERED  
 PROFESSIONAL  
 LAND SURVEYOR

*(Signature)*  
 OREGON  
 MAY 4, 1956  
 JAMES G. VOELZ  
 381