

Steve C. Rowe
 1905 Washington Ave.
 La Grande, Oregon

April 20, 1972

Scale 1" = 50'
 set 5/8" X 30" steel rods.
 () data of record

Intersection marker

CROOK AVE.

steel nail 40'

NORTH SECOND STREET (336)
 335.95'
 center line of street north bearing.
 (basis of bearing)

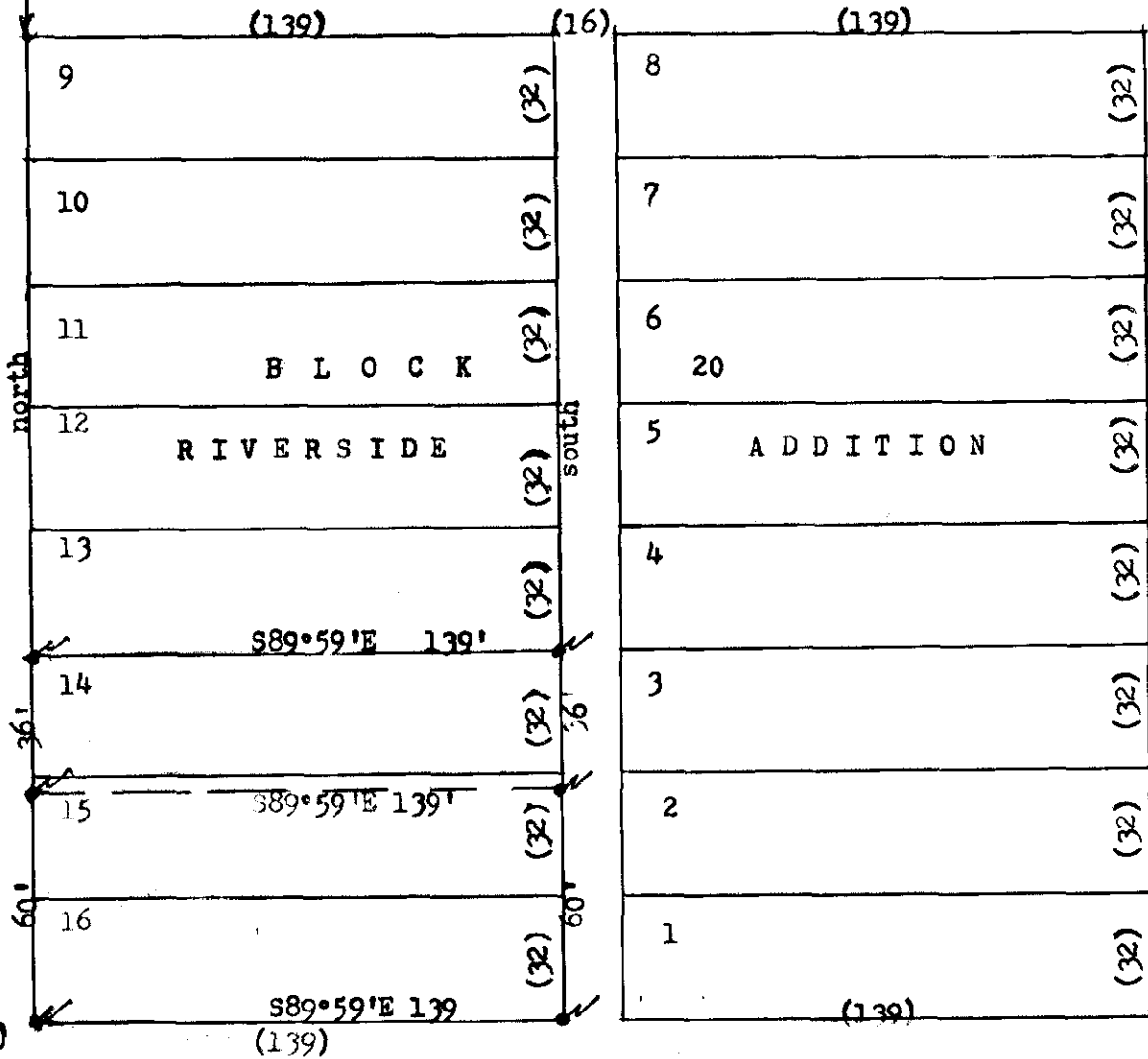

NORTH THIRD STREET (336)

initial point

intersection marker

ref lead plugs in curbs.

"Z" Ave. S89°59'E (374)

REGISTERED
 PROFESSIONAL
 LAND SURVEYOR
James G. Voelz
 OREGON
 MAY 4, 1966
 JAMES G. VOELZ
 381

19-72

19-1972