

Survey by
Oregon State Highway Dept.

BASIS OF BEARINGS
Forward bearing as published
by the U.S.C. and G.S. from
A College to A Valley

REFERENCE MATERIAL:

Survey by O.S.H.D.
Survey for Wallace Cass
Deed Records:
Book 145 page 507
MF 33741
MF 27020

To all parties interested in title to premises surveyed:

I, Duane I. Griffith, do hereby certify that in November and December of 1971 I did survey the parcel hereon shown. Do to the lack of original G.L.O. corners in this section, I locate the South line of this tract on the basis of the call distance in the description in Deed Volume 145, Page 507, from the southerly right of way line of Oregon State Highway 82, I find no encroachments.

LEGEND:

- Fd. Monument of Record
- Set 5/8" x 30" iron pin with Plastic Cap marked B G F SURVEY MK
- () Record bearing and distance

REGISTERED
PROFESSIONAL
LAND SURVEYOR

Duane I. Griffith

OREGON
JULY 10, 1964
DUANE I. GRIFFITH
644

BAGETT-GRIFFITH-FERGUSON		
<small>La Grande, Oregon Map of Survey</small>		
<i>Portion of the SE 1/4 of</i> Section 4; T 35; R 38E; W.M. <small>Union County, Oregon</small>		
SURVEYED FOR	Golden Oregon Adventures	
SURVEYED BY	D. I. G.	Dec. 1971
Scale: 1" = 200'	Drawn by: Edg	Dec. 1971

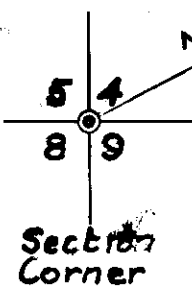

Map of Survey No. 91-71