

30-70

William Patrick Rollins estate
% Burleigh, Carey & Wooding
Fourth and Washington Ave.
La Grande, Oregon

April 18, 1970

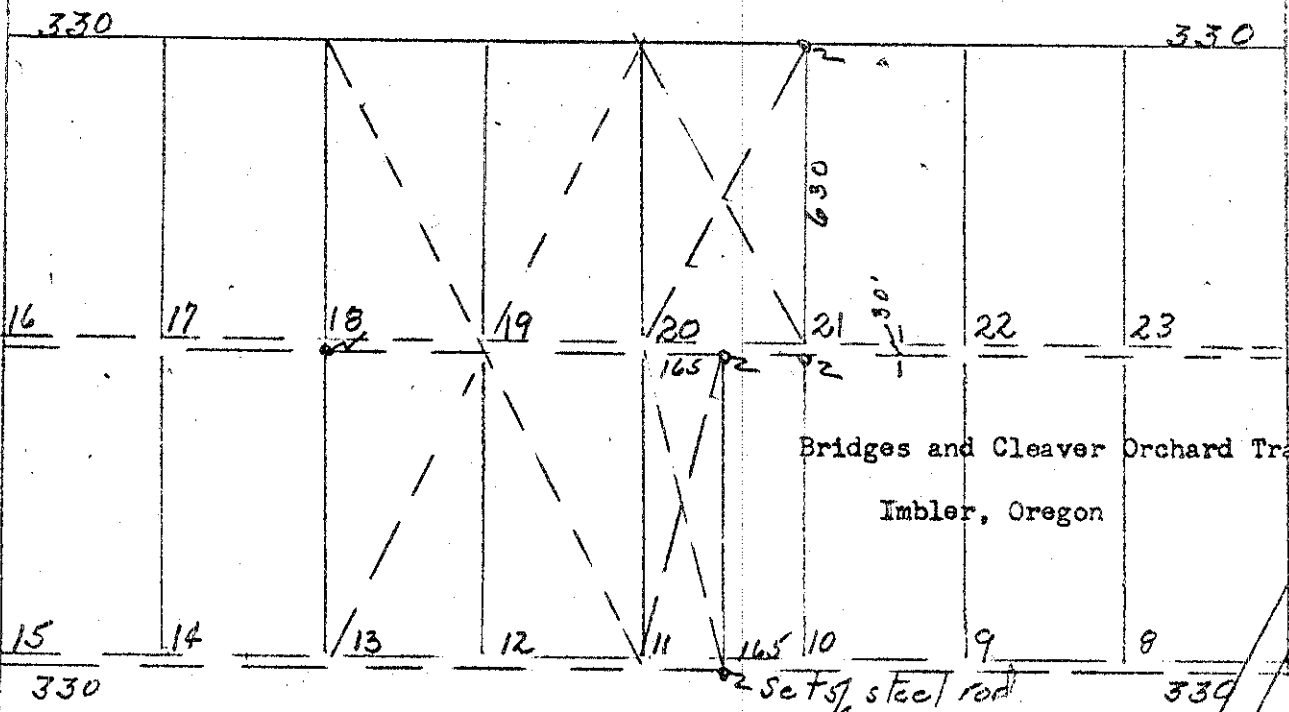

Scale 1" = 400'

Bridges and Cleaver Orchard Tracts
Imbler, Oregon

Description;
All of tract 12, 13, 18, 19, 20 and the west half of tract 11
of Bridges & Cleaver Orchard Tracts which are located in SE $\frac{1}{4}$ of
Section 17, T1S, R39E, W1M.

REGISTERED
OREGON
LAND SURVEYOR

James G. Voelz

MAY 4, 1963
JAMES G. VOELZ
331

T-1-S; R39E W1M

18 39 17
1202
1401