

10-608
10-108

89-01

Gary Erwin
Union, Oregon

April 14, 1968

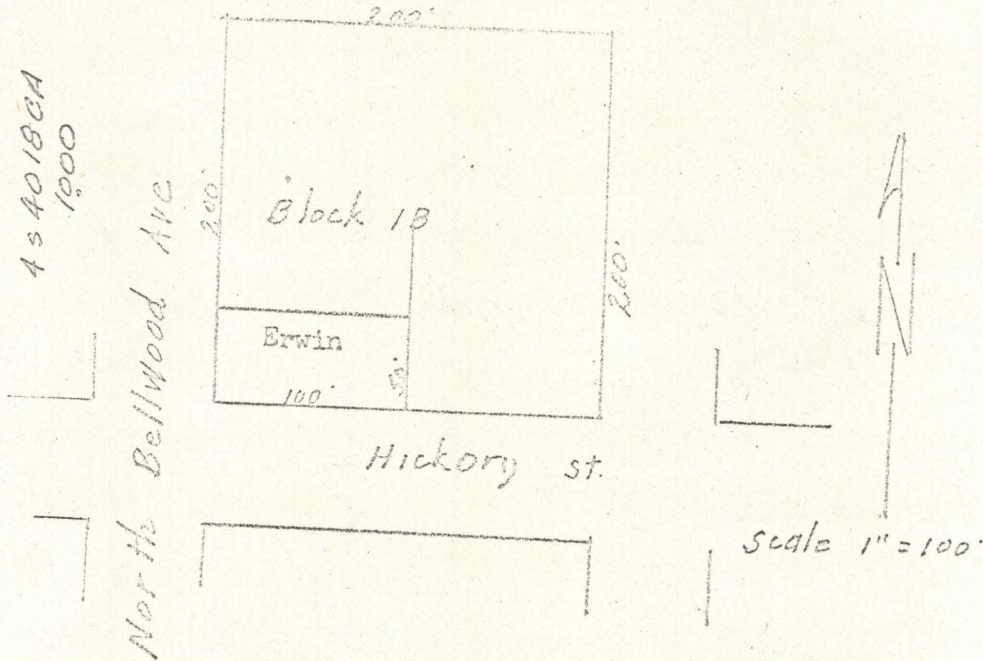

Description; The south half of the southwest quarter of Block 18 of Swackhammer's Addition to Union, Oregon.

REGISTERED
OREGON
LAND SURVEYOR

James G. Voelz

MAY 4, 1968
JAMES G. VOELZ
331