

5-66

James M. & Marlene J. Macfarlane
1412 Oak Street
La Grande, Oregon

April 13, 1966

"0" Ave.

curb line

(no walk)

35387AB 4000

property line /

110'

40'

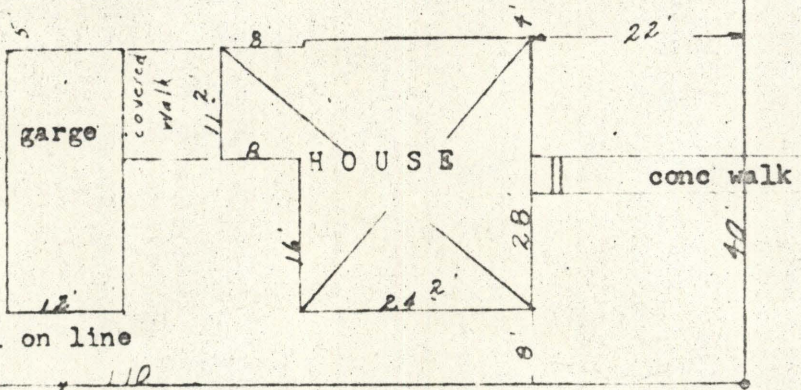

4.0' - sawn wood wall 2' high

rock retaining wall on line

Oak St

Description; Lot 1 of Block 7 of Wisdom's Addition to La Grande, Oregon.

I certify there are no encroachments onto or off of surveyed property except as shown.

REGISTERED
OREGON
LAND SURVEYOR

James G. Voliz

MAY 4, 1966
JAMES G. VOLIZ
381

scale 1" = 20'

5-66

5-66