

Survey for
 Marie M. and Alfred Shirley Jr.
 1309- 8th St. La Grande, Oregon

Date of survey, Jan 10, 1964

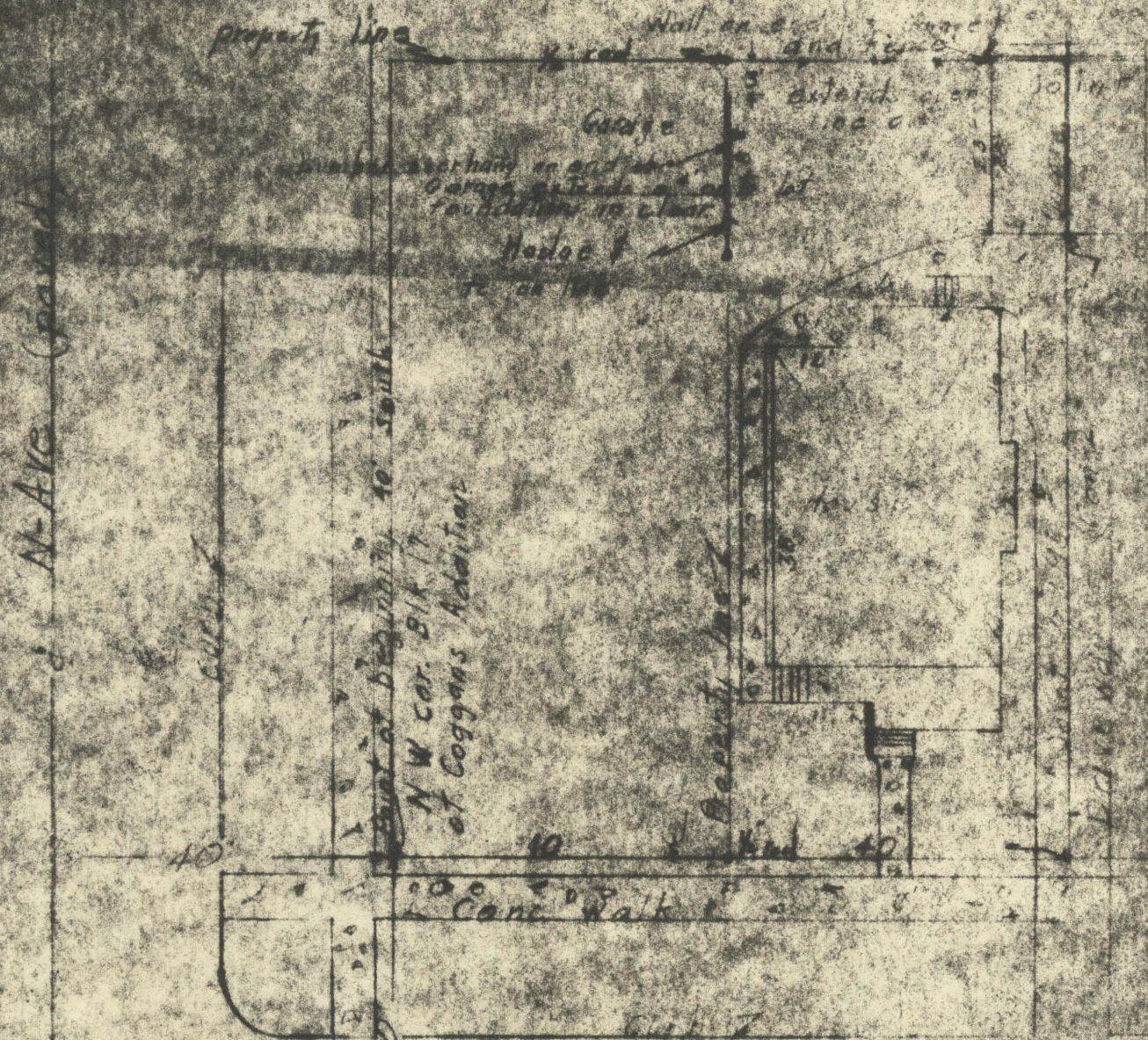

Description; Beginning at a point 40 feet south of the northwest corner of block 17 of COGGAN'S ADDITION to La Grande, Union County, Oregon, according to the recorded plat of said addition; running thence east 95 feet; thence south 40 feet; thence west 95 feet; thence north 40 feet to point of beginning.

scale 1" = 20'

I certify this survey was made by me on January 10, 1964 and results show encroachment of east wall of garage and eve overhang onto property to east. There is also a slight overhang from a bumper extension on end of garage of adjoining property on north onto surveyed property.

REGISTERED
 OREGON
 LAND SURVEYOR
James G. Voelz
 MAY 1, 1959
 JAMES G. VOELZ
 381

33-64

33-1964