

SHAW'S ADDITION.

To
Summerville.

Located in S. W. 1/4 Sec 12 T. 1 South, Range 38 East W. M.

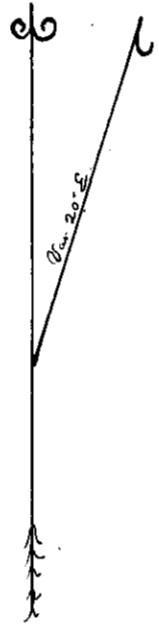
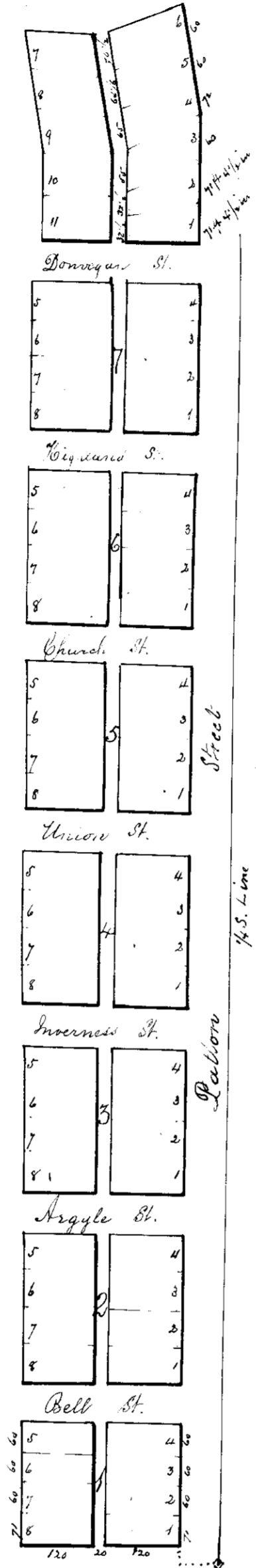

State of Oregon
County of Union: I Angus Shaw being the owner in fee simple of the land upon which
Shaw's Addition to the town of Summerville in Union County, State of Oregon is laid
out, do hereby declare this plat hereto attached to be a plat of said Addition. The
Initial or Commencing point of said Addition is at the S.E. corner of the S.W. 1/4 of
Section 12 Township 1 South Range 38 East Willamette Meridian. The Streets
are all 60 feet wide except the one on the extreme South which is 50 feet and forms
a part of the County Road. Alleys are 20 feet wide. All lots are 60 x 120 feet, except
the lots in the Block on the North which are as indicated on the plat, also lots
1 & 6 in Block 1 are 71 x 120 feet. The said Addition lies North and South along
the quarter section line as indicated by the plat. And I do hereby dedicate
to public use forever all the Streets and Alleys as shown on the plat.

In witness my hand and seal this 26th day of January A.D. 1884.
In presence of
O. F. Bell — P. E. Wade
Angus Shaw

State of Oregon
County of Union: This certifies that on this 26th
day of January A.D. 1884 before the undersigned a Notary Public of said Union
County personally appeared Angus Shaw to me personally known to be the person
described in and who executed the foregoing instrument of writing and
acknowledged to me that he executed the same freely for the uses and purposes
therein set forth. In witness whereof I have hereunto set my hand and official
seal the day and year last above written.

O. F. Bell.
Notary Public for Oregon

Scale 200 feet to the inch.

All full lots 60 x 120 ft. Alleys 20 ft.

Recorded January 26th 1884.
H. J. Knight
County Clerk.

18870003

SHAW'S ADDITION.

to

SUMMERYVILLE.

Located in S.W. 1/4 of Sec. 12, T. 1. S. R. 38. East W. 116.

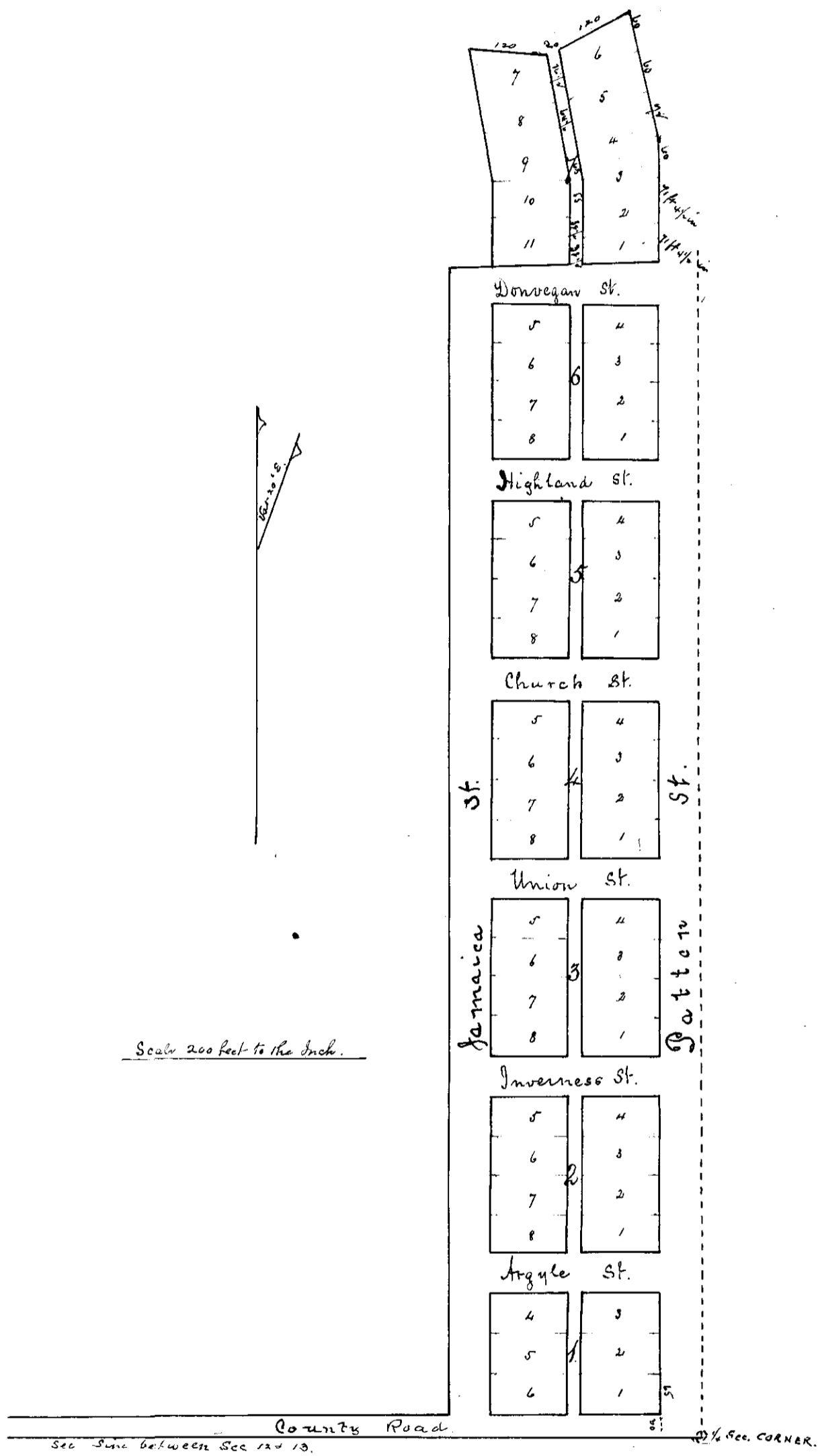

Filed January 4th 1887
 A. J. Hall
 Co. Clerk.

All full lots 60 x 120 ft.
 Alleys 20 ft wide
 Streets 60 ft wide

[Faint handwritten notes at the bottom of the page, possibly including a signature or date.]