

MOUNT EMILY ORCHARDS

IN THE
GRANDE RONDE VALLEY
UNION COUNTY, ORE.

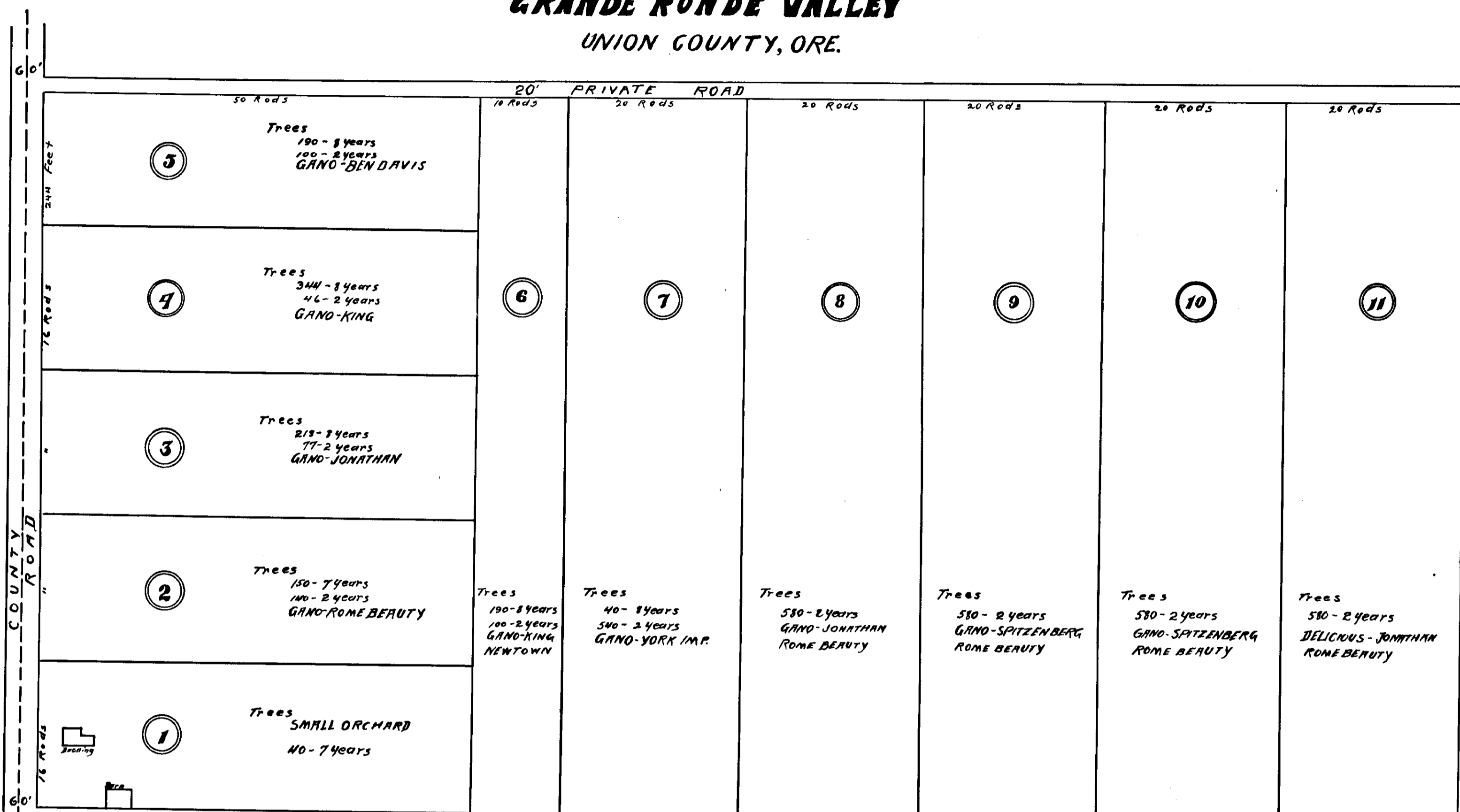

SE Cor. Sec. 34
T. 1. S. R. 31. E. W. M.

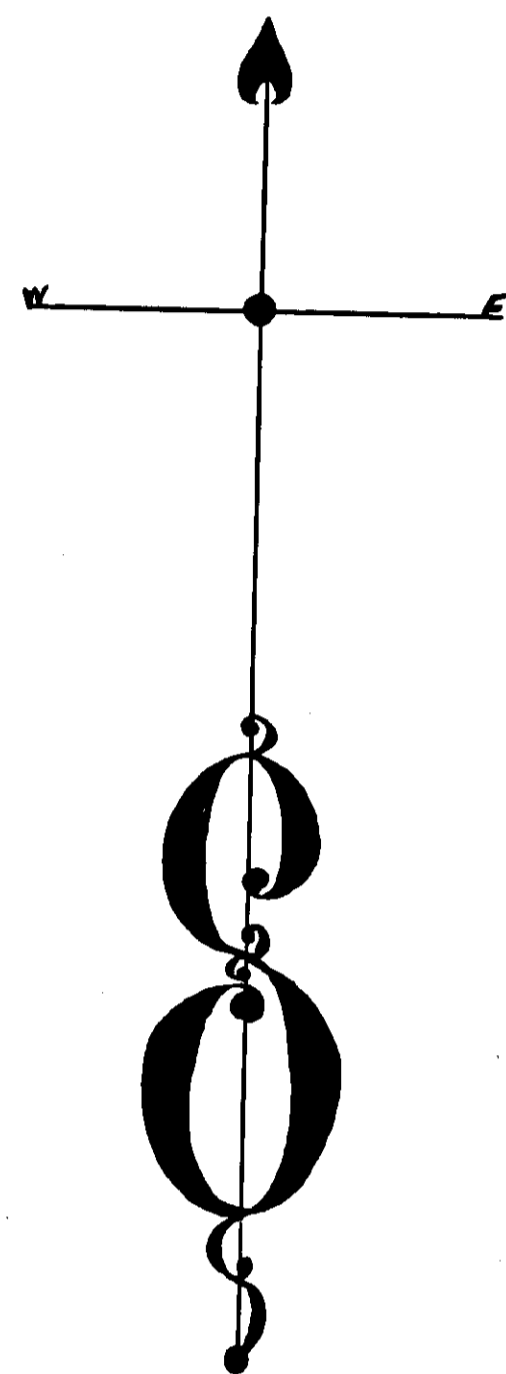

State of Oregon } ss
County of Union, }

I, Arthur Curtis, County Surveyor of Union County, Oregon, do hereby certify that the attached plat of Mount Emily Orchards is true and correct and corresponds with the measurements on the ground.
WITNESS my hand and seal this 8th day of Oct A.D. 1909

Arthur Curtis
County Surveyor

State of Oregon } ss
County of Union, }

I, T.A. Rinehart, County Assessor of Union County, Oregon, do hereby certify that the attached plat of Mount Emily Orchards is free from taxes and conforms to all requirements of law.

T.A. Rinehart
County Assessor

Approved Oct 8th 1909.

J. C. Koenig
County Judge

Filed Oct 9th 1909, at 10:45 A.M.

J. R. Deacon
Recorder of Conveyances.