

PLOT
of the Town of
ISLAND CITY.

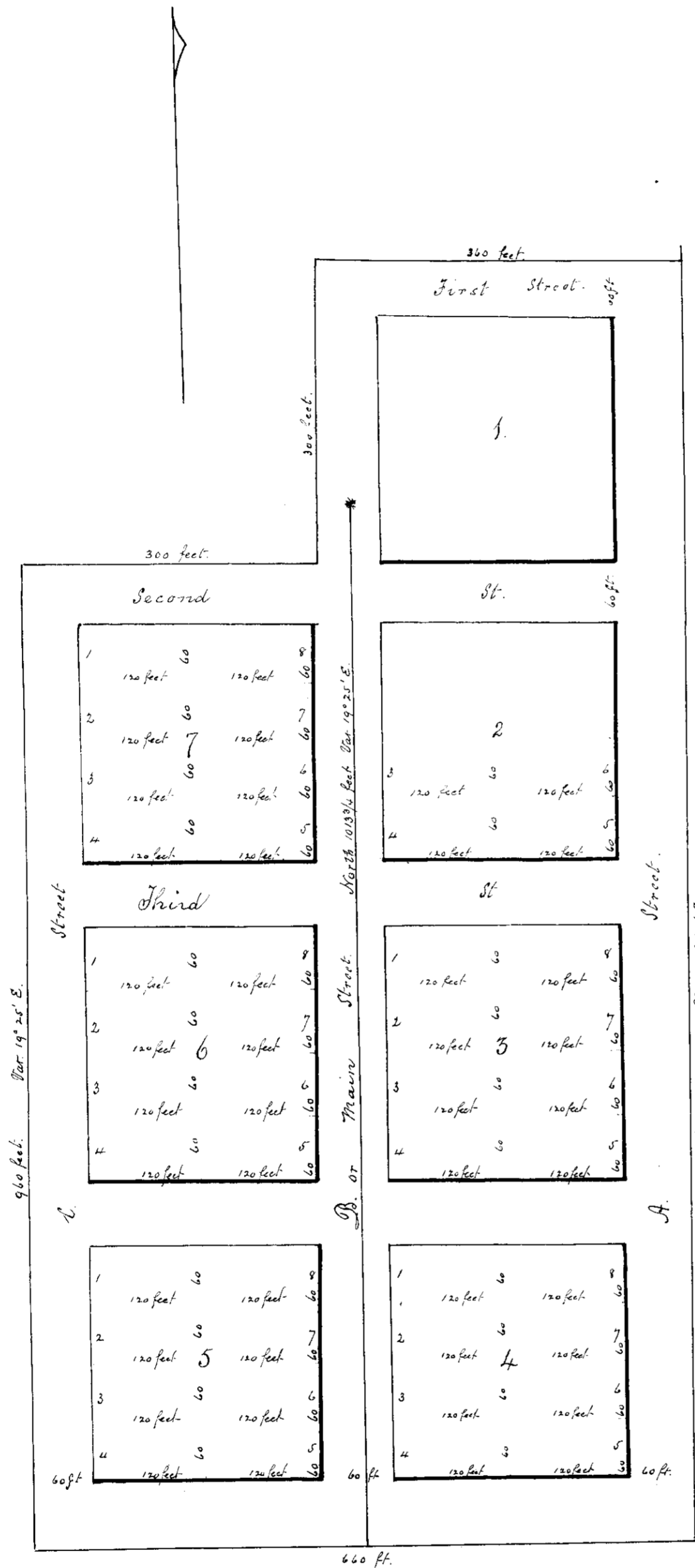

Commencing at a post bearing south from a rock 1/4 S distance 10137 1/2 feet. Thence east 330 feet to post, thence North 1260 feet to post, thence West 300 feet to post, thence South 300 feet to post, thence West 300 feet to post, thence South 960 feet to post, thence East 330 feet to place of beginning. And containing 17 3/4 acres of land. Situated in Union County, State of Oregon.

State of Oregon
Union County } ss J. Hillis Skiff being first duly sworn say that the above field notes together with the blocks and lots as marked on the plat are correct as made by me on the 7th and 8th of July 1874.

J. Hillis Skiff.

Subscribed and sworn to before me this the first day of August 1874.

S. Alverson
Justice of the Peace.

Recorded August 13. 1874
R. S. Cates, Co. Clerk.
per W. J. Wright, Deputy

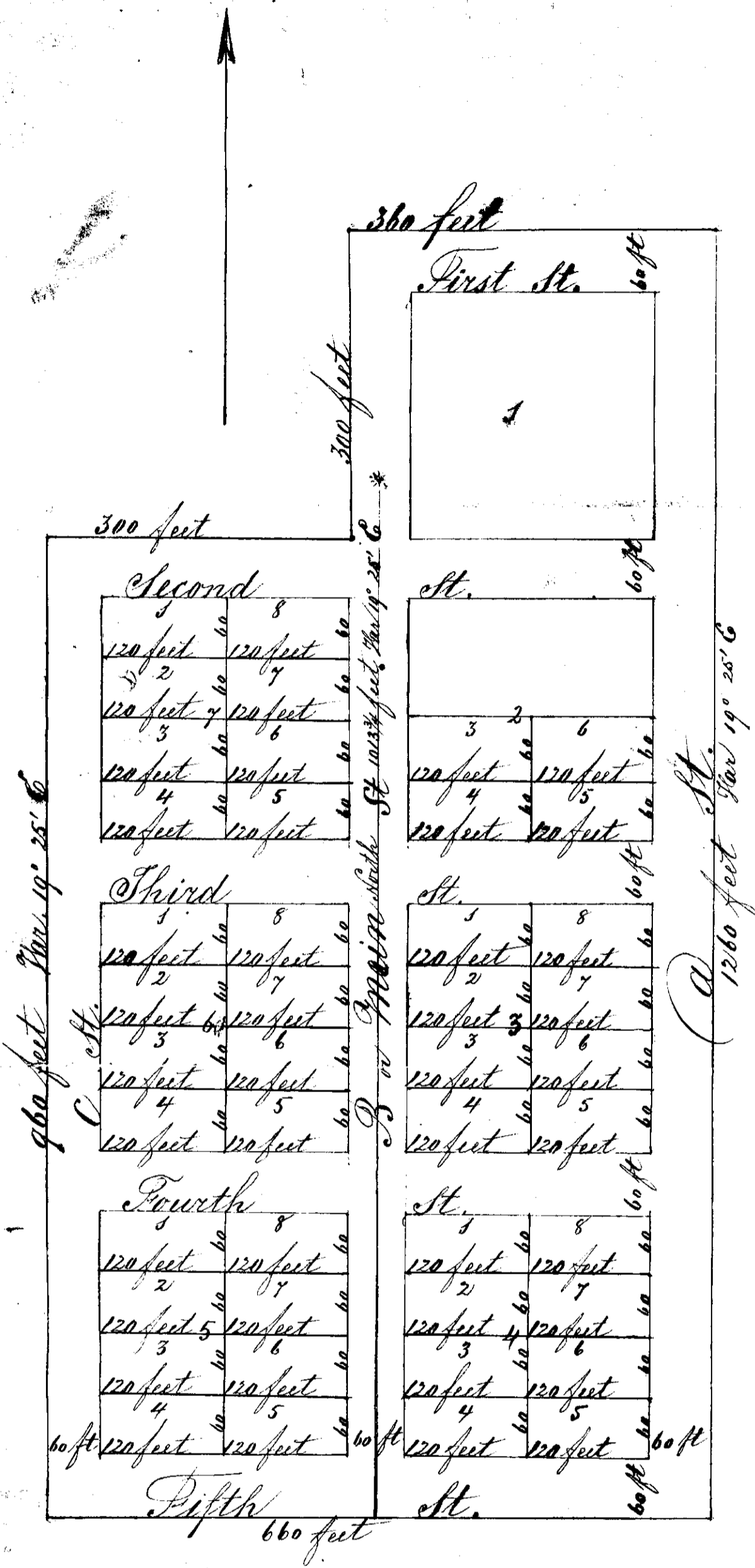

Plot

Of the town of Island City.
 Commencing at a post bearing South
 from a rock marked $\frac{1}{4}$ S distant 113 $\frac{1}{4}$ feet
 Thence East 330 feet to post. Thence
 North 1260 feet to post. Thence
 West 360 feet to post. Thence
 South 300 feet to post. Thence
 West 300 feet to post. Thence
 South 960 feet to post. Thence
 East 330 feet to the place of beginning
 And containing 17 $\frac{1}{2}$ acres of land
 Situated in Union County, State

of Oregon
 Union County

Willis Skiff

being first duly sworn say
 that the above field notes together
 with the blocks and lots as
 marked on the plot are correct
 as made by me on the 7th day of
 July 1874.

Willis Skiff

Subscribed and
 Sworn to before me
 this the first day
 of August 1874
 S. Ahlerson
 Justice of the peace

Recorded Aug 17th 1874

R. S. Lewis
 Clerk