

HELSON'S ADDITION,

to the City of

LA GRANDE, Ore.

Scale 50 ft one Inch

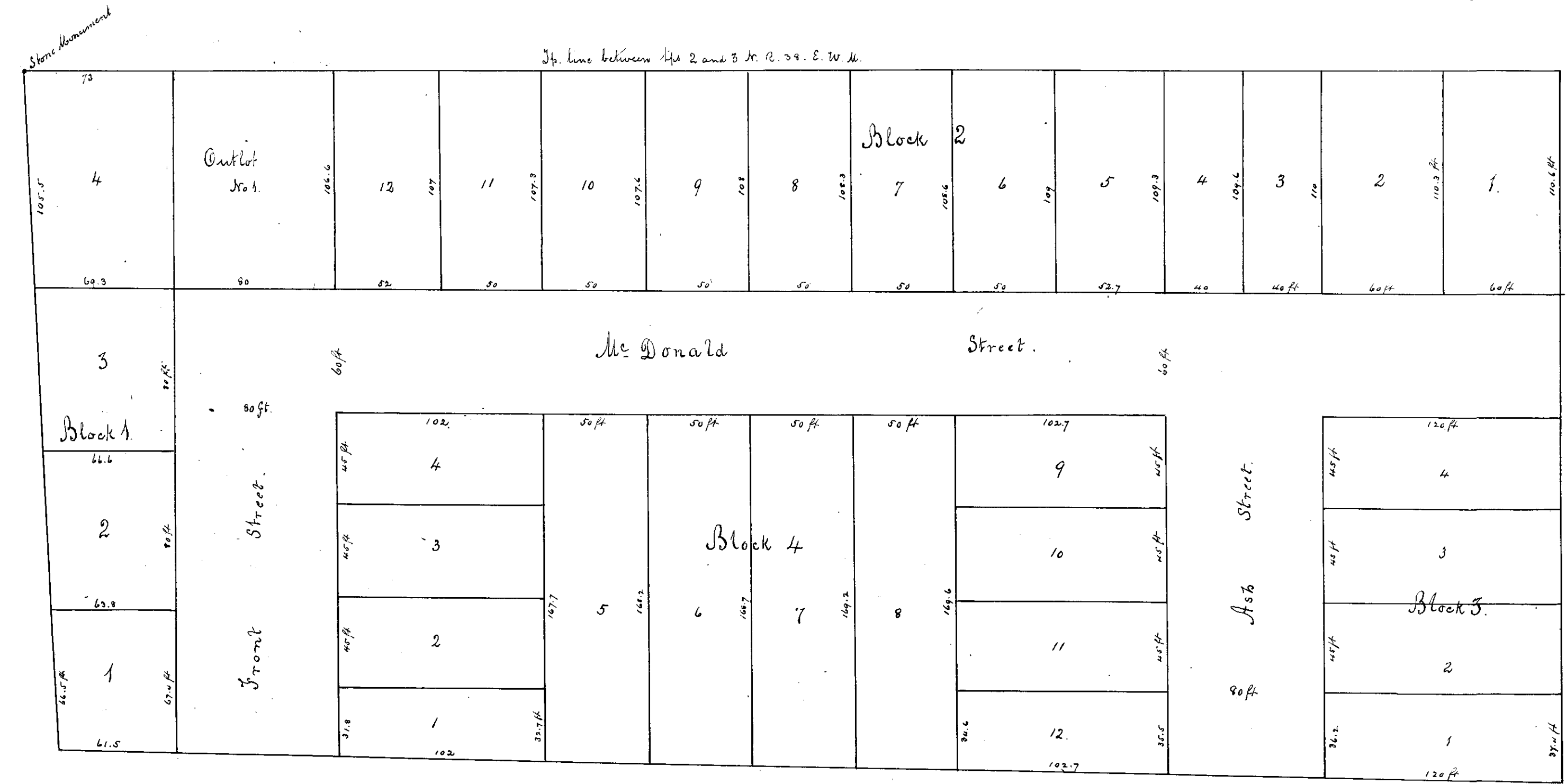

State of Oregon

County of Union: Personally appeared before the undersigned J. L. Heidenreich Notary Public for Oregon, on this 2nd day of July A. D. 1890. Walter Helson and Annie Helson his wife personally known to me who acknowledged to me that they surveyed laid out and platted all that parcel of land lying and situate in the North West 1/4 of Sec. 5 in Township 3 South of Range 38 E. W. M. in Union County, Oregon, more particularly described as follows: Commencing at the North West corner of said Sec. 5 Twp. and Range aforesaid, thence running along said section and township line East 757.7 feet, thence South 381.5 feet, thence West 746.2 feet, thence North 335.9 to place of beginning, in town lots, blocks and alleys, and that the plat upon which this acknowledgment and certificate is placed is the original and true plat of said survey and land so laid out, that they hereby dedicate the blocks and alleys thereon represented, as required by law and that the same is their voluntary act and deed which acknowledgment of Annie Helson the wife was made separate and apart from her husband Walter Helson.

Witnesses.

Jonathan Long — J. Heidenreich
 Walter Helson
 Annie Helson

[Signature]
[Signature]

In witness whereof I have hereunto set my hand and seal this July 2nd 1890.

J. L. Heidenreich
 Notary Public for Oregon

Recorded July 5, 1890 8 o'clock A. M.
 A. J. Neill, County Clerk

[Notary Seal]

Transferred from Book O. of Records of Deeds page 488
 this 2nd day of March A. D. 1891
 John L. Elliott Recorder
 By *[Signature]* Deputy