

EQUITY.

No 17

In CIRCUIT COURT
UNION COUNTY

Samuel Hough Jr

Plaintiff

vs

Alice E Hough

Defendant

B F Nelson

Attorney for Plaintiff

Attorney for Defendant

THE IRWIN HOBSON COMPANY P T S T N

N 20737

Patented July 6, 1891

Grand Rapids Lumber Co.
Logging, Mich.

Beginning at a point on the

northern line of

Secs 27, 28, 29, 30, 31, 32, 33, 34, 35, 36

and terminating on the

bank of Grand Rapids River

at a point in the Sec. 34

Sec 15 T³ R³⁶ Town

K 44-112-173 - 174

534-543

Patented July 6, 1891

Grand Rapids Lumber Co.

Map of Lot of Lands of Grande Ronde Lumber Co.,
 4-590 B QM Suspect Logging Road
 Township No Shres (31) South Range No Thirty Six (36) 6th Mex

EXPLANATORY NOTES

The proposed road for logging purposes, to be used mostly in the winter by the Grande Ronde Lumber Co to haul its logs

Commences at a point, on the 1/4 corner near the Sec bet. Secs 27-34 Sp 35 Rq. 36 6th Mex. thence N. 80 de and 6 700 ft to the beginning of Road

- Thence 17° 54' N 750 ft
- " " " " N. 100 ft
- " " " " 23° W of N 300 ft
- " " " " 47° W of N 350 ft
- " " " " 18° W of N 200 ft
- " " " " 23° E of N 250 ft
- " " " " 11° E of N 250 ft
- " " " " 20° E of N 350 ft
- " " " " 23° E of N 650 ft
- " " " " 28° W of N 450 ft
- " " " " 55° W of N 450 ft
- " " " " 10° W of N 450 ft

Being on Sec 27
 Section 27-27
 331 ft E of cor p

- " " " " 07° W of N 200 ft
- " " " " 42° W of N 600 ft
- " " " " 40° W of N 300 ft
- " " " " 21° W of N 350 ft
- " " " " 3° W of N 400 ft
- " " " " 10° W of N 650 ft
- " " " " 2° E of N 1500 ft
- " " " " 19° E of N 1200 ft
- " " " " 19° E of N 175 ft

Being on Sec 27
 Sp 35 Rq. 36
 5 of 21 W of Sec 27

- " " " " 19° E of N - 95 ft
- " " " " 30° E of N - 550 ft
- " " " " 20° E of N - 130 ft
- " " " " 19° N of N - 270 ft
- " " " " 32° N of N - 450 ft
- " " " " 37° N of N - 130 ft
- " " " " 76° N of N - 320 ft
- " " " " 17° S of N 150 ft - crossing E. Road
- " " " " 78° W of N - 200 ft
- " " " " 47° N of N - 180 ft
- " " " " 2° N of N - 420 ft

being then on S bank of Grande Ronde River

Dec 15 Sp 35 Rq 36 E. terminus of proposed road. being about 787 rods long.

Lands for road to cross:
 NW 1/4 Sec 27 - Mary & Lowley
 N 1/2 Sec 27 - SM 1/4 Sec 27
 NW 1/4 Sec 22 - Smith & Pierce
 NW 1/4 Sec 22, E 1/2 Sec 27 - Mary & Lowley

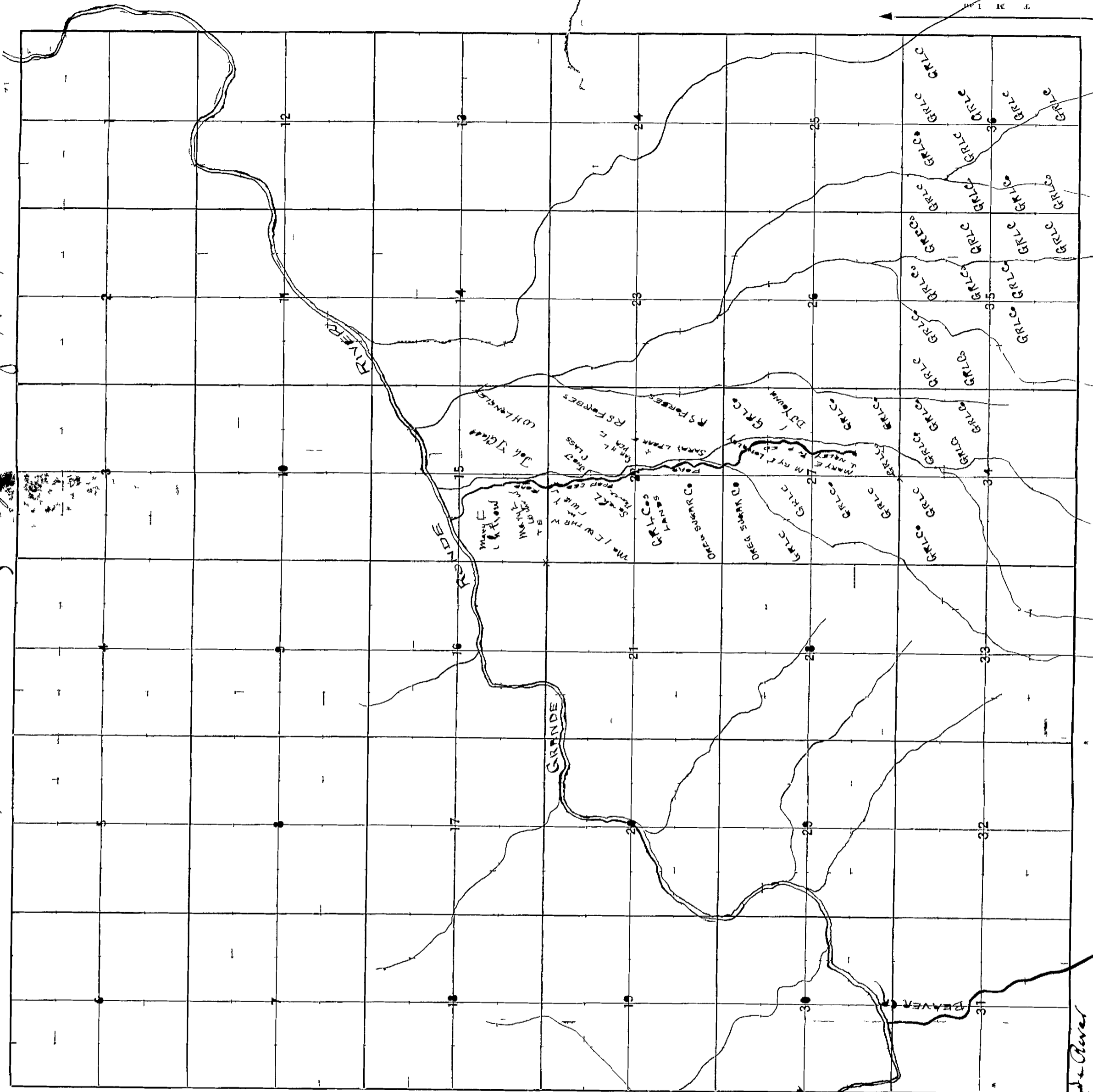

Lands of Petitioner for use of Logging Road.

N 1/2, NW 1/4 Sec 34 -
 E 1/2 SW 1/4 - E 1/2 - SW 1/4 Sec 27
 S 1/2 NW 1/4 Dec 27 N 1/2 NW 1/4 - S 1/2 NW 1/4
 - SW 1/4 NW 1/4 - NW 1/4 NW 1/4 - S 1/2 NW 1/4
 Dec 35 all in Sp 35 Rq 36 E

Mary & Lowley

In County Court
Union Co, Oregon

Map
or
Plat, with

Petition of
The Guide Road
Lumber Co
for Logging Road

Filed July 8th 1902

J. M. Mumma
By Ed. L. Mumma
Attorney

TO THE HONORABLE COUNTY COURT OF UNION COUNTY, OREGON,-
Your petitioner respectfully represents:

That it is a private corporation duly organized and existing under the laws of the State of Oregon having its principal place of business and office at Perry, Union County, Oregon.

That as such corporation it is engaged in the manufacture of lumber, having a large plant at said Perry, Union County, Oregon, and as such manufactory it is also the owner of large tracts of timbered land in the vicinity of said mill, and along the Grande Ronde River and its tributaries south and west of its said plant.

That the Grande Ronde River is a navigable stream rising in Township 3 South, of Range 35, and flowing in a northeasterly direction through and by the lands of your petitioner, and through said Perry, Union County, Oregon, adjacent to the manufacturing plant of your petitioner.

That your petitioner in order to obtain the timber off its said lands and to haul or transport the same to its said manufacturing plant at Perry can and does utilize the channel and water of said Grande Ronde River.

That your petitioner is the owner of the following lands, to-wit: The north half of the southwest quarter of Section 22, the south half of the northwest quarter and the east half of the southeast quarter and the east half of the southwest quarter and the southwest quarter of the southeast quarter of Section 27; the north half of the northwest quarter and the northeast quarter of Section 34, and the north half of northwest quarter and the Southwest quarter of the northwest quarter of Section 35, all in Tp. 3, S, R. 36; and that the said lands contain an

estimated amount of one million feet of merchantable timber growing on each quarter section thereof-as more fully appears and is designated as to location -upon the accompanying map.

That there is no public-road, or acquired right of way-and that there is no direct or feasible way from your petitioner's said timber lands to arrivable or navigable water-or railroad, whereon or whereby said timber can be moved or hauled to market -or to your petitioner's said manufacturing plant -and that your petitioner desires that it may have your order and license therefor-and that your honorable body will view, locate and establish for your petitioner a logging road leading from its said timbered lands to the Grande Ronde River so that it may transport and haul its said timber-but that the feasible way for said road-will be across the private lands of others-especially -the west half of the southeast qr-and southwest qr of northeast qr-and and the southeast qr of the northwest qr-of Sec.22-Tp 3 S.Rge 36 E-belonging to Sarah L.Pearce--and the northeast qr of the northwest qr of said Section 22-Tp 3 S-Rge 36 E-belonging to Mary E Withrow-and the east half-and northwest qr of the southwest qr of Section 15-in Township 3 S-Rge 36 E.W.M.-belonging to the said Mary E.Withrow-and that these parties do not desire to permit your petitioner to use their said lands for such logging road-without onerous obligations which will be a hardship to your petitioner-and not a fair or just price therefor.

That the E hf NE qr-and NW $\frac{1}{4}$ SE $\frac{1}{4}$ Sec.27 -belongs to Mary E.Longley.

That your petitioner has thoroughly examined the proper and feasible route-and at its own expense - has surveyed and marked on the ground and on the accompanying map or plat -such route or right of way for such proposed logging road -which it is desirous of constructing-and that the lands over which the same is located by such survey-are not valuable, or highly improved lands-and the taking of the same for such logging road of thirty feet in width-will not injure said lands-nor be a burden on the same or their owners-and said route so surveyed is as follows:-

Commencing at a point, or the quarter corner or post on the section line between Section 27 and 34 in Tp. 3, S. R. 36, E. W. M.,- thence north 80 rods and east 700 feet to the beginning of said proposed road, the same being the commencing point thereof; thence running 17 deg. east of north 750 feet; thence north 100 feet; thence 23 deg. west of north 300 feet; thence 47 deg. west of north 350 feet; thence 18 deg. west of north 200 feet; thence 23 deg. east of north 250 feet; thence 11 deg. east of north 250 feet; thence 20 deg. east of north 350 feet; thence 23 deg. east of north 650 feet; thence 28 deg. west of north 450 feet; thence 55 deg. west of north 450 feet; thence 10 deg. west of north 450 feet, being on the section line between Sections 22 and 27 and 331 feet east of the quarter corner or post; thence running 7 deg. west of north 200 feet; thence 42 deg. west of north 600 feet; thence 40 deg. west of north 300 feet; thence 21 deg. west of north 350 feet; thence north 350 feet; thence 3 deg. west of north 400 feet; thence 10 deg. west of north 650 feet; thence north 1500 feet; thence 2 deg. east of north 1200 feet; thence 19 deg. east of north 175 feet; being then on the section line between Sections 15 and 22, and 2200 feet east of the northwest corner of said Section 22; thence running 19 deg. east of north 75 feet; thence 30 deg. east of north 550 feet; thence 20 deg. east of north 130 feet; thence 19 deg. west of north 270 feet; thence 32 deg. west of north 450 feet; thence 37 deg. west of north 130 feet; thence running 76 deg. west of north 320 feet; thence 7 deg. south of west 150 feet, and crossing the county road running between Starkey and Hilgard; thence running 78 deg. west of north 200 feet; thence running 47 deg. west of north 180 feet; thence 2 deg. west of north

420 feet to the Grande Ronde River, the last point being on the south bank thereof, and in said ^{northwest} ~~southeast~~ quarter of the ^{southwest} ~~northeast~~ quarter of Section 15, Tp. 3, S, R. 36, as the terminus of said proposed road and said road being in the aggregate 787- rods long, and being generally in a northerly direction.

That said road so surveyed and described as to direction is to be 30 feet wide, and runs along or in the vicinity of a tributary of said Grande Ronde River along the bottom land thereof and that said ~~section~~ of the country being hilly, it is necessary to make the angles as aforesaid in order to obtain a feasible and direct route between said timbered lands of your petitioner and said navigable or drivable water to said Grande Ronde River and by means of the construction of said road, your petitioned will be enabled to cut from its said lands said timber, haul them over the proposed road to the Grande Ronde River and therein float the same to its said mill and manufactory plant, and your petitioner herewith presents a good and sufficient undertaking with two sureties, conditioned that your petitioner or applicant will pay all costs and expenses that may be incurred by reason of filing this petitioned, and all costs and expenses of viewing a survey of such road, whether the same is located or not.

And your petitioner prays for the license and order of the court viewing said proposed road and the establishing of a right of way over said survey of said lands for a logging road from your petitioner's said lands to said Grande Ronde River as the most direct and feasible way for the removal of your petitioner's timber as aforesaid, and your petitioner will ever pray.

The Grande Ronde Lumber Co-
Perry, Union County, Oregon.

STATE OF OREGON,
COUNTY OF UNION. } ss.

I, _____, being first duly sworn, depose and say
that I am the President of _____ in the above entitled _____;
and that the foregoing _____ is true as I verily believe.

L. H. Stanley

Subscribed and sworn to before me this _____ day of _____ 190_____

C. H. Fin
Notary Public for Oregon.

STATE OF OREGON,
COUNTY OF UNION. } ss.

I, _____, do hereby certify that I am
_____ attorney herein; that the foregoing
copy of _____ has been by me carefully compared with
the original thereof and that it is a correct transcript therefrom and the whole of such original.
La Grande, Oregon, dated this _____ day of _____ 190_____

Due service of the within _____ is hereby accepted in
_____ County, Oregon, this _____ day of _____ 190_____, by receiving a
copy thereof, duly certified to be such by _____ attorney for _____

Attorney for the _____

No.

In the **County** Court,
State of Oregon,
For the County of Union.

**The Grande Ronde
Lumber Co (incorporated)
Petitioner for
Docketing Road.**

Deponent

**Petition for Docketing
Road**

Filed

July 8

1902

Clerk.

By

C. H. Finn
Deputy.

FROM THE OFFICE OF

C. H. FINN,

Attorney for

Petitioner

State of Oregon)
County of Union.) ss

I, T. B. Johnson, being first duly sworn, say that I am a regularly qualified Deputy Sheriff of Union County, Oregon; that I served the within notice, within said County and State on the 22 day of July, 1902, on the within named John J. Bease by delivering a copy thereof, duly certified as such, to the said John J. Bease in person.
Union, Oregon, this 24th day of July, 1902.

T. B. Johnson

Subscribed and sworn to before me this 24th day of July, 1902.

J. M. Minnaugh
County Clerk of Union Co., Ore.

By Deputy.

State of Oregon-

County of Union-SS:- In the County Court of Union County.

In the application of the Grande Ronde
Lumber Co-(a private corporation) to
establish a logging-road in Union County.

To

John J. Glass

You will please take notice that the Grande
Ronde Lumber Co-(a private corporation) has this day filed a
petition and map in the county Court providing the location of
a right of way for a logging road through lands in your possess
ion in Section ^{1st} 22 Township 3 south of Range 30 E.W. and in
said County-and said application will come on to be heard before
said Court at the next regular term thereof for appointment of
viewers to locate said road in said county in which said court
will be held-on Friday, August 8th 1902-said term commencing on
Wednesday, August 6th 1902-at which time you are required to ap-
pear and file your claim for damages that may consider you will
sustain in case said right of way is located as by said map
shown and in said petition prayed:-and further-you do then show
cause-if any you have-why said right of way should not be located
as by said map shown and projected.

Witness my hand and the seal of the said Court of Union County
this July 19 1902-

J. N. Minnaugh Clerk.
By E. P. Schow Deputy

Original

John H. ...
...
...
...

Received July 14th 1902

E. C. Pennington Sheriff

By G. B. Johnson Deputy

In the Matter of the Application
of the Grande Ronde Lumber Co-for
right of way for logging road in
Twonship 3 south of Range 36 E.W.M.-

And now at this time -August 8th 1902-this matter came
on for hearing upon the application of the said Grande Ronde
Lumber Co-for such right of way and establishment of a log-
ging road-as prayed for in the petition -and upon all alle-
gations of persons interested-and the court being fully ad-
vised by the papers, record and by testimony offered-finds
and determines:-

- (1) That said proposed logging road-survey and description
of route is feasible-
- (2) That it is necessary for applicant to have such right of
of way over the said lands of the persons so named in the
petition and map so filed herein-
- (3) That it is advisable that viewers be appointed and
said proposed location of said right of way and said log-
ging road is advisable-
- (4) That all the proceedings had-petition, map-notices,
services of said notices-published notice-bond etc are
regular-and sufficient.

It is therefore ordered that R.R.Collins-C.N.Lewis and
Arthur Arnold-
be appointed as viewers to proceed as provided by law to
view ^{and locate} said proposed logging road and to assess all damages
the respective parties ^{who have heretofore filed their claim for damages herein} shall sustain by reason thereof or
the location of said right of way over the lands of any
and all persons interested. ^{at goodlock, Ore} To meet at Hilgard-Aug 25th 1902
and file report by Sep-3rd 1902.

M. A. Harrison County Judge

Robert Blumenthal Commissioner

Jas. A. Pilcher Commissioner.

-IN THE COUNTY COURT OF UNION COUNTY STATE OF OREGON-

In the matter of the application)
of the Grande Ronde Lumber Co., a)
private corporation, to estab-) **-CLAIM FOR DAMAGES-**
lish a logging road in Union)
county, state of Oregon.)

Sarah L. Pearce, makes the following claim for damages in the above-entitled matter, and represents:-

-1-

That she is the owner in fee of all the following described real-property, though which the proposed logging road above mentioned will or is proposed to be located by the above named corporation, to wit:-
SE-1/4 of NW-1/4, and SW-1/4 of NE-1/4, and W-1/2 of SE-1/4 of section 22, in township 3 south, of range 26, E.W.M., in the county of Union, state of Oregon.

-2-

That she is in the exclusive occupancy of the whole thereof as such owner, and that the location thereon of the above proposed logging road, by the above-named Grande Ronde Lumber Co., a private corporation, will damage said property and this claimant in the sum of \$ 150.00-

W h e r e f o r e, the undersigned claimant for damages, and owner of the above-described real property claims the sum of one hundred and fifty dollars, her damages in the event said proposed road is located over and upon her said real property by said company, according to the terms of its petition and map on file with the clerk of above-named court.

State of Oregon,)
County of Union.)ss-

Sarah L. Pearce
Joachim Kling, her attys.

I, Sarah L. Pearce, being first duly sworn, say:-I am the claimant who signed the above-application for damages, and that the statements set forth in said claim, are true, as I verily believe.

Subscribed and sworn to before me this 26th day of July, 1908-

Sarah L. Pearce
J. Frank
Notary-Public-for-Oregon.

In the county court
Union county, Oregon

Since application of
Grande Ronde Lumber Co
for logging road

Claims of Sarah T. Pierce
for damages

Filed August 6, 1902.

J. W. Merritt
Deputy

Stanley Cherry
attys for claimant

State of Oregon)

County of Union.)

ss I, T. B. Johnson, being first duly sworn, say

that I am a regularly qualified Deputy Sheriff of Union County, Oregon; that I served the within notice, within said County and

State on the 22 day of July, 1902, on the within named R. S.

Forbes by delivering a copy thereof, duly certified as such, to the said R. S. Forbes in person.

Union, Oregon, this 24th day of July, 1902.

T. B. Johnson

Subscribed and sworn to before me this 24th day of July, 1902.

J. W. [Signature]
County Clerk of Union Co., Ore.

By _____ Deputy.

State of Oregon

County of Union-SS:- In the County Court of Union County.

In the application of the Grande Ronde Lumber Co-(a private corporation) to establish a logging-road in Union County.

To R. H. Jones

You will please take notice that the Grande Ronde Lumber Company-(a private corporation) has this day filed a petition and map in county court providing the location of a right of way for a logging road or chute through lands now in your possession in Section 22 Township 3 south of Range 36 E.W.M. in said County and said application will come to be heard before said Court at the next regular monthly term thereon for appointment of viewers to locate said road in said county in which said court will be held-in Union, Union County, commencing on Wednesday, August 6th 1902--at which time you are required to appear and file your claim for damages that you may consider you will sustain in case said right of way is located as by said map shown and in said petition prayed;-and further-you do then show cause, if any you have -why said right of way should not be located as by said map shown and projected.

Witness my hand and the seal of the said court of Union County, this July 1902-

J. B. Munn Clerk.

E. P. Schenck Deputy

Original

Recd July 25-1902
J. P. Hammond
C. P. Hammond

Recd July 19th 1902
C. P. Hammond & Son
By W. B. Johnson & Son

State of Oregon)

County of Union.)^{ss}

I, T. B. Johnson, being first duly sworn, say that I am a duly and regularly qualified Deputy Sheriff of Union County Oregon. That I served the within notice, within said County and State, on the 22nd 21st day of July, 1902, on the within named Oregon Sugar Company, by delivering a copy thereof prepared and certified to by C. C. Penington, Sheriff of said County, to George Steddard in person, he the said George Steddard being the Manager of the said Oregon Sugar Company.

Dated this 24th day of July, 1902, at Union, Union County, Oregon.

T. B. Johnson.

Subscribed and sworn to before me this 24th day of July, 1902.

J. M. Penington
County Clerk of Union County Oregon.

By _____ Deputy.

State of Oregon

County of Union-SS:- In the County Court of Union County.

In the application of the Grande Ronde Lumber Co-(a private corporation) to establish a logging-road in Union County.

To Oregon Sugar Co -

You will please take notice that the Grande Ronde Lumber Company-(a private corporation) has this day filed a petition and map in county court providing the location of a right of way for a logging road or chute through lands now in your possession in Section ^{20 & 27} ~~1~~ Township 3 south of Range 36 E.W.M. in said County and said application will come to be heard before said Court at the next regular monthly term thereon for appointment of viewers to locate said road in said county in which said court will be held-in Union, Union County-commencing on Wednesday, August 6th 1902--at which time you are required to appear and file your claim for damages that you may consider you will sustain in case said right of way is located as by said map shown and in said petition prayed;-and further-you do then show cause, if any you have -why said right of way should not be located as by said map shown and projected.

Witness my hand and the seal of the said court of Union County, this July 1902-

By

J. H. Minnau Clerk.
E. P. Schow Secy

Carissima

Miss July 25/1902

W. M. M. M.
County Clerk

Recd July 14. 1902

E. P. Pennington Sheriff

By A. B. Johnson Clerk

In the County Court of Union County-State of Oregon-

In the Matter of the Application of the
Grande Ronde Lumber Co-to establish a
logging-road in Union County.

To All Whom it May Concern:-You are hereby notified that
the Grande Ronde Lumber Co-a private corporation of Perry, Oregon
has filed its petition and map in the County Court providing for
the location of a right of way for a logging-road as follows:-
Beginning at a point-or the quarter corner or post on the Sec.
line between Sections 27 and 34-in Twp 3 south Range 36 E.W.M.
thence north 80 rods and east 700 feet-as the commencement of
the $W\frac{1}{2}$ $NE\frac{1}{4}$ and $NW\frac{1}{4}$ $SE1$ -Sec.27-and
said proposed road-thence running northerly through the $W\frac{1}{2}$ $SE\frac{1}{4}$ -
the $SW\frac{1}{4}$ $NE\frac{1}{4}$ --the $SE\frac{1}{4}$ $NW\frac{1}{4}$ -the $NE\frac{1}{4}$ $NW\frac{1}{4}$ -Sec.22-and and the $E\frac{1}{2}$ -and
 $NW\frac{1}{2}$ $SW\frac{1}{2}$ Sec.15-all in Township 3 south Range 36 E.W.M.-and termi-
nating on the south bank of the Grande Ronde River-at a point in
the $SE\frac{1}{4}$ $NE\frac{1}{4}$ Sec.15-Tp 3 south Rge 36 E.W.M.-and that the same
will come up for hearing and the appointment of viewers on Fri-
day, August 8th 1902- at 11 oclock A.M. of said day--and that any
and all persons having or claiming any interests in said lands
through which said road is proposed to be located are, to appear
at that time and file their complaint for damages or show cause
why said logging road should not be located as asked by the
petitioners-the Grande Ronde Lumber Co, ~~the applicants.~~

Dated at Union, Union County, Oregon-July 8th 1902.

Witness my hand and official seal of the County Court of
Union County, Oregon.

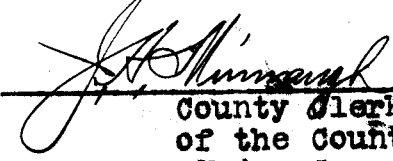
County Clerk-and Clerk
of the County Court-
Union County, Oregon.

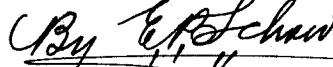
By  E. P. Schaw

 A. Perry

1870

of the

of the

of the

of the

of the

of the

of the

of the

of the

of the

of the

of the

of the

of the

of the

of the

of the

of the

of the

of the

of the

of the

of the

of the

of the

of the

of the

of the

of the

of the

of the

of the

of the

of the

of the

of the

Native of Palestine
Spencer Smith Jones Co

State of Oregon)

County of Union.)^{ss}

I, T. B. Johnson, being first duly sworn, say that I am a ~~regularly~~ duly and regularly qualified Deputy Sheriff of Union County, Oregon. That I served the within notice, within said County and State, on the _____ day of July, 1902, on the within named Sarah L. Peace by delivering a copy thereof prepared and certified to by C. C. Penington, Sheriff of said County, to the said Sarah L. Peace in person.

Dated this 24th day of July, 1902, at Union, Union County, Oregon.

T. B. Johnson

Subscribed and sworn to before me this 24th day of July, 1902.

[Signature]
County Clerk of Union County, Oregon.

By _____ Deputy.

State of Oregon

County of Union-SS:- In the County Court of Union County.

In the application of the Grande Ronde Lumber Co-(a private corporation) to establish a logging-road in Union County.

To Sarah L. Parco

You will please take notice that the Grande Ronde Lumber Company-(a private corporation) has this day filed a petition and map in county court providing the location of a right of way for a logging road or chute through lands now in your possession in Section 22 Township 3 south of Range 36 E.W.M. in said County and said application will come to be heard before said Court at the next regular monthly term thereon for appointment of viewers to locate said road in said county in which said court will be held-in Union, Union County-commencing on Wednesday, August 5th 1902-at which time you are required to appear and file your claim for damages that you may consider you will sustain in case said right of way is located as by said map shown and in said petition prayed;-and further-you do then show cause, if any you have -why said right of way should not be located as by said map shown and projected.

Witness my hand and the seal of the said court of Union County, this July 14 1902-

J. H. Neumaugh Clerk.
W. J. Schow Deputy

Original

Recd July 25th 1902

Recd July 19. 1902

E. E. Livingston Street

By P. B. Johnson, Deputy

State of Oregon)

County of Union.)^{ss}

I, T. B. Johnson, being first duly sworn, say that I am a ~~regularly~~ duly and regularly qualified Deputy Sheriff of Union County, Oregon. That I served the within notice, within said County and State, on the 22" day of July, 1902, on the within named R. F. Young by delivering a copy thereof prepared and certified to by C. C. Penington, Sheriff of said County, to the said R. F. Young in person.
Dated this 24" day of July, 1902, at Union, Union County, Oregon.

T. B. Johnson

Subscribed and sworn to before me this 24" day of July, 1902.

[Signature]
County Clerk of Union County, Oregon.

[Signature] Deputy.

State of Oregon-

County of Union-SS:- In the County Court of Union County.

In the application of the Grande Ronde
Lumber Co--(a private corporation) to
establish a logging road in Union County.

to

B. J. Young

You will please take notice that the Grande
Ronde Lumber Co--(a private corporation) has this day filed a
petition and map in the county Court providing the location of
a right of way for a logging road through lands in your possess
ion in Section 27 Township 3 south of Range 36 E.S. and in
said County--and said application will come on to be heard before
said court at the next regular term thereon for appointment of
viewers to locate said road in said county in which said court
will be held--on Friday, August 8th 1902--said term commencing on
Wednesday, August 6th 1902--at which time you are required to ap-
pear and file your claim for damages that may ^{you} consider you will
sustain in case said right of way is located as by said map
shown and in said petition prayed:-and further--you do then show
cause--if any you have--why said right of way should not be located
as by said map shown and projected.

Witness my hand and the seal of the said Court of Union County
this July 19 1902-

J. K. Minzraugh
Clerk.
By E. L. Schwan
Clerk

Original

Miss Mary Ann 1902

Wm. W. W. W.

Emily W. W.

Recd Jan 19. 1902

C. C. Remington & Smith

By Wm. W. W. on delivery

In the County Court of Union County-State of Oregon.

In the Matter of the Application)
of the Grande Ronde Lumber Co-for)
a Logging Road in Union County, Oregon.)

And now on this the 4th day of September A.D.1902-the same being a regular term of the County Court of Union County, as fixed by law-the above matter came regularly on to be heard upon the report of the viewers heretefore appointed by this Court-and the petition for such logging road-and map, survey, testimony taken and all proceedings herein-and it appearing that all persons interested have been duly and personally served with notice-as well as by publication-and that there are no objections filed against the location of such logging road-but only claims for damages in the location and use of lands thro' which it is sought to be located-and the court being now fully advised in the premises, finds:-

- (1) That the said viewers after being properly qualified-proceeded on a day fixed by them to locate said logging road-and fixed and located the same upon the survey and route proposed in the petition-fixing the same after finding the same necessary and advisable for the purposes petitioned:-
- (2) That we find said proposed logging road, survey and description of route is necessary, feasible and advisable for the removal to market of the timber described in the petition-and should be ordered- It is therefore ordered:-
 - (A) That the report of the viewers be adopted and filed-
 - (B) That the applicant pay to the county clerk-subject to the order of Sarah L. Pearce-(he being the clerk of this court) the sum of sixty dollars the sum assessed and found as damages sustained by said Sarah L. Pearce-claimant for damages for the location of said logging road over her lands being the SE $\frac{1}{4}$ NW $\frac{1}{4}$ -SW $\frac{1}{4}$ NE $\frac{1}{4}$ & W $\frac{1}{4}$ SE $\frac{1}{4}$ Sec.22-Twp 3 South Rge 36 E.W.M.-
 - (C) And it appearing that the said applicant has deposited with the clerk of this court said sum of money as damages-and that further has adjusted with Mary E. Withrow-claimant for damages-no appraisalment was made by said viewers of any damages for her

(D) That the petition of said Grande Ronde Lumber Co-applicant for the location and opening of said logging road over the route and survey as set out and described in said petition, map and survey be approved and granted—and said logging road is hereby granted for a period of six years in which to remove to market the said timber set out in said petition—and ~~responsibility~~ over the lands of said Sarah L. Pearce claimant for damages.)

(E) That said logging road as by said survey and location is hereby allowed, authorized and ordered opened, built and used on said survey, route and road by the said applicant—the Grande Ronde Lumber Co—and said corporation—its agents and servants shall at all times have the use thereof—subject however to the requirements and restrictions of law.

M. A. Harrison

County Judge

Robert Blumentein

Commissioner

Gar. a. Pilcher

Commissioner

State of Oregon)

County of Union.) ss

I, T. B. Johnson, being first duly sworn, say that I am a regularly qualified Deputy Sheriff of Union County, Oregon; that I served the within notice, within said County and State on the 22 day of July, 1902, on the within named Mary E. Whitrow by delivering a copy thereof, duly certified as such, to the said Mary E. Whitrow in person. Union, Oregon, this 24th day of July, 1902.

T. B. Johnson

Subscribed and sworn to before me this 24th day of July, 1902.

J. M. [Signature]
County Clerk of Union Co., Ore.

By _____ Deputy.

1 State of Oregon-

2 County of Union-SS:- In the County Court of Union County.

3 In the application of the Grande Ronde
4 Lumber Co-(a private corporation) to
5 establish a logging-road in Union County.

6 To Mary E Whitlow

7
8 You will please take notice that the Grande
9 Ronde Lumber Co-(a private corporation) has this day filed a
10 petition and map in the county Court providing the location of
11 a right of way for a logging road through lands in your possess
12 ion in section 15 & 27 Township 3 south of Range 36 E.W.M. and in
13 said County-and said application will come on to be heard before
14 said Court at the next regular term thereon for appointment of
15 viewers to locate said road in said county in which said court
16 will be held-on Friday, August 8th 1902-said term commencing on
17 Wednesday, August 6th 1902-at which time you are required to ap-
18 pear and file your claim for damages that may consider you will
19 sustain in case said right of way is located as by said map
20 shown and in said petition prayed:-and further-you do then show
21 cause-if any you have-why said right of way should not be located
22 as by said map shown and projected.

23 Witness my hand and the seal of the said Court of Union County
24 this July 19 1902-

25 J. H. Minnaugh Clerk.
26 J. B. E. Schow
27 Sery

Original

Recd July 25th 1902

J. W. Wainwright
Army Work

Recd July 13th 1902

C. E. Pennington Smith

By J. W. Wainwright

State of Oregon)

)ss

County of Union.) I, T. B. Johnson, being first duly sworn, say

that I am a ~~regularly~~ duly and regularly qualified Deputy Sheriff of Union County, Oregon. That I served the within notice, within

said County and State, on the 22 day of July, 1902, on the with-

in named Mary E. Douglas by delivering a copy

thereof prepared and certified to by C. C. Penington, Sheriff of

said County, to the said Mary E. Douglas in person.

Dated this 24th day of July, 1902, at Union, Union County, Oregon.

T. B. Johnson.

Subscribed and sworn to before me this 24th day of July, 1902.

J. B. [Signature]
County Clerk of Union County, Oregon.

[Redacted] Deputy.

State of Oregon-

County of Union-SS:- In the County Court of Union County.

In the application of the Grande Ronde
Lumber Co-(a private corporation) to
establish a logging-road in Union County.

To

Mary C. Longley

You will please take notice that the Grande
Ronde Lumber Co-(a private corporation) has this day filed a
petition and map in the county Court providing the location of
a right of way for a logging road through lands in your possess
ion in Section 27 Township 3 south of Range 36 E.W., and in
said County-and said application will come on to be heard before
said court at the next regular term thereon for appointment of
viewers to locate said road in said county in which said court
will be held-on Friday, August 8th 1902-said term commencing on
Wednesday, August 6th 1902-at which time you are required to ap-
pear and file your claim for damages that may consider you will
sustain in case said right of way is located as by said map
shown and in said petition prayed:-and further-you do then show
cause-if any you have-why said right of way should not be located
as by said map shown and projected.

Witness my hand and the seal of the said Court of Union County
this July 14 1902-

J. H. Minnigh
Clerk.
C. E. Schenck

Original

Recd July 19-1902

E E Pennington - Newark

By G W Johnson - Newark

July 19-1902

Newark

1 In the Matter of the Application of the
2 Grande Ronde Lumber Co-for a Logging Road
3 in Union County, Oregon-

4
5 To the Hon. County Court, Union County, Oregon:-

6 We-the viewers appointed at the
7 August Term 1902-of your honorable court to view and locate a
8 logging road as applied for by said Grande Ronde Lumber Co-
9 through and across the lands of Sarah L. Pearce in Sec. 22-Twp
10 3 south of Range 36 E.W.M.-and of Mary E. Withrow in said Sec.
11 22 and Sec. 15-in same Twp and Range-as well as other lands-and
12 to fix and determine the damages done such owners and such
13 lands by reason thereof-towit:- To said Sarah L. Pearce and
14 said Mary E. Withrow-they being the only claimants for damages,
15 beg leave to report:-

16 That on the 27 day of August A.D. 1902-the day fixed by
17 us to begin-and after being duly sworn to discharge our duties
18 as viewers faithfully and impartially-we proceeded to view and
19 locate said logging road at the place of commencement designa-
20 ted on the petitioner's map and plat, and located said right of
21 way-following the route and survey proposed therein, and in
22 said applicants map and petition-establishing the width there-
23 of at thirty (30) feet;--that said right of way through the
24 lands of said Sarah L. Pearce enters her lands about 331 feet
25 east of the $\frac{1}{2}$ sec. cor. between Secs-22&27-Tp 3 S. R-36E-runs in
26 a northwesterly about 254 rods-and she claiming damages-as
27 owner of said lands for such right of way for said logging
28 road-we have fixed and determined that the damages which she
29 would suffer by reason of the opening of said road in the amt
30 of \$60--or \$10-per year for a period of six years-which we es-
31 timate it will take to remove said timber of applicants-

32 That the said Mary E. Withrow having adjusted her damages with
said applicant for said logging road-we have not appraised
any for her. Dated at Hilgard, Oregon-this August 28th 1902.

R. R. Collins
C. J. Lewis
Viewers

STATE OF OREGON

TO THE COMMISSIONERS OF THE LAND AND MINING DEPARTMENT OF THE STATE OF OREGON
We the undersigned, owners hereof on the 1st day of August 1902
view outward assess the damages claimed by
road the whole distance through the premises
complaint, and to assess and determine the value of said
road the whole distance through the premises
we find that the premises of said complainant
valued at \$1000.00 and that the premises of complainant
valued at \$1000.00 less valuable
premises of the complainant
less valuable by the
public highway of said county, and recommend that
complaintant

Both County Court
of the State of Oregon
for Union County

Viewers Report
Laying out
returned for by
the Grant Point
Lumber Company

Filed Sept 3, 1902
J. H. Cunningham, Clerk
By E. P. Shaw
Deputy

REPORT OF VIEWERS.

TO THE HONORABLE COUNTY COURT FOR UNION COUNTY, GEORGIA:

We, the undersigned, viewers heretofore of the 5th day, August, 1902,
appointed to view out and assess John A. Smith's claim by John R. Purce

Mary E. Smith in the matter of the proposed county road, petitioned for by
John R. Purce beg leave to report

that on the 27th day of August, 1902, we, after being duly sworn to dis-
charge our duty faithfully and impartially, proceeded to view said proposed
road the whole distance through the premises of John R. Purce and Mary E. Smith

complainant, and to assess and determine how much less valuable said prem-
ises of said complainant would be rendered by the opening of said road, and
we find that the premises of said complainant John R. Purce would be

rendered \$100.00 and that the premises of complainant Mary E. Smith
rendered \$50.00 less valuable, and the
premises of the complainant John R. Purce would be rendered \$100.00

less valuable by the establishment of said proposed road as a
public highway of said county. We recommend that \$150.00 be paid to said
complainant before laying out and establishing said road as a public highway.

R. H. Collins
C. Lewis

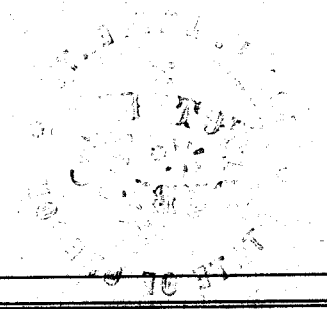

STATE OF OREGON.)
County of Union.) SS.

Filed Aug 28 1902
J. H. Cunningham
Clk.
Ry. E. Schaw

We, R. R. Collins, Arthur Arnold and C. N. Lewis, heretofore appointed by the County Court of said County and State to assess the damages that would accrue to the claimants Sarah L. Pierce and Mary E. Withrow by reason of the location and establishment of a proposed Logging road petitioned for by the Grande Ronde Lumber Co, being first duly sworn, each for himself and not one for the other, say, that we will faithfully and impartially appraise the damages that would accrue to the said claimants by the reason of the location and establishment of said proposed logging road and render our report accordingly.

R. R. Collins
C. N. Lewis

Subscribed and sworn to before me this 27 day of August, A.D. 1902

Fra U Lafferty
Notary Public for Ore

REPORT OF VIEWERS.



TO THE HONORABLE COUNTY COURT FOR UNION COUNTY, OREGON:

We, the undersigned, viewers heretofore on the 8th day of August, 1902, appointed to view out and assess the damages claimed by Sarah L. Pince and Mary E. Withrow in the matter of the proposed Logging road, petitioned for by Grand Lumber Co. et al. beg leave to report that on the.....day of.....190....., we, after being duly sworn to discharge our duty faithfully and impartially, proceeded to view said proposed road the whole distance through the premises of Sarah L. Pince and Mary E. Withrow complainant, and to assess and determine how much less valuable said premises of said complainant would be rendered by the opening of said road, and we find that the premises of said complainant Sarah L. Pince would be rendered \$..... less valuable, and that the premises of complainant Mary E. Withrow would be rendered \$..... less valuable, and the premises of the complainant..... would be rendered \$..... less valuable by the laying out and establishment of said proposed road as a public highway of said county, and recommend that..... be paid to said complainant....before laying out and establishing said road as a public highway.

STATE OF OREGON.)
County of Union.) SS.

Handwritten notes:
Arthur Arnold
Notary Public
for Oregon

~~Me, R. R. Collins,~~ Arthur Arnold ~~and~~

~~S. N. Lewis,~~ heretofore appointed by the County Court of said County and State to assess the damages that would accrue to the claimants Sarah L. Pierce and Mary E. Withrow by reason of the location and establishment of a proposed Logging road petitioned for by the Grande Ronde Lumber Co, being first duly sworn, each for himself and not one for the other, say, that I will faithfully and impartially ^{perform the duties of} appraise the damages that would accrue to the said claimants by the reason of the location and establishment of said proposed logging road and render our report accordingly.

Handwritten signature: A. W. Arnold

Subscribed and sworn to before me this 13 day of August, A.D. 1902

by said
Arthur Arnold

Arthur Arnold
Notary Public
for Oregon

In County Court-County of Union-and State of Oregon.

In the matter of the petition and application of the Grande Ronde Lumber Co-a private corporation for a logging road to be located through parts of Sections 15-22 and 27-in Twp 3 south of Range 36-E.W.M.and in Union County, Oregon.

UNDERTAKING.

KNOW ALL MEN BY THESE PRESENCE-The we-the Grande Ronde Lumber Company-as principal-and J.M.Berry-and *F.L. Meyers* as sureties all of Union County, Oregon-are held and firmly bound unto UNION COUNTY, OREGON-in the penal sum of two hundred and fifty dollars lawful money of the United States-sealed with our seals and dated this the 8th day of July A.D.1902-

The condition of the foregoing obligation is such-That where-as-The Grande Ronde Lumber Co-has filed with the clerk of the County Court-of Union County, Oregon-its petition and application and map of survey for a logging road through parts of Sections 15-22 and 27-Tp 3 south Range 36 E.W.M. in said Union County, Oregon-praying for the location and establishment of the same -and in consideration of the premises the said sureties herein undertake and agree to pay all costs and expenses that may be incurred by reason of the filing of such petition-and all costs of viewing and surveying such road ~~whether~~-the same is located or not.

The Grande Ronde Lumber Co
Principal seal

J.M. Berry seal

F.L. Meyers seal

State of Oregon

County of Union-SS:-We--J.M.Berry--and *F.L. Meyers* being first duly sworn say:- That I am a resident householder within Union County, Oregon-and that I am worth the sum of five hundred dollars over and above all my just debts and property exempt from execution, and that I am surety on the foregoing bond.

F.L. Meyers
J.M. Berry

Subscribed and sworn to before me July 8th A.D.1902-

C.H. Quinn Notary Public for Oregon

De County Court
Harris Co, Oregon

In matter of
application and
petition of
Francis W. Ross
Kendall Co. for
logging road

Approved and

Filed July 8, 1902

J. K. Cunningham
Clerk

By E. J. Johnson
Atty

IN THE COUNTY COURT OF UNION COUNTY STATE OF
OREGON.

.....
In the matter of the application ;
of the Grande Ronde Lumber Co. ;
for the location of a logging- ;
road. ;
.....

Now at this time comes Mary E. Withrow, and shows to the Court, that she is the owner, in fee, and in possession, of the following described lands in Union county, State of Oregon, through which the proposed logging road, asked to be established by the Grande Ronde Lumber Co. runs, to-wit:- The South half of the South half of Section 16, the Southwest quarter of Section 15, the East half of the Northeast quarter of Section 21, and the West half of the Northwest quarter of Section 22, all in Township 3, South of Range 36, East of Willamette Meridian.

That the location of the said logging road as platted and asked for by the petitioner, The Grande Ronde Lumber Company, will damage and injure the said premises of the said Mary E. Withrow, to the extent of the sum of \$600.00, and that by the location of the said road the said premises will be rendered less valuable in the sum of \$600.00;

Wherefore the said Mary E. Withrow, claims and asks damages for the location of the said County road to the extent, and in the amount of the sum of \$600.00 against the County of Union, and the said Grande Ronde Lumber Company.

Mary E. Withrow

STATE OF OREGON,)
) ss.
County of Union.)

I, Mary E. Withrow, being duly sworn,
say I am the person making the foregoing claim for damages, and
the statements hereinbefore made are true as I verily believe.

Mary E. Withrow

SUBSCRIBED and sworn to before me this 4th. day of August,
A. D. 1902.

J. A. Scott
Notary Public for Oregon.

STATE OF OREGON, }
COUNTY OF UNION, } ss.

I, being first duly sworn,
depose and say that I am the
in the above entitled; and that the foregoing
is true as I verily believe.

Subscribed and sworn to before me this the day of 190.....

Notary Public for Oregon.



I, do hereby certify that I am
..... attorney herein; that the foregoing copy of
..... has been by me carefully compared with the original
thereof; that it is a correct transcript therefrom and of the whole of such original.

La Grande, Oregon, dated the day of 190.....

Attorney for



Due service of the within is hereby accepted in
..... County, Oregon, this day of 190.....
by receiving a copy thereof, duly certified to as such by,
attorney for

Attorney for

No.

IN THE County COURT
OF THE
STATE OF OREGON,
FOR
UNION COUNTY.

And the Wells
the of the
for the of
vs.
by the Board
of the County
Clerk.

Claim for damages
by Wells & Watson

Filed Sept 17th
1907
J. D. Slater
County Clerk.

By _____
Deputy.

J. D. SLATER,
Attorney for Plaintiff

State of Oregon)

County of Union.)^{ss}

I, T. B. Johnson, being first duly sworn, say that I am a regularly duly and regularly qualified Deputy Sheriff of Union County, Oregon. That I served the within notice, within said County and State, on the 22 day of July, 1902, on the within named W. H. Langley by delivering a copy thereof prepared and certified to by C. C. Penington, Sheriff of said County, to the said W. H. Langley in person.

Dated this 24th day of July, 1902, at Union, Union County, Oregon.

T. B. Johnson

Subscribed and sworn to before me this 24th day of July, 1902.

J. M. [Signature]
County Clerk of Union County, Oregon.

By _____ Deputy.

State of Oregon

County of Union-SS:- In the County Court of Union County.

In the application of the Grande Ronde
Lumber Co--(a private corporation) to
establish a logging-road in Union County.

To W. H. Longley

You will please take notice that the Grande Ronde Lumber
Company--(a private corporation) has this day filed a petition
and map in county court providing the location of a right of way
for a logging road or chute through lands now in your possession
in Section 10 Township 5 south of Range 36 E.W.M. in said County
and said application will come to be heard before said Court at
the next regular monthly term thereof for appointment of viewers
to locate said road in said county in which said court will be
held--in Union, Union County--commencing on Wednesday, August 6th
1902--at which time you are required to appear and file your
claim for damages that you may consider you will sustain in case
said right of way is located as by said map shown and in said
petition prayed;-and further-you do then show cause, if any you
have -why said right of way should not be located as by said
map shown and projected.

Witness my hand and the seal of the said court of Union County,
this July 14th 1902-

J. H. Minnick Clerk.
By E. P. Shaw Deputy

Original

Recd July 20th 1902

W. W. W. W. W.
copy over

Recd July 18th 1902

C. E. Pennington Smith
By W. W. W. W. W.

In the County Court of the County of Union-State of Oregon-

In the Matter of the Application

of the Grande Ronde Lumber Co-to

establish a logging-road in Union County.

Comes now the petitioner and presents this its proof of
publication of notice of its application for the location
of a right of way for such logging road:-

NOTICE FOR PUBLICATION.

In the County Court of Union County--State of Oregon.

In the matter of the application of the Grande Ronde Lumber Co. to establish a logging-road in Union county.

To all whom it may concern:- You are hereby notified that the Grande Ronde Lumber Co., a private corporation of Perry, Oregon, has filed its petition and map in the County Court providing for the location of a right-of-way for a logging road as follows. Beginning at a point, or the quarter corner or post, on the section line between Sections 27 and 34, in Twp. 3 South Range 36 E. W. M., thence north 80 rods and East 700 feet, as the commencement of said proposed road, thence running Northerly through the W $\frac{1}{4}$, NE $\frac{1}{4}$, and NW $\frac{1}{4}$ SE $\frac{1}{4}$ Sec. 27, and the W $\frac{1}{4}$ SE $\frac{1}{4}$, the SW $\frac{1}{4}$ NE $\frac{1}{4}$, the SE $\frac{1}{4}$ NW $\frac{1}{4}$, the NE $\frac{1}{4}$ NW $\frac{1}{4}$ Sec. 22 and the E $\frac{1}{4}$ and NW $\frac{1}{4}$ SW $\frac{1}{4}$ Sec. 15 all in Township 3 South Range 36 E. W. M., and terminating on the South bank of the Grande Ronde river, at a point in the SE $\frac{1}{4}$ E $\frac{1}{4}$ Sec. 15, Tp. 3 South Range 36 E. W. M., and that the same will come up for hearing and the appointment of viewers on Friday, August 8th, 1902, at 11 o'clock A. M. of said day, and that any and all persons having or claiming any interests in said lands through which said road is proposed to be located, are to appear at that time and file their complaint for damages or show cause why said logging road should not be located as asked by the petitioners, the Grande Ronde Lumber Co. Dated at Union, Union County, Oregon, July 8th, 1902.

Witness my hand and official seal of the County Court of Union County, Oregon.

J. H. MI~~NA~~UGH,
County Clerk and Clerk of
the County Court, Union
County, Oregon.

SEAL

By E. P. SCHOW,
Deputy.

State of Oregon-

County of Union--I--E.L. Eckley being first duly sworn say:-That I am the foreman and printer of the LaGrande Chronicle-a daily newspaper of general circulation-and published at LaGrande, Union County, Oregon-that the annexed and hereto attached notice was published in all the issues of said paper for and during the past three weeks, and generally circulated.

E. L. Eckley

Subscribed and sworn to before me this the 8th day of August A.D. 1902.

C. H. Quinn
Notary Public for Oregon.

Wherefore the petitioner prays that that such proof be considered sufficient to meet the requirement of the law.

The Grande Ronde Lumber Co-by
C. H. Quinn its Attorney.

De County Court
August 8, 1902

In the matter
of application
of Edward Bond
Kumler &
for logging road

Good & Reason
thereof of Justice

Filed Aug 8, 1902

J. H. Munnis
County Clerk

Fifth Judicial Day

Tuesday July 8, 1902

ordered to open up said road according to law and to place the same in repair for travel.

In the matter of the application of the Grand Pouse Lumber Co. to establish a logging road in Tp 3 N 36 E 20

This matter came on to be heard on the petition of the Grand Pouse Lumber Co. praying for the location of a logging road in Tp 3 N 36 E 20, and it appearing to the Court that said petition is in all things regular and in accordance with law, in the matter of establishing a logging road, it is therefore considered and ordered by the Court that August 8th, 1902, be set for hearing of said petition and for any and all objections or remonstrances thereto.

In the matter of the application of J. W. Masterson, N. M. Lord and R. C. Mays to have Lacking et al's Creek between certain points declared navigable for floating logs, etc

At this time it is ordered by the Court that this matter be and the same is hereby continued for the term,

In the matter, yearly report of the County Treasurer.

Now at this time comes John Frawley, County Treasurer, and presents to the Court his annual report for the year ending June 30, 1902, which is in words and figures as follows, to wit:

Treasurer report for year ending, June 30, 1902.

Cities and School District Funds.

Amount on hand from last report	664.65
Received from Sheriff from taxes	41548.34
" " Dist Clks to pay bond interest	782.75
" " County Clk from Tax liens	245.94
Total on hand and received during year	43241.68
Paid out on special tax receipts & bond interest	41695.24
Balance on hand July 1, 1902.	1546.44

↳ onward, page 100

Third Judicial Day

Friday, August 8, 1902.

Court met pursuant to adjournment

Present same officers as on yesterday.

The proclamation of the opening of Court having been made the journal of yesterday's proceedings was read, approved and is here now signed

M. A. Harrison County Judge
Robert Blumenthal Commissioner
Jos. A. Pilcher Commissioner

Thereupon the following proceedings were had, to wit:

In the matter of the application of
the Grand River Lumber Co. for
right of way for logging road in
Township 3 S. R. 36 E. 110

And now, at this time, (August 8, 1902) this matter came on for hearing upon the application of the said Grand River Lumber Co. for such right of way and establishment of a logging road, as prayed for in the petition, and upon all allegations of persons interested, and the Court being fully advised by the papers, record and by testimony offered, finds and determines;

- 1st That said proposed ^{logging} road, survey and description of route is feasible,
2. That it is necessary for applicant to have such right of way over the said lands of the persons so named in the petition and map so filed herein
- 3 That it is advisable that viewers be appointed and said proposed location of said right of way and said logging road is advisable
- 4 That all the proceedings had, petition, map, notices, services of said notices, published notice, bonds, etc. are regular, and sufficient.

It is therefore ordered that R. P. Collins, C. M. Lewis and Arthur Donald be appointed as viewers to proceed as provided by law, to view and locate said proposed logging road and to assess all damages the respective parties shall sustain by reason thereof or the location of said right of way over the lands of any and all persons interested. To meet at Helgard, Aug 25, 1902 at 9 o'clock a. m. and file report by Sept 3, 1902.

In the matter of the appointment
of Supervisor of Road District #20

At this time is presented to the Court the petitions of C. D. Huffman and Frank H. Tatman for appointment as Supervisor

First Judicial Day.

Wednesday, Sept 3, 1902

In the matter of the application
of certain citizens to purchase a
rock crusher.

At this time it is ordered by the Court that
this matter be and the same is hereby continued for the term.

In the matter of the application
of the Grand Round Lumber Co
for a logging road in Union Co.
Oregon

And now on this 24th day of September A.D. 1902, the
same being a regular term of the County Court of Union County, as fixed by law,
the above came regularly on to be heard upon the report of the viewers here-
before appointed by this Court, and the petition for such ^{logging} road, and map,
survey, testimony taken and all proceedings herein, and it appearing that
all persons interested have been duly and personally served with notice - as
well, as well as by publication, and that there are no objections filed against
the location of such logging road, but only claims for damages in the location
and use of lands that which it is sought to be located, and the Court being
now fully advised in the premises, finds:

- 17 That the said viewers after being properly qualified, proceeded
on a day fixed by them to locate said logging road, and fixed and located
the same upon the survey and route prepared in the petition, fixing the
same after finding the same necessary and advisable for the purposes men-
tioned.
- 18 That we find said proposed logging road, survey, and descrip-
tion of route is necessary, feasible and advisable for the removal to market
of the timber described in the petition, and should be ordered. It is therefore ordered
- 19 That the report of the viewers be adopted & filed.
- 20 That the applicant pay to the County Clerk, subject to the order of
Sarah L. Pearce (he being the Clerk of this Court) the sum of fifty dollars
the sum assessed and found as damages sustained by Sarah L.
Pearce, claimant, for damages for the location of said logging road over
her lands being the Sec 22 & 23 & 24 & 25 Sec 27, T 32 R 36 E 20
- 21 And it appearing that the said applicant has deposited with the
Clerk of this Court said sum of money as damages, and that further
has adjusted with Mary Edithrow, claimant, for damages, no assessments were
made by said viewers of any damages for her
- 22 That the petition of said Grand Round Lumber Co.
applicant, for the location and opening of said logging
road over the route and the survey as set out and described

First Judicial Day

Wednesday, Sept 3, 1902

in said petition, map and survey be approved and granted, and said logging road is hereby granted for a period of six years in which to remove to market the said timber set out in said petition and over the lands of Sarah L. Pearce, claimant, for damages.

That said logging road as by said survey and location is hereby allowed, authorized and ordered opened, built and used on said survey, route and road by the said applicants, The Grand Pond Lumber Co, and said corporation, its agents and servants shall at all times have the use thereof, subject however to the requirements and restrictions of law.

In the matter of the application of }
S. N. Smith for appointment as }
Supervisor of Road District No 9 }

It appearing to the Court that a vacancy exists in the office of Supervisor of Road District No 9, and it further appearing to the Court that S. N. Smith has filed a petition containing the names of great many of the tax payers residing within said Road District asking that the Court appoint said petitioner Supervisor of said Road District, And it appearing to the Court that said S. N. Smith is a fit and proper person for said appointment, It is therefore considered and ordered that S. N. Smith be and he is hereby appointed Supervisor of Road District No 9, upon his filing a good and sufficient bond in the sum of \$500.00.

In the matter of the vacation }
of certain streets in }
Add to Lalpant, Oregon }

At this time it is ordered by the Court that this matter be and the same is hereby continued for the term.

In the matter of the approval of }
bonds of Supervisors of Road Districts }
Nos 6, 28, 29, 26-20 and 3 }

At this time is presented to the Court the bonds of Sam Parker, Frank Kempf, John Shaw, L. J. Quicks, Frank McFatman, S. M. Galt Supervisors of Road Districts Nos 6, 28, 29, 26-20 and 3 respectively for approval. And it appearing to the Court that said bonds are in the sum of \$500.00 respectively and the sureties having justified in the required amount, It is therefore considered and ordered that said bonds be approved and placed on file in the office of the Clerk of this Court.