

No 252

in

Circuit

Court

L. Baer

Plaintiff

vs

Clara Baer

Defendant

Action for Money

Docket A Page 440

M. Baker and
D. W. Lichtenhaler

Attorney for Plaintiff

Attorney for Defendant

REV. J. H. GREEN, BOSTON, MASS.
MAY 1 1894
RECEIVED
LIBRARY

1892
 Sept 16 Petition No 9 (Moussis applied)
 Journal B p 760
 Nov 8 1st reading Report
 Journal B p 783
 Nov 9 Appn said applied
 Journal B p 784
 Dec 8 Report of Appn see 1 to
 Journal B p 791
 1893
 Jan 4 Ordered proceed
 Journal C p 11
 1894
 June 19 Order to sup 1st & 2d
 Journal C p 260

Road

Commencing at Lostine to Little Sheep
Creek

DIRECTIONS—Place papers on TOP OF RUBBER
 Fold ends first then sides Throw the rubber cords
 over the ends and package is complete

Petition.

To the
Honorable County Court of Union
County Oregon. The undersigned
twelve resident householders
and legal voters residing along
the line and in the immediate
vicinity of the hereinafter proposed
County road and others would
most respectfully yet earnestly
pray your honorable body to locate
lay out and grant a County Road
as nearly as practicable on the following
described route, to wit to commence
at the town of Lathrop in Union
County State of Oregon and running
thence to James Gochrans house in
the Long Bottom (old) Press Valley
residence in a southeasterly direction
a distance of about 4 miles thence
following along and up the Lake
fork of the Wallawa River to a point
near the mouth of Trout Creek in a
southeasterly direction a distance of
about three miles. Thence on the
most direct and practicable route to the
town of Alder in a southerly direction
a distance of about two miles
thence in an easterly direction on the

South lines of Secs 10 11 12 in
 Town 2 South Range 4th east of Hall
 about 2 1/4 miles thence East to a
 point near the residence of
 James Pratt a distance of
 about six miles thence in an
 easterly direction on the most prac-
 ticable road to the residence of
 Josh Hayden on Little Sheep
 Creek the terminus of said proposed
 County Road a distance of about six
 miles. All of said points and places
 are in Union County Oregon.

| Names | Names |
|----------------|--------------|
| A. P. Busleigh | James Pratt |
| Peter Bullman | Vergil Pratt |
| W. P. Garrison | Rollin Pratt |
| J. K. Gardner | J. W. Davis |
| E. Adams | Old Miller |
| W. H. Akin | David Foch |
| Chaney Akin | Jenna Koch |
| T. H. Absey | H. Beecher |
| Charles Holmes | Wm. Atkinson |
| C. D. Akin | D. B. Reavis |
| H. B. Howard | A. C. Terry |
| A. G. Smith | J. A. Hunter |
| J. H. Cochran | Sam. Wale |
| G. Cochran | |
| Henry Miller | |
| Wm. Brown | |
| J. A. Reavis | |
| G. S. Reavis | |
| B. W. Davis | |
| Benjamin Ross | |
| Adam George | |

2. 5

Recd Sept 2 1852

W. P. Burghill
Co. Clerk

Peterson

Notice

To whom it may concern Notice is hereby given that application will be made by the under signed to the Honorable County Court of Union County Oregon at its next regular term to be holden in the Town of Union State of Oregon on the 24th day of September 1882 praying said Court to locate lay out and grant a County Road as nearly as practicable on the following described route to wit commencing at the Town of Sustine above named County and State and running there in a southeasterly direction via Prop. Hall's residence to the residence of James Cochran in the long bottom on the Lake fork of the Malheur river a distance of about 4 miles thence crossing said Lake fork to and a long and up said Lake fork to a point near the mouth of Trout Creek a distance of about 3 miles thence descending the said Lake fork and running in a southerly direction on the most practicable route to the Town of Alder a distance of about 2 miles thence in an easterly direction along the South line of Secs 10-11-12 Town 2 South Range 4 of east a distance of about 2 1/4 thence in an easterly direction to the residence of Pratt

a distance of about 6 miles and thence in an easterly direction to the residence of Joshua Hayden on Little Sheep Creek the terminus of said proposed County Road a distance of about 6 miles all of which points and places are situated in Union County State of Oregon

| Name | Name |
|------------------|------------------|
| A. B. Burleigh | Wm. Reaves |
| Peter O'Sullivan | D. B. Reavis |
| W. P. Cannon | G. D. Reavis |
| J. K. Lanier | J. H. Reavis |
| E. Holmes | B. W. Davis |
| A. H. Kin | Benjamin Boswell |
| Chance Akin | James Pratt |
| J. N. Reese | George Pratt |
| Charles Holman | Rollin Pratt |
| O. D. Akin | G. W. Davis |
| H. K. Kellard | Adam George |
| A. G. Smith | De Miller |
| J. H. Cochran | David Korch |
| B. Cochran | James Korch |
| Henry Miller | |

Inter -

1882

Filed Sept. 4. 1882

Wm. F. Wright Clerk

J. A. Smith of the Town of Alder
Division County Oregon being first duly sworn
deposes and says that I posted up and
caused to be posted up this the enclosed
notice on the fourth day of Aug. 1882 at
Town of Alder on the Post office door
and another on an exact and true copy of
the enclosed notice at The Prairie Creek School
house on the line of the said proposed road
mentioned in the petition referred to and also
the same on the Post office door at
the Town of Soatine all of which were
posted up as above described on the third
and fourth day of August 1882 and
the said points and places above
mentioned are situated in Division
County State of Oregon

J. A. Smith

Sworn and subscribed
to before me this 30th day
of August 1882.

Jas A Hunter
Justice of the Peace

Book of Postings

Given Sept. 4. 1852
W. S. Wright
C. DeWitt

Notice

To Whom it may concern Notice is hereby given that application will be made by the undersigned to the Honorable County Court of Union County Oregon at its next regular term to be holden in the town of Union State of Oregon on the 4th day of September 1882 praying said Court to locate layout and grant a County Road as nearly as practicable on the following described route to wit: Commencing at Section above named County and State and running thence in a south easterly direction via Press Halley's residence to the residence of James Cochran on the Long Bottom on the Lake Fork of the Hullaawa River a distance of about four miles thence crossing said Lake fork and along and up said Lake fork to a point near the mouth of Trout Creek a distance of about three miles thence recrossing the said Lake fork and running in a southerly direction on the most practicable route to the

town of Alder a distance of about two miles thence in an easterly direction along the south lines of Secs 10 11 12 of town 2 S R 44 E a distance of about 2 1/4 miles thence east to a point near the residence of Pratt a distance of about six miles and thence in an easterly direction on the most practicable route to the residence of Wash Hayden on Little Sheep Creek the terminus of said proposed County road a distance of about six miles

All of which points and places are in Union County Oregon

- | | |
|--|---|
| <p>H. F. Burleigh Peter William W. P. Sammons J. E. Lambert E. Holmes A. H. Skir Orance Skir T. H. Beasey Charles Holmes A. C. Smith G. D. Skir W. K. Stillard J. H. Cochran S. Cochran</p> | <p>Wm. Reavis J. S. Reavis J. A. Reavis D. B. Reavis</p> |
|--|---|

Posted on Crank house door
 Aug 2 1882

State of Oregon }
County of Union } S.S.

I R J Rogers Sheriff of Union
County Oregon hereby Certify that
I posted the within notice on
the Court House door on Aug
2^d 1882

Dated Sept 4th 1882

R J Rogers Sheriff
of Union County Oregon

Filed Sept 6 1882
Wm Wampler
Co Clerk

Proof of Posting

town of Alder a distance of about
two miles thence in an easterly
direction along the South lines of
Sects 10 11 12 town 2 S R 44 E
a distance of about 2 1/4 miles
thence East to a point near the residence
of Pratt a distance of about
Six miles and thence in an easterly
direction on the most practicable route
to the residence of Noah Hayden
on Little Sheep Creek the terminus
of said proposed County road a
distance of about 6 miles All of
which points and places are in
Union County State of Oregon

Know all Men by these Presents:

THAT WE, A. C. Smith

and Sam Wale, of the County of Marion and Marion

State of Oregon, are held and firmly bound unto the said County of Marion in the sum of

\$ 200 Dollars, the payment of which, well and truly

to be made, we bind ourselves, our heirs, executors and administrators firmly by these presents.

Signed this 30th day of August A. D. 1882

Now the condition of the above obligation is such, that whereas, if the County Road petitioned for by A. F. Ballagh Peter O'Sullivan and others, and presented at the Regular Sept term, 1882, of the County Court of said Marion county, commencing

At the town of Sastine and running thence to the town of Alda and thence to Jacob Hayden's farm on little sheep creek the thence and more particularly described in the petition herewith enclosed being situated in Marion County, Oregon

be located and established, then this obligation to be void; otherwise to remain in full force and virtue in law.

A. C. Smith

Sam Wale

STATE OF OREGON,
COUNTY OF MARION, } ss.

I, A. C. Smith and

Sam Wale each for himself says that I am worth the sum

of 200 Hundred Dollars over and above all debts and liabilities and property

exempt from execution, and that I am a resident and householder in said County and State.

A. C. Smith

Sam Wale

Subscribed and sworn to before me, this 30th

day of August A. D. 1882

Jas A Hunter
Justice of the peace Marion

Know all Men by these Presents

of the County of ...
...
...
...
...

Underwriting

Signed

Sept. 4. 1882

W. N. Wang
Clerk

STATE OF MARYLAND

COUNTY OF ...

...
...
...
...

...
...

...

Be it remembered, that at a term of the Hon. County Court of Union County, State of Oregon, begun and held at the Court House in Union, in said County, on the 8th day of November A. D. 1882 and from day to day thereafter during the continuance of said term -

Present the Hon. A. L. Craig County Judge

Hon. Joel B. Dolby Commissioner

W. F. Knight Clerk

R. J. Rogers Sheriff -

The following among other proceedings were had, to wit; -

In the matter of the petition
for a County Road of H. F. ^{Burleigh}
Burleigh and others

Now at this time is presented and read for a second time the viewers report on a proposed county road - petitioned for by H. F. Burleigh and others - which report is favorable - and there being presented at the same time the petition of R. W. Bloom through whose lands the said proposed road is viewed and marked out, complaining thereof and claiming damages - It is therefore ordered by the Court, that said report shall lay over till the next regular term of this Court, - and it is further ordered, that Jacob Sturgill

E. H. Tully and J. Le Stanley - three disinterested householders of this County be and they are hereby appointed to view said proposed road the whole distance through the premises of complainant, and assess and determine how much less valuable such premises of the complainant would be rendered by the opening of said road, and they shall meet at the house of Jacob Sturgill on Monday Nov. 20th. 1882 - and be duly sworn before entering upon the discharge of their duties herein, and of their doings herein this matter make return to this Court in writing at the next regular term thereof.

Signed A. C. Leasing

County Judge

State of Oregon,
County of Union 3^d S.

I W. D. Wright clerk of the County Court - hereby certify that I have compared the foregoing with the original order of the Court as it appears of Record in Vol. B. Commissioners Court Journal - at Page 784 Records of Union County Oregon and that it is a true copy thereof.

Witness my hand and the seal of said Court affixed this 9th day of Nov. A. D. 1882 -

W. D. Wright

County Clerk

State of Oregon
County of Union 3 s.s.

We - Jacob. Sturgill - E. H. Tully
and J. L. Stanley - being first duly sworn
say that we will truly and faithfully
perform the duties of appraisers in
the matter of assessing and determin-
ing how much less valuable the
premises of R. H. Bloom will be rendered
by the opening of the proposed County
Road now viewed and marked
out through said premises -

Subscribed and sworn to before

me this 24th day of Nov. 1882

W. P. Sammons

Justice of the Peace

Jacob P. Sturgill
E. H. Tully
John L. Stanley

all have signed here

make known to this appraisers appointed
by the County Court of Union County
State of ^{Oregon} in the case R. H. Bloom
claiming damages on a certain Road
running through his premises find
proper investigation found that his
premises is of less value to the amount
of Two hundred dollars

Nov 24/82 Jacob P. Sturgill

E. H. Tully

John L. Stanley

In County Court
for Miami County
Oregon -

Appraisal & Report
of Appraiser of
Damage
in the matter of
County Road purchases
per by
J. S. Burleigh & others

Filed Dec. 8. 1882
W. S. Burleigh
vs. State

11
12
13
14
15
16
17
18
19
20
21
22
23
24
25
26
27
28
29
30
31
32
33
34
35
36
37
38
39
40
41
42
43
44
45
46
47
48
49
50
51
52
53
54
55
56
57
58
59
60
61
62
63
64
65
66
67
68
69
70
71
72
73
74
75
76
77
78
79
80
81
82
83
84
85
86
87
88
89
90
91
92
93
94
95
96
97
98
99
100

Alder - Oregon Nov-4th 1883
To the Hon County Court)
of Union County Oregon.)

The undersigned would respectfully state your Honors - That a County road has recently been surveyed commencing at Lostine, Wallowa valley and running by the way of "Front Creek" Alder and to Sheep Creek. (The correct callings I am unable to give at this time). Said road runs through my land. which if established as a County road will in addition to other damages ~~will~~ cause me to have to build one half mile of fences. which fences will not only be useless to me but will be an actual injury, cutting my pasture into incumberment parcels. And I take this method of notifying your Hon body. That I shall claim damages. (Should the road be located) in the sum of (\$200.) two hundred dollars. and will at your next term present my claim in due form. Very Respectably Yours &c. R. W. Bloom

Providence County, Mass
Put name a few by
No. 7. Burlington St. at,

Dam for damages

R. H. Bloom

Dated Nov. 9. 1882

W. S. Wright
Agent

Allen Union O Or

OCT 27th 1882

To The Honorable County
Board

Gentlemen I would
respectfully ask you to allow
me a bill of damages to the
amount of four hundred dollars
damages as follows to it - The
Newly laid out road will cause
me to make two miles of fence,
that I would not have to build if
the road did not run thru my
place, - 2nd it runs thru 9th
of my plow ground, 3rd it runs
thru the best timber I have on
my place and 4th it runs thru
my turkey meadow, said road
commences south of Allen, then
east running on the line between

Sections 11 and 12 Township 2
South of Range 44th Thence
east to James Pratts

I will further say if you will make
a jog at the south west corner
of Sect 12 one $\frac{1}{4}$ of a mile north
thence east one mile thence
south $\frac{1}{4}$ mile to the bottom line
I will give one half of the road
around my place free of charge
I would much rather you would
accept my proposition than
to have the \$400 damages
Most Respectfully
J. A. Riley

Proposed County Road
petitioned for by
R. C. Wright & others

Claim of Damages
J. A. Riley

Filed Nov. 8. 1882
W. F. Wright
Clerk

To the Hon County Court of Union
County, Oregon

We the undersigned viewers appointed
by your Honorable Body to view
out a proposed County Road from
Lostine to Irish Haydens on
Little Sheep Creek by way of
Front Creek and Alder submit
the following report in relation
there-to. We met by appointment
on the 25th day of October A.D.
1882 the three viewers being
present and after being first
duly sworn in company with
the Surveyor, proceeded to view,
survey and lay-out said road
as directed in your order and as
shown by the Surveyors plat and
report submitted herewith. We

Surveyed from

day to day completing said survey Oct 31 1882

We find the road to be located
on as good ground as the
section of country over which
the road is laid will admit
of and taking into consideration
the necessity that exists for the
road we recommend that
said route be established
as a County Road

S. K. Francis
C. W. Womack
John M. Richardson

} Viewers of proposed
County Road

County Poor Petitioner

By H. P. Burleigh and
Others -

versus Report

Filed Nov. 8. 1882

H. P. Burleigh
Clerk

Report of Survey to the runners of a proposed County from the town of Lostine to Torch Hayden on Little Sheep Creek by way of Trout Creek and Alder 1st following in the field notes - Beginning at the NW cor of the NE⁴ Sec 15 T South Range 44 East at post marked R thence East 140 rods to post marked A I thence S 45 E 114 rods to post marked A II thence N 78 E 200 rods to post marked A III thence S 40 E 166 rods to post marked A IV thence S 55 E 82 rods to post marked A V thence S 10 E 261 rods to post marked A VI thence S 21 E 480 rods to post marked A VII thence S 70 E 68 rods to post marked A VIII thence S 80 E 105 rods to post marked A IX thence N 66 E 60 rods to post marked A X thence N 76 E 32 rods to post marked A XI thence S 9 E 20 rods to post marked A XII thence S 50 E 26 rods to post marked A XIII thence S 68 E 45 rods to post marked A XIV thence N 70 E 54 rods to post marked A XV thence N 35 E 14 rods to post marked A XVI thence S 72 E 82 rods to post marked A XVII thence N 57 E 52 rods to post marked A XVIII thence S 60 E 82 rods to post marked A XIX thence S 75 E 148 rods to post marked A XX thence S 70 E 40 rods to post marked A XXI thence S 55 E 98 rods to post marked A XXII thence S 23 E 80 rods to post marked A XXIII thence S 38 E 54 rods to post marked A XXIV thence S 65 E 52 rods to post marked A XXV thence S 55 E 76 rods to post marked A XXVI thence S 75 E 32 rods to post marked A XXVII thence S 58 E 70 rods to post marked A XXVIII thence S 43 E 136 rods to post marked A XXIX thence S 33 W 24 rods to post marked A XXX thence S 36 E 24 rods to post marked A XXXI thence South 108 rods to post marked A XXXII thence S 18 E 168 rods to post marked A XXXIII thence S 51 E 60 rods to post marked A XXXIV thence South 210 rods to post marked A XXXV thence East 17 rods to post marked A XXXVI thence South 78 rods to post marked A XXXVII thence East 1046 rods to post marked A XXXVIII thence S 58 E 46 rods to post marked A XXXIX

| | | |
|---|------------|----------|
| " | N 10 E 58 | A XL |
| | East 22 | A XLI |
| | S 37 E 18 | A XLII |
| | S 80 E 46 | A XLIII |
| | East 160 | A XLIV |
| | S 45 E 460 | A XLV |
| | South 160 | A XLVI |
| | East 780 | A XLVII |
| | S 74 E 166 | A XLVIII |
| | S 80 E 98 | A XLIX |
| | N 30 E 154 | AL |
| | N 58 E 312 | ALI |
| | East 36 | ALII |
| | N 75 E 50 | ALIII |
| | N 33 E 78 | ALIV |
| | N 70 E 70 | ALV |
| | N 65 E 100 | ALVI |
| | East 232 | ALVII |
| | N 57 E 60 | ALVIII |
| | N 10 E 118 | ALIX |
| | N 52 E 82 | ALX |
| | N 35 E 44 | ALXI |
| | N 85 E 36 | ALXII |
| | N 40 E 108 | ALXIII |
| | N 55 E 480 | RT end |

terminating at Torch Hayden on Little Sheep Creek
 State of Oregon } ss
 County of Union }
 I, Eugene LeRose, here by Surveyor in and for the County and State
 above and do hereby certify that the field notes of the survey of the above
 land are correct as reviewed by me under the supervision of
 the runners for Oct 25th to Oct 31st 1882 Eugene LeRose, Surveyor

County Road maintenance

by W. J. Rindberg
and others

January 22, 1882

Filed Jan 8 1882
W. J. Rindberg
Clerk

Survey of County Roads from Lostine
to Post Hayden on Little Sheep Creek

Surveyed from Oct 25th to Oct 31st 1882

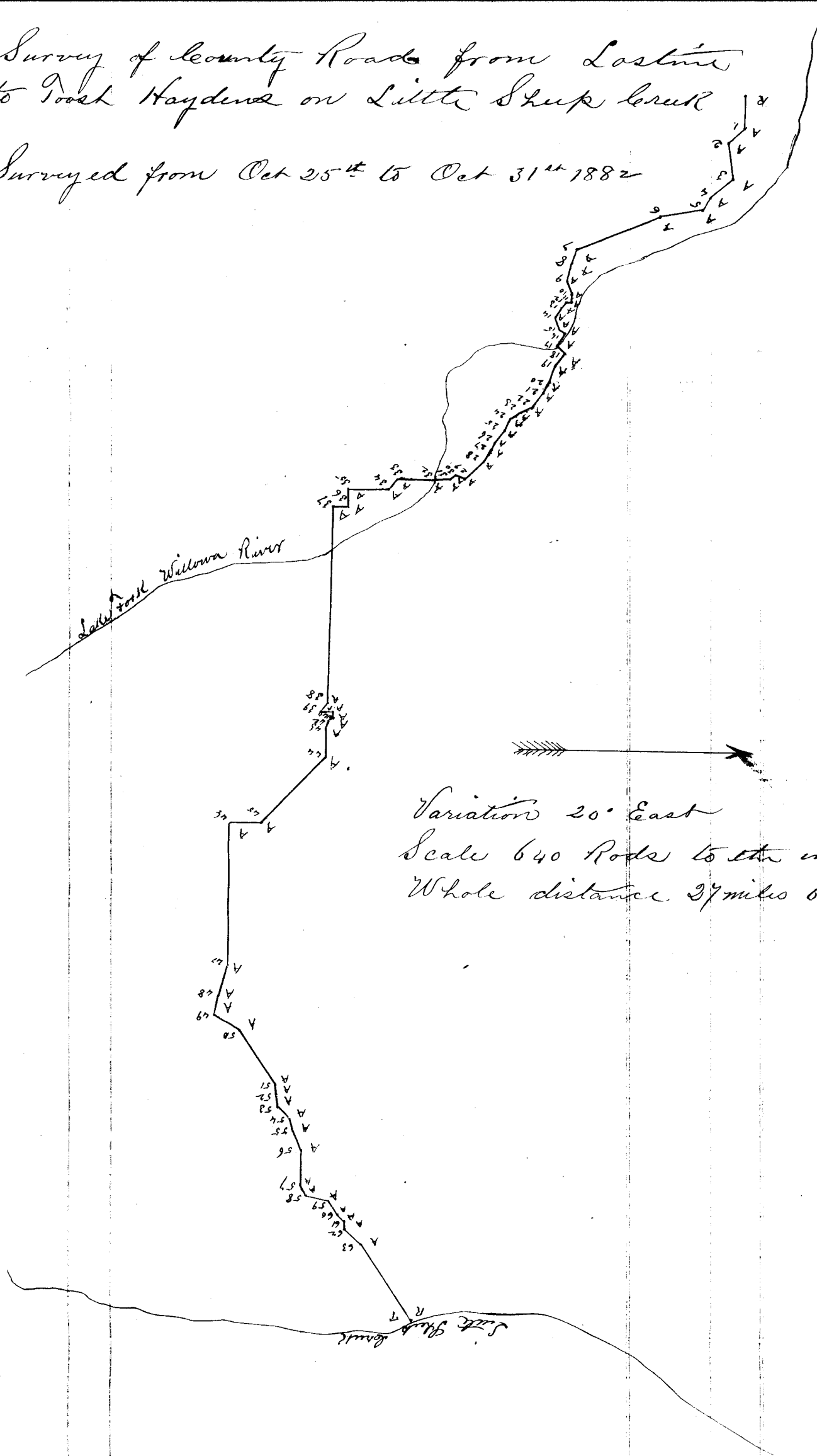

Variation 20° East
Scale 640 Rods to the inch
Whole distance 27 miles 61 rods

has been given as by law required; that more than twelve of said petitioners are legal house holders residing in the vicinity of said road, and that a good and sufficient bond has been given filed;

It is therefore ordered by the Court that D. B. Reavis - Benj. Davis and Benj. Roswell be appointed viewers and Eugene Chase Surveyor, to view, survey and report upon said proposed County Road, and that they meet at the place named herein as the beginning of said road on the 13th day of July - 1882 and duly qualify before entering upon the discharge of their duties in this behalf.

In the matter of proposed
County Road petitioned for
by H. F. Burlington and others

On this day came H. F. Burlington who presents to the Court the petition of himself and thirty four others praying for the location and establishment of a County road as follows to wit; - to commence at the town of Lostine in Union County, State of Oregon and running thence to James Lechman's house in the city of Bottom via Cross Halley's residence in a South Easterly direction a distance of about 4 miles thence following along and up the Lake fork of the Willowa River to a point near the mouth of Trout Creek in a South Easterly direction a distance of about three miles - thence on the most direct and practicable route to the town of Alder in a southerly direction a distance of about two miles - thence in an Easterly direction on the South line of Secs. 10-11 + 12 in Town, 2. South Range 44 E. of T. M. - about 2 1/4 miles - thence East to a point near the residence of James Pratt a distance of about six miles - thence in an Easterly direction on the most practicable route to the residence of David Hayden on Little Sheep Creek the terminus of said proposed County Road a distance of about six miles, all of said town being in Union Co Oregon

and it satisfactorily appearing to the Court from proof filed therein, that due notice of the pendency of this proceeding has been given as by law required; that more than twelve of said petitioners are legal householders residing in the vicinity of said road, and that a good and sufficient bond has been filed:

It is therefore ordered, by the Court that Leroy Wammack - John Richardson and S. H. Francis be appointed viewers, and Eugene Chase Surveyor, to view, survey and report upon said proposed County Road and that they meet at the town of Sustine on the 15th day of Sept. - 1882 and duly qualify before entering upon the discharge of their duties in this behalf.

In the matter of proposed
County Road petitioned for
by H. P. Gregg and others

On this day came H. P. Gregg who presents to the Court the petition of himself and thirty five others praying for the location and establishment of a County Road, as follows, to wit: - Beginning at the mouth of Trout Creek in the Upper Hollow Valley about two miles north of the town of Alder - thence up Trout Creek on the most practicable route to the residence of James Saunders about 4 1/2 miles - thence following the present road from the residence of said James Saunders, to the edge of the timber about 6 1/2 miles, all of said road running in a northerly direction and all of said points and places being in Union County Oregon - And it appearing to the Court, from proof filed herein, that due notice of the pendency of this proceeding has been given as by law required; that more than twelve of said petitioners are legal householders - residing in the vicinity

A. J. Patten & Co. authorizing them to keep and offer for sale spirituous liquors in less quantities than one quart in said precinct for the period of six months -

And it appearing to the satisfaction of the Court that all due and proper notice of the pendency of these proceedings have been given as by law required - and that a good and sufficient bond has been filed, as well the receipt of the County Treasurer showing that the amount required therefor has been paid - and no remonstrance or other objection having been filed - It is therefore ordered and adjudged by the Court that the prayer of the petition be granted - and that the Clerk of this Court issue to said A. J. Patten & Co. a license authorizing them to keep and offer for sale spirituous liquors in less quantities than one quart, in Sumnerville precinct Union County Oregon for the period of six months from the date hereof.

In the matter of the
County Road petitioned for
by H. F. Burleigh and others

Now at this time is presented to the Court the report of the viewers heretofore appointed - to view out a proposed County road - petitioned for by H. F. Burleigh and others - and read for the first time - and it is ordered by the Court that the report lay over for a second reading on tomorrow

In the matter of the County road
petitioned for by R. R. Wright & others

Now at this time is presented to the Court the report of the viewers heretofore appointed - to view out a proposed County road, petitioned for by R. R. Wright & others, and read for the first time, and it is ordered by the Court that the report lay over for a second reading on tomorrow -

Therefore Court adjourned to tomorrow morning at 9.0. clock

Second Judicial Day Thursday Nov. 9th 1882

Court met pursuant to adjournment same officers present as on yesterday - due proclamation of the opening of court having been made the proceedings of yesterday were read approved and are now signed

A. C. Craig
County Judge

Thereupon the following proceedings were had to wit;

In the matter of the petition
for a County Road of
H. F. Burleigh and others

now at this time is presented and read for a second time the previous report on a proposed county road - petitioned for by H. F. Burleigh and others - which report is favorable - and there being presented at the same time the petition of of W. H. Bloom through whose lands the said proposed road is viewed and marked out - complaining thereof and claiming damages - It is therefore ordered by the Court - that said report shall lay over till the next regular term of this Court - And it is further ordered, that Jacob Sturgill, E. H. Pully and J. C. Stanley three disinterested house holders of this County be and they are hereby appointed, to view said proposed road the whole distance through the premises of complainant and assess and determine how much less valuable such premises of the complainant would be rendered by the opening of said road, and they shall meet at the house of Jacob Sturgill on Monday Nov. 20th 1882, and be duly sworn before entering upon the discharge of their duties herein - And of their doings in this matter make return to this Court in writing at the next regular term thereof -

disallowed -

It further appearing that the review report on said proposed County Road is favorable and has been read in open court on two days successively at a regular session thereof it is further ordered that said report and petition be laid over till the next regular term of this court - when if there is no remonstrance or bills of damages filed the same will be regularly allowed - and ordered to be opened as a County Road -

In the matter of proposed
County Road petitioned for
by H. F. Burleigh and others

Now at this time this matter came on to be heard upon the report of the appraisers heretofore appointed to assess and determine how much less valuable the premises of R. H. Bloom - complainant herein would be rendered by the opening of said road - which report is as follows, to wit: -

"We the appraisers appointed by the County Court of Union County State of Oregon in the case of R. H. Bloom claiming damages on a certain road running through his premises from proper investigation that his premises are of less value to the amount of - Two Thousand and dollars -

Nov. 24/82

Jacob P. Jungill

E. H. Pully

John L. Grandley

and it appearing to the court that the appraisers above named, were duly sworn before entering upon the discharge of their duties therein and that their report is in due form and according to law the same is hereby accepted by the court. -

And it is ordered that the damages herein named be assessed upon the petitioners for said road - and that upon the payment or satisfaction of the same to the complainant herein - said road shall be declared a public highway -

In the matter of Proposed
County Road petitioned for
by H. F. Bauligh and others

Now at this time this matter came
on to be heard upon the report of the appraisers hereto-
fore appointed to assess and determine how much
less valuable the premises of R. W. Bloom complainant
herein would be rendered by the opening of said road -
which report is as follows, to wit: -

"The the appraisers appointed by the County Court of
Union County, State of Oregon in the case of R. W. Bloom
claiming damages on a certain road passing through
his premises from proper investigation that his premises
is of less value to the amount of two hundred dollars

Nov. 24/82

Jacob P. Furgill

E. H. Sully

John L. Standley

And it appearing to the court that the appraisers
above named, were duly sworn before entering
upon the discharge of their duties therein and that
their report is in accordance with law the
same is hereby accepted by the court. -

And it further appearing to the court that the
previous report on said Proposed Road is favorable
and has been read in open court on two
different days at a regular term thereof - and
that the proceedings herein have been regular
and according to law and there being no
remonstrance nor other claim for damages
except as named herein - it is therefore order-
ed by the court that the previous report and
plot of the Surveyor be placed on record and
the damages herein be assessed to the petitioners
for said road - and that upon payment of
said damages - the said road shall be opened
as a public highway. -

Previous Report -

"To the Hon County Court of Union County Oregon
We the undersigned viewers appointed by your
Honorable body to view out a proposed County
Road from Lortine to Ross Hayden on Little Sheep
Creek by way of Trout Creek and Alder submit

the following report in relation thereto. We met by appointment on the 25th day of October A.D. 1882 the three viewers being present and after being first duly sworn in company with the Surveyor proceeded to view, survey and lay out said road as directed in your order and as shown by the Surveyors plat and report submitted herewith. we surveyed from day to day completing said survey Oct. 31st 1882 - We find the road to be located on as good ground as the Section of Country over which the road is laid will admit of and taking into consideration the necessity that exists for the road we recommend that said route be established as a county Road -

S. M. Francis }
 G. W. Hornack } viewers of proposed
 John M. Richardson } County Road "

"Report of Surveyor, to the viewers of a proposed County Road from the Town of Lostine to Toosh Hayden's on Little Sheep Creek by way of Trout Creek and Alder. The following are the field notes. Beginning at the N.W. cor. of the S.E. 1st Sec. 15 T. 1 South Range 44 East at post marked R thence East 140 rods to Post marked A I thence S. 45° E. 114 rods to post marked A II. thence N. 78° E. 200 Rods to Post marked A III thence S 40° E. 166 rods to Post marked A IV thence S. 55° E 82 rods to post marked A V thence S. 10° E 264 rods to Post marked A VI thence S. 28° E 480 rods to Post marked A VII thence S. 70° E. 68 Rods to Post marked A VIII thence S. 80° E ¹⁰⁸ Rods to post marked A IX thence N. 66° E 60 Rods to post marked A X thence N. 76° E 32 Rods to post marked A XI thence S. 9° E 20 rods to post marked A XII thence S 50° E 26 rods to post marked A XIII thence S. 60° E 42 Rods to post marked A XIV thence N. 70° E. 54 Rods to post marked A XV thence N. 35° E 14 Rods to post marked A XVI thence S. 72° E 82 Rods to post marked A XVII thence N. 37° E. 52 rods to post marked A XVIII thence S. 60° E 82 rods to post marked A XIX thence S. 75° E 148 rods to post marked A XX thence S. 70° E 40 rods to post marked A XXI thence S 55° E 98 rods to post marked A XXII thence S. 25° E 80 Rods to post marked A XXIII thence S. 35° E 54 Rods to post marked A XXIV thence S. 65° E 52 Rods to post marked A XXV thence S. 55° E. 76 Rods. to post marked A XXVI thence S. 75° E. 52 Rods to post marked A XXVII thence S 58° E 70 Rods to post marked A XXVIII thence S 43° E 136

rods to post marked A XXIX thence S 33° W 24 rods to post marked
 A XXX thence S 36° E 24 to post marked A XXXI thence South
 108 rods to post marked A XXXII thence S. 13° E 168 rods to post
 marked A XXXIII thence S. 51° E. 60 rods to post marked A XXXIV
 thence South 210 rods to post marked A XXXV thence East 77
 rods to post marked A XXXVI thence South 78 rods to post
 marked A XXXVII thence East 1046 Rods to post marked A XXXVIII
 thence S 58° E 46 rods to post marked A XXXIX
 " N. 10° E 58 " " " " " " A XL
 " East 22 " " " " " " A XL I
 " S. 39° E 18 " " " " " " A XL II
 " S. 80° E 46 " " " " " " A XL III
 " East 160 " " " " " " A XL IV
 " S. 45° E 460 " " " " " " A XL V
 " South 160 " " " " " " A XL VI
 " East 780 " " " " " " A XL VII
 " S 74° E 166 " " " " " " A XL VIII
 " S. 80° E 98 " " " " " " A XL IX
 " N. 30° E 154 " " " " " " A L
 " N. 58° E 372 " " " " " " A LI
 " East 36 " " " " " " A LII
 " N 75° E 50 " " " " " " A LIII
 " N. 35° E 78 " " " " " " A LIV
 " N. 70° E 70 " " " " " " A LV
 " N. 65° E 100 " " " " " " A LVI
 " East 232 " " " " " " A LVII
 " N. 57° E 60 " " " " " " A LVIII
 " N 10° E 118 " " " " " " A LIX
 " N. 52° E 82 " " " " " " A LX
 " N. 35° E 44 " " " " " " A LX I
 " N 85° E 36 " " " " " " A LX II
 " N. 40° E 108 " " " " " " A LX III
 " N. 55° E 480 " " " " " " R.T.

Terminating at Toosh Hayden's on little Sheep Creek
 State of Oregon,
 County of Union 3rd ss. I Eugene Chase County Surveyor in
 and for the County and state aforesaid do hereby
 certify that the field notes of the survey of the
 above road are correct as surveyed by me under
 the supervision of the viewers from Oct. 25th to Oct 31st, 1882
 Eugene Chase
 Co-Surveyor

Survey of County Road from Lostine to Goose Meadows
 on Little Sheep Creek
 Surveyed from Oct. 25th to Oct. 31st 1882

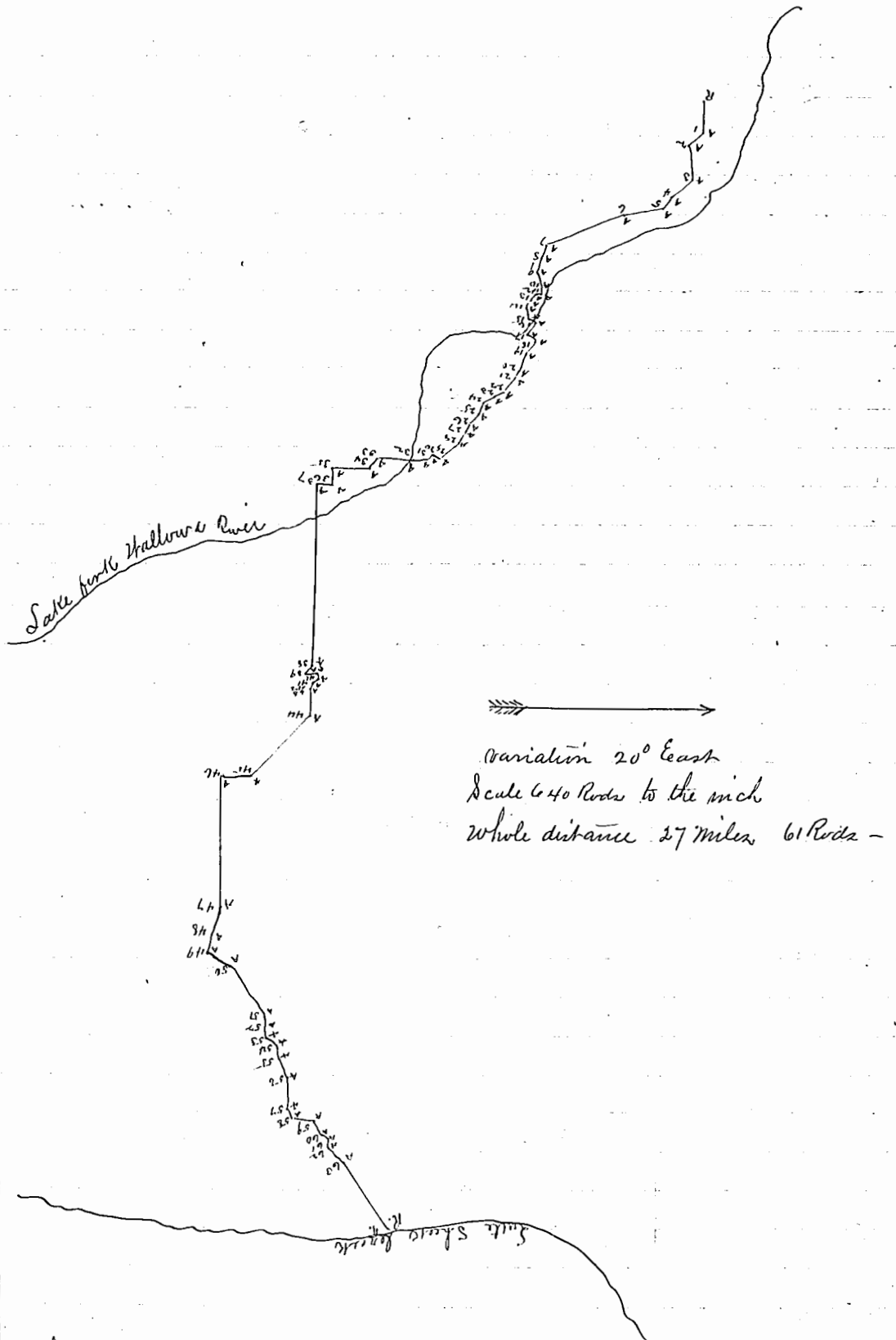

Thereupon Court adjourned until tomorrow morning at
 Nine o'clock

Seventh Judicial Day

Thursday June 19th 1884

In the matter of a proposed
County Road petitioned for
by David A. Bidwell, E. J.
Keiville and others.

Now at this time it appearing to the Court from an examination of the record in the matter of the County Road petitioned for by David A. Bidwell E. J. Keiville and others, ordered by this Court to be opened as a County Road, by order duly entered of Record on the 11th day of January 1884, ^{that a portion thereof} lies in Road District No 10 of this County, and that no notice to open said road had been given to the Supervisor of said District. It is therefore ordered by the Court that the Supervisor of Road District No 10 of this County proceed at once to open such portion of said road as lies within his District, and that the Clerk of this Court send a Certified Copy of this order, together with a copy of the field notes of the Surveyor of said road, to the Supervisor of said District No 10 forthwith.

In the matter of a County
Road petitioned for by
J. Burleigh and others.

Now at this time it appearing to the Court from an examination of the record in the matter of the County Road petitioned for by J. E. Burleigh and others, ordered by this Court to be opened as a County Road, by order duly entered of record on the 4th day of January 1883, ^{that a portion thereof} lies in Road District No 19 of this County and that no notice to open said road had been given to the Supervisor of said District. It is therefore ordered by the Court that the Supervisor of Road District No 19 of this County proceed at once to open such portion of said road as lies in his District, provided however that where such opening will interfere with growing crops of the present season, this order shall remain in abeyance until the harvesting and removal of such growing crops, and the Clerk of this Court is ordered to send a Certified Copy of this order together with a copy of the field notes of the Surveyor of said road to the Supervisor of said District No 19 forthwith.

Whereupon Court adjourned until Tuesday July 1st 1884