

*Law*

No "7"  
in

Court

*J A Baker*

Plaintiff

vs

*W. S. Thompson*

Defendant

Action for

Docket

Page

*A Meachen*

Attorney for Plaintiff

Attorney for Defendant

PRINTED AND PUBLISHED BY  
W. L. GIBSON, 101 N. 10th St.  
PHILADELPHIA, PA.

**Record of the Case**

130

**WITNESSES.**

1880

Feb 4 Petition rec Brewer's appld  
Journal B p 423

May 17 1st reading report  
Journal B p 446

May 13 ordered opened  
Journal B p 463

P

Road

commencing opposite house of  
James Cochran in Long Valley to  
road near house of Abel Roswell

**DIRECTIONS**—Place papers on **TOP OF RUBBER**  
Fold ends first then sides. Throw the rubber cords  
over the ends and package is complete

130

To B S Halley and J A Hunter, viewers appointed to review the county road from near the house of James Cochran in Long Valley to intersect the county road at or near the house of Benjamin Boswell. The following are the field notes of the survey of the above described road. Beginning opposite the house of J<sup>as</sup>. Cochran at a post marked R

Thence	N 37° E - 26	tds to Post marked	A I.
"	S 6½° E - 30	" " Tree "	A II.
"	S 65° E - 72	" " Post "	A III.
"	N 77° E - 28	" " " "	A IV.
"	N 61° E - 76	" " " "	A V.
"	S 45° E - 54	" " Tree "	A VI.
"	S 10° W - 14	" " Post "	A VII.
"	S 70° W - 10	" " " "	A VIII.
"	S 38° W - 10	" " " "	A IX.
"	S 8° E - 238	" " Tree "	A X.
"	S 35° E - 78	" " Post "	A XI.
"	East - 80	" " " "	A XII.
"	South - 80	" " " "	A XIII.
"	East - 160	" " " "	A XIV.
"	South - 320	" " " "	A XV.
"	East - 214	" " " "	R I and

intersecting the county road

State of Oregon }  
 County of Union } SS

I, Eugene Chase County Surveyor in and for the county and State aforesaid do hereby certify that the field notes of the survey of the above described road are correct as surveyed by me on the 15<sup>th</sup> day of March 1880

Eugene Chase Co Surveyor

Survey of County Road leading  
from Long Valley to intersect the  
County Road near the house of  
Benjamin Boswell

Surveyed March 15<sup>th</sup> 1880  
Variation 20° East

Scale of distances  
100 rods to the inch

Whole distance 4 miles 210 rods

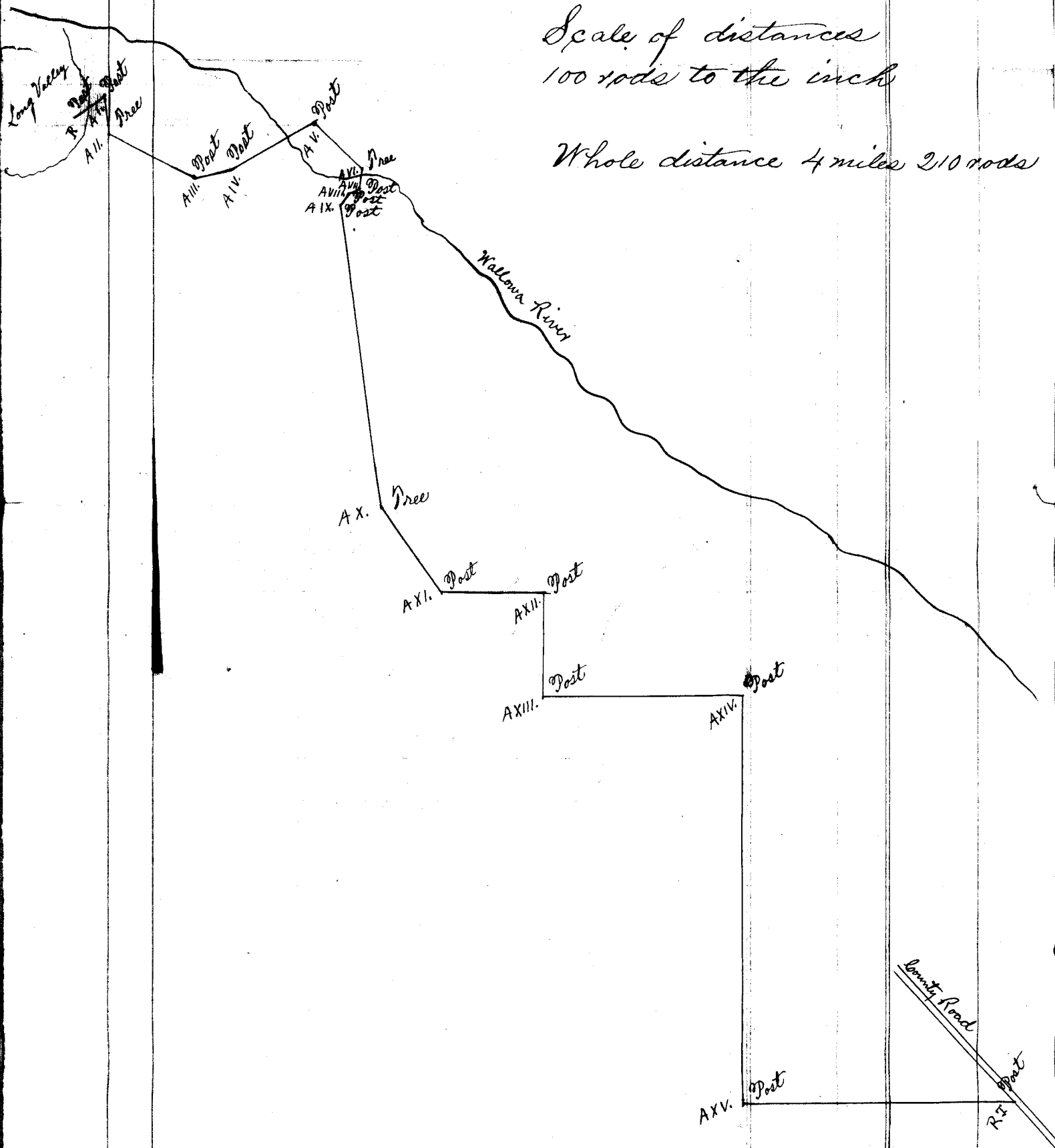

Very Truly & Warmly

Yours Truly  
J. Williams

at  
New York May 12<sup>th</sup>  
1882

Wm. W. W. W.  
Dear

J. Williams  
New York

# Know all Men by these Presents:

THAT ~~vs.~~ *J D B Reavis*

*Union*  
and \_\_\_\_\_, of the County of Marion and

*am*  
State of Oregon, ~~we~~ held and firmly bound unto the said County of Marion in the sum of

*fifty* Dollars, the payment of which, well and truly  
*I myself my*  
to be made, ~~we bind ourselves, our~~ heirs, executors and administrators firmly by these presents.

Signed this *4<sup>th</sup>* day of *Feb* A. D. 18*88*

Now the condition of the above obligation is such, that whereas, if the County Road petitioned  
for by *Ray Rosewell* and others, and presented

*Union*  
at the *March* term, 18*88*, of the County Court of said ~~Marion~~ county, commencing  
*commencing at a point opposite the house of James Leckman,*  
*(in what is known as Long Valley) and running on the most practicable*  
*route to the South West corner of Henry Miller's Claim;*  
*thence 1/4 mile East, thence 1/4 mile South to the*  
*Surveyors line; thence East on said line 1/2 mile*  
*thence South one mile to the South West corner of*  
*James Rogers Claim, thence East to the intersection*  
*of the present road at or near the house of B Rosewell*

be located and established, then this obligation to be void; otherwise to remain in full force  
and virtue in law.

*J D B Reavis*

Yield March 4<sup>th</sup>

1879  
Wells' Shipp

Clark

By Ellis E. Clark

Deputy

To the Hon County Court of  
Union County Oregon,

The undersigned citizens and  
householders of Union County, would respect-  
fully petition your Hon body to make the fol-  
lowing alteration in "the Wallawa County  
road". Commencing at a point opposite  
the house of James Cochran (in what is known  
as Long Valley) and running on the most practi-  
cable route to the South West Corner of Henry  
Miller's Claim, thence  $\frac{1}{4}$  mile east thence  $\frac{1}{4}$  mile  
South. Thence to the Township line thence east with  
said line  $\frac{1}{2}$  mile, thence South one mile to the  
South West Corner of James Rogers Claim thence  
east to the intersection of the present road at or  
near the house of Benjamin Boswell Esq.

Names

J B Reavis

Benj Boswell

W Bloop

E J Hamblen

A E King

Mark Homan

J W Reynolds

Henry Miller

Jakob S Woods

Names

James Cochran

J C Rogers

William Reavis

E A Hart

O D Abner

S B Yawter

W B McConnell

W W Cheever



Gen. L. Hamblin  
of St. George  
T. P. McConnell  
W. S. Hayes

Road Petition  
Filed Feb 23<sup>rd</sup> 1880  
Willis Skiff  
Co. clerk

W. S. Skiff  
of St. George  
~~Gen. L. Hamblin~~

W. H. Allen

A petition will be presented at the next term  
of the Union County Court for the following al-  
teration in the Wellouse County road.

The commencing at a point near  
the residence of James H. Cochran and run-  
ning on the most practicable road to the South West  
Corner of Henry Motters Claim thence east  $\frac{1}{2}$  mile  
thence South  $\frac{1}{2}$  mile thence to the township line thence  
east with said line  $\frac{1}{2}$  miles thence South one mile  
to the S. W. Corner of James Rogers Claim thence  
east intersecting the old road near the home of  
Benjamin Bassell Aug 28<sup>th</sup> 1888

Filed March 27<sup>th</sup> 1880  
Willis Skiff  
County Clerk

State of Oregon } ss I Edliss Elatis being  
Union County } duly sworn say that I posted the  
within notice on the court house door in Union  
County, Or. more than 30 days prior to this date  
subscribed and sworn to before me }  
this 4<sup>th</sup> day of March 1880. } Edliss Elatis

Willis Skiff  
County Clerk

State of Oregon } ss  
Union County } I D P Reavis being sworn say  
that three copies of the within notice were posted  
in three public places in the vicinity of the  
within proposed road more than 30  
days prior to the date hereof  
subscribed and sworn to before me } D P Reavis  
this 4<sup>th</sup> day of March 1880. }

Willis Skiff  
County Clerk

To the Hon County Court of Union  
County state of Oregon,  
We submit the following as our report  
as viewers of roads, described as follows  
to wit, commencing at a point opposite  
the house of James Cochran (in what is  
known as Long valley) and running  
thence on the most practicable route  
to the south west corner of Henry  
Millers claim, thence  $\frac{1}{4}$  mile east,  
thence  $\frac{1}{4}$  mile south, to the Township  
line thence east with said line  $\frac{1}{2}$  mile  
thence south 1 mile to the south  
west corner of James Rogers claim  
thence east to the intersection of the  
present road at or near the house of  
Benj. Boswell

And as follows; commencing at the  
east corner of D B Peares claim (in  
Wallowa valley) running east 1 mile  
to the north west corner of A C Kings  
claim, thence south (by the school house)  
 $\frac{1}{2}$  mile to the south west corner of A C  
Kings claim thence east  $\frac{1}{2}$  mile or  
thereabouts until it well intersect with the present  
county

We met on the 13<sup>th</sup> of march A D 1880 as  
mentioned in your order and after  
being first duly sworn in company  
with the surveyor, proceeded to  
view, survey, and lay out said roads  
from day to day up to and including  
march 16<sup>th</sup> 1880 and closing said survey.

We select from said surveyors plat of  
surveys which as shown by surveyors  
plat, one which we heartily recommend  
for County road and public travel

We therefore submit the above hoping  
the same will meet your approval

B S Walley Viewers of  
J A Hunter } proposed county  
roads

Survey Report

Filed May 12<sup>th</sup>

1880

Wells Stuffs

Chas

J. Ellis - Escalante

20

1

county road at or near Alder. And it satisfactorily appearing to the court, from proof filed herein, that due notice of the pendency of this proceedings has been given as by law required; that more than twelve of said petitioners are legal householders residing in the vicinity of said road, and that a good and sufficient bond has been filed: It is therefore ordered by the court, that B. S. Kaley, J. H. Hamilton and Samuel Wade be appointed viewers and Eugene Lehave Surveyor, to view, survey and report upon said proposed road and that they meet at James Lechman's and that they on the 15<sup>th</sup> day of March 1880 and duly qualify before entering upon the discharge of their duties in this behalf.

In the matter of the  
petition of D. B. Reavis ~~et al~~  
for County Road

On this day come D. B. Reavis who presents to the court the petition of himself and twelve others praying for the location of a county road as follows, to wit: Commencing at a point opposite the house of James Lechman (in what is known as Long Valley) and running on the most practicable route to the South West corner of Henry Miller's claim thence East  $\frac{1}{4}$  of mile, thence South  $\frac{1}{4}$  of mile to the Township line, thence East with said line  $\frac{1}{2}$  mile thence South one mile to the South West corner of James Rogers' claim, thence East to the intersection of the present road at or near the house of Benjamin Boswell Esq. And it satisfactorily appearing to the court, from proof filed therein, that due notice of the pendency of this proceeding had been given as by law required; that more than twelve of said petitioners are legal householders residing in the vicinity of said road,



March 4<sup>th</sup> 1880 and that a good and sufficient bond  
 has been filed. It was therefore ordered by  
 the court that B. J. Halley, J. A. Hunter and  
 Samuel Wade be appointed Viewers and  
 Eugene Lechase Surveyor to view survey and  
 report upon said proposed road and that  
 they meet at James Lechman's on the 15<sup>th</sup>  
 day of March 1880 and duly qualify before  
 entering upon the discharge of their duties in  
 this behalf.

In the matter of  
 Viewers report upon  
 Road petitioned for  
 by J. L. Harris

Now at this time was  
 read the second time in this court the  
 report of the Viewers appointed to view and  
 report upon a proposed county road as  
 follows, to wit: Commencing at the N. E.  
 corner of the N. W. 1/4 of Sec. 16 T. 2 S. R. 38 E. and  
 running thence North two miles; thence E.  
 one mile to the Helena City road, which  
 report is as follows:

To the Hon County Court of Blaine County  
 Oregon,

We submit the following as our report  
 as viewers of road viz: beginning at the N.  
 E. corner of the N. W. 1/4 of Section 16 T. 2 South  
 Range 38, E. running thence North two miles  
 thence East one mile to intersect the Helena  
 City County road. We met on the 16<sup>th</sup>  
 of Jan according to your order, but the  
 Surveyor not coming until dark were  
 obliged to adjourn until the next day, we  
 met on the 17<sup>th</sup> and after being first duly  
 sworn in company with the Surveyor,  
 proceeded to view layout and survey said  
 road, the completed. We select from  
 said surveyors plat of surveys, which as  
 shown by Surveyors plat, one which we  
 heartily recommend for county Road and

May 12. 1880.

In the Matter  
of  
Viewers Report  
upon Road petitioned  
for, by D. B. Reavis et al.

Viewers Report  
Willowa Road

Now at this Time  
was read for the first time the viewers report  
upon a County Road petitioned for by D. B.  
Reavis et al. described as follows to wit:

Commencing at the Point opposite the house  
of James Cochran, in what is known as Long  
Valley and running on the most practicable  
route to the South West Corner of Henry  
Millers Claim; thence 1/4 Mile East, thence 1/4  
of Mile South to the Townships line, thence  
east with said line 1/2 Mile, thence South one  
Mile to the South West Corner of James  
Kogers Claim, thence East to the intersec-  
tion of the present County Road at or near  
the house of Benjamin Boswell; which  
report was laid over until to morrow  
for a second reading. —

In the Matter  
of  
Viewers Report  
upon  
Road Petition  
from D. B. Reavis  
and others.

Viewers Report  
on  
Willowa Road.

Now at this Time comes  
on for the first reading the report of the viewers  
heretofore appointed to view a proposed County  
Road petitioned for by D. B. Reavis et al.  
as follows, to wit:

Commencing at the East Corner of D. B. Reavis  
Claim in Willowa Valley and running  
East one Mile to the N. W. Corner of C. C.  
Kings Claim thence South 1/2 mile to the  
South West Corner of C. C. King's Claim,  
thence East 1/2 mile or so when it will inter-  
sect with the present County Court at or  
near Alder, which report was laid over, un-  
till to morrow morning for a second reading.



May 13 1880 } In the Matter  
 of Viewers Report }  
 on }  
 Willowa Road }

Now at this Time come on for a second reading, the Report of the Viewers heretofore appointed to view and report upon a proposed County Road as follows to wit:

Commencing at a Point opposite the house of James Cochran, in Long Valley and running thence on the most practicable Route to intersect the Co. Road at or near the house of Benjamin Roswell, which Report is as follows to wit:

To the Hon. County Court of Union County,  
 State of Oregon.

We submit the following as our Report as Viewers of Road, described as follows to wit:

Commencing at a Point opposite the house of James Cochran (in what is known as Long Valley) and running thence on the most practicable route to the South West Corner of Henry Millers Claim, thence  $\frac{1}{4}$  Miles east, thence one fourth mile south to the Townships line thence east with said line  $\frac{1}{2}$  mile, thence South 1 Mile to the South West Corner of James Rogers Claim, thence East to the intersection of the present road at or near the house of Beny. Roswell.

We met on the 15 of March A D 1880 as mentioned in Your order and being first duly sworn, in Company with the Surveyor, proceeded to review, survey and lay out said road from day to day, up to and including March 16 1880 - and closing said Survey. -

We select from said Surveyor plat of Surveys, which as Shown by Surveyors plat, one which we heartily recommend for County Road and Public Travel.

We therefore submit the above

hoping the same will meet Your Approval  
 B. S. Halley }  
 Jas. A. Hunter } Viewers of  
 proposed Road.

And it satisfactory appearing to the Court, that the Proceedings herein have been regular and in due form of Law and that this Road would be of great Public Utility and there having been no damages Claimed by any one by reason of the location of said Road

It was ordered, that the same be opened and declared a County Road and public highway, in accordance with the Surveyors plat and Field Notes thereof of which the following are Copies to wit:

To: B. S. Halley and J. A. Hunter viewers appointed to review the County Road, from near the house of James Cochran in Long Valley to intersect the County Road at or near the house of Benjamin Ross-wells

The following are the Field Notes of the Survey of the above described road -

Beginning opposite the house of Jas Cochran at a Post marked - R

Thence	N 37° E	26 rods to a Post marked	A I
"	S 6 1/2° E	30 " " " Tree	A II
"	S 65° E	72 " " " Post	A III
"	N. 77° E.	28 " " " "	A IV
"	N. 61° E.	76 " " " "	A V
"	S 45° E	54 " " " Tree	A VI
"	S 10° W	14 " " " Post	A VII
"	S 70° W	10 " " " "	A VIII
"	S 38° W	10 " " " "	A IX
"	S 8° E	238 " " " Tree	A X
"	S 35° E	78 " " " Post	A XI
"	East -	80 " " " "	A XII
"	South -	80 " " " "	A XIII
"	East -	160 " " " "	A XIV
"	South -	320 " " " "	A XV
"	East -	214 " " " "	R I

and intersecting the County Road

Survey of County Road leading from Long Valley to intersect the County Road near the house of Benjamin Rossell.

Surveyed March 15<sup>th</sup> 1880.

Variation 20<sup>o</sup> East.

Whole Dist. 4 M. 210 rods.

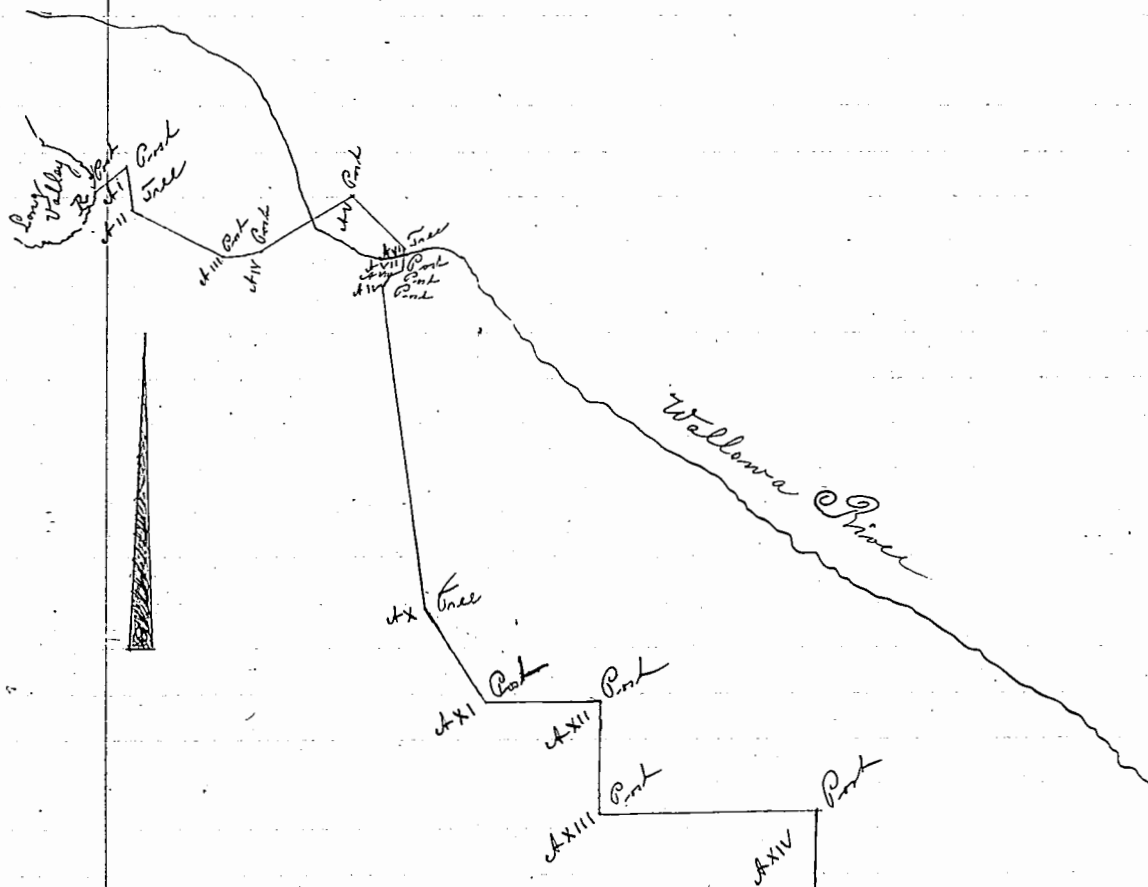

State of Oregon } ss  
County of Union }

I, Eugene Chase County Surveyor in and for the County aforesaid do hereby Certify, that the Field Notes of the above desc. Road are Correct as surveyed by me on the 15<sup>th</sup> day of March 1880.  
Eugene Chase Co. Surveyor.

