

Index File No. R9

CORNER RECORD (SEARCH)
(Ref. FSM 7151.4)

Tract or Survey No. _____ Cor. No. _____

T 6S R. 42E R.D. UNION County UNION

Merid. W-M N.F. W-W State OKA

CORNER DIAGRAM

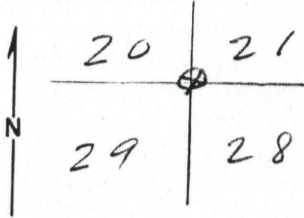

DESCRIBE CORNER MONUMENT FOUND

DESCRIBE BEARING TREES OR OTHER OFFICIAL ACCESSORIES FOUND 2

15" PP SNAG IN SEC. 28 WITH SCRIP
T6 R44E S28 B.T.

PHOTO IDENTIFICATION DATA 6

Photo No. 8970
FWP 21-117

Filed At. _____

Object Ident. _____

Ident. By _____

Signature

DESCRIBE CORNER LOCATION RELATIVE TO NEAR-BY FEATURES, ALSO HOW TO REACH CORNER 3

Cor. CAN BE SEEN FROM HD. SHOWN
ON PHOTO

PLANE COORDINATE POSITION DATA 8

State _____ Zone _____

X _____

Y _____

Estab. By _____

Agency

Signature
EAH

Title

Division

Headquarters

Date

8/31/78

7100-52-(3/68)

4
5

**UNION COUNTY
SURVEYOR**

Date Received _____

Date Filed 12-23-87

By G. LANGUITZ, DEPUTY

File No. 415-87R

R-9

CERTIFIED RECORD OF LAND CORNER MONUMENTATION

History of original corner establishment:

80.00 Set basalt rock 12 x 10 x 8 ins., 8 ins. in the ground, for corner to secs. 20, 21, 28, and 29. Marked with 4 notches on the East and 2 notches on the South edge, from which:

A pine, 26 ins. diam., bears N.75°E., 72 lks. dist. mkd. T6S R42E S21 BT.

A pine, 15 ins. diam., bears S.16°E., 85 lks. dist. mkd. T6S R42E S28 BT.

No other trees with in links. raised mound of rock alongside. Pits impracticable.

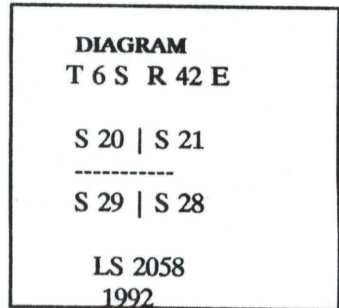

Description of corner evidence found:

A pine stump, 20" diam., bears S.16°E., 56.10', scribing visible in blaze.

A log/root hole, 26" diam., bears N.75°E., 47.5'.

Description of monument and accessories I established to perpetuate the original location of this corner:

No evidence of original monument found. Position established from using record bearing and distance from found original bearing tree stump. Set a 3" diam. U.S.F.S aluminum capped pipe, 30" long, with magnet, 2" in ground with mound of stone to cap, from which:

A chiseled hole, bears N.27°54'W., 92.54'.

A chiseled hole, bears S.18°21'E., 44.88'.

A pine, 7" diam., bears N.77°31'W., 90.43', scribed "X BT".

A pine, 15" diam., bears N.77°59'E., 61.57', scribed "T6S R42E S21 BT".

UNION COUNTY SURVEYOR	
Date Received	<u>8/28/94</u>
Date Filed	<u>10/22/94</u>
By	<u>[Signature]</u>
File No.	<u>062-1994R</u>

REGISTERED
PROFESSIONAL LAND SURVEYOR
 [Signature]
 OREGON
 JULY 15 1983
RONALD E. STOLL
 2058

Office of _____ County of _____
 State of _____ I hereby certify that the within instrument was filed in this office
 for record on the _____ day of _____, 19____
 _____ by _____
 (COUNTY OFFICIAL) (DEPUTY)

E