

CERTIFIED RECORD OF LAND CORNER MONUMENTATION

History of original corner establishment:

Set basalt rock 12 x 12 x 6 ins., 8 ins. in the ground cor. to sec. 19, 20, 29, and 30, marked with 2 notches on the South and 5 notches on the East edges, raised a mound of rock alongside, pits impracticable.

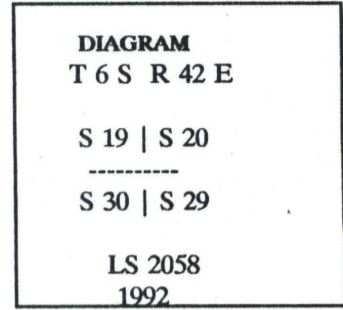

Description of corner evidence found:

Found a stone, 12"x12"x8", with 2 notches on South, and 5 notches on East.

Description of monument and accessories I established to perpetuate the original location of this corner:

Set a 3" diam. U.S.F.S aluminum capped pipe, 30" long, with magnet, 20" in ground at position of marked stone and buried marked stone to East, from which:

- Set ½" rebar, bears S.88°02'E., 26.71'.
- Set ½" rebar, bears S.14°03'W., 24.15'.
- Chiseled "X" in rock, bears N.88°12'W., 23.17'.
- Set ½" rebar, bears N.12°40'E., 21.27'.

UNION COUNTY SURVEYOR

Date Received 8/10/94

Date Filed 10/22/94

By [Signature]

File No. 060-1994R

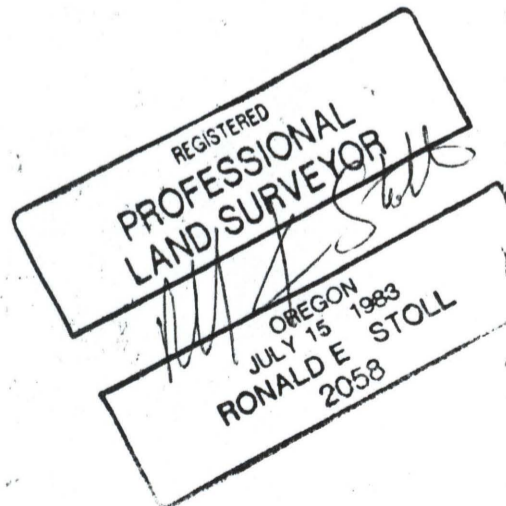

Office of _____ County of _____
 State of _____ I hereby certify that the within instrument was filed in this office
 for record on the _____ day of _____, 19____
 _____ by _____
 (COUNTY OFFICIAL) (DEPUTY)