

**CERTIFIED RECORD OF LAND CORNER MONUMENTATION**

**History of original corner establishment:**

40.00 Set basalt rock 22 x 12 x 5 ins, 17 ins in the ground, for 1/4 corner Sec. corner marked 1/4 on the West face, from which:

- A pine, 14 ins. diam., bears S.9°W., 216 lks. dist. mkd. 1/4 SBT.
- A pine, 16 ins. diam., bears S.48°E., 182 lks. dist. mkd. 1/4 SBT.

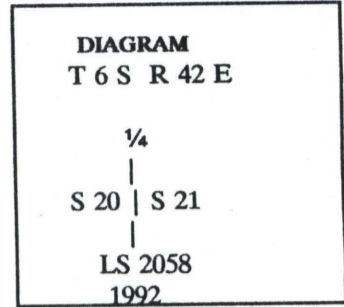

**Description of corner evidence found:**

- A burnt pine log and root hole, 22" diam., bears S.48°E., 120.10', no scribing visible.
- A burnt pine log, 24" diam., bears S.09°W., 142.6', no scribing visible.

**Description of monument and accessories I established to perpetuate the original location of this corner:**

No evidence of original monument found. Position established at record bearing and distance from the remains of 22" burnt pine log and root hole. Set a 3" diam. U.S.F.S aluminum capped pipe, 30" long, with magnet, 20" in ground, from which:

- A pine, 12" diam., bears N.20°46'E., 20.23'.
- A pine, 9" diam., bears S.07°43'E., 62.45'.
- A pine, 9" diam., bears S.78°57'E., 62.45'.
- A 3/4" drill hole in N-S ledge rock, bears N.52°01'W., 68.38'.

**UNION COUNTY SURVEYOR**

Date Received 8/18/94

Date Filed 10/22/94

By Gregory T. Blain

File No. 063-1994K

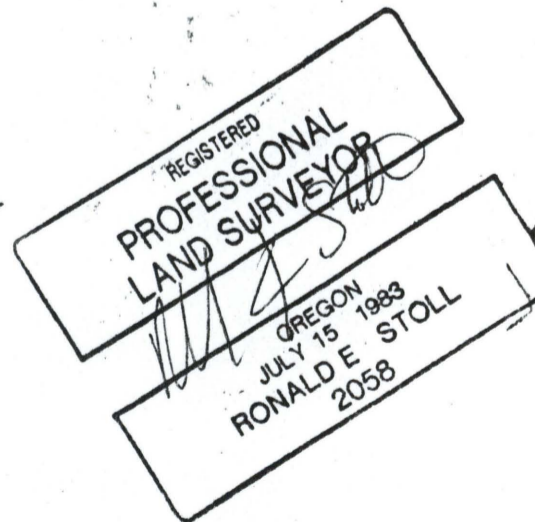

Office of \_\_\_\_\_ County of \_\_\_\_\_  
 State of \_\_\_\_\_ I hereby certify that the within instrument was filed in this office  
 for record on the \_\_\_\_\_ day of \_\_\_\_\_, 19\_\_\_\_  
 \_\_\_\_\_ by \_\_\_\_\_  
 (COUNTY OFFICIAL) (DEPUTY)