

CERTIFIED RECORD OF LAND CORNER MONUMENTATION

History of original corner establishment:

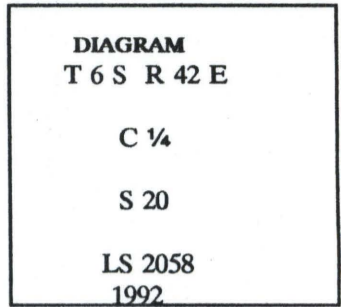

Description of corner evidence found:

Description of monument and accessories I established to perpetuate the original location of this corner:

Set a 3" diam. U.S.F.S aluminum capped pipe, 30" long, with magnet, 26" in ground with mound of stone, from which:

- A tamarack, 10" diam., bears N.16°25'E., 1.32', scribed "C¼ S20 BT".
- A pine, 6" diam., bears N.71°52'E., 18.01', scribed "C¼ S20 BT".
- A fir, 17" diam., bears S.13°09'E., 37.04', scribed "C¼ S20 BT".
- A fir, 11" diam., bears N.85°16'W., 26.88', scribed "C¼ S20 BT".

**UNION COUNTY
SURVEYOR**

Date Received 8/18/94

Date Filed 10/23/94

By [Signature]

File No. 056-1994K

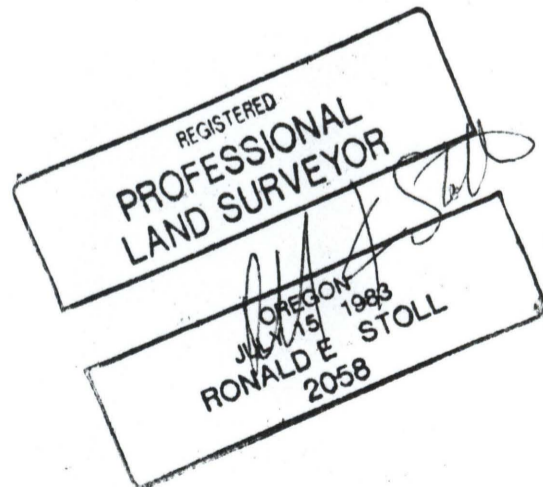

Office of _____ County of _____
 State of _____ I hereby certify that the within instrument was filed in this office
 for record on the ____ day of _____, 19__
 _____ by _____
 (COUNTY OFFICIAL) (DEPUTY)